

SURVEY IN LOT 6, BLOCK 2, COTTAGE HOME ADDITION
 FOR
 WALTER HALL
 62 - 28

BY EDWARD MCGINTY
 MEDFORD OREGON
 AUGUST 1962

SCALE: 1"=100'
 o = 5/8" I.P.I.N

2377

2377

Survey No. 2377

Survey Narrative to comply with O. R. S. 209-250:

Survey for: Walter Hall
Rogue River, Oregon

Survey by: Edward A. McGinty, L.S.
12/24/63

PRECEDENCE OF SURVEY:

Purpose of this survey was to determine the Northwest and Southwest corners and a point along the North line of Deed Record Vol. 525 page 83. The same procedure was used in determining the center line of Tripp Street as shown in Sur. No. 749. Record plat distance was used from Main St. and ran lot lines parallel to Main St.

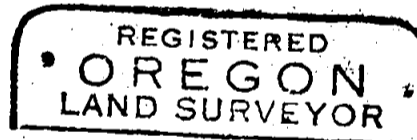
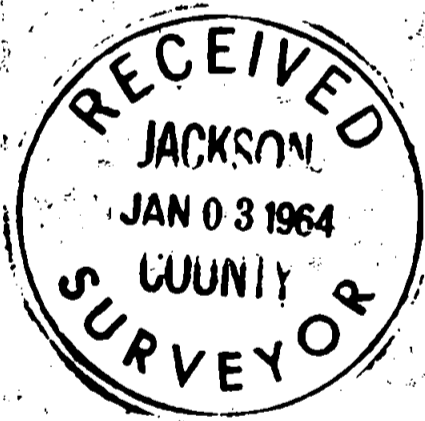

Edward A. McGinty
JULY 10, 1953
EDWARD A. MCGINTY
301