

MAP OF SURVEY

FOR
ERIC SUBERT

SITE ADDRESS
391 SOUTH MOUNTAIN AVENUE
ASHLAND, OREGON

LOCATED IN THE SOUTHEAST QUARTER OF SECTION 9,
TOWNSHIP 39 SOUTH, RANGE 1 EAST,
WILLAMETTE MERIDIAN,
CITY OF ASHLAND, JACKSON COUNTY, OREGON

DATE: 05-04-2022
SCALE: 1" = 40'

SURVEY NARRATIVE
TO COMPLY WITH O.R.S. 209.250

PURPOSE:
TO SURVEY AND MONUMENT THE BOUNDARY OF THAT TRACT OF LAND DESCRIBED IN INSTRUMENT NUMBER 83-20846, JACKSON COUNTY OFFICIAL RECORDS, OREGON.

PROCEDURE:
USING A TRIMBLE S-6 ROBOTIC TOTAL STATION AND TRIMBLE R-10 GPS RECEIVERS, I RECOVERED AND TIED EXISTING MONUMENTS OF RECORD AS SHOWN HEREIN. THE SUBJECT PROPERTY IS DESCRIBED AS BEING THE SOUTHERLY 50 FEET OF A DESCRIBED PREMISES. THERE IS AN OVERLAP AT THE POINT OF BEGINNING OF SAID PREMISES WITH THE NORTH LINE OF LOT 38 OF THE MAP OF MONTVIEW ADDITION TO ASHLAND, OREGON, WITH THE SUBJECT PROPERTY BEING JUNIOR. I HOLD THE RECOVERED CORNERS MONUMENTING THE NORTH LINE OF SAID LOT 38 AS SET ON SURVEY NUMBER (S/N) 16668. THE WESTERLY LINE IS DESCRIBED AS FOLLOWING A GULCH WHICH HAS SINCE BEEN BACKFILLED, I HOLD THE CALLS AS SHOWN ON S/N 22887 TO MAINTAIN THE CONTINUITY WITH THE EXISTING SURVEYS ALONG SAID THEORETICAL GULCH. THE NORTH LINE WAS HELD 50 FEET NORTH, AND PARALLEL WITH THE SOUTH LINE. SOUTH MOUNTAIN WAS ESTABLISHED BE HOLDING THE EXISTING MONUMENTS AND RECORD DISTANCES AS SHOWN ON S/N 8660.

BASIS OF BEARING WAS DETERMINED BY HIGH PRECISION GPS OBSERVATIONS (NAD83 (2011) EPOCH 2010.00 DATUM) APPLIED TO THE EAST HALF OF THE SOUTH LINE OF SECTION 9 AS SHOWN HEREIN RESULTING IN A BEARING OF N89°59'56"E.

LEGEND

- BOUNDARY LINE
- ✦ FOUND 2-1/2" OR 3" CITY OF ASHLAND BRASS CAP AS NOTED HEREIN
- ⊙ FOUND 2-1/2" BRASS CAP PER JACKSON COUNTY RE-ESTAB. AS NOTED
- ⊗ FOUND 1/2" IRON PIPE UNKNOWN ORIGIN
- ⊕ FOUND 5/8" REBAR PER S/N 16668
- ⊙ FOUND 5/8" REBAR WITH YELLOW PLASTIC CAP STAMPED "FARBER PLS 2189" PER S/N 16668
- ⊕ FOUND 5/8" REBAR WITH 2" ALUMINUM CAP STAMPED "KAMPMANN PLS 2883" PER S/N 22887
- FOUND 5/8" REBAR WITH ORANGE PLASTIC CAP STAMPED "KAMPMANN PLS 2883" PER S/N 22887
- ⊙ SET 5/8" X 24" REBAR WITH 1-1/2" ALUMINUM CAP STAMPED "DROSSOS LS 90718"
- S/N SURVEY NUMBER, ON FILE IN THE OFFICE OF THE JACKSON COUNTY SURVEYOR, JACKSON COUNTY, OREGON
- (R1) RECORD DATA PER S/N 8660
- (R2) RECORD DATA PER S/N 16668
- (R3) RECORD DATA PER S/N 22887

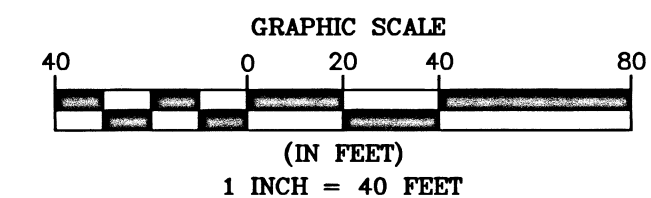

TERRASURVEY, INC.

PROFESSIONAL LAND SURVEYORS

274 FOURTH STREET
ASHLAND, OREGON 97520

(541) 482-6474
terrain@bisp.net

JOB NO. 1596-22

REGISTERED
PROFESSIONAL
LAND SURVEYOR

OREGON
JULY 12, 2016
PHILIP J. DROSSOS
No. 90718

Renewal 12-31-23

SECTION CORNER SECTIONS
9/10/16/15
FND. 2-1/2" BRASS CAP IN
MONUMENT CASE PER
JACKSON COUNTY SECOND
RE-ESTAB. CORNER REPORT

ACCEPTED SOUTHWEST COR.
DLC NO. 39
FND. 3" BRASS CAP IN
MONUMENT CASE

FILED
Date 9/1/22 By PE
This Survey Consists Of:
1 sheet(s) Map
2 page(s) Narrative
JACKSON COUNTY
SURVEYOR

MAP OF H.B.
CARTER ADDITION
TO THE CITY OF
ASHLAND

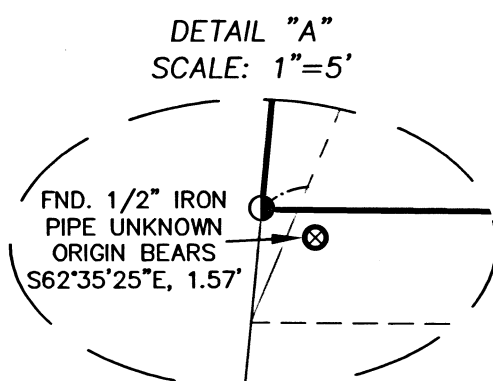

LINE TABLE		
LINE	BEARING	DISTANCE
L1	N05°37'32"E	9.19'

"DEEP GULCH" PER INST.
NO. 83-20846

HENRY STREET

1/4 CORNER SECTION 9/16
FND. 2-1/2" BRASS CAP IN
MONUMENT CASE PER JACKSON
COUNTY THIRD RE-ESTAB.

ASSESSOR'S MAP NO. 39 1E 09 DD,
TAX LOT 900

ASHLAND STREET

FND. 2-1/2" BRASS
CAP IN MONUMENT
CASE STAMPED "PLS
2653" PER S/N 22317

DETAIL "B"
SCALE: 1"=5'

269.25' (4.10 CHAINS DR) (269.25' R3)

