

# MAP OF SURVEY

1590 THOMPSON CREEK ROAD  
APPLEGATE, OREGON

FOR  
CRAIG & KIM LYONS

LOCATED IN THE NORTHWEST AND SOUTHWEST QUARTERS OF SECTION 28,  
TOWNSHIP 38 SOUTH, RANGE 4 WEST,  
WILLAMETTE MERIDIAN,  
JACKSON COUNTY, OREGON

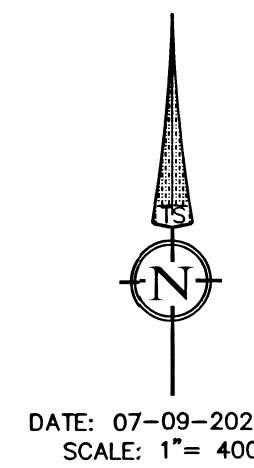

DATE: 07-09-2021  
SCALE: 1" = 400'

**SURVEY NARRATIVE**  
TO COMPLY WITH O.R.S. 209.250

**PURPOSE:**  
TO SURVEY AND MONUMENT THAT TRACT OF LAND DESCRIBED WITHIN INSTRUMENT NUMBER 2021-014033, OF THE JACKSON COUNTY OFFICIAL RECORDS, OREGON.

**PROCEDURE:**  
USING A TRIMBLE S-6 ROBOTIC TOTAL STATION AND TRIMBLE R-10 GPS RECEIVERS, I RECOVERED AND HELD THE CONTROLLING MONUMENTS AS SHOWN HEREIN. AT THE WEST 1/16 CORNER FOR SECTION 21 AND 28 SURVEY NUMBER (S/N) 4001 RECOVERED, BUT DID NOT HOLD, THE 1961 BLM MONUMENT AND ON SAID SURVEY SETS A 1" IRON PIPE. I HOLD SAID IRON PIPE AS IT, AND OTHER CORNERS AS SET ON S/N 4001 HAVE BEEN HELD AND RELIED UPON BY OTHER SURVEYS IN THE AREA. AT THE CENTER-NORTH 1/16 CORNER OF SECTION 28 I FIND A 2-1/2" X 48" IRON PIPE LEANING AND PROTRUDING 30", AND TWO TREES WITH BLM BEARING TREE TAGS DATED 12-84, BUT NO BLAZE OR SCRIBE, NEAR THE COMPUTED POSITION. I COULD FIND NO OFFICIAL GOVERNMENT OR PRIVATE SURVEY RECORDS FOR ANY CORNER OR ACCESSORIES FOR THE CENTER-NORTH 1/16 CORNER. I SET THE CENTER-NORTH 1/16 AND SCRIBE, BLAZE, AND PLACE NEW TAGS ON SAID TREES. THE RIGHT-OF-WAY OF THOMPSON CREEK ROAD WAS NOT MONUMENTED AND THE AS-TRAVELED CENTERLINE IS SHOWN HEREIN. WITNESS CORNERS ALONG THOMPSON CREEK ROAD WERE SET IN OR NEAR THE FENCELINE TO PROTECT THEM FROM FIELD EQUIPMENT.

ALL BEARING TREES SET ON THIS SURVEY HAVE AN UPPER AND LOWER BLAZE. THE UPPER BLAZE IS SCRIBED WITH PROPER CORNER AND SECTION DESIGNATION. THE LOWER BLAZE IS SCRIBED "BT". ALL TREES ARE MEASURED TO THE CENTER OF THE ROOT CROWN.

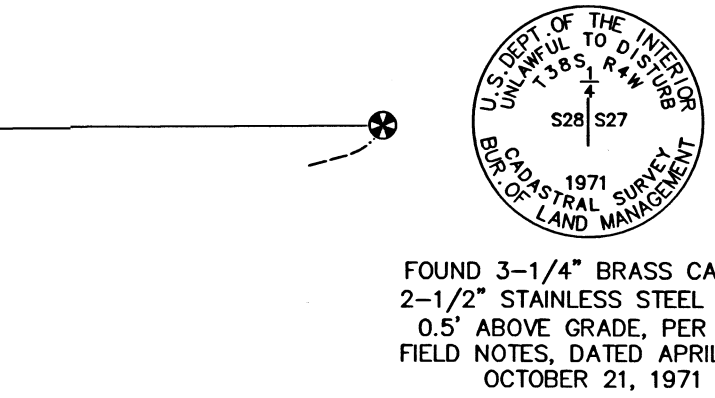

REGISTERED  
**PROFESSIONAL  
LAND SURVEYOR**  
*[Signature]*  
OREGON  
JULY 12, 2016  
PHILIP J. DROSSOS  
No. 90718  
Renewal 12-31-21

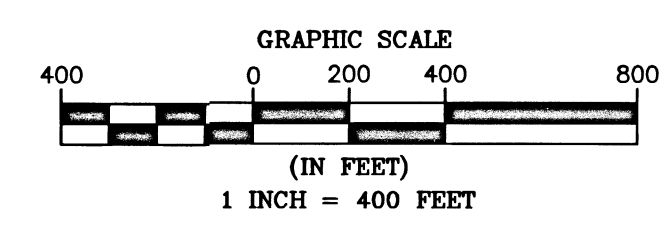

FILED  
Date 7/26/21 By PB  
This Survey Consists Of:  
1 sheet(s) Map  
5 page(s) Narrative  
JACKSON COUNTY  
SURVEYOR

**TERRASURVEY, INC.**  
PROFESSIONAL LAND SURVEYORS  
274 FOURTH STREET  
ASHLAND, OREGON 97520  
(541) 482-6474  
terrain@bisp.net  
JOB NO. 1500-21

DETAIL "A"  
NOT TO SCALE

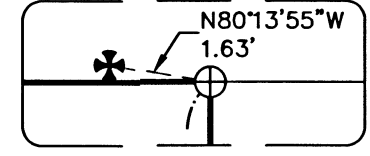

FOUND 3-1/2" BRASS CAP ON 2-1/2" STAINLESS STEEL POST, 0.2' ABOVE GRADE, PER BLM DEPENDENT RESURVEY, APPROVED MARCH 8, 1963 \*SEE NARRATIVE\*

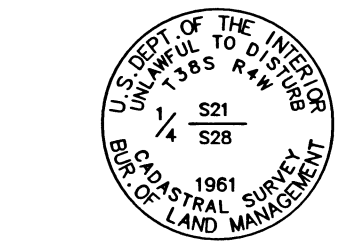

FOUND 3-1/2" BRASS CAP ON 2-1/2" STAINLESS STEEL POST, 0.3' ABOVE GRADE, PER BLM DEPENDENT RESURVEY, APPROVED MARCH 8, 1963

DETAIL "B"  
NOT TO SCALE

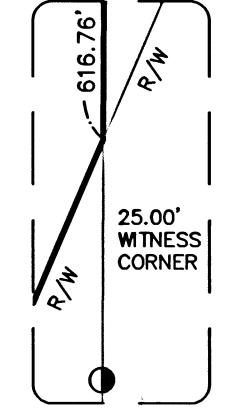

DETAIL "C"  
NOT TO SCALE

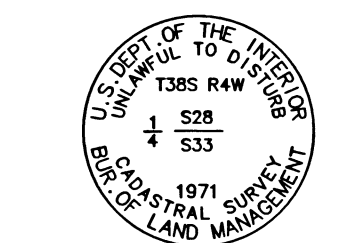
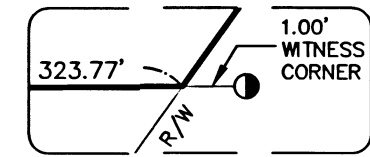

FOUND 3-1/4" BRASS CAP ON 2-1/2" STAINLESS STEEL POST, 0.7' ABOVE GRADE, PER BLM FIELD NOTES, DATED APRIL 2 - OCTOBER 21, 1971

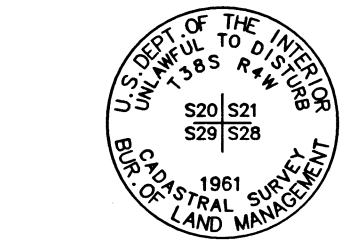

FOUND 3-1/2" BRASS CAP ON 2-1/2" STAINLESS STEEL POST, 0.2' ABOVE GRADE, PER BLM DEPENDENT RESURVEY, APPROVED MARCH 8, 1963

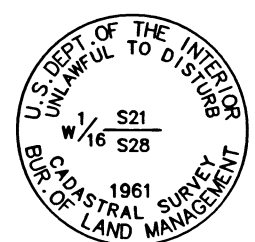

SEE DETAIL "A"

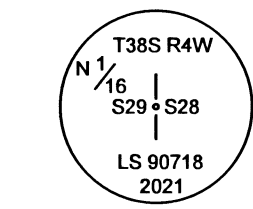

NW 1/16 BEARING TREES SET  
9" OAK BEARS N22W, 64.1'  
24" OAK BEARS N70E, 37.4'

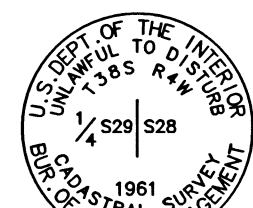

FOUND 3-1/2" BRASS CAP ON 2-1/2" STAINLESS STEEL POST, 0.6' ABOVE GRADE, PER BLM DEPENDENT RESURVEY, APPROVED MARCH 8, 1963

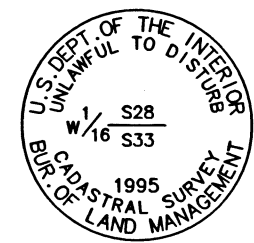

FOUND 3-1/4" BRASS CAP ON 2-1/2" STAINLESS STEEL POST, 0.1' ABOVE GRADE, PER BLM DEPENDENT RESURVEY, APPROVED JULY 7, 1997

**LEGEND**

- BOUNDARY LINE
- ⊕ FOUND 3-1/4" BRASS CAP BUREAU OF LAND MANAGEMENT MONUMENT AS NOTED
- ⊕ FOUND 3-1/2" BRASS CAP BUREAU OF LAND MANAGEMENT MONUMENT AS NOTED
- ⊕ FOUND 1" IRON PIPE, NO CAP, 0.1' ABOVE GRADE PER S/N 4001
- ⊕ SET 5/8" X 30" REBAR WITH 2" ALUMINUM CAP STAMPED AS NOTED
- ⊕ SET 5/8" X 24" REBAR WITH YELLOW PLASTIC CAP STAMPED "DROSSOS LS 90718"
- R/W RIGHT-OF-WAY
- S/N SURVEY NUMBER, FILED IN THE OFFICE OF THE JACKSON COUNTY SURVEYOR, JACKSON COUNTY, OREGON
- (R1) RECORD DATA PER BLM DEPENDENT RESURVEY, APPROVED MARCH 8, 1963
- (R2) RECORD DATA PER S/N 4001
- (R3) RECORD DATA PER S/N 20020

BASIS OF BEARING WAS DETERMINED BY HIGH PRECISION GPS OBSERVATIONS (NAD83 (2011) EPOCH 2010.00 DATUM) APPLIED TO NORTH-SOUTH CENTER SECTION LINE OF SECTION 28 AS SHOWN HEREIN RESULTING IN A BEARING OF S00°15'31"W.

ASSESSOR'S MAP NO. 38 4W 28, TAX LOT 500