

# CORNER INVESTIGATION REPORT

FS INDEX ID: N/A

CORNER: AP 2, LOT 5      GCDB ID: N/A      DATE: 1/15/21  
TOWNSHIP: 40S      STATE: OREGON  
RANGE: 3W      COUNTY: JACKSON  
SECTION: 18      FOREST: ROGUE RIVER-SISKIYOU NF  
MERIDIAN: WILLAMETTE      DISTRICT: SISKIYOU MOUNTAINS RD  
NFSL PROPERTY BOUNDARY CORNER?:     YES     NO

HISTORY OF VISITATIONS:

LINE(S) POSTED:

MAINTAINED:      SOUTH-2020      EAST-2020  
GUARD POST(S):      SOUTH      EAST

CORNER HISTORY:

SET BY BLM IN 1991, BY STEPHEN L. BAROTT

MONUMENT FOUND/SET:

3 1/2" BRASS CAP ON 2 1/2" PIPE, APPROX. 0.1' EXPOSED, IN PILE OF STONES  
GOOD CONDITION

RECORD CORNER ACCESSORIES:

PER BLM NOTES 1991  
 22" DIA PINE (NOW 27") HEALED BLAZE  
 9" DIA OAK (NOW 13") HEALED BLAZE

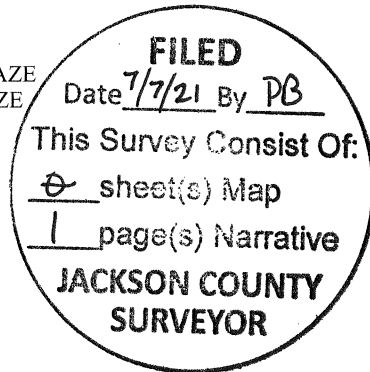

NEW CORNER ACCESSORIES:

NO NEW ACCESSORIES ESTABLISHED

CORNER MAINTENANCE/OTHER INFO:

CLEAR BRUSH FROM AROUND MONUMENT & TO BT'S. BT FACES & A 6" BAND AT  
 HEAD HEIGHT PAINTED RED. ADD NEW NAILS TO BT TAGS & ADD NEW TAGS  
 WHERE NEEDED. MONUMENT SIZES ARE OUTSIDE DIAMETER & BT DIAMETERS  
 ARE AT BREAST HEIGHT.

GEODETTIC COORDINATES:

LATITUDE: N 42°05'19.6"  
LONGITUDE: W 123°06'10.5"  
ELLIPSOID HEIGHT: ~1725  
DATUM: WGS-84

DOCUMENTS ON FILE AT:

SOURCE: CONSUMER GRADE G.P.S.

DATE OF INVESTIGATION: 12/23/20

REPORT BY: JASON MARTIN

FIELD CREW: DENNIS H. MORTON, PARTY CHIEF  
 TOM MILSTEAD, FIELD TECH  
 RYAN BEIL, FIELD TECH

THIS DOCUMENT FILED IN CS OFFICE:  
OTHER DOCUMENT FILED WITH CS:

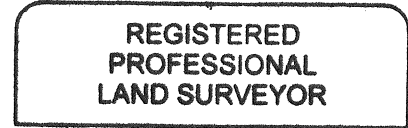

*Jason M. Martin*



RENEWS: 1-1-2023

RECORD MEASUREMENTS:

BEARS S58°W, 121ks (7.9')  
 BEARS N14°W, 46 1/2 lks (30.7')

METHOD OF MEASUREMENT:

CAP DIAGRAM:

