

Record of Monument Preservation – ORS 209.150

For:
Talent Irrigation District
104 West Valley View Road
Talent, OR 97540

Date:
March 8, 2021

Location:
Section 25, Township 39 South, Range 1 East, Willamette Meridian, Jackson County, Oregon Tax Lots 300 and 400.

Purpose:
Monuments established by Surveyor George R. Burrell, RLS 638 during record Survey No. 9719 are subject to potential disturbance and or removal by replacement of a section of irrigation water pipeline replacement.

Procedure:
The position of the three monuments to be referenced were recovered and verified. I established a 5/8 inch diameter, 24 inch long iron pin with yellow plastic cap marked "Center + LS1071" adjacent to the construction area. This monument is situated and North 20° 21' 46" West from the one-quarter corner monument for Section 25, Township 39 South, Range 1 East and Section 30, Township 39 South, Range 2 East, Willamette Meridian, Jackson County, Oregon. I also set a "PK" nail and washer marked LS 1071 in the top northwest corner of a concrete vault (4 foot x 8 foot). The nail bears North 39° 05' 53" East 208.10 from the described iron pin.

The Survey No. 9717 monuments are referenced from the previously established iron pin as follows:

A 5/8 inch diameter iron pin with remains of red plastic flagging attached, bears North 07° 54' 46" West 78.87 feet.

A 5/8 inch diameter iron pin with red plastic cap marked "Burrell + LS 638" bears North 52° 47' 45" West 34.84 feet.

A 5/8 inch diameter iron pin exposed 12-14", firmly set at the base of a concrete irrigation diversion stricture bears South 23° 25' 55" West 55.41 feet.

HAROLD L. CENTER
Professional Land Surveyor
Oregon Certificate No. 1071

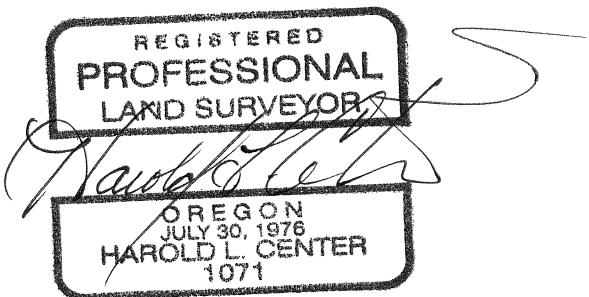

Renews:
12/31/21

(ref:TID_21-4)

