

# RECORD OF MONUMENT PRESERVATION

LOCATED IN THE NORTHEAST 1/4 OF SECTION 18, TOWNSHIP  
37 SOUTH, RANGE 1 WEST, WILLAMETTE MERIDIAN, IN THE  
CITY OF MEDFORD, JACKSON COUNTY, OREGON

**\*\* RECEIVED \*\***  
DATE 11/23/20 BY PB  
This survey consists of:  
1 sheet(s) Map  
0 page(s) Narrative  
JACKSON COUNTY  
SURVEYOR

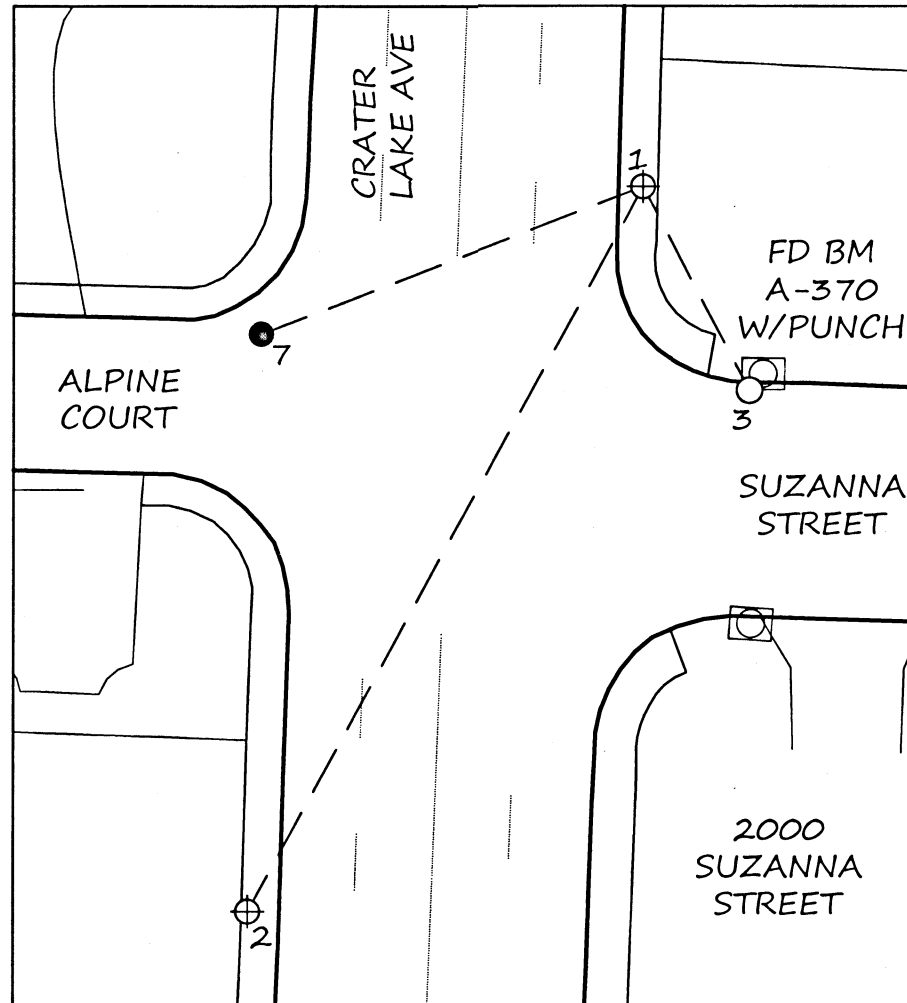

SET UP @ PNT 1  
BACKSIGHT AT PNT 2

PNT	ANGLE RIGHT	HORIZ DIST.	
2	00-00-00	129.10	
3	303-55-07	35.92	
4	<del>332-28-20</del>	<del>73.10</del>	DESTROYED
5	<del>20-32-35</del>	<del>80.12</del>	DESTROYED
7	40-24-45	63.77	
8	<del>46-18-10</del>	<del>61.17</del>	DESTROYED

- ⊗ FOUND CUT "X" IN SIDE WALK PER RECORD OF MONUMENT PRESERVATION 23026
- SET 5/8" REBAR WITH ALUMINUM CAP MARKED "CITY OF MEDFORD" SET IN ASPHALT TO REPLACE FOUND 5/8" REBAR WITH BROKEN CAP FLUSH IN ASPHALT IN RECORD OF MONUMENT PRESERVATION 23026
- FOUND .38 CALIBER SHELLS IN TOP CURB PER CITY OF MEDFORD FIELD BOOK 1641 PG 14, OR AS NOTED



0 30 60  
SCALE 1"=30'

SURVEY NARRATIVE TO COMPLY WITH O.R.S. 209.250

SURVEY FOR/BY: CITY OF MEDFORD, 411 WEST 8TH STREET, MEDFORD, OREGON 97501

DATE OF SURVEY: OCTOBER, 2020

PURPOSE: PURPOSE: IN ACCORDANCE O.R.S. 209.150 THE PURPOSE OF THIS SURVEY IS TO RE-ESTABLISH THE LOCATION OF FOUND MONUMENT (PER SN 10939) REPORTED IN RECORD OF MONUMENT PRESERVATION NUMBER 23026 THAT WAS DESTROYED BY CONCRETE RAMP RECONSTRUCTION. POINT #7 WAS PREVIOUSLY TIED IN SAID SURVEY IS NOW REPLACED WITH 5/8" REBAR WITH ALUMINUM CAP MARKED "CITY OF MEDFORD" SET FLUSH IN PAVEMENT.

EQUIPMENT USED TO PERFORM THIS SURVEY CONSISTED OF UTILIZING A TRIMBLE S6 ROBOTIC TOTAL STATION AND TSC3 DATA COLLECTOR. POINT NUMBERS 4, 5 AND 8 FROM SURVEY 23021 WHERE FOUND TO BE DESTROYED DURING RAMP CONSTRUCTION AS WELL.

REGISTERED  
PROFESSIONAL  
LAND SURVEYOR  
*[Signature]*  
OREGON  
JANUARY 9, 2007  
JON M. PROUD  
77652  
EXPIRES DECEMBER 31, 2020

CITY OF MEDFORD - SURVEYING DEPARTMENT		
CRATER LAKE AVENUE & ALPINE COURT		
DRAWN BY: ZPE	DATE 10/20/2020	PROJECT NO.
CHECKED BY: JP	DATE 10/20/2020	N/A
DATE REFERENCED:	DATE 10/16/20	SHEET NO.
CREW: Z. EARLE, S. METZGER		1 OF 1

371W18AD