

CORNER INVESTIGATION REPORT

FS INDEX ID: B-25

CORNER: N 1/16 GCDB ID: 700660 DATE: 07/17/2020
TOWNSHIP: 32S STATE: OREGON
RANGE: 2E & 3E COUNTY: JACKSON
SECTION: 1 FOREST: ROGUE RIVER-SISKIYOU NF
MERIDIAN: WILLAMETTE DISTRICT: HIGH CASCADES RD
NFSL PROPERTY BOUNDARY CORNER?: YES NO

HISTORY OF VISITATIONS:

LINE(S) POSTED:
MAINTAINED: SOUTH-2020 WEST-2020

GUARD POST(S):

CORNER HISTORY:
 CORNER SET IN 1980, ON FILED SURVEY 8652,(JACKSON COUNTY SURVEYOR'S OFFICE)

**REGISTERED
 PROFESSIONAL
 LAND SURVEYOR**

Jason M. Martin
**OREGON
 MAY 8, 2012
 JASON M. MARTIN
 54729**

RENEWS: 1-1-2021

MONUMENT FOUND/SET:

FOUND 2 1/2" BRASS CAP ON A 2 1/2" PIPE APPROX. 0.6' EXPOSED, SET FIRM, NO STONES, GOOD CONDITION.

RECORD CORNER ACCESSORIES:

PER RECORDED SURVEY 8652:
 35" DIA. D. FIR (NOW 42") HEALED BLAZES, HAS LARGE "CAT FACE" ON N'LY SIDE

 10" DIA. D. FIR DEAD AND ON GROUND

 3/4" IRON PIPE IS 10.7' NORTH AND 1.15' WEST, GOOD CONDITION

RECORD MEASUREMENTS:

BEARS N06°W, 93.6 FEET

NEW CORNER ACCESSORIES:

8" CEDAR BEARS N61°W, 22.0 FEET TO 60D NAIL ON S'LY SIDE OF TREE SCRIBED "N 1/16 S1" "BT" ADDED: BEARING TAG ABOVE PAINTED SCRIBES "DO NOT DISTURB" SIGN OPPOSITE OF SCRIBE FACE.

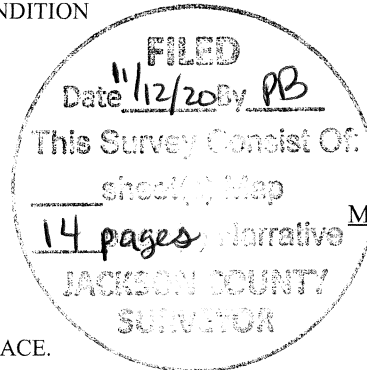

METHOD OF MEASUREMENT:

COMPASS AND TAPE

CORNER MAINTENANCE/OTHER INFO:

CLEAR BRUSH FROM AROUND MONUMENT & TO BT'S. BT FACES & A 6" BAND AT HEAD HEIGHT PAINTED RED. ADD NEW NAILS TO BT TAGS & ADD NEW TAGS WHERE NEEDED. MONUMENT SIZES ARE OUTSIDE DIAMETER & BT DIAMETERS ARE AT BREST HEIGHT.

GEODETTIC COORDINATES:

LATITUDE: N42°49'15.0"
 LONGITUDE: W122°31'15.0"
 ELLIPSOID HEIGHT: ~3117
 DATUM: WGS 84
 SOURCE: CONSUMER GRADE GPS

DOCUMENTS ON FILE AT:

DATE OF INVESTIGATION:

REPORT BY: JASON MARTIN

FIELD CREW: DENNIS H. MORTON, PARTY CHIEF
 TOM MILSTEAD, FIELD TECH

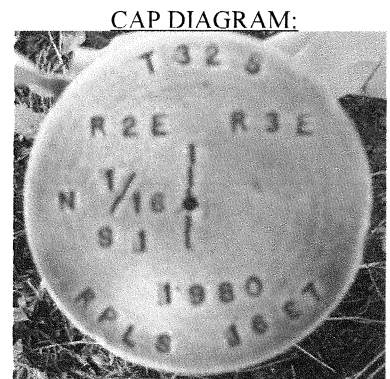

THIS DOCUMENT FILED IN CS OFFICE: YES
OTHER DOCUMENT FILED WITH CS:

CORNER INVESTIGATION REPORT

FS INDEX ID: R-6

CORNER: W 1/16 GCDB ID: 220400 DATE: 07/31/2020
TOWNSHIP: 32S STATE: OREGON
RANGE: 3E COUNTY: JACKSON
SECTION: 20 FOREST: ROGUE RIVER-SISKIYOU NF
MERIDIAN: WILLAMETTE DISTRICT: HIGH CASCADES RD
NFSL PROPERTY BOUNDARY CORNER?: YES NO

HISTORY OF VISITATIONS:LINE(S) POSTED:MAINTAINED: WEST-2020 SOUTH-2020GUARD POST(S):CORNER HISTORY:

MONUMENT WAS SET ON FILED SURVEY 7101 (JACKSON COUNTY SURVEYOR'S OFFICE)

MONUMENT FOUND/SET:

FOUND 2 1/2" BRASS CAP ON 2 1/2" PIPE, APPROX. 0.6' EXPOSED, IN PILE OF STONES, GOOD CONDITION, SET FIRM

RECORD CORNER ACCESSORIES:

PER FILED SURVEY 7101
 14" DIA. FIR (NOW 18") HEALED BLAZES
 9" DIA. FIR (NOW DEAD ON GROUND)

**REGISTERED
 PROFESSIONAL
 LAND SURVEYOR**

Jason M. Martin

**OREGON
 MAY 8, 2012
 JASON M. MARTIN
 54729**

RENEWS: 1-1-2021

RECORD MEASUREMENTS:

BEARS N28°52'W, 5.6 FEET

NEW CORNER ACCESSORIES:

18" DIA. FIR BEARS S14°E, 46.7 FEET, TO 60D NAIL ON W'LY SIDE OF TREE
 SCRIBED "W1/16 S20" "BT"
 ADDED BEARING TAG ABOVE SCRIBES AND "DO NOT DISTURB" SIGN TO
 OPPOSITE SIDE OF BLAZE FACE. 6" RING AND BLAZES PAINTED.

METHOD OF MEASUREMENT:

COMPASS AND TAPE

CORNER MAINTENANCE/OTHER INFO:

CLEAR BRUSH FROM AROUND MONUMENT & TO BT'S. BT FACES & A 6" BAND AT HEAD HEIGHT PAINTED RED. ADD NEW NAILS TO BT TAGS & ADD NEW TAGS WHERE NEEDED. MONUMENT SIZES ARE OUTSIDE DIAMETER & BT DIAMETERS ARE AT BREAST HEIGHT. STACKED MORE STONES AROUND MONUMENT TO PREVENT "WIGGLE".

CAP DIAGRAM:GEODETTIC COORDINATES:

LATITUDE: N42°46'48.1"

LONGITUDE: W122°29'32.3"

ELLIPSOID HEIGHT: ~2745

DATUM: WGS 84

SOURCE: CONSUMER GRADE GPS

DATE OF INVESTIGATION:REPORT BY: JASON MARTIN

FIELD CREW: DENNIS H. MORTON, PARTY CHIEF
 TOM MILSTEAD, FIELD TECH

DOCUMENTS ON FILE AT:

THIS DOCUMENT FILED IN CS OFFICE: YES
OTHER DOCUMENT FILED WITH CS:

CORNER INVESTIGATION REPORT

FS INDEX ID: A-23

CORNER: 1/4 GCDB ID: 640100 DATE: 07/17/2020
TOWNSHIP: 31S & 32S STATE: OREGON
RANGE: 2E COUNTY: JACKSON
SECTION: 36 & 1 FOREST: ROGUE RIVER-SISKIYOU NF
MERIDIAN: WILLAMETTE DISTRICT: HIGH CASCADES RD
NFSL PROPERTY BOUNDARY CORNER?: YES NO

HISTORY OF VISITATIONS:

LINE(S) POSTED:
MAINTAINED: SOUTH-2020
GUARD POST(S):

CORNER HISTORY:
 CORNER SET IN 1980, ON FILED SURVEY 8652,(JACKSON COUNTY SURVEYOR'S OFFICE)

MONUMENT FOUND/SET:
 FOUND 2 1/2" BRASS CAP ON A 2 1/2" PIPE APPROX. 0.5' EXPOSED, SET FIRM, IN SMALL PILE OF STONES, GOOD CONDITION.

RECORD CORNER ACCESSORIES:
 PER RECORDED SURVEY 8652:
 12" DIA. D. FIR (NOW 22") HEALED BLAZES
 12" DIA. D. FIR (NOW 21") HEALED BLAZES

RECORD MEASUREMENTS:

BEARS N26°E, 31.7 FEET
 BEARS S21°E, 26.4 FEET

**REGISTERED
 PROFESSIONAL
 LAND SURVEYOR**

Jason M. Martin

**OREGON
 MAY 8, 2012
 JASON M. MARTIN
 54729**

NEW CORNER ACCESSORIES:
 NO NEW ACCESSORIES ESTABLISHED

METHOD OF MEASUREMENT:
 NO NEW MEASUREMENTS TAKEN.
 FILED AS CONDITION REPORT.

RENEWS: 1-1-2021

CORNER MAINTENANCE/OTHER INFO:
 CLEAR BRUSH FROM AROUND MONUMENT & TO BT'S. BT FACES & A 6" BAND AT HEAD HEIGHT PAINTED RED. ADD NEW NAILS TO BT TAGS & ADD NEW TAGS WHERE NEEDED. MONUMENT SIZES ARE OUTSIDE DIAMETER & BT DIAMETERS ARE AT BREAST HEIGHT.

GEODETIC COORDINATES:
LATITUDE: N42°49'23.0"
LONGITUDE: W122°31'50.3"
ELLIPSOID HEIGHT: ~3467
DATUM: WGS 84
SOURCE: CONSUMER GRADE GPS

DOCUMENTS ON FILE AT:

DATE OF INVESTIGATION:
REPORT BY: JASON MARTIN

FIELD CREW: DENNIS H. MORTON, PARTY CHIEF
 TOM MILSTEAD, FIELD TECH

THIS DOCUMENT FILED IN CS OFFICE: YES
OTHER DOCUMENT FILED WITH CS:

CAP DIAGRAM:

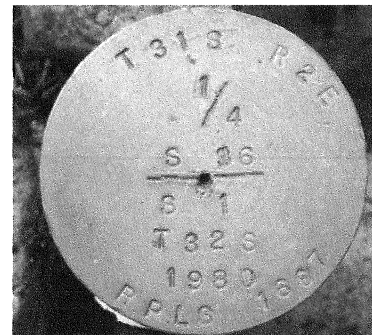

CORNER INVESTIGATION REPORT

FS INDEX ID: W-2

CORNER: NW1/16

GCDB ID: 120160

DATE: 07/17/2020

TOWNSHIP: 31S

STATE: OREGON

RANGE: 3E

COUNTY: JACKSON

SECTION: 31

FOREST: ROGUE RIVER-SISKIYOU NF

MERIDIAN: WILLAMETTE

DISTRICT: HIGH CASCADES RD

NFSL PROPERTY BOUNDARY CORNER?: YES NO

LINE(S) POSTED:

MAINTAINED: SOUTH-2020

GUARD POST(S):

CORNER HISTORY:

CORNER SET IN 1980, ON FILED SURVEY 8652,(JACKSON COUNTY SURVEYOR'S OFFICE)

HISTORY OF VISITATIONS:

REGISTERED
PROFESSIONAL
LAND SURVEYOR*Jason M. Martin*OREGON
MAY 8, 2012
JASON M. MARTIN
54729

RENEWS: 1-1-2021

MONUMENT FOUND/SET:

FOUND 2 1/2" BRASS CAP ON A 2 1/2" PIPE APPROX. 0.2' EXPOSED, SET FIRM, NO STONES, GOOD CONDITION, SOME LETTERING ILLEGIBLE.

RECORD CORNER ACCESSORIES:

PER RECORDED SURVEY 8652:

23" DIA. D. FIR (NOW 29") HEALED BLAZES

22" DIA. D. FIR (NOW 32") HEALED BLAZES

RECORD MEASUREMENTS:

BEARS N33°W, 30.4 FEET

BEARS N66°E, 8.9 FEET

NEW CORNER ACCESSORIES:

NO NEW ACCESSORIES ESTABLISHED

METHOD OF MEASUREMENT:NO NEW MEASUREMENTS TAKEN.
FILED AS CONDITION REPORT.CORNER MAINTENANCE/OTHER INFO:

CLEAR BRUSH FROM AROUND MONUMENT & TO BT'S. BT FACES & A 6" BAND AT HEAD HEIGHT PAINTED RED. ADD NEW NAILS TO BT TAGS & ADD NEW TAGS WHERE NEEDED. MONUMENT SIZES ARE OUTSIDE DIAMETER & BT DIAMETERS ARE AT BREAST HEIGHT.

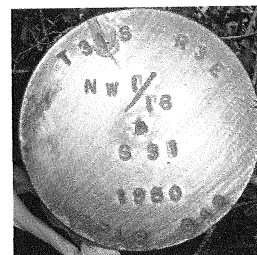
CAP DIAGRAM:GEODETIC COORDINATES:

LATITUDE: N42°50'02.2"

LONGITUDE: W122°30'52.9"

ELLIPSOID HEIGHT: ~3108

DATUM: WGS 84

SOURCE: CONSUMER GRADE GPS

DATE OF INVESTIGATION:

REPORT BY: JASON MARTIN

FIELD CREW: DENNIS H. MORTON, PARTY CHIEF
TOM MILSTEAD, FIELD TECHDOCUMENTS ON FILE AT:THIS DOCUMENT FILED IN CS OFFICE: YES
OTHER DOCUMENT FILED WITH CS:

CORNER INVESTIGATION REPORT

FS INDEX ID: X-2

CORNER: C-W 1/16 GCDB ID: 120140 DATE: 07/08/2020
TOWNSHIP: 31S STATE: OREGON
RANGE: 3E COUNTY: JACKSON
SECTION: 31 FOREST: ROGUE RIVER-SISKIYOU NF
MERIDIAN: WILLAMETTE DISTRICT: HIGH CASCADES RD
NFSL PROPERTY BOUNDARY CORNER?: YES NO

HISTORY OF VISITATIONS:

LINE(S) POSTED:
MAINTAINED: NORTH-2020
GUARD POST(S):

CORNER HISTORY:
 CORNER SET IN 1980, ON FILED SURVEY 8652,(JACKSON COUNTY SURVEYOR'S OFFICE)

**REGISTERED
 PROFESSIONAL
 LAND SURVEYOR**

Jason M. Martin
**OREGON
 MAY 8, 2012
 JASON M. MARTIN
 54729**

MONUMENT FOUND/SET:
 FOUND 2 1/2" BRASS CAP ON A 2 1/2" PIPE FLUSH WITH GROUND, LEANING WESTERLY, WITH SIGN OF IMPACT ON NORTH-EASTERLY SIDE, NEAR 2 STONES.

RENEWS: 1-1-2021

RECORD CORNER ACCESSORIES:
 PER RECORDED SURVEY 8652:
 51" D.FIR (NOW 52") , SCRIBE VISIBLE "CW 1/16 S31"
 10" D. FIR (NOW 15") , HEALED BLAZES

RECORD MEASUREMENTS:
 BEARS N10°W, 10.1 FEET
 BEARS N62°E, 24.4 FEET

NEW CORNER ACCESSORIES:
 NO NEW ACCESSORIES ESTABLISHED

METHOD OF MEASUREMENT:
 NO NEW MEASUREMENTS TAKEN.
 FILED AS CONDITION REPORT.

CORNER MAINTENANCE/OTHER INFO:
 CLEAR BRUSH FROM AROUND MONUMENT & TO BT'S. BT FACES & A 6" BAND AT HEAD HEIGHT PAINTED RED. ADD NEW NAILS TO BT TAGS & ADD NEW TAGS WHERE NEEDED. MONUMENT SIZES ARE OUTSIDE DIAMETER & BT DIAMETERS ARE AT BREAST HEIGHT.

GEODETIC COORDINATES:
 LATITUDE: N42°49'49.1"
 LONGITUDE: W122°30'52.5"
 ELLIPSOID HEIGHT: ~3084
 DATUM: WGS 84
 SOURCE: CONSUMER GRADE GPS
DATE OF INVESTIGATION:

DOCUMENTS ON FILE AT:

REPORT BY: JASON MARTIN
FIELD CREW: DENNIS H. MORTON, PARTY CHIEF
 TOM MILSTEAD, RODMAN

THIS DOCUMENT FILED IN CS OFFICE: YES
OTHER DOCUMENT FILED WITH CS:

CAP DIAGRAM:

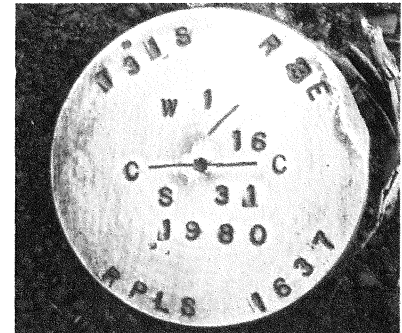

CORNER INVESTIGATION REPORT

FS INDEX ID: Y-25

CORNER: S 1/16 **GCDB ID:** 700120 **DATE:** 07/17/2020
TOWNSHIP: 31S **STATE:** OREGON
RANGE: 2E & 3E **COUNTY:** JACKSON
SECTION: 36 & 31 **FOREST:** ROGUE RIVER-SISKIYOU NF
MERIDIAN: WILLAMETTE **DISTRICT:** HIGH CASCADES RD
NFSL PROPERTY BOUNDARY CORNER?: YES NO

HISTORY OF VISITATIONS:**LINE(S) POSTED:****MAINTAINED:** SOUTH-2020**GUARD POST(S):****CORNER HISTORY:**

CORNER SET IN 1980, ON FILED SURVEY 8652, (JACKSON COUNTY SURVEYOR'S OFFICE)

**REGISTERED
PROFESSIONAL
LAND SURVEYOR**

Jason M. Martin

**OREGON
MAY 8, 2012
JASON M. MARTIN
54729**

RENEWS: 1-1-2021**MONUMENT FOUND/SET:**

FOUND 2 1/2" BRASS CAP ON A 2 1/2" PIPE APPROX. 0.5' EXPOSED, SET FIRM, NO STONES, GOOD CONDITION.

RECORD MEASUREMENTS:BEARS N12°W, 5.8 FEET
BEARS N48°E, 10.2 FEET**RECORD CORNER ACCESSORIES:**PER RECORDED SURVEY 8652:
8" DIA. W. FIR (NOW 18") HEALED BLAZES
8" DIA. W. FIR (NOW 15") HEALED BLAZES, TREE IS DEAD**METHOD OF MEASUREMENT:**

COMPASS AND TAPE

NEW CORNER ACCESSORIES:16" DIA. W. FIR BEARS N79°E, 27.8 FEET
TO 60D NAIL ON N'LY SIDE OF TREE
SCRIBED "S 1/16 S31" "BT"
ADDED: BEARING TAG ABOVE PAINTED SCRIBES
"DO NOT DISTURB" SIGN OPPOSITE OF SCRIBE FACE**CORNER MAINTENANCE/OTHER INFO:**

CLEAR BRUSH FROM AROUND MONUMENT & TO BT'S. BT FACES & A 6" BAND AT HEAD HEIGHT PAINTED RED. ADD NEW NAILS TO BT TAGS & ADD NEW TAGS WHERE NEEDED. MONUMENT SIZES ARE OUTSIDE DIAMETER & BT DIAMETERS ARE AT BREST HEIGHT.

CAP DIAGRAM:**GEODETIC COORDINATES:**

LATITUDE: N42°49'35.9"

LONGITUDE: W122°31'14.8"

ELLIPSOID HEIGHT: ~3501

DATUM: WGS 84

SOURCE: CONSUMER GRADE GPS

DATE OF INVESTIGATION:**REPORT BY:** JASON MARTIN**FIELD CREW:** DENNIS H. MORTON, PARTY CHIEF
TOM MILSTEAD, FIELD TECH**DOCUMENTS ON FILE AT:****THIS DOCUMENT FILED IN CS OFFICE: YES**
OTHER DOCUMENT FILED WITH CS:

CORNER INVESTIGATION REPORT

FS INDEX ID: P-6

CORNER: C-W 1/16 GCDB ID: 220340 DATE: 07/31/2020
TOWNSHIP: 32S STATE: OREGON
RANGE: 3E COUNTY: JACKSON
SECTION: 20 FOREST: ROGUE RIVER-SISKIYOU NF
MERIDIAN: WILLAMETTE DISTRICT: HIGH CASCADES RD
NFSL PROPERTY BOUNDARY CORNER?: YES NO

HISTORY OF VISITATIONS:

**REGISTERED
PROFESSIONAL
LAND SURVEYOR**

Jason M. Martin

**OREGON
MAY 8, 2012
JASON M. MARTIN
54729**

RENEWS: 1-1-2021

LINE(S) POSTED:
MAINTAINED: NORTH-2020
GUARD POST(S):

CORNER HISTORY:
 MONUMENT WAS SET ON FILED SURVEY 7101 (JACKSON COUNTY SURVEYOR'S OFFICE)

MONUMENT FOUND/SET:
 FOUND 2 1/2" BRASS CAP ON 2 1/2" PIPE, APPROX. 0.6' EXPOSED, IN PILE OF STONES, GOOD CONDITION, MONUMENT WILL "WIGGLE" WHEN GRABBED.

RECORD MEASUREMENTS:

RECORD CORNER ACCESSORIES:
 PER FILED SURVEY 7101
 10" FIR (NOW 19.5") HEALED BLAZES
 9" FIR (NOW 21.5") HEALED BLAZES

BEARS S27°58'E, 14.10 FEET
 BEARS S82°32'W, 6.45 FEET

NEW CORNER ACCESSORIES:
 NO NEW ACCESSORIES ESTABLISHED

METHOD OF MEASUREMENT:
 NO NEW MEASUREMENTS TAKEN.
 FILED AS CONDITION REPORT.

CORNER MAINTENANCE/OTHER INFO:
 CLEAR BRUSH FROM AROUND MONUMENT & TO BT'S. BT FACES & A 6" BAND AT HEAD HEIGHT PAINTED RED. ADD NEW NAILS TO BT TAGS & ADD NEW TAGS WHERE NEEDED. MONUMENT SIZES ARE OUTSIDE DIAMETER & BT DIAMETERS ARE AT BREAST HEIGHT. STACKED MORE STONES AROUND MONUMENT TO PREVENT "WIGGLE".

CAP DIAGRAM:



GEODETIC COORDINATES:

DOCUMENTS ON FILE AT:

LATITUDE: N42°46'21.2"
 LONGITUDE: W122°29'36.3"
 ELLIPSOID HEIGHT: ~2680
 DATUM: WGS 84
 SOURCE: CONSUMER GRADE GPS

DATE OF INVESTIGATION:

REPORT BY: JASON MARTIN

FIELD CREW: DENNIS H. MORTON, PARTY CHIEF
 TOM MILSTEAD, FIELD TECH

THIS DOCUMENT FILED IN CS OFFICE: YES
OTHER DOCUMENT FILED WITH CS:

CORNER INVESTIGATION REPORT

FS INDEX ID: B-23

CORNER: C-N 1/16 GCDB ID: 640660 DATE: 07/17/2020
TOWNSHIP: 32S STATE: OREGON
RANGE: 2E COUNTY: JACKSON
SECTION: 1 FOREST: ROGUE RIVER-SISKIYOU NF
MERIDIAN: WILLAMETTE DISTRICT: HIGH CASCADES RD
NFSL PROPERTY BOUNDARY CORNER?: YES NO

HISTORY OF VISITATIONS:

LINE(S) POSTED:

MAINTAINED: NORTH-2020 EAST-2020

GUARD POST(S):

CORNER HISTORY:

CORNER SET IN 1980, ON FILED SURVEY 8652,(JACKSON COUNTY SURVEYOR'S OFFICE)

**REGISTERED
PROFESSIONAL
LAND SURVEYOR**

Jason M. Martin

**OREGON
MAY 8, 2012
JASON M. MARTIN
54729**

RENEWS: 1-1-2021

MONUMENT FOUND/SET:

FOUND 2 1/2" BRASS CAP ON A 2 1/2" PIPE APPROX. 0.6' EXPOSED, SET FIRM, NO STONES, GOOD CONDITION.

RECORD MEASUREMENTS:

BEARS N56°E, 18.5 FEET
BEARS NORTH, 36.1 FEET

RECORD CORNER ACCESSORIES:

PER RECORDED SURVEY 8652:
10" DIA. PACIFIC YEW (NOW 10") SCRIBES VISIBLE "CN 1/16" "S1"
44" DIA. D. FIR (NOW 46") HEALED BLAZES

NEW CORNER ACCESSORIES:

NO NEW ACCESSORIES ESTABLISHED

METHOD OF MEASUREMENT:

NO NEW MEASUREMENTS TAKEN.
FILED AS CONDITION REPORT.

CORNER MAINTENANCE/OTHER INFO:

CLEAR BRUSH FROM AROUND MONUMENT & TO BT'S. BT FACES & A 6" BAND AT HEAD HEIGHT PAINTED RED. ADD NEW NAILS TO BT TAGS & ADD NEW TAGS WHERE NEEDED. MONUMENT SIZES ARE OUTSIDE DIAMETER & BT DIAMETERS ARE AT BREST HEIGHT.

CAP DIAGRAM:



GEODETTIC COORDINATES:

LATITUDE: N42°49'14.9"
LONGITUDE: W122°31'50.3"
ELLIPSOID HEIGHT: ~3302
DATUM: WGS 84
SOURCE: CONSUMER GRADE GPS

DOCUMENTS ON FILE AT:

DATE OF INVESTIGATION:

REPORT BY: JASON MARTIN

FIELD CREW: DENNIS H. MORTON, PARTY CHIEF
TOM MILSTEAD, FIELD TECH

THIS DOCUMENT FILED IN CS OFFICE: YES
OTHER DOCUMENT FILED WITH CS:

CORNER INVESTIGATION REPORT

FS INDEX ID: K-19

CORNER: C-N 1/16 GCDB ID: 540460 DATE: 07/31/2020
TOWNSHIP: 32S STATE: OREGON
RANGE: 2E COUNTY: JACKSON
SECTION: 14 FOREST: ROGUE RIVER-SISKIYOU NF
MERIDIAN: WILLAMETTE DISTRICT: HIGH CASCADES RD
NFSL PROPERTY BOUNDARY CORNER?: YES NO

HISTORY OF VISITATIONS:

LINE(S) POSTED:
MAINTAINED: SOUTH-2020
GUARD POST(S):

CORNER HISTORY:
 MONUMENT WAS SET ON FILED SURVEY 10371 (JACKSON COUNTY SURVEYOR'S OFFICE)

**REGISTERED
 PROFESSIONAL
 LAND SURVEYOR**

Jason M. Martin
**OREGON
 MAY 8, 2012
 JASON M. MARTIN
 54729**

RENEWS: 1-1-2021

MONUMENT FOUND/SET:
 FOUND 2 1/2" BRASS CAP ON A 2 1/2" PIPE, APPROX. 0.4' EXPOSED IN A SMALL PILE OF STONES, SET FIRM, GOOD CONDITION

RECORD CORNER ACCESSORIES:
 PER FILED SURVEY 10371
 7" DIA. WHITE FIR (NOW 15") HEALED BLAZES
 6" DIA. WHITE FIR (NOW 13.5") HEALED BLAZES
 1" GALVANIZED PIPE WITH 2" EXPANDER FILLED WITH POT METAL
 APPROX. 0.2' EXPOSED, SET FIRM, GOOD CONDITION

RECORD MEASUREMENTS:

BEARS S87°38'E, 15.6 FEET
 BEARS S23°31'E, 12.2 FEET
 BEARS N83°37'44"E, 23.81 FEET

NEW CORNER ACCESSORIES:
 NO NEW ACCESSORIES ESTABLISHED

METHOD OF MEASUREMENT:
 NO NEW MEASUREMENTS TAKEN.
 FILED AS CONDITION REPORT.

CORNER MAINTENANCE/OTHER INFO:
 CLEAR BRUSH FROM AROUND MONUMENT & TO BT'S. BT FACES & A 6" BAND AT HEAD HEIGHT PAINTED RED. ADD NEW NAILS TO BT TAGS & ADD NEW TAGS WHERE NEEDED. MONUMENT SIZES ARE OUTSIDE DIAMETER & BT DIAMETERS ARE AT BREAST HEIGHT. RE-STACKED STONES AROUND MONUMENT.

CAP DIAGRAM:



GEODETIC COORDINATES:
LATITUDE: N42°47'19.7"
LONGITUDE: W122°33'00.2"
ELLIPSOID HEIGHT: ~4880
DATUM: WGS 84
SOURCE: CONSUMER GRADE GPS

DOCUMENTS ON FILE AT:

DATE OF INVESTIGATION:
REPORT BY: JASON MARTIN
FIELD CREW: DENNIS H. MORTON, PARTY CHIEF
 TOM MILSTEAD, FIELD TECH

THIS DOCUMENT FILED IN CS OFFICE: YES
OTHER DOCUMENT FILED WITH CS:

CORNER INVESTIGATION REPORT

FS INDEX ID: C-25

CORNER: CC E 1/4

GCDB ID: 700640

DATE: 07/17/2020

HISTORY OF VISITATIONS:

TOWNSHIP: 32S

STATE: OREGON

RANGE: 2E

COUNTY: JACKSON

SECTION: 1

FOREST: ROGUE RIVER-SISKIYOU NF

MERIDIAN: WILLAMETTE

DISTRICT: HIGH CASCADES RD

NFSL PROPERTY BOUNDARY CORNER?: YES NO

LINE(S) POSTED:

MAINTAINED: NORTH-2020

GUARD POST(S):

CORNER HISTORY:

CORNER SET IN 1980, ON FILED SURVEY 8652,(JACKSON COUNTY SURVEYOR'S OFFICE)

**REGISTERED
PROFESSIONAL
LAND SURVEYOR**

Jason M. Martin

**OREGON
MAY 8, 2012
JASON M. MARTIN
54729**

MONUMENT FOUND/SET:

FOUND 2 1/2" BRASS CAP ON A 2 1/2" PIPE APPROX. 0.5' EXPOSED, SET FIRM, NO STONES, GOOD CONDITION.

RENEWS: 1-1-2021

RECORD CORNER ACCESSORIES:

PER RECORDED SURVEY 8652
1962 BLM 3 1/2" BRASS CAP ON 2 1/2" PIPE, SET FIRM, GOOD CONDITION, REFERENCE MONUMENT

RECORD MEASUREMENTS:

BEARS S34°W, 3.0 FEET

BEARS N10°W, 32.3 FEET

BEARS N84°W, 49.0 FEET

12" DIA. HEMLOCK (NOW 14") SCRIBE VISIBLE, HAS DEAD TOP

16" DIA. HEMLOCK HEALED BLAZES, TREE IS DEAD

METHOD OF MEASUREMENT:

COMPASS AND TAPE

NEW CORNER ACCESSORIES:

7" DIA. D. FIR BEARS N06°W, 24.7 FEET
TO 60D NAIL ON W'LY SIDE OF TREE
SCRIBED "1/4 S1" "BT"
ADDED: BEARING TAG ABOVE PAINTED SCRIBES AND ATTACHED
"DO NOT DISTURB" SIGN OPPOSITE OF SCRIBE FACE

CORNER MAINTENANCE/OTHER INFO:

CLEAR BRUSH FROM AROUND MONUMENT & TO BT'S. BT FACES & A 6" BAND AT HEAD HEIGHT PAINTED RED. ADD NEW NAILS TO BT TAGS & ADD NEW TAGS WHERE NEEDED. MONUMENT SIZES ARE OUTSIDE DIAMETER & BT DIAMETERS ARE AT BREST HEIGHT. 16" HEMLOCK (SNAG) WAS NOT PAINTED PER LAND OWNER REQUEST.

CAP DIAGRAM:



GEODETIC COORDINATES:

LATITUDE: N42°49'02.0"

LONGITUDE: W122°31'15.0"

ELLIPSOID HEIGHT: ~3113

DATUM: WGS 84

SOURCE: CONSUMER GRADE GPS

DATE OF INVESTIGATION:

REPORT BY: JASON MARTIN

FIELD CREW: DENNIS H. MORTON, PARTY CHIEF
TOM MILSTEAD, FIELD TECH

DOCUMENTS ON FILE AT:

THIS DOCUMENT FILED IN CS OFFICE: YES

OTHER DOCUMENT FILED WITH CS:

CORNER INVESTIGATION REPORT

FS INDEX ID: L-19

CORNER: C 1/4 GCDB ID: 540440 DATE: 07/31/2020
TOWNSHIP: 32S STATE: OREGON
RANGE: 2E COUNTY: JACKSON
SECTION: 14 FOREST: ROGUE RIVER-SISKIYOU NF
MERIDIAN: WILLAMETTE DISTRICT: HIGH CASCADES RD

HISTORY OF VISITATIONS:

LINE(S) POSTED:
MAINTAINED: NORTH-2020
GUARD POST(S):

**REGISTERED
PROFESSIONAL
LAND SURVEYOR**

Jason M. Martin

**OREGON
MAY 8, 2012
JASON M. MARTIN
54729**

CORNER HISTORY:
MONUMENT WAS SET ON FILED SURVEY 10371 (JACKSON COUNTY SURVEYOR'S OFFICE)

RENEWS: 1-1-2021

MONUMENT FOUND/SET:
FOUND 2 1/2" BRASS CAP ON A 2 1/2" PIPE, APPROX. 1.9' EXPOSED, LEANING WESTERLY ON ROCKY SLOPE. NOT ORIGINAL POSITION. LOOSE AND EASILY MOVED OR REMOVED FROM PILE OF STONES. NEEDS RE-SET

RECORD MEASUREMENTS:

RECORD CORNER ACCESSORIES:
PER FILED SURVEY 10371
15" DIA. DOUGLAS FIR (NOW DEAD SNAG)
20" DIA. CEDAR (NOW 25") HEALED BLAZES
1" GALVANIZED PIPE WITH 2" EXPANDER FILLED WITH POT METAL
APPROX. 1.7' EXPOSED, SET FIRM, GOOD CONDITION

BEARS S13°41'E, 19.5 FEET
BEARS S67°27'W, 10.1 FEET
BEARS S83°28'02"E, 15.67 FEET

NEW CORNER ACCESSORIES:
12" DOUGLAS FIR BEARS S79°E, 34.5' FROM 60D NAIL ON E'LY SIDE OF TREE. SCRIBED "C1/4 S14", "BT"
ADDED BEARING TREE TAG ABOVE SCRIBE, AND "DO NOT DISTURB" SIGN OPPOSITE OF SCRIBE FACE. PAINTED 6" RING AND SCRIBES.

METHOD OF MEASUREMENT:
COMPASS AND TAPE

CORNER MAINTENANCE/OTHER INFO:
CLEAR BRUSH FROM AROUND MONUMENT & TO BT'S. BT FACES & A 6" BAND AT HEAD HEIGHT PAINTED RED. ADD NEW NAILS TO BT TAGS & ADD NEW TAGS WHERE NEEDED. MONUMENT SIZES ARE OUTSIDE DIAMETER & BT DIAMETERS ARE AT BREAST HEIGHT. MONUMENT WAS RE-POSITIONED UPRIGHT, AND RE-SET PER RECORD BEARING TREES.

CAP DIAGRAM:



GEODETIC COORDINATES: DOCUMENTS ON FILE AT:
LATITUDE: N42°47'16.7"
LONGITUDE: W122°33'00.2"
ELLIPSOID HEIGHT: -4776
DATUM: WGS 84
SOURCE: CONSUMER GRADE GPS

DATE OF INVESTIGATION:
REPORT BY: JASON MARTIN
FIELD CREW: DENNIS H. MORTON, PARTY CHIEF
TOM MILSTEAD, FIELD TECH

THIS DOCUMENT FILED IN CS OFFICE: YES
OTHER DOCUMENT FILED WITH CS:

CORNER INVESTIGATION REPORT

FS INDEX ID: Z-1

CORNER: S-W CORNER GCDB ID: 100100 DATE: 07/17/2020
TOWNSHIP: 31S *E 32 S* STATE: OREGON
RANGE: 3E *E 2 E* COUNTY: JACKSON
SECTION: 31 FOREST: ROGUE RIVER-SISKIYOU NF
MERIDIAN: WILLAMETTE DISTRICT: HIGH CASCADES RD
NFSL PROPERTY BOUNDARY CORNER?: YES NO

HISTORY OF VISITATIONS:

**REGISTERED
PROFESSIONAL
LAND SURVEYOR**

Jason M. Martin

**OREGON
MAY 8, 2012
JASON M. MARTIN
54729**

LINE(S) POSTED:
MAINTAINED: NORTH-2020 WEST-2020

GUARD POST(S):
CORNER HISTORY:
 CORNER SET 1962, BY JOSEPH S. GAWRON, CADASTRAL SURVEYOR
 CORNER VISITED IN 1980, ON FILED SURVEY 8652, (JACKSON COUNTY
 SURVEYOR'S OFFICE)
 CORNER VISITED IN 2011, JACKSON COUNTY SURVEYOR'S OFFICE, SECOND
 RE-ESTABLISHMENT

RENEWS: /-1-2021

MONUMENT FOUND/SET:
 FOUND 3 1/2" BLM BRASS CAP ON A 3" PIPE APPROX. 0.4' EXPOSED, SET FIRM, NO
 STONES, GOOD CONDITION.

RECORD CORNER ACCESSORIES:
 PER RECORDED SURVEY 8652:
 22" DIA. FIR (NOW 29") HEALED BLAZES
 18" DIA. W. FIR (NOW 24") HEALED BLAZES
 16" DIA. W. FIR (NOW 25") HEALED BLAZES
 14" DIA. D. FIR (NOW 26") HEALED BLAZES
 STILL NO SUITABLE TREE IN NW QUAD
 PER JACKSON COUNTY SURVEYOR SECOND RE-ESTABLISHMENT
 9" DIA CEDAR "CS" SCRIBE VISIBLE, "BT" VISIBLE

RECORD MEASUREMENTS:

BEARS N06°E, 62.9 FEET
 BEARS S42°W, 22.0 FEET
 BEARS S23°W, 66.5 FEET
 BEARS N28°E, 74.9 FEET

 BEARS S46.5°E, 23.5 FEET

NEW CORNER ACCESSORIES:
 NO NEW ACCESSORIES ESTABLISHED

METHOD OF MEASUREMENT:
 NO NEW MEASUREMENTS TAKEN.
 FILED AS CONDITION REPORT.

CORNER MAINTENANCE/OTHER INFO:
 CLEAR BRUSH FROM AROUND MONUMENT & TO BT'S. BT FACES & A 6" BAND AT
 HEAD HEIGHT PAINTED RED. ADD NEW NAILS TO BT TAGS & ADD NEW TAGS
 WHERE NEEDED. MONUMENT SIZES ARE OUTSIDE DIAMETER & BT DIAMETERS
 ARE AT BREAST HEIGHT.

CAP DIAGRAM:

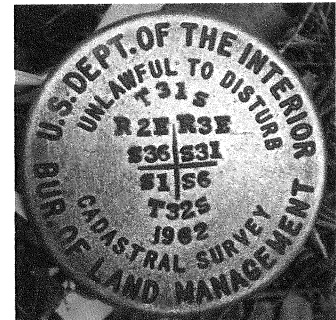

GEODETIC COORDINATES:
 LATITUDE: N42°49'23.1"
 LONGITUDE: W122°31'15.0"
 ELLIPSOID HEIGHT: ~3225
 DATUM: WGS 84
 SOURCE: CONSUMER GRADE GPS

DOCUMENTS ON FILE AT:

DATE OF INVESTIGATION:
REPORT BY: JASON MARTIN
FIELD CREW: DENNIS H. MORTON, PARTY CHIEF
 TOM MILSTEAD, FIELD TECH

THIS DOCUMENT FILED IN CS OFFICE: YES
OTHER DOCUMENT FILED WITH CS: