

MAP OF SURVEY PROPERTY LINE ADJUSTMENT

FILE NUMBER - PLA-20-110

FOR
CLAY & JENNIFER VERBRYCK

SITE:
3600 AND 3602 NORTH PACIFIC HIGHWAY, MEDFORD, OREGON

LOCATED IN THE SOUTHEAST AND SOUTHWEST QUARTER OF SECTION 11,
AND THE NORTHEAST AND NORTHWEST QUARTER OF SECTION 14,
TOWNSHIP 37 SOUTH, RANGE 2 WEST,
WILLAMETTE MERIDIAN,
CITY OF MEDFORD, JACKSON COUNTY, OREGON

FILED
Date 10/15/20 By PH
This Survey Consists Of:
1 sheet(s) Map
2 page(s) Narrative
JACKSON COUNTY
SURVEYOR

DATE: 09-10-2020
SCALE: 1" = 30'

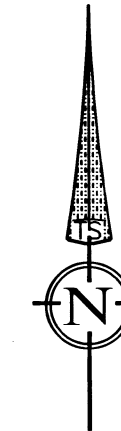

LEGEND

- BOUNDARY LINE
- ORIGINAL BOUNDARY LINE
- FND. 3/4" IRON PIPE 0.2' BELOW ASPHALT PER S/N 7825
- FND. 5/8" IRON PIN PER OREGON STATE HIGHWAY DEPARTMENT DRG. 7B-22-17, OR AS NOTED
- FND. 1/2" IRON PIPE IN CONCRETE PER S/N 7825
- FND. 5/8" IRON PIN WITH YELLOW PLASTIC CAP 0.3' BELOW GRADE, STAMPED "LJ FRIAR & ASSOC" PER S/N 15925
- FND. LEAD PLUG WITH BRASS TAG IN CONCRETE STAMPED "LS 1069" PER S/N 17593
- FND. 5/8" IRON PIN WITH ORANGE PLASTIC CAP FLUSH, STAMPED "HARDEY ENG & ASSOC" PER S/N 18515
- FND. 5/8" REBAR WITH YELLOW PLASTIC CAP STAMPED "HOFFBUHR AND ASSOC, INC" PER S/N 20173
- SET 5/8" X 30" REBAR WITH YELLOW PLASTIC CAP STAMPED "DROSSOS LS 90718"
- SET 5/8" X 24" REBAR WITH YELLOW PLASTIC CAP STAMPED "DROSSOS LS 90718"
- S/N SURVEY NUMBER, ON FILE IN THE OFFICE OF THE JACKSON COUNTY SURVEYOR, JACKSON COUNTY, OREGON
- (R1) RECORD DATA PER S/N 17593
- (R2) RECORD DATA PER S/N 18515

NARRATIVE IS A TWO PAGE SEPARATE DOCUMENT

LINE TABLE		
LINE	BEARING	DISTANCE
L1	S35°08'59"E	5.69'

TAX LOT 4700
ADJUSTED DEED:
INSTRUMENT NO. 2020-037320

TAX LOT 1800
ADJUSTED DEED:
INSTRUMENT NO. 2020-037319

PACIFIC HIGHWAY NO. 99

CITY OF MEDFORD APPROVALS

FILE NO. PLA-20-110

EXAMINED AND APPROVED THIS 5TH DAY OF OCTOBER 2020
BY: [Signature]
CITY OF MEDFORD PLANNING DIRECTOR

EXAMINED AND APPROVED THIS 1ST DAY OF OCT. 2020
BY: [Signature]
CITY OF MEDFORD SURVEYOR

TERRASURVEY, INC.

PROFESSIONAL LAND SURVEYORS

274 FOURTH STREET
ASHLAND, OREGON 97520

(541) 482-6474
terrain@bisp.net

JOB NO. 1253-19

REGISTERED
PROFESSIONAL
LAND SURVEYOR

OREGON
JULY 12, 2016
PHILIP J. DROSSOS
No. 90718

Renewal 12-31-21

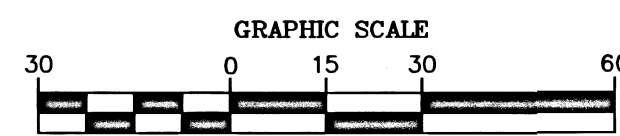

(IN FEET)
1 INCH = 30 FEET

ASSESSOR'S MAP NO., 37 2W 11 DC, TAX LOT 4700
AND 37 2W 14 AB, TAX LOT 1800

BASIS OF BEARING WAS DETERMINED BY HIGH PRECISION GPS
OBSERVATIONS (NAD83 (2011) EPOCH 2010.00) APPLIED TO THE RECOVERED
MONUMENTS AS SHOWN HEREIN RESULTING IN A BEARING OF N35°08'59"W

Survey Number 23164

SURVEY NARRATIVE

TO COMPLY WITH PARAGRAPH 209.250, OREGON REVISED STATUTES

DATE OF SURVEY:

September 10, 2020

SURVEYED BY:

TerraSurvey, Inc.
274 Fourth Street
Ashland, OR 97520

SURVEY FOR:

Clay & Jennifer Verbryck
3600 and 3602 North Pacific Hgwy
Medford, Oregon 97501

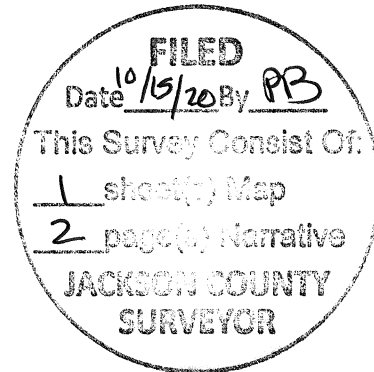

LOCATION:

Located in the Southeast and Southwest Quarter of Section 11 and the Northeast and Northwest Quarter of Section 14 Township 37 South, Range 2 West, Willamette Meridian, City of Medford, Jackson County, Oregon.

PURPOSE:

To survey and monument a property line adjustment of two lots as approved by the City of Medford in File # PLA-20-110.

BASIS OF BEARINGS:

The Basis of Bearings for this survey was determined by high precision GPS observations (NAD83 (2011) Epoch 2010.00) applied to the recovered monuments as shown herein, resulting in a bearing of North 35°08'59" West.

PROCEDURE:

The properties being adjusted are Parcel 1 of Partition Plat No. P-78-2004, filed as survey number 18515, and that tract of land described within Instrument No. 2001-14551 and previously surveyed per survey number 15925. I recovered and tied the monuments as found per said surveys, and held said monuments to control this property line adjustment. The most northwesterly corner was established by holding deed record distance along the easterly right-of-way of Pacific Highway 99 from the found 1/2" iron pipe in concrete as shown herein. The most northeasterly corner was established by holding the record distance and the angle relationship as shown as survey number 15925 from the recovered monuments along the northerly property as shown herein.

MAP OF SURVEY IS A ONE SHEET SEPARATE DOCUMENT

September 10, 2020

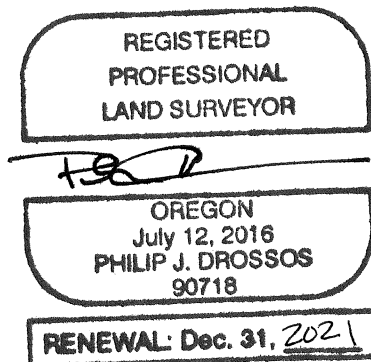

Philip J. Drossos, PLS 90718
TerraSurvey, Inc.
274 Fourth Street
Ashland, OR 97520