

MAP OF SURVEY
 LOCATED IN NE1/4SE1/4 SECTION 9,
 TOWNSHIP 36 SOUTH, RANGE 4 WEST,
 W.M., JACKSON COUNTY, OREGON

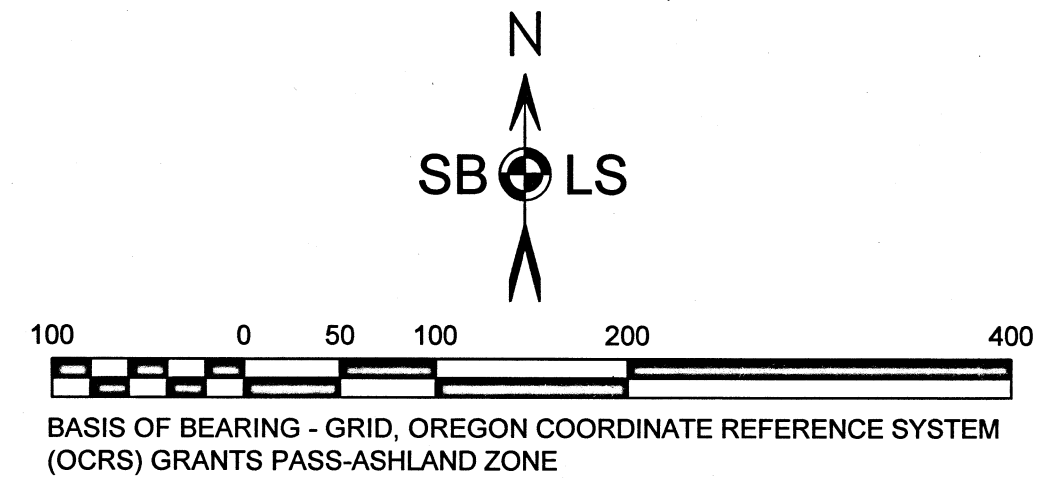

LEGEND

- ACCESS ROAD ROW LIMITS
- BOUNDARY MARKED AND POSETED THIS SURVEY
- CALCULATED LINES
- CALCULATED PLSS POINT- NOTHING FOUND OR SET
- FENCE POST
- CAPPED WELL HEAD- DRY WELL
- COTTON GIN SPINDLE SET
- FOUND IRON PIN AS NOTED- WEST EVANS CR RD ROW
- FOUND IRON PIPE AS NOTED
- FOUND PLSS CORNER POINT AS NOTED
- ACCESS ROAD CENTERLINE POINT
- FOUND UNRECORDED MONUMENT AS NOTED
- FOUND IRON PIN AS NOTED
- CALCULATED POINT- NOTHING FOUND OR SET
- FILED SURVEY NO. JACKSON COUNTY SURVEYOR'S OFFICE
- C.S. 8030 LS 1445 DATED 2 OCT 1979
- C.S. 17657 LS 2724 DATED 18 JAN 2003
- SET 5/8" X 24" IRON PIN WITH GPC
- 1 3/4" GREEN PLASTIC CAP- MORASSE STYLE MARKED



MAP OF SURVEY

DRAWN	DATE	MACKENZIE IVES
SBLS	10-09-2020	MATTHEW RYAN
APPROVED	DATE	1327 WEST EVANS CR RD
		ROGUE RIVER, OR 97537
SCALE	SHEET	PROJECT NO.
1"=100'	1 OF 1	2020-19

SBLS
STEPHAN BAROTT LAND SURVEYING

REGISTERED PROFESSIONAL LAND SURVEYOR <i>Stephan Barott</i>	1446 ST. ANDREW WAY MEDFORD, OR 97504 PHONE: 541-776-1272 CELL: 541-510-8278 e-mail: sbarott@charter.net
OREGON JULY 28, 1988 STEPHAN L. BAROTT 2332 RENEWS: DECEMBER 31, 2021	

**Survey Narrative to Comply with
Oregon Revised Statutes, Paragraph 209.250**

**SURVEYED FOR: MACKENZIE IVES
MATT RYAN**
1327 West Evans Creek Road
Rogue River, Oregon 97537

SURVEYED BY: STEPHAN BAROTT LAND SURVEYING
1446 ST. ANDREW WAY
MEDFORD, OREGON 97504

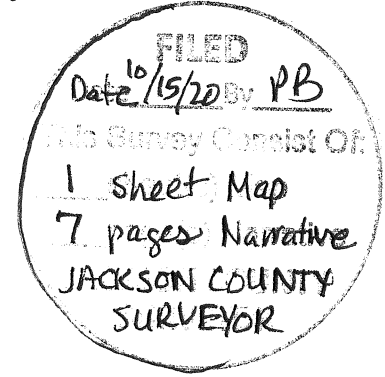

LOCATION: Township 36 South, Range 4 West, Southeast quarter of Section 9, Willamette Meridian, Jackson County, Oregon. (Jackson County Tax Records 364W09-1700)

BASIS OF BEARING: Grid, Oregon Coordinate Reference System (OCRS) Grants Pass-Ashland Zone, per O.A.R. 734-005-0015.

PURPOSE: To survey and mark the boundaries of property described in Document No 2020-014167 as recorded in the Office of the Clerk of Jackson County, Oregon. Secondary purpose is to identify any man made encroachments and locate the existing access roads and driveways.

PROCEDURE: Prior to commencement of this survey, deed records, surveys of record, and a Title Report were evaluated.

This property is described as:

**“THE WEST ONE HALF OF THE SOUTHEAST ONE QUARTER OF THE
NORTHEAST ONE QUARTER OF THE SOUTHEAST ONE QUARTER OF SECTION
9, TOWNSHIP 36 SOUTH, RANGE 4 WEST OF THE WILLAMETTE MERIDIAN IN
JACKSON COUNTY, OREGON.”**

***To paraphrase...EXCEPTING THERFROM THE SOUTHERLY 369 FEET, BEING TWO
PARCELS (160 FEET- TAX LOT 1709) AND (209 FEET -TAX LOT 1708) DEEP AND 330
FEET WIDE.***

Monuments from surveys of record as shown on the Map of Survey were found, verified as marking the true corner points, and accepted for control for the most part. At the South one-sixteenth corner point position for Sections 9 and 10, I found a ½-inch x 24-inch iron pipe buried horizontally. Said pipe does not match the monument of record. Said corner point falls in a cultivated field, five feet south of a wire fence.

I accepted the found iron pin marking the Southeast 1/16 position for Section 9, held the surveyed East line of the Southeast quarter of Section 9, and calculated the position for the South 1/16 corner point.

**Survey Narrative to Comply with
Oregon Revised Statutes, Paragraph 209.250**

Along my clients North boundary, I held the iron pin established for the C-N-SE 1/64th corner and the Witness corner on the Westerly line of West Evans Creek Road as shown on C.S. 8030 and C.S. 17657 as marking the true line.

With the controlling corners found and accepted for control, I computed the subdivision of the Northeast quarter of the Southeast quarter of Section 9.

Near the Southeast corner of Tax Lot 1700, I found encroachments of small wood piles, pallets, and a shed. It also must be noted that other encroachments are evident on Tax Lots 1705, 1701, 1708, and 1709. Those encroachments are not a part of this current survey and were not mapped.

The Ditch and Irrigation as shown on the current Tax Lot map does not represent what is currently being used for irrigation. The current ditch crosses Tax Lot 1702 and 1700 as shown on the Map of Survey.

Shared access is as shown on the Map of Survey and consists of private roads and driveways. The main shared access road from West Fork of Evans Creek Road is described as a 25-foot wide easement, or right-of-way, for the benefit of Tax Lots 1602, 1603, 1700, 1702, 1703, 1708, 1709, and 1801. The driveway from the main access to Tax Lots 1700, 1702, 1708, and 1709 is described as a 20-foot easement of right-of-way. The current centerlines are as shown on the Map of Survey.

Survey grade, network adjusted Geodetic positions for many of the found monuments are on file with this office.

HISTORY OF SURVEYS: The history of surveys of T.36 S., R.4 W. pertaining to this survey is as follows:

1855- Ives & Hyde, U.S. Deputy Surveyors, surveyed the Township and sub-divisional lines. Refer to Contract No. 47 dated July 30, 1855.

1884- The original Serial Patent was issued to Michael Beckenback on April 24, 1884. Refer to Document No. 934 signed by Chester A. Arthur. This 160 acre patent included the Northeast quarter of the Southeast quarter of Section 9 and was granted under the authority of the Homestead Entry of May 20, 1862. No HES survey could be found.

1979- Robert B. Weigand, PLS 1445, surveyed a portion of Section 9 during a Major Land Partition for John Branham. During this survey, Weigand calculated the subdividing of the Southeast quarter of Section 9. Many of the Weigand monuments were found and held for control for this current survey. Refer to C.S. 8030 dated October 2, 1979.

1991- Darrell W. Edwards, PLS 741, surveyed a portion of Section 10. During this survey, Edwards found and mapped the East one-quarter corner and the Southeast Section Corner for Section 9. Refer to C.S. 12429 dated January 31, 1991.

1998- James P. Dickerson, S 2691, Jackson County Roads Department, surveyed a portion of West Evans Creek Road and tied to the Section Corner for Sections 9, 10, 15, and 16. Two monuments established on the Westerly right-of-way line at Engineer's Station 58+00 and 60+00 were found as

**Survey Narrative to Comply with
Oregon Revised Statutes, Paragraph 209.250**

noted. The other monuments established by Dickerson were not searched for but most likely could be recovered if needed. Refer to C.S. 15823 dated July 6, 1998.

1999-Richard L. Bath, Hardy Engineering & Associates, Inc. surveyed a portion of the Southeast quarter of Section 9. During this survey, Bath tied to West Evans Creek Road and to the Section corner for Sections 9, 10, 15, and 16. Refer to C.S. 16133 dated April 23, 1999.

2000- Richard L. Bath, LS 1069, Hardy Engineering & Associates, Inc. surveyed a portion of the Southeast quarter of Section 9. During this survey, Bath tied to West Evans Creek Road, West Lloyelen Drive, and to the Section corner for Sections 9, 10, 15, and 16. Two monuments established and or described by Bath were found and used as references to said Section Corner, which is under two feet of rock and dirt, near a fence corner. Refer to Partition Plat P-12-2000 (C.S. 16430) dated February 28, 2000.

2003- Ray Wytcherley, Is 2724, surveyed a portion of the Northeast quarter of the Southeast quarter of Section 9. Said survey is directly North and adjacent to my clients North line. Wytcherley found several monuments as set or described during C.S. 8030. Refer to C.S. 17657 daterd January 18, 2003.

2017- Mark Heimburger, LS 2287, Land Mark Surveying , Inc., surveyed a portion of the Southwest quarter of Section 10, adjacent to West Evans Creek Road and the South 1/16 corner of Sections 9 and 10. During this survey, Heimburger found the Westerly right-of-way monuments described by the Jackson County Roads Department at Engineer’s Stations 58+00 and 60+00. Heimburger also mapped the West line of the Southwest quarter of Section 10, which is coincident with the East line of the Southeast quarter of Section 9. Refer to C.S. 22250 dated May 9, 2017.

2019-The Bureau of Land Management subdivided a portion of Section 9 and mapped the North-South centerline, establishing a Witness Point north of the Center one-quarter corner. This survey reported finding original monuments at the South, North, and West quarter corner points as well as the Northwest Section corner position. Refer to Special Instructions for Group No. 2907 dated April 4, 2018, and approved by Mary J.M. Hartel, Chief Cadastral Surveyor of Oregon on October 2, 2019.

No other surveys of record that pertain to this current project were found.

ACCESS ROAD TRAVERSE TABLES

SEGMENT A (IVES-RYAN)

MAIN ACCESS ROAD (25 FT EASEMENT)

Station	Northing	Easting	Bearing	Distance
0+00.00	256241.82	207948.40		

SEG A #1

WESTERLY R.O.W. FOR WEST EVANS CREEK ROAD

FROM WHICH, THE NE CORNER FOR TL 1700 BEARS N 66°36'53" W 241.41 FT

**Survey Narrative to Comply with
Oregon Revised Statutes, Paragraph 209.250**

S 87°02'29" W 49.39FT
 0+49.39 256239.27 207899.08 Deflection: 16°52'32" Right
 N 76°04'58" W 29.13FT
 0+78.52 256246.28 207870.80 Deflection: 13°30'45" Right
 N 62°34'14" W 23.73FT
 1+02.25 256257.21 207849.74 Deflection: 03°50'16" Left
 N 66°24'29" W 81.37FT
 1+83.62 256289.77 207775.17 Deflection: 07°28'10" Left
 N 73°52'40" W 50.06FT
 2+33.69 256303.68 207727.07 Deflection: 01°25'37" Right
 ENTER TAX LOT 1700
 FROM WHICH, THE NE CORNER FOR TL 1700 BEARS N 00°25'53" W 33.96 FT

N 72°27'03" W 102.83FT
 3+36.52 256334.68 207629.03 Deflection: 11°40'40" Left
 N 84°07'43" W 25.27FT
 3+61.78 256337.27 207603.89 Deflection: 00°00'01" Left
 ENTER TAX LOT 1602

N 84°07'44" W 71.43FT
 4+33.22 256344.57 207532.83 Deflection: 06°49'24" Left
 ENTER TAX LOT 1603

S 89°02'52" W 23.70FT
 4+56.92 256344.18 207509.14 Deflection: 00°46'58" Left
 SEG B #1
 BEGIN DRIVEWAY FOR 1327 WEST EVANS CR RD (IVES-RYAN), 1333, 1339
 FROM WHICH, THE NW CORNER FOR TL 1700 BEARS S 86°11'27" W 113.53 FT

S 88°15'54" W 46.68FT
 5+03.60 256342.77 207462.48 Deflection: 00°49'25" Right
 S 89°05'19" W 66.67FT
 5+70.27 256341.71 207395.82 Deflection: 00°00'00" Left
 S 89°05'19" W 36.12FT
 6+06.39 256341.13 207359.70 Deflection: 01°00'37" Right
 N 89°54'04" W 77.54FT
 6+83.93 256341.27 207282.16 Deflection: 01°00'46" Left
 S 89°05'10" W 39.25FT
 7+23.18 256340.64 207242.91 Deflection: 00°23'59" Right
 S 89°29'09" W 54.93FT

7+78.11 256340.15 207187.99
 SEG A #2
 BEGIN DRIVEWAY FOR TL1603
 ROAD CONTINUES WESTERLY.

**Survey Narrative to Comply with
Oregon Revised Statutes, Paragraph 209.250**

SEGMENT B (IVES-RYAN)

1327 WEST EVANS CREEK ROAD
20-FOOT EASEMENT

Station	Northing	Easting	Bearing	Distance
4+56.92	256344.18	207509.14		
SEG B #1				
			S 73°02'03" W	16.07FT
4+72.99	256339.49	207493.77	Deflection: 07°38'42" Left	
			S 65°23'20" W	6.18FT
4+79.17	256336.92	207488.15	Deflection: 00°00'06" Left	
ENTER TL 1700				
FROM WHICH, THE NW CORNER FOR TL 1700 BEARS S 89°49'37" W 92.29 FT				

			S 65°23'15" W	17.70FT
4+96.87	256329.54	207472.05	Deflection: 17°59'24" Left	
			S 47°23'51" W	46.61FT
5+43.49	256297.99	207437.75	Deflection: 15°03'22" Left	
			S 32°20'29" W	18.40FT
5+61.88	256282.45	207427.90	Deflection: 04°32'24" Left	
			S 27°48'05" W	13.28FT
5+75.16	256270.71	207421.71		
SEG C #1				
			Deflection: 10°42'24" Left	
IRRIGATION DITCH				
BEGIN DRIVEWAY FOR 1339 WEST EVANS CR RD				
FROM WHICH, THE WITNESS CORNER FOR THE NW CORNER OF TL 1700				
BEARS N 24°50'41" W 61.66 FT				

			S 17°05'41" W	21.09FT
5+96.25	256250.55	207415.51	Deflection: 11°25'12" Left	
			S 05°40'29" W	21.74FT
6+17.99	256228.91	207413.36	Deflection: 06°32'08" Left	
			S 00°51'39" E	23.25FT
6+41.23	256205.67	207413.71	Deflection: 00°24'20" Left	
			S 01°15'59" E	24.28FT
6+65.52	256181.39	207414.25	Deflection: 02°39'43" Right	
			S 01°23'44" W	34.40FT
6+99.92	256147.00	207413.41	Deflection: 00°29'46" Left	
			S 00°53'57" W	40.12FT
7+40.04	256106.89	207412.78	Deflection: 01°10'11" Left	
			S 00°16'14" E	31.89FT
7+71.93	256075.00	207412.93	Deflection: 02°04'07" Right	
			S 01°47'54" W	26.94FT

**Survey Narrative to Comply with
Oregon Revised Statutes, Paragraph 209.250**

7+98.87 256048.07 207412.09

SEG B #2

FROM WHICH, THE SW CORNER FOR TL 1700 BEARS S 89°47'37" W 25.16 FT

Total Length: 341.95FT

SEGMENT C (IVES-RYAN)

20-FOOT EASEMENT

Station	Northing	Easting	Bearing	Distance
---------	----------	---------	---------	----------

5+75.16	256270.71	207421.71		
---------	-----------	-----------	--	--

SEG C #1

S 27°34'24" W 17.23FT

IRRIGATION DITCH

BEGIN DRIVEWAY FOR 1339 WEST EVANS CREEK ROAD

5+92.39	256255.43	207413.74	Deflection: 07°21'34" Right	
---------	-----------	-----------	-----------------------------	--

S 34°55'58" W 18.18FT

6+10.58	256240.52	207403.32	Deflection: 07°58'04" Right	
---------	-----------	-----------	-----------------------------	--

S 42°54'02" W 9.62FT

6+20.19

SEG C #2	256233.48	207396.78		
----------	-----------	-----------	--	--

ENTER TL 1702

Total Length: 45.03FT

MONUMENTS ACCEPTED FOR CONTROL AND ESTABLISHED THIS SURVEY

As shown on the Map of Survey.

Monuments established this survey are 5/8-inch x 24-inch long iron pins with Green Plastic Morasse style cap marked as shown.

BAROTT - SBLS



LS 2332

BOUNDARY MARKER

EQUIPMENT:

**Survey Narrative to Comply with
Oregon Revised Statutes, Paragraph 209.250**

Equipment utilized throughout this survey includes a Leica TCRP-1203 Electronic Total Station and Leica GS14 GNSS RTK GPS Receiver adjusted utilizing Oregon Department of Transportation (ODOT ORGN) GPS network, NAD83(2011) EPOCH 2010.00. Elevations are NAVD88 using Geoid 12A.

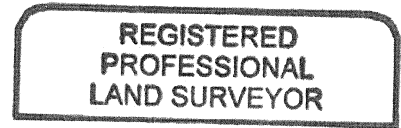

Stephan Barott

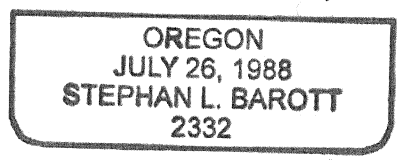

RENEWS: DECEMBER 31, 2021

DATE OF SURVEY: OCTOBER 09, 2020