

MAP OF SURVEY

414 MATSON MILL ROAD PROSPECT, OREGON

FOR
DENNIS AND RENEE WILLIS
414 MATSON MILL ROAD
PROSPECT, OR 97536

LOCATED IN THE SOUTHEAST QUARTER OF SECTION 28
TOWNSHIP 32 SOUTH, RANGE 3 EAST,
WILLAMETTE MERIDIAN,
JACKSON COUNTY, OREGON

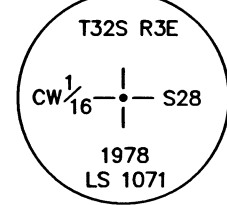

FOUND 2-1/2"
BRASS CAP, 0.4'
ABOVE GRADE, PER
S/N 7306

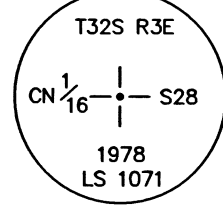

FOUND 2-1/2"
BRASS CAP, 0.4'
ABOVE GRADE, PER
S/N 7306

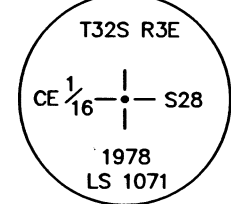

FOUND 2-1/2"
BRASS CAP, 0.4'
ABOVE GRADE, PER
S/N 7306

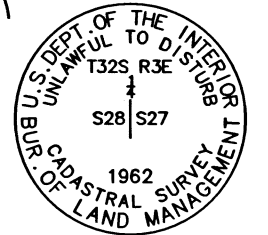

FOUND 3" BRASS
CAP, 0.5' ABOVE
GRADE, PER
JACKSON COUNTY
THIRD RE-ESTAB.

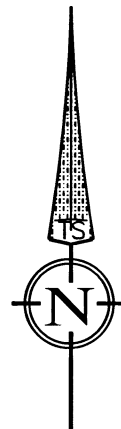

DATE: 08-14-2020
SCALE: 1" = 200'

FND. MONUMENT BEARS
N00°51'17"E, 6.19'
(N01°15'51", 5.92' PER
S/N 14355)

SE 1/16 BEARING TREES SET
10" CEDAR BEARS N50°W 23.3'
SCRIBED "SE 1/16 S28" "BT"

FND. MONUMENT
BEARS
S00°19'15"E, 0.28'

FND. MONUMENT
BEARS
S00°19'15"E, 0.39'

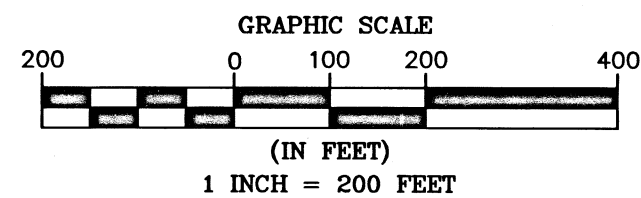

BASIS OF BEARING WAS DETERMINED BY HIGH PRECISION GPS OBSERVATIONS (NAD83 (2011) EPOCH 2010.00 DATUM) APPLIED TO A PORTION OF THE CENTER SECTION LINE OF SECTION 28 AS SHOWN HEREIN RESULTING IN A BEARING OF S89°51'19"E.

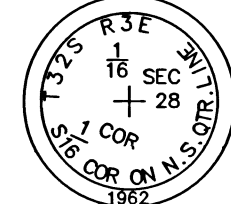

FOUND 1-1/2"
EXPANDER FILLED
WITH LEAD, 0.4'
ABOVE GRADE, PER
S/N 7623

CURVE TABLE					
CURVE #	RADIUS	LENGTH	DELTA	CHORD	BEARING
C1	988.00'	99.16'	5°45'01"	99.12'	N32°50'50"E

DETAIL
SCALE: 1" = 3'

DETAIL
MONUMENT FOUND LEANING
SOUTHERLY AT THE BASE OF A
LARGE FENCE POST BEARS
S19°06'20"W, 0.41'. POSITION
COMPUTED FROM RECORD
REFERENCE MONUMENTS.

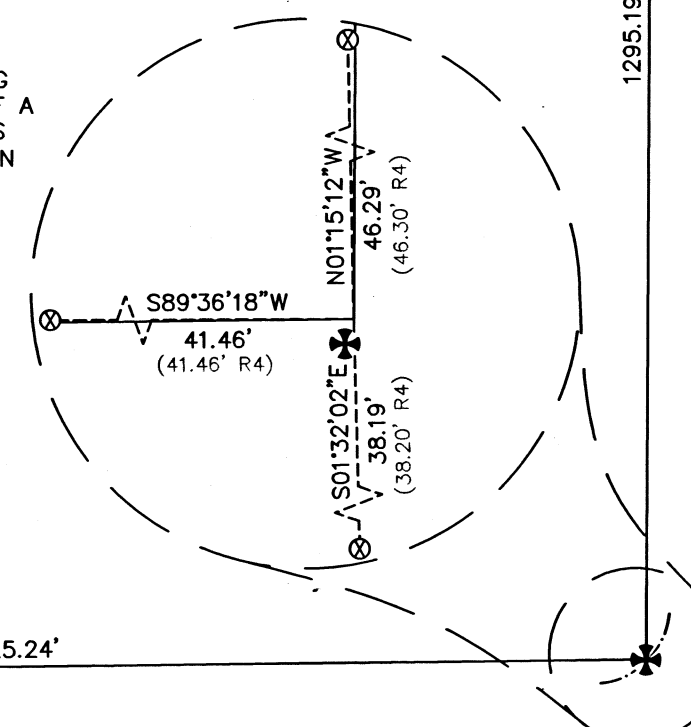

FOUND 2-1/2"
BRASS CAP, 0.2'
ABOVE GRADE, PER
JACKSON COUNTY
THIRD RE-ESTAB.

LEGEND

- BOUNDARY LINE
- - - - - PHYSICAL AS-TRAVELED CENTERLINE OF USFS ROAD #6205 (FORMERLY ROAD #3227) PER VOL. 507 PG. 319, DEED RECORDS FOR JACKSON COUNTY, OREGON
- ⊕ FOUND BRASS CAP MONUMENT PER JACKSON COUNTY RE-ESTAB. AS NOTED
- ⊙ FOUND BRASS CAP MONUMENT PER S/N 7306 OR AS NOTED
- ⊕ FOUND 1" IRON PIPE PER JACKSON COUNTY RE-ESTAB. NOTES AND S/N 2582
- ⊗ FOUND 1" IRON REFERENCE CORNER PIPE PER JACKSON COUNTY SECOND RE-ESTAB NOTES
- ⊕ FOUND 1" IRON PIPE UNKNOWN ORIGIN, SHOWN ON S/N 3465
- ⊙ FOUND 5/8" IRON PIN WITH YELLOW PLASTIC CAP STAMPED "LJ FRIAR & ASSOC" PER S/N 14355
- ⊙ FOUND 5/8" REBAR WITH YELLOW PLASTIC CAP STAMPED "KAISER RLS 803" PER S/N 17729
- ⊙ SET 5/8" X 24" REBAR WITH YELLOW PLASTIC CAP STAMPED "DROSSOS LS 90718"
- S/N SURVEY NUMBER, ON FILE IN THE OFFICE OF THE JACKSON COUNTY SURVEYOR, JACKSON COUNTY, OREGON
- (R1) RECORD DATA PER S/N 7306
- (R2) RECORD DATA PER S/N 14355
- (R3) RECORD DATA PER S/N 15783
- (R4) RECORD DATA PER JACKSON COUNTY SECOND RE-ESTAB NOTES

NARRATIVE IS A SEPARATE
TWO PAGE DOCUMENT

FILED
Date 10/1/20 By PJB
This Survey Consists Of:
1 sheet(s) Map
2 page(s) Narrative
JACKSON COUNTY
SURVEYOR

REGISTERED
PROFESSIONAL
LAND SURVEYOR

OREGON
JULY 12, 2016
PHILIP J. DROSSOS
No. 90718

Renewal 12-31-21

TERRASURVEY, INC.

PROFESSIONAL LAND SURVEYORS

274 FOURTH STREET
ASHLAND, OREGON 97520

(541) 482-6474
terrain@bisp.net

JOB NO. 1362-20

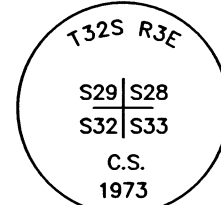

FOUND 2-1/2"
BRASS CAP, IN
MONUMENT CASE, PER
JACKSON COUNTY
FIRST RE-ESTAB.

2650.49'

1325.24'

S89°12'21"W 5300.97' -
(S89°11'44"W 5300.61' R2)(S89°08'49"W 5300.98' R3)

Survey Number 23157

SURVEY NARRATIVE

TO COMPLY WITH PARAGRAPH 209.250, OREGON REVISED STATUTES

DATE OF SURVEY:

August 14, 2020

SURVEYED BY:

TerraSurvey, Inc.
274 Fourth Street
Ashland, OR 97520

SURVEY FOR:

Dennis and Renee Willis
414 Matson Mill Road
Prospect, Oregon 97536

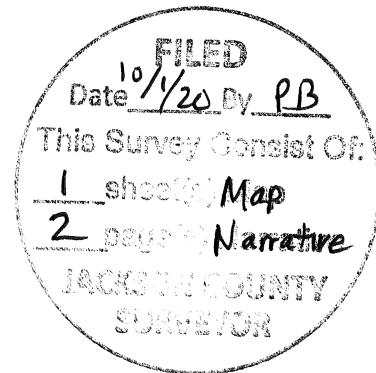

LOCATION:

Located in the Southeast Quarter of Section 28, Township 32 South, Range 3 East, Willamette Meridian, Jackson County, Oregon.

PURPOSE:

To survey and monument that tract of land described in Instrument Number 2011-011059, Jackson County Official Records.

BASIS OF BEARINGS:

The Basis of Bearings for this survey was determined by high precision GPS observations (NAD83 (2011) Epoch 2010.00) applied to a portion of the center section line of Section 28, resulting in a bearing of South 89°51'19" East.

PROCEDURE:

Using a Trimble S-6 robotic total station and Trimble R-10 GPS receivers, I recovered and tied existing monuments of record. During the boundary research for this project, it was realized that the existing South 1/4 corner of Section 28 was in conflict with its computed position if properly established by single proportion methods. A more detailed explanation of the initial discovery of the 1/4 corners position is explained in Survey No. 2582. Survey No. 7306 recognized the conflict and held the existing 1" pipe for the north-south alignment in Section 28, but not for the east-west (south) line of said Section. After researching and reading the narratives of all of the surveys affected by this quandary, I hold the recovered 1" pipe's position in the same manner as shown on Survey No. 7306.

The south line of the subject property is the south line of the Northeast quarter of the Southeast quarter, said Township, Range, and Section. At the location of the Center-South 1/16 corner, I find a 1-1/2" expander as shown on Survey No. 7623. This 1/16 corner appears to have been set using the position of the aforementioned 1" pipe for the South 1/4 corner, and as I did not hold said 1" pipe, I do not hold this monument, but instead hold the proportioned distance as shown on attached Map of Survey. The north line of the subject property is the north line of said quarter-quarter. I hold the found monuments as shown to determine said north line. The easterly line is the easterly right-of-way of U.S. Forest Service Road #3227. The deed centerline location is approximately 30' east of the current physical centerline, and as the original deed states a strip of land 66' in width, being 33' on each side of a centerline as located and constructed on the ground, I tie the physical center line and offset 33' to determine said easterly line. The west line is the west line of said quarter-quarter. I hold the recovered corner monumenting the Center-East 1/16 and the proportioned distance along the south section line for the East 1/16 and set the South-East 1/16 as shown on attached Map of Survey.

MAP OF SURVEY IS A SEPARATE ONE SHEET DOCUMENT

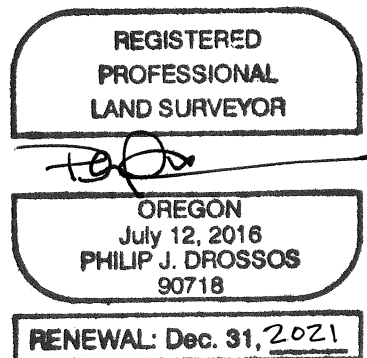

August 14, 2020

Philip J. Drossos, PLS 90718
 TerraSurvey, Inc.
 274 Fourth Street
 Ashland, OR 97520