

**SURVEY NARRATIVE**

THIS SURVEY WAS MADE AS A RESULT OF THE OREGON DEPARTMENT OF TRANSPORTATION'S OR62 CURB RAMP PROJECT. THE PURPOSE OF THIS SURVEY IS TO RECORD THE POSITIONS OF MONUMENTS OF RECORD, RESOLVE THE EXISTING RIGHT OF WAY (R/W) CENTER LINES, AND DEFINE THE EXISTING RIGHT OF WAY LINES AS DIRECTED IN OREGON REVISED STATUTE (ORS)209.155. IN ADDITION, MONUMENTATION WAS SET TO DEFINE RIGHT OF WAY TAKES PREVIOUSLY NEVER MONUMENTED, AND TO AID IN THE PRESERVATION OF CENTERLINES SHOWN HEREON.

**HIGHWAY 62 - 'L2' CENTERLINE**

THE HWY. 62 'L2' CENTERLINE SHOWN HEREON WAS RESOLVED UTILIZING ODOT DRAWING NUMBERS 6B-18-6 & 6B-3-10 AND COUNTY SURVEY NO. 21213, JACKSON COUNTY RECORDS. STATIONING WAS ESTABLISHED BY HOLDING COUNTY SURVEY 21213 BETWEEN STATIONS 'L2' 1712+00 P.O.T.- 'L2' Bk. 1829+99.63 P.I. POINT 1010 WAS HELD TO ESTABLISH THE STATIONING PER ODOT DRAWINGS 6B-18-6 & 6B-3-10 BETWEEN STATIONS 'L2' Ah. 1829+99.35 P.I. - 'L2' Bk. 1906+49.55 P.O.T. POINT 1053 WAS HELD TO ESTABLISH THE STATIONING BETWEEN STATIONS 'L2' Ah. 1906+50.00 - 1964+00.00 P.O.T. (END OF ALIGNMENT). THE GEOMETRY OF THIS CENTERLINE WAS ESTABLISHED UTILIZING THE FOLLOWING FOUND MONUMENTATION:

- 'L2' 1712+00.0 P.O.T. - 'L2' Bk.1829+99.63 P.I. THIS SECTION WAS RESOLVED BY HOLDING POINTS 1000, 1001, AND 1008 SHOWN HEREON TO BE IN COMMON WITH POINTS 1014, 1060 AND 1072 RESPECTIVELY PER SAID COUNTY SURVEY NO. 21213.
- 'L2' Ah. 1829+99.35 P.I. - 'L2' 1865+05.33 P.I. THIS TANGENT WAS RESOLVED BY HOLDING THE SPLIT BETWEEN POINTS 1001 AND 1008, AND THE RECORD OFFSET AT POINT 1010 PER ODOT DRAWING 6B-18-6.
- 'L2' 1865+05.33 P.I. - 'L2' 1941+83.55 P.I. THIS TANGENT WAS RESOLVED BY FINDING MONUMENTS FROM COUNTY SURVEY 15288, JACKSON COUNTY RECORDS, TO EVIDENCE THE ORIGINAL MONUMENTATION AT STATION 'L2' 1878+81.71 P.T. THE RECORD OFFSET FROM THIS CALCULATED POSITION AND THE RECORD OFFSET AT POINT 1121 WERE HELD TO PLACE THE TANGENT. THIS PRODUCED A RESULT WHICH FIT ADDITIONAL ORIGINAL MONUMENTATION AT POINTS 1053 AND 1168 WELL. THE CURVE BETWEEN THE PREVIOUS TWO TANGENTS (HAVING P.I. STATION 1865+05.33) WAS PLACED BY HOLDING THE PRODUCED DELTA AND RECORD DEGREE OF CURVE PER ODOT DRAWING 6B-18-6.
- 'L2' 1941+83.55 P.I. - 1964+00.00 P.O.T. THIS TANGENT WAS RESOLVED AS BEING PARALLEL AND 44 FEET DISTANT FROM THE '6B' ALIGNMENT SHOWN HEREON PER ODOT DRAWING 6B-3-10. THE RESOLUTION OF THE '6B' ALIGNMENT IS SHOWN BELOW. THE CURVE BETWEEN THE PREVIOUS TWO TANGENTS (HAVING P.I. STATION 1941+83.55) WAS PLACED BY HOLDING THE PRODUCED DELTA AND RECORD DEGREE OF CURVE PER ODOT DRAWING 6B-3-10.

**HIGHWAY 62 - '10B' CENTERLINE**

THE HWY. 62 '10B' CENTERLINE SHOWN HEREON WAS RESOLVED UTILIZING ODOT DRAWING NUMBERS 10B-10-5, 10B-10-6 AND COUNTY SURVEY NO. 16586, JACKSON COUNTY RECORDS. STATIONING WAS ESTABLISHED BY HOLDING THE EVENT POINT AT STATION '10B' 1850+02.41 P.S. EQUAL TO THE RECORD STATION (CONVERTED FROM METERS) AS SHOWN ON SAID MAP 10B-10-5. THE GEOMETRY OF THIS CENTERLINE WAS ESTABLISHED UTILIZING THE FOLLOWING FOUND MONUMENTATION:

- '10B' 1838+25.01 P.O.T. - '10B' 1865+14.56 P.I. THIS TANGENT WAS ESTABLISHED BY HOLDING THE RECORD OFFSET AT POINT 1011 AND THE RECORD TANGENT DISTANCE BACK (ALONG THE NEXT DESCRIBED TANGENT) FROM POINT 1122.
- '10B' 1865+14.56 P.I. - '10B' 1943+87.10 P.I. THIS TANGENT WAS ESTABLISHED BY HOLDING THE RECORD OFFSET AT POINTS 1035 AND 1122. THE CURVE BETWEEN THE PREVIOUS TWO TANGENTS (HAVING P.I. STATION 1865+14.56) WAS PLACED BY HOLDING THE PRODUCED DELTA AND RECORD TANGENT DISTANCE PER ODOT DRAWING 10B-10-5.
- '10B' 1943+87.10 P.I. - '10B' 1964+00.00 P.O.T. THIS TANGENT WAS ESTABLISHED BY HOLDING THE PREVIOUS TANGENT, AND APPLYING THE RECORD CURVE INFORMATION PER ODOT DRAWING 10B-10-6. THIS PRODUCED A RESULT WHICH FIT FOUND MONUMENTS FROM SAID SURVEY 16586 WELL.

**HIGHWAY 62 - '6B' CENTERLINE**

THE HWY. 62 '6B' CENTERLINE SHOWN HEREON WAS RESOLVED UTILIZING ODOT DRAWING NUMBER 6B-3-10 AND COUNTY SURVEY NO.22203, JACKSON COUNTY RECORDS. STATIONING WAS ESTABLISHED BY HOLDING POINT 1137. THE GEOMETRY OF THIS CENTERLINE WAS ESTABLISHED UTILIZING THE FOLLOWING FOUND MONUMENTATION:

- '6B' 1953+59.13 P.O.T. - '6B' 2032+01.37 P.I. THIS TANGENT WAS ESTABLISHED BY HOLDING POINTS 1091 AND 1137. THIS PRODUCED A RESULT WHICH FIT FOUND ORIGINAL MONUMENTATION FROM SAID DRAWING 6B-3-10 WELL.
- '6B' 2032+01.37 P.I. - '6B' Bk. 2086+93.12 P.O.T. THIS TANGENT WAS ESTABLISHED BY FIRST UTILIZING FOUND MONUMENTS FROM COUNTY SURVEY NO. 17651 TO CALCULATE THE FOUND ORIGINAL POSITION OF MONUMENTATION AT EVENT STATION '6B' 2045+86.91 P.T. THE OTHER END OF THIS TANGENT WAS ESTABLISHED BY UTILIZING THE RECORD RELATIONSHIP OF POINT 1300, PER SAID SURVEY 22203, AS BEING 100.20'. THE CURVE BETWEEN THE PREVIOUS TWO TANGENTS (HAVING P.I. STATION 2032+01.37) WAS PLACED BY HOLDING THE PRODUCED DELTA AND RECORD DEGREE OF CURVE PER SAID MAP 6B-3-10.

\*IN THE AREA OF THIS RESOLUTION, ODOT SURVEY CREWS ALSO MONUMENTED A CENTERLINE AS SHOWN ON ODOT DRAWING 8B-32-12. THERE WERE RIGHT OF WAY TAKES SHOWN IN THE AREA OF THIS RESOLUTION, HOWEVER THEY WERE NOT PURCHASED IN RELATION TO THE CENTERLINE. FOR UNKNOWN REASONS, THIS CENTERLINE WAS MONUMENTED WITH REBAR AND CAPS, AS WELL AS POSTS AND PADDLES. HOWEVER THESE MONUMENTS WOULD NOT CONTROL THE ORIGINAL '6B' CENTERLINE SHOWN ABOVE. THE POSITIONS OF THESE MONUMENTS WERE REPORTED IN RELATION TO THE '6B' CENTERLINE IN ORDER TO HELP PERPETUATE ITS POSITION SINCE THE '8B' CENTERLINE SERVES NO PURPOSE IN RESOLVING THE RIGHT OF WAY FOR THIS SECTION.

**EAST & WEST LINN RD. - 'FR' CENTERLINE**

THE CENTERLINE OF E LINN RD AND W LINN RD ('FR' CENTERLINE) WAS ESTABLISHED BY CALCULATING THE RECORD CENTERLINE AS SHOWN ON ODOT DRAWING 10B-10-5. THE RECORD STATIONING AND OFFSET AT POINT 1015 WAS HELD AND THE ALIGNMENT WAS ROTATED TO THE RECORD DELTA BETWEEN THE '10B' CENTERLINE AND 'FR' CENTERLINE AS SHOWN ON SAID MAP 10B-10-5. THIS PROVIDED A SOLUTION THAT FIT POINTS 1016 AND 1017 WELL.

**NICK YOUNG RD. - 'NY' CENTERLINE**

THE CENTERLINE OF NICK YOUNG RD ('NY' CENTERLINE) WAS ESTABLISHED BY CALCULATING THE RECORD CENTERLINE AS SHOWN ON ODOT DRAWING 10B-10-5. THE RECORD RELATIONSHIP OF THE DELTA BETWEEN THE '10B' CENTERLINE AND 'NY' CENTERLINE WAS HELD TO ESTABLISH THE BEARING OF THE 'NY' CENTERLINE. THE 'NY' CENTERLINE WAS THEN SLID NORTH/SOUTH ALONG THE '10B' CENTERLINE TO A POINT THAT FIT THE RECORD OFFSET AT POINT 1038. THE 'NY' CENTERLINE WAS THEN SLID EAST WEST ALONG ITS TANGENT TO A POINT THAT FIT POINT 1043. THE RECORD EVENT STATION PRODUCED AT 'NY' 168+89.74 P.C. WAS HELD FOR STATIONING WHICH FIT POINTS 1038 AND 1039 WELL.

**SOUTH SHASTA AVE. - 'SH' CENTERLINE**

THE CENTERLINE OF S SHASTA AVE ('SH' CENTERLINE) WAS ESTABLISHED BY CALCULATING THE RECORD CENTERLINE AS SHOWN ON ODOT DRAWING 10B-10-6. THE RECORD RELATIONSHIP OF THE DELTA BETWEEN THE '10B' CENTERLINE AND 'SH' CENTERLINE WAS HELD TO ESTABLISH THE BEARING OF THE 'SH' CENTERLINE. THE RECORD STATION AND OFFSET AT POINT 1062 WAS THEN HELD TO PLACE THE CENTERLINE.

**SHEET INDEX:**

- 1 SURVEY NARRATIVE, SHEET LAYOUT
- 2 CONTROL NARRATIVE, NETWORK DIAGRAM, SURVEY REFERENCES
- 3-15 SURVEY SHEETS

ASSESSORS MAPS: 361W29B 361W20C 361W20CB 361W20CA 361W20BD 361W20BC 361W20B  
361W20AB 361W17DC 361W17D 361W16C 361W17 361W16B 361W09D 361W09 361W09A  
361W10BB 361W03CC 361W03C 361W03B 361W03BD 361W03BA 351W34 351W34CD

SECS. 33,34 T35S R1W WM  
SECS. 3,4,9,10,16,17,20,29 T36S R1W WM

**\*\* RECEIVED \*\***  
DATE 6/19/2020 BY [Signature]  
This survey consists of:  
15 sheet(s) Map  
0 page(s) Narrative  
JACKSON COUNTY SURVEYOR

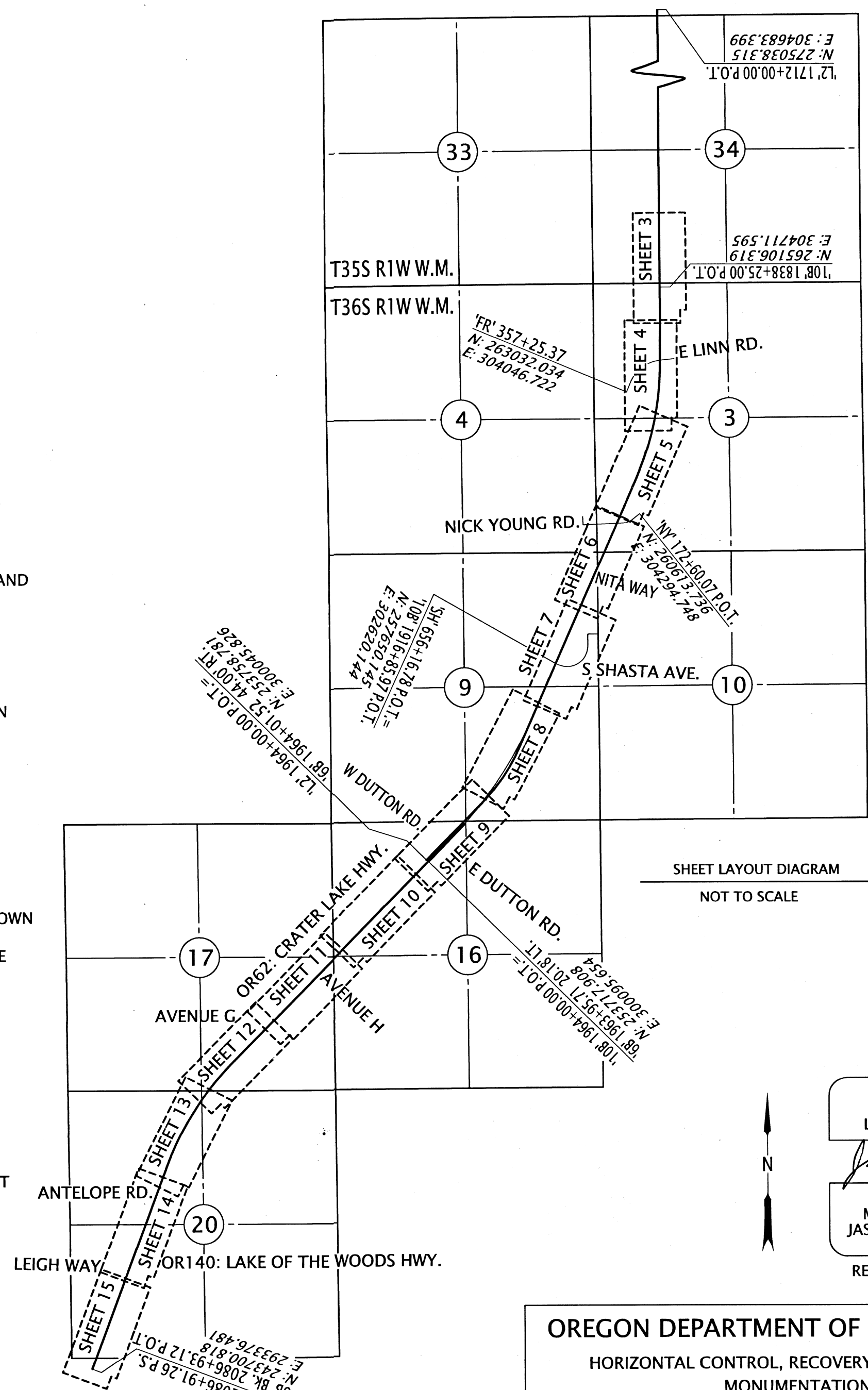

REGISTERED PROFESSIONAL LAND SURVEYOR  
[Signature]  
OREGON  
MARCH 14, 2017  
JASON ROBERT WEISZ  
91618  
RENEWS: 6-30-2020

**OREGON DEPARTMENT OF TRANSPORTATION**  
HORIZONTAL CONTROL, RECOVERY, RETRACEMENT, AND MONUMENTATION MAP  
OR62: CURB RAMP UPGRADES PROJECT  
JACKSON COUNTY

ODOT REGION 3 TECH CENTER  
100 ANTELOPE RD.  
WHITE CITY, OR 97503 KEY NO. 22127

MAY 21, 2019  
SCALE: NTS  
SHEET 1 OF 15

REFERENCE LEGEND

- (R1) RECORD INFORMATION PER COUNTY SURVEY NO. 21213
- (R2) RECORD INFORMATION PER COUNTY SURVEY NO. 16586
- (R3) RECORD INFORMATION PER ODOT DRG. 6B-18-6
- (R4) RECORD INFORMATION PER ODOT DRG. 10B-10-5
- (R5) RECORD INFORMATION PER COMMISSIONERS JOURNAL VOL. 20 PAGES 318,331,332,432
- (R6) RECORD INFORMATION PER COUNTY SURVEY NO. 16887
- (R7) RECORD INFORMATION PER ODOT DRG. 10B-10-6
- (R8) RECORD INFORMATION PER RECORDED DOCUMENT V.272 P.596
- (R9) RECORD INFORMATION PER ODOT DRG. 6B-3-10
- (R10) RECORD INFORMATION PER COUNTY SURVEY NO. 22203
- (R11) RECORD INFORMATION PER COUNTY SURVEY NO. 13652
- (R12) RECORD INFORMATION PER RECORDED DOCUMENT V.324 P.327
- (R13) RECORD INFORMATION PER COUNTY SURVEY NO. 15791
- (R14) RECORD INFORMATION PER COUNTY SURVEY NO. 20249
- (R15) RECORD INFORMATION PER COUNTY SURVEY NO. 4165
- (R16) RECORD INFORMATION PER COUNTY SURVEY NO. 15499
- (R17) RECORD INFORMATION PER RECORDED DOCUMENT D 1973-13472
- (R18) RECORD INFORMATION PER RECORDED DOCUMENT D 1970-05094
- (R19) RECORD INFORMATION PER RECORDED DOCUMENT V.316 P.189
- (R20) RECORD INFORMATION PER "AGATE SUBDIVISION" ON FILE AT THE JACKSON COUNTY SURVEYOR'S OFFICE UNDER SUBD. NO. 006\_127\_R
- (R21) RECORD INFORMATION PER COMMISSIONERS JOURNAL V.182 P.672

CONTROL INFORMATION

SURVEY DATUM- OREGON COORDINATE REFERENCE SYSTEM (OCRS):  
GRANTS PASS - ASHLAND ZONE  
NAD83(2011) EPOCH 2010 (INTERNATIONAL FEET)

EQUIPMENT- THE FIELD WORK FOR THIS PROJECT WAS INITIATED IN DECEMBER OF 2019 AND CARRIED ON INTERMITTENTLY THROUGH MAY OF 2020. 2 LEICA GS14 GNSS RECEIVERS, 1 LEICA CS20 DATA COLLECTOR, 1 LEICA CS15 DATA COLLECTOR, AND 2 LEICA 1200 GPS SYSTEMS WERE UTILIZED TO PERFORM THE FIELD WORK.

CONTROL/FIELD NARRATIVE

A STATIC GPS NETWORK UTILIZING REDUNDANT 2 HOUR OCCUPATIONS WAS PERFORMED TO DERIVE COORDINATES ON POINTS 1083858 AND 2149201. THIS NETWORK WAS PROCESSED AND ADJUSTED UTILIZING A 3D LEAST SQUARES ADJUSTMENT, HOLDING FIXED OREGON REAL TIME GEODETIC NETWORK (ORGN) STATIONS 'CTPT', 'ASHL' AND 'PSPT'. TWO REDUNDANT 20 MINUTE OCCUPATIONS WERE PERFORMED ON POINTS 2019203, T607, 1083812, 1083813, 1083817, 1083818, AND 2149202 WHILE OCCUPYING SAID POINTS 1083858, 2149201 AND STATION DATA FROM CTPT. THIS SUBSEQUENT NETWORK WAS PROCESSED AND ADJUSTED UTILIZING A 3D LEAST SQUARES ADJUSTMENT, HOLDING FIXED THE ORGN VALUE FOR STATION 'CTPT' AND THE PREVIOUSLY ADJUSTED VALUES FOR POINTS 1083858 AND 2149201. THIS PRODUCED A MINIMUM OF 6 INDEPENDENT BASELINES ON EACH POINT.

ALL FOUND MONUMENTATION IN THE 1000 SERIES POINT RANGE WERE TIED UTILIZING 2 REDUNDANT 60 EPOCH GNSS OBSERVATIONS WHILE CONNECTED TO THE ORGN IN ACCORDANCE WITH ODOT'S SURVEY POLICY AND PROCEDURES MANUAL. FOUND MONUMENTS IN THE 2000 SERIES CAME FROM COUNTY SURVEY 22862 FILED BY THIS OFFICE, UNDER MY SEAL, AND IN THE SAME COORDINATE SYSTEM. THE POINT NUMBERS CORRESPOND TO THOSE FROM SAID SURVEY BY SUBTRACTING 1000. THESE POINTS WERE NOT VISITED SINCE THE ORIGINAL TIE, HOWEVER THEIR POSITIONS ARE VALID AS EVIDENCE NONETHELESS.

CONTROL POINTS FOR THIS SURVEY WERE NOT SET ON AND DO NOT REPRESENT PROPERTY OR RIGHT OF WAY LINES AND ARE INTENDED FOR THE USE BY ODOT IN SUPPORT OF THIS AND FUTURE PROJECTS. IT IS NOT THE INTENT OF ODOT TO PERPETUATE THESE CONTROL POINTS AS MONUMENTS.

CONTROL POINT COORDINATE TABLE

PT. NO.	OCRS NORTHING	OCRS EASTING	DATE	DESCRIPTION	REFERENCE DOCUMENT
1083812	253211.09	292759.21	7/25/2017	FD 3" BRASS DISK "OREGON DOT GEODETIC CONTROL PT 1083812"	CS 19957
1083813	253210.62	301306.37	3/18/2020	FD 3" BRASS CAP "OREGON D.O.T. DO NOT DISTURB 10838-13 GEODETIC CONTROL PT."	CS 19957
1083817	259643.15	303551.18	3/18/2020	FD 2-1/2" BRASS CAP "JACKSON COUNTY SURVEYOR T36S R1W 4/3/10/9 REF MON 1999 UNLAWFUL TO DISTURB"	JCS 4TH RE-ESTAB 7/26/199
1083818	261959.54	293394.57	3/18/2020	FD 2" AC "OREGON STATE HWY DIV 1083818 CONTROL POINT"	CS 19957
1083858	243109.01	293076.07	3/18/2020	FD 1" COPPER PLUG "ODOT 1083858"	CS 22813
2019203	245854.18	299616.88	7/24/2018	FD HAMMERSET WITH 1-1/2" ALUM. WASHER "ODOT 20192-03"	CS 22657
2149201	267862.82	308690.64	3/18/2020	FD 2-1/2" BRASS DISK 1/4 COR SEC 34/35	JCS 3RD RE-ESTAB 7/18/17
2149202	269708.25	304653.68	3/18/2020	SET 1" COPPER PLUG "ODOT 21492-02"	-
T607	251803.70	298322.20	3/18/2020	FD 3" BRASS CAP "STATE HIGHWAY DEPARTMENT ELEVATION FEET B.M. NO. T607"	CS 19957
CTPT	228693.68	282775.32	EPOCH 2010.00	ORGN STATION	ORGN STATION

FD=FOUND AC=ALUMINUM CAP  
ORGN=OREGON REAL TIME GEODETIC NETWORK

**\*\* RECEIVED \*\***  
DATE 6/19/2020 BY PO  
This survey consists of:  
15 sheet(s) Map  
8 page(s) Narrative  
JACKSON COUNTY SURVEYOR

GEODETIC CONTROL TABLE - NAD 83(2011) EPOCH 2010.00

PT. NO.	LATITUDE (N)	LONGITUDE (W)	ELL. HT.
1083818	42° 28' 04.09795" N	122° 51' 14.22518" W	1239.14
1083858	42° 24' 57.92239" N	122° 51' 19.88971" W	1227.39
2149201	42° 29' 01.50189" N	122° 47' 49.66101" W	1271.06

SECS. 33,34 T35S R1W WM  
SECS. 3,4,9,10,16,17,20,29 T36S R1W WM

BASIS OF BEARING AND  
CONTROL NETWORK SCHEMATIC  
NOT TO SCALE

CONTROL POINT LEGEND	
	ORGN STATION
	SET GPS CONTROL POINT
	FOUND GPS CONTROL POINT

CONTROL LINE LEGEND	
	STATIC GNSS OBSERVATION LINE
	CENTERLINE

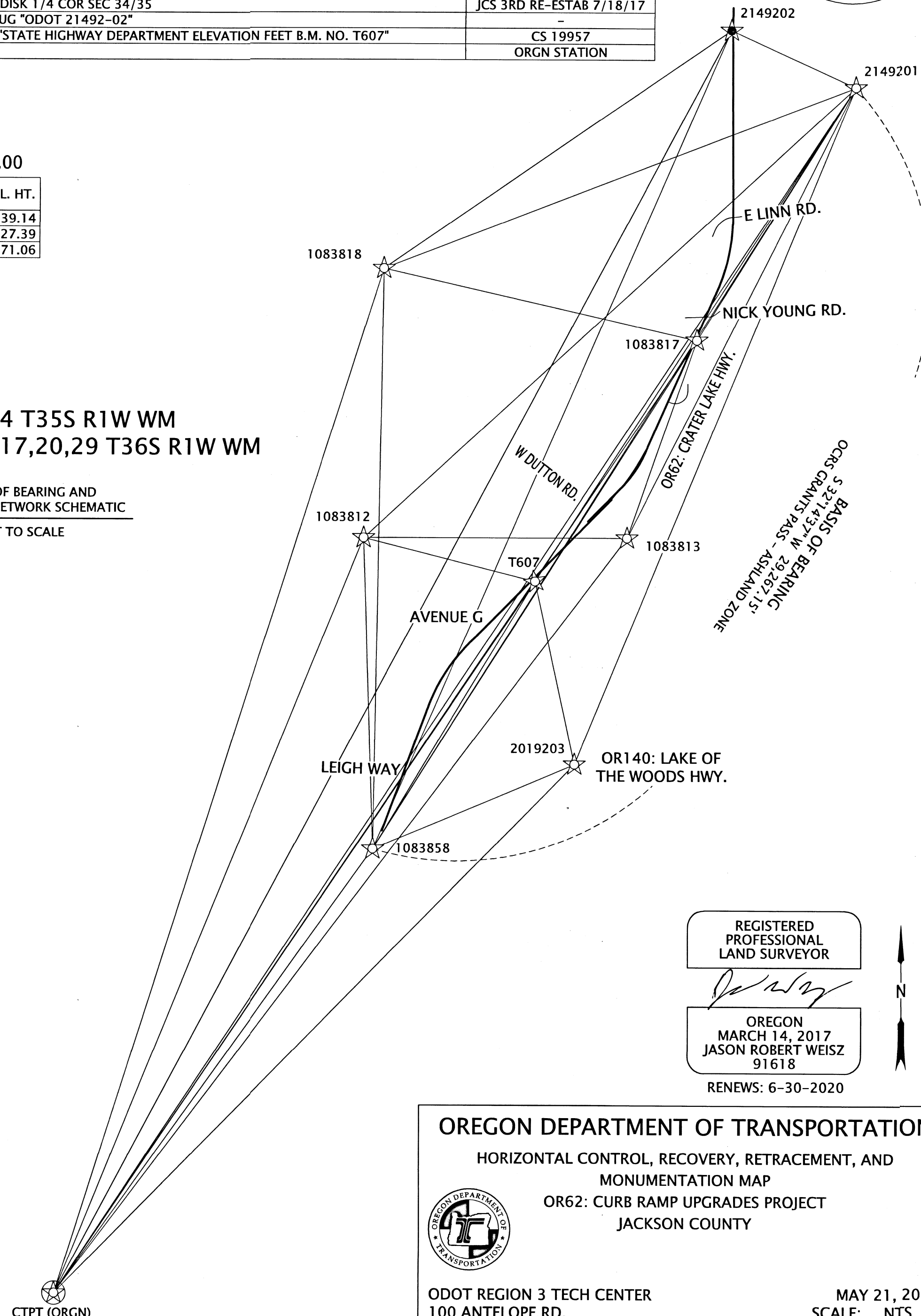

REGISTERED PROFESSIONAL LAND SURVEYOR  
*Jason Robert Weisz*  
OREGON  
MARCH 14, 2017  
JASON ROBERT WEISZ  
91618  
RENEWS: 6-30-2020

**OREGON DEPARTMENT OF TRANSPORTATION**  
HORIZONTAL CONTROL, RECOVERY, RETRACEMENT, AND MONUMENTATION MAP  
OR62: CURB RAMP UPGRADES PROJECT  
JACKSON COUNTY

ODOT REGION 3 TECH CENTER  
100 ANTELOPE RD.  
WHITE CITY, OR 97503 KEY NO. 22127

MAY 21, 2019  
SCALE: NTS  
SHEET 2 OF 15

SW 1/4 SECTION 34 T35S R1W WM NW 1/4 SECTION 3 T36S R1W WM

**\*\* RECEIVED \*\***  
 DATE 6/19/2020 BY JB  
 This survey consists of:  
15 sheet(s) Map  
8 page(s) Narrative  
 JACKSON COUNTY  
 SURVEYOR

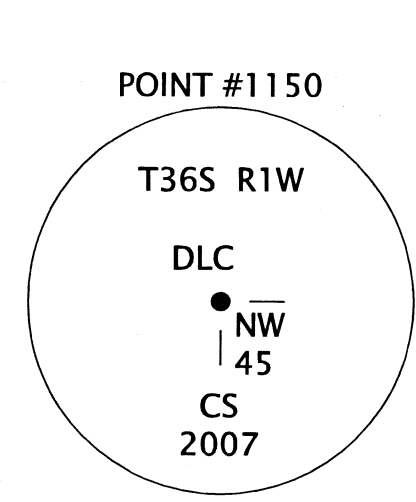
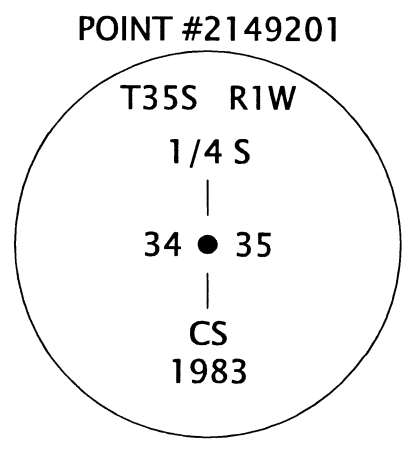

NOTE 1 - RECORD STATION PER CS 21213 CALCULATED BY THE SPLIT OF POINTS 1060 & 1072 SHOWN THEREON  
 WOOLSON TUCKER DLC 40

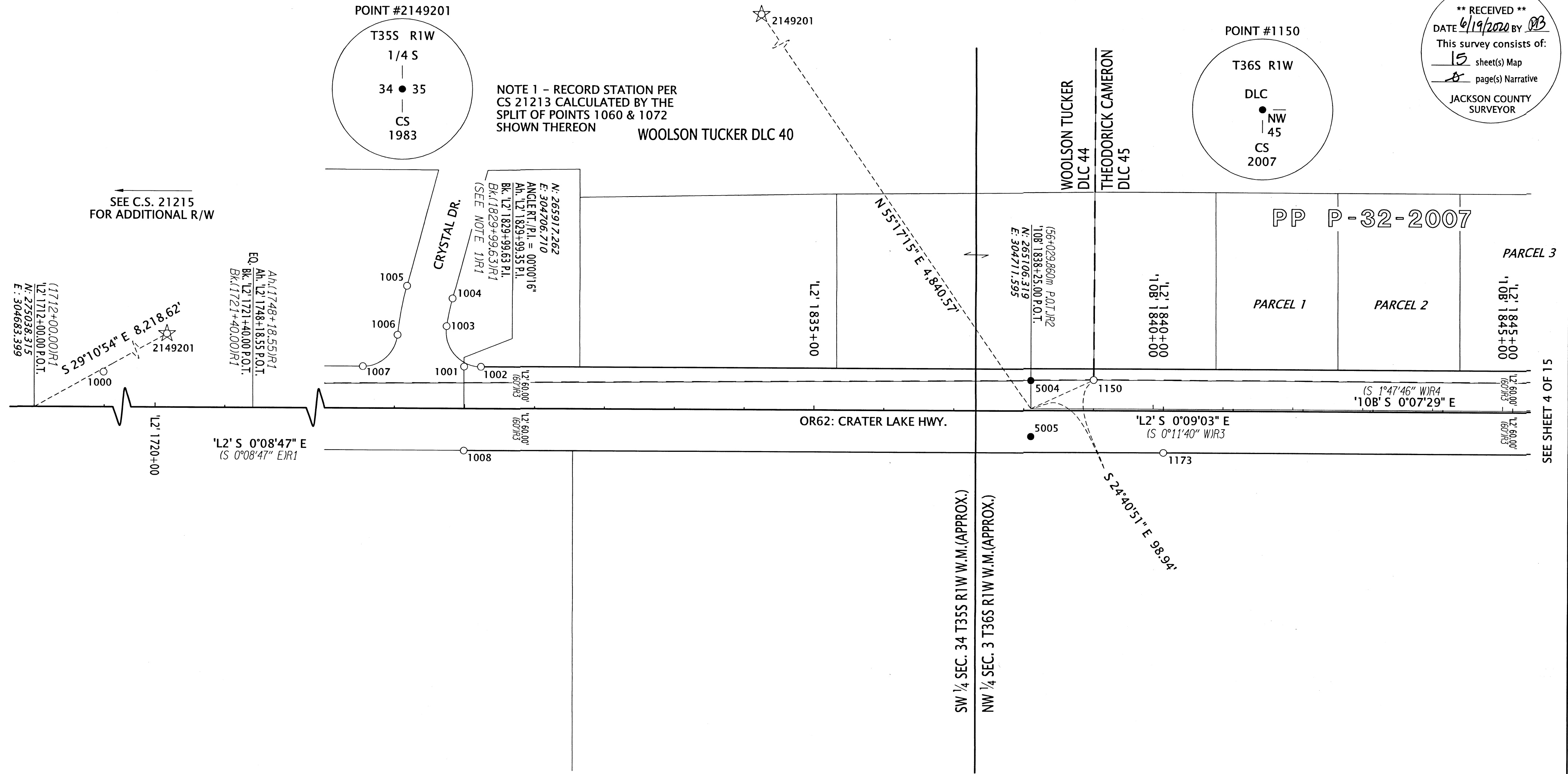

SEE C.S. 21215 FOR ADDITIONAL R/W

SEE SHEET 4 OF 15

SET MONUMENT TABLE

IR=IRON REBAR AC=ALUMINUM CAP

PT. NO.	STATION	OFFSET	OCRS NORTHING	OCRS EASTING	DATE	DESCRIPTION
5004	'108' 1838+25.00	-40.00	265106.41	304751.59	5/21/2020	SET 5/8" X 30" IR w/ AC "ODOT RIGHT OF WAY"
5005	'108' 1838+25.00	40.00	265106.23	304671.59	5/21/2020	SET 5/8" X 30" IR w/ AC "ODOT RIGHT OF WAY"

RECOVERED MONUMENT TABLE

JCS=JACKSON COUNTY SURVEYOR CS=COUNTY SURVEY  
 FD=FOUND IR=IRON REBAR OPC=ORANGE PLASTIC CAP

PT. NO.	STATION	OFFSET	OCRS NORTHING	OCRS EASTING	DATE	DESCRIPTION	REFERENCE DOCUMENT
1000	'L2' 1712+99.04	-50.00	274939.40	304733.65	1/31/2020	FD 5/8" IR	ODOT 68-18-5
1001	'L2' 1829+99.41	-60.21	265917.36	304766.92	1/31/2020	FD 5/8" IR, BENT W'LY, TIED SPIN HOLE	ODOT 68-18-6
1002	'L2' 1830+23.61	-59.99	265893.16	304766.77	1/31/2020	FD IR w/ OPC "HARDEY ENG. & ASSOC."	CS 19925
1003	-	-	265942.72	304824.35	1/31/2020	FD IR w/ OPC "HARDEY ENG. & ASSOC."	CS 19925
1004	-	-	265934.45	304864.02	1/31/2020	FD IR w/ OPC "HARDEY ENG. & ASSOC."	CS 19925
1005	-	-	266000.06	304881.65	1/31/2020	FD IR w/ OPC "HARDEY ENG. & ASSOC."	CS 19925
1006	-	-	266012.83	304811.45	1/31/2020	FD IR w/ OPC "HARDEY ENG. & ASSOC."	CS 19925
1007	'L2' 1828+54.64	-60.01	266062.40	304766.35	1/31/2020	FD IR w/ OPC "HARDEY ENG. & ASSOC."	CS 19925
1008	'L2' 1829+99.58	60.21	265917.16	304646.50	1/31/2020	FD 5/8" IR w/ PADDLE "SHRW 1829+99.58 60.21 RT"	ODOT 68-18-6
1150	'L2' 1839+00.32	-43.83	265016.42	304752.91	2/27/2020	FD BRASS DISK, DLC NW 45	JCS 4TH RE-ESTAB 1/9/07
1173	'L2' 1840+00.12	59.98	264916.34	304649.36	3/5/2020	FD 3/4" IR w/ BLANK PADDLE & 4x4 R/W POST	ODOT 68-18-6
2149201	-	-	267862.82	308690.64	3/18/2020	FD 2-1/2" BRASS DISK 1/4 COR SEC 34/35	JCS 3RD RE-ESTAB 7/18/17

**LEGEND**

- (IR)# SEE SHEET 2 FOR REFERENCE INFORMATION
- SET MONUMENT NOTED IN TABLE
- FOUND MONUMENT NOTED IN TABLE
- ☆ FOUND CONTROL POINT NOTED IN TABLE

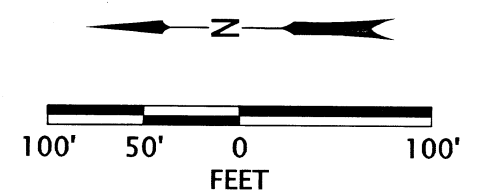

REGISTERED PROFESSIONAL LAND SURVEYOR  
  
 OREGON  
 MARCH 14, 2017  
 JASON ROBERT WEISZ  
 91618  
 RENEWS: 6-30-2020

**OREGON DEPARTMENT OF TRANSPORTATION**  
 HORIZONTAL CONTROL, RECOVERY, RETRACEMENT, AND MONUMENTATION MAP  
 OR62: CURB RAMP UPGRADES PROJECT  
 JACKSON COUNTY

ODOT REGION 3 TECH CENTER  
 100 ANTELOPE RD.  
 WHITE CITY, OR 97503 KEY NO. 22127

MAY 21, 2019  
 SCALE: 1" = 100'  
 SHEET 3 OF 15



NW 1/4 SECTION 3 T36S R1W WM SW 1/4 SECTION 3 T36S R1W WM

**\*\* RECEIVED \*\***  
 DATE 6/19/2020 BY PB  
 This survey consists of:  
15 sheet(s) Map  
8 page(s) Narrative  
 JACKSON COUNTY SURVEYOR

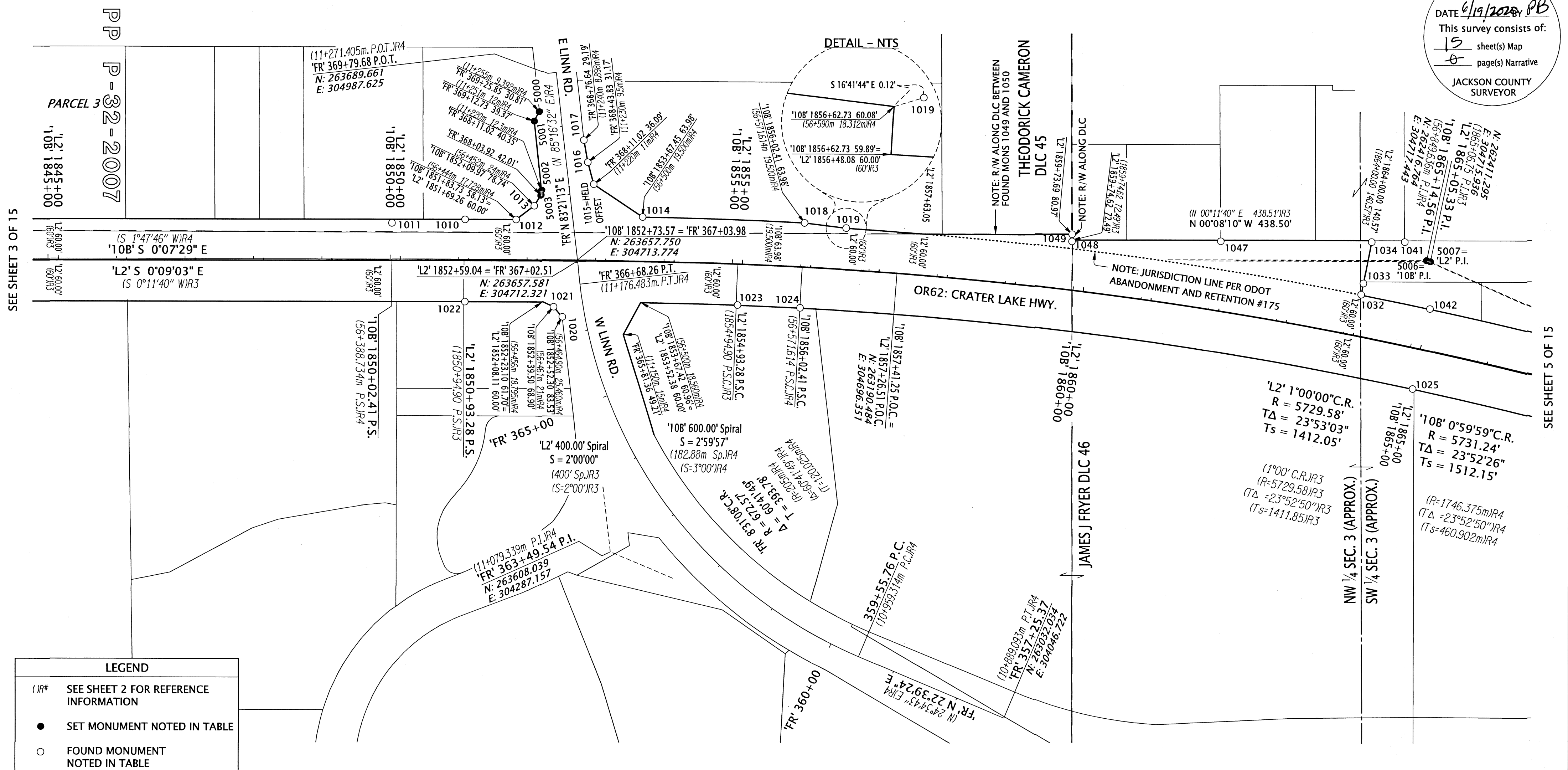

SEE SHEET 3 OF 15

SEE SHEET 5 OF 15

**LEGEND**

( )#	SEE SHEET 2 FOR REFERENCE INFORMATION
●	SET MONUMENT NOTED IN TABLE
○	FOUND MONUMENT NOTED IN TABLE

JCS=JACKSON COUNTY SURVEYOR  
 YPC=YELLOW PLASTIC CAP CS=COUNTY SURVEY  
 FD=FOUND IP=IRON PIPE IR=IRON REBAR AC=ALUMINUM CAP

**RECOVERED MONUMENT TABLE**

PT. NO.	STATION	OFFSET	OCRS NORTHING	OCRS EASTING	DATE	DESCRIPTION	REFERENCE DOCUMENT
1010	'L2' 1850+94.90	-60.00	263821.88	304772.22	2/4/2020	FD IR w/ AC "OREGON STATE... ", 2.3' DN	ODOT 6B-18-6
1011	'10B' 1850+02.54	-52.49	263928.90	304766.65	2/4/2020	FD IR w/ AC "OTAK INC."	CS 16586
1012	'L2' 1851+69.40	-59.96	263747.30	304772.35	2/4/2020	FD IR w/ AC "OTAK INC."	CS 16586
1013	'10B' 1852+10.16	-78.59	263720.84	304792.76	2/4/2020	FD IR w/ AC "OTAK INC."	CS 16586
1014	'10B' 1853+67.55	-63.96	263562.68	304776.54	2/4/2020	FD IR w/ AC "OTAK INC."	CS 16586
1015	'10B' 1852+95.89	-110.71	263634.29	304824.27	2/4/2020	FD IR w/ AC "OTAK INC."	CS 16586
1016	'10B' 1852+86.95	-142.69	263643.00	304856.34	2/4/2020	FD IR w/ AC "OTAK INC."	CS 16586
1017	'10B' 1852+80.97	-174.98	263648.76	304888.69	2/4/2020	FD IR w/ AC "OTAK INC."	CS 16586
1018	'10B' 1856+02.45	-64.00	263325.81	304768.91	2/10/2020	FD IR w/ AC "OTAK INC."	CS 16586
1019	'10B' 1856+62.84	-60.12	263265.07	304761.66	2/10/2020	FD IR w/ AC "OTAK INC."	CS 16586
1020	'10B' 1852+52.60	83.48	263679.31	304630.46	2/10/2020	FD IR w/ AC "OTAK INC."	CS 16586
1021	'10B' 1852+39.62	68.96	263692.12	304645.07	2/10/2020	FD SCREW w/ TAG "OTAK INC."	CS 16586
1022	'L2' 1850+94.84	59.97	263821.63	304652.25	2/4/2020	FD 5/8" IR, BENT 'E/LY, TIED SPIN HOLE	ODOT 6B-18-6
1023	'L2' 1854+95.25	59.82	263423.36	304648.77	2/11/2020	FD 5/8" IR, 2.2' DN	ODOT 6B-18-6
1024	'10B' 1856+02.55	59.98	263331.93	304645.08	2/11/2020	FD IR w/ AC "OTAK INC.", LEANING E	CS 16586
1025	'10B' 1865+15.75	58.56	262436.54	304529.58	2/11/2020	FD 5/8" IR, BENT N, TIED SPIN HOLE	CS 16586
1032	'L2' 1863+99.95	-60.47	262511.82	304667.31	2/11/2020	FD 5/8" IR w/ BROKEN YPC, 1.2' DN	CS 18576
1033	'L2' 1863+99.93	-77.14	262508.68	304683.69	2/11/2020	FD IR w/ YPC "KAISER RLS 803", 1.3' DN	CS 18576
1034	'L2' 1863+99.92	-138.50	262497.07	304743.93	2/11/2020	FD 5/8" IR	ODOT 6B-18-6
1041	-	-	262448.72	304744.23	2/11/2020	FD 3/4" IP	CS 38
1042	'10B' 1865+15.84	-61.59	262411.46	304647.08	2/11/2020	FD IR w/ AC "OTAK INC."	CS 16586
1047	'L2' 1861+87.04	-100.79	262717.63	304743.96	2/12/2020	FD 5/8" IR	CS 17129
1048	'L2' 1859+74.77	-70.53	262935.18	304742.95	2/12/2020	FD IR w/ YPC "LJ FRIAR & ASSOC", LEANING N	CS 17129
1049	'L2' 1859+73.69	-80.97	262935.05	304753.44	2/12/2020	FD 3" BRASS DISK w/ CROSS PUNCH	JCS 3RD RE-ESTAB 3/4/97

**SET MONUMENT TABLE**

PT. NO.	STATION	OFFSET	OCRS NORTHING	OCRS EASTING	DATE	DESCRIPTION
5000	'FR' 369+25.85	-30.81	263714.04	304930.59	5/21/2020	SET 1" COPPER PLUG "ODOT"
5001	'FR' 369+12.73	-39.37	263721.02	304916.57	5/21/2020	SET 5/8" X 30" IR w/ AC "ODOT RIGHT OF WAY"
5002	'FR' 368+11.02	-40.35	263710.22	304815.43	5/21/2020	SET 5/8" X 30" IR w/ AC "ODOT RIGHT OF WAY"
5003	'FR' 368+03.92	-42.01	263711.05	304808.18	5/21/2020	SET 5/8" X 30" IR w/ AC "ODOT RIGHT OF WAY"
5006	'10B' 1864+96.45	-129.35	262416.76	304717.44	5/21/2020	SET 5/8" X 30" IR w/ AC "ODOT RIGHT OF WAY"
5007	'L2' 1864+87.49	-127.94	262411.29	304715.94	5/21/2020	SET 5/8" X 30" IR w/ AC "ODOT RIGHT OF WAY"

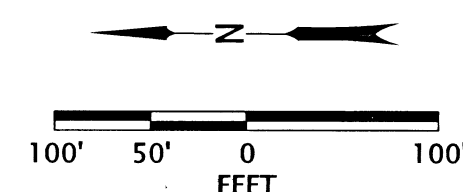

REGISTERED PROFESSIONAL LAND SURVEYOR  
  
 OREGON  
 MARCH 14, 2017  
 JASON ROBERT WEISZ  
 91618  
 RENEWS: 6-30-2020

**OREGON DEPARTMENT OF TRANSPORTATION**  
 HORIZONTAL CONTROL, RECOVERY, RETRACEMENT, AND MONUMENTATION MAP  
 OR62: CURB RAMP UPGRADES PROJECT  
 JACKSON COUNTY

ODOT REGION 3 TECH CENTER  
 100 ANTELOPE RD.  
 WHITE CITY, OR 97503 KEY NO. 22127

MAY 21, 2019  
 SCALE: 1" = 100'  
 SHEET 4 OF 15

NW 1/4 SECTION 3 T36S R1W WM SW 1/4 SECTION 3 T36S R1W WM

**\*\* RECEIVED \*\***  
 DATE 6/19/20 BY PB  
 This survey consists of:  
 15 sheet(s) Map  
 0 page(s) Narrative  
 JACKSON COUNTY SURVEYOR

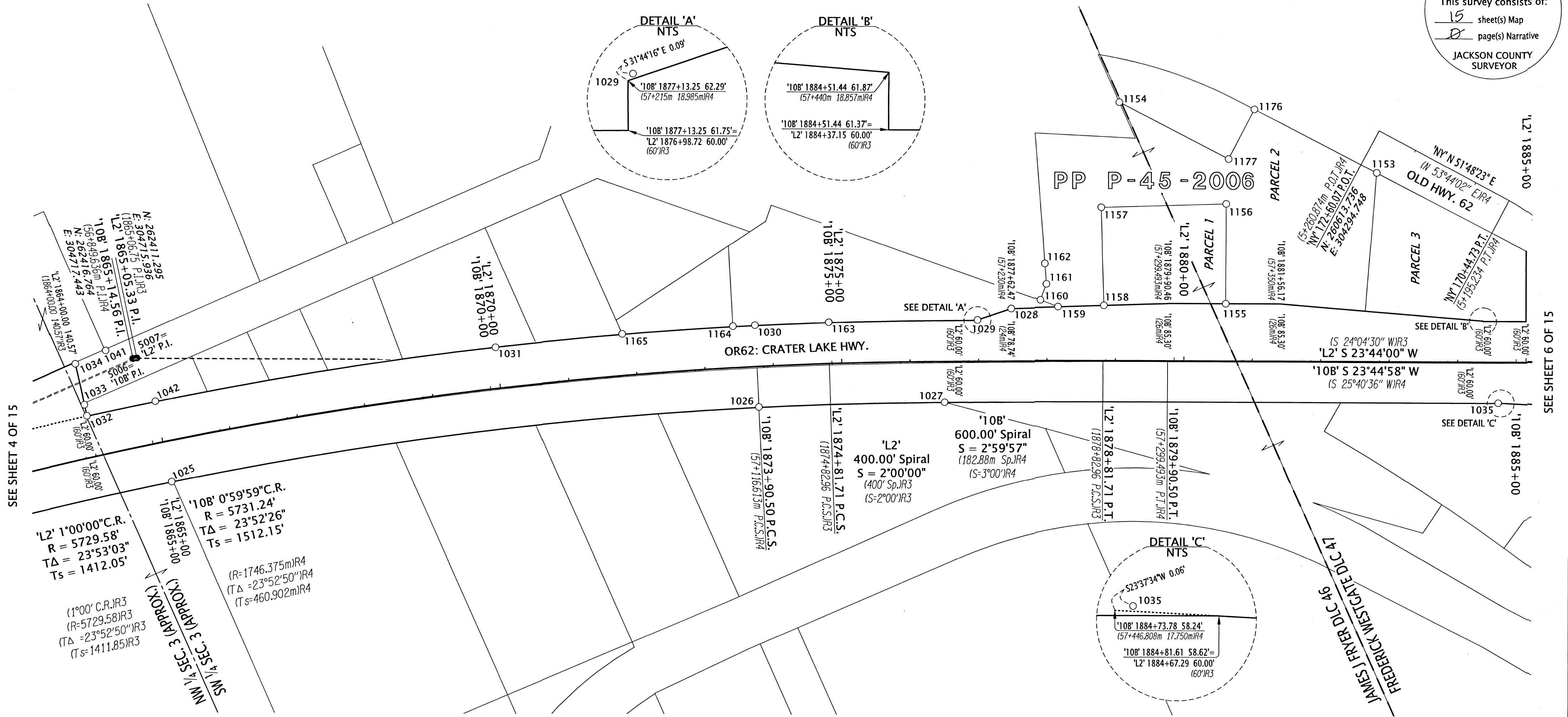

SEE SHEET 4 OF 15

SEE SHEET 6 OF 15

RECOVERED MONUMENT TABLE

PT. NO.	STATION	OFFSET	OCRS NORTHING	OCRS EASTING	DATE	DESCRIPTION	REFERENCE DOCUMENT
1034	'L2' 1863+99.92	-138.50	262497.07	304743.93	2/11/2020	FD 5/8" IR	ODOT 68-18-6
1025	'108' 1865+15.75	58.56	262436.54	304529.58	2/11/2020	FD 5/8" IR, BENT N, TIED SPIN HOLE	CS 16586
1026	'108' 1873+90.50	57.24	261606.20	304286.91	2/11/2020	FD IR w/ AC "OTAK INC."	CS 16586
1027	'L2' 1876+49.95	59.64	261354.54	304185.19	2/11/2020	FD IR w/ YPC "FARBER PLS 2189"	CS 19680
1028	'108' 1877+62.47	-78.82	261210.42	304272.14	2/11/2020	FD 5/8" IR, LEANING W	CS 16586
1029	'108' 1877+13.30	-62.36	261262.33	304276.49	2/11/2020	FD IR w/ AC "OTAK INC."	CS 16586
1030	'108' 1873+90.55	-62.81	261563.62	304399.16	2/11/2020	FD IR w/ AC "OTAK INC."	CS 16586
1031	'L2' 1869+99.75	-59.97	261923.89	304521.13	2/11/2020	FD 5/8" IR, 1' DN	ODOT 68-18-6
1032	'L2' 1863+99.95	-60.47	262511.82	304667.31	2/11/2020	FD 5/8" IR w/ BROKEN YPC, 1.2' DN	CS 18576
1033	'L2' 1863+99.93	-77.14	262508.68	304683.69	2/11/2020	FD IR w/ YPC "KAISER RLS 803", 1.3' DN	CS 18576
1035	'108' 1884+73.84	58.24	260613.71	303860.48	2/11/2020	FD IR w/ AC "OTAK INC."	CS 16586
1041	-	-	262448.72	304744.23	2/11/2020	FD 3/4" IP	CS 38
1042	'108' 1865+15.84	-61.59	262411.46	304647.08	2/11/2020	FD IR w/ AC "OTAK INC."	CS 16586
1153	'NY' 172+34.15	-56.14	260641.83	304239.66	3/5/2020	FD IR w/ OPC "D. HUCK LS 2023", 1' DN	CS 19191
1154	-	-	260945.36	304484.69	3/5/2020	FD IR w/ OPC "D. HUCK LS 2023", LEANING SE	CS 19191
1155	'108' 1880+75.37	-85.43	260920.58	304152.46	3/5/2020	FD IR w/ OPC "D. HUCK LS 2023"	CS 19191
1156	-	-	260861.85	304285.96	3/5/2020	FD 5/8" IR w/ OPC PUNCHED THROUGH, FLUSH IN ASPHALT	CS 19191
1157	-	-	261031.19	304354.28	3/5/2020	FD 5/8" IR w/ OPC PUNCHED THROUGH, FLUSH IN ASPHALT	CS 19191
1158	'108' 1878+97.40	-82.57	261084.73	304221.52	3/4/2020	FD 5/8" IR w/ OPC PUNCHED THROUGH, FLUSH IN ASPHALT	CS 19191
1159	'108' 1878+30.56	-80.68	261146.93	304246.64	3/4/2020	FD IR w/ OPC "D. HUCK LS 2023"	CS 19191
1160	-	-	261166.62	304266.00	3/4/2020	FD IR w/ OPC "D. HUCK LS 2023"	CS 19191
1161	-	-	261149.16	304283.85	3/4/2020	FD 5/8" IR, FLUSH IN ASPHALT	CS 19191
1162	-	-	261139.17	304312.25	3/4/2020	FD IR w/ YPC "KAISER PLS 803", LEANING E	CS 18742
1163	'L2' 1874+82.96	-60.50	261463.09	304360.06	3/5/2020	FD 3/4" IR	ODOT 68-18-6
1164	'L2' 1873+44.26	-60.67	261593.83	304410.56	3/5/2020	FD IR w/ YPC "FRIAR PLS 961"	CS 8047
1165	'L2' 1871+83.76	-60.76	261746.64	304464.94	3/4/2020	FD IR w/ YPC "FRIAR PLS 961", 1.2' DN	CS 8047
1176	-	-	260768.54	304396.24	3/6/2020	FD 5/8" IR w/ OPC PUNCHED THROUGH	CS 19191
1177	-	-	260832.29	304344.63	3/6/2020	FD TACK w/ WASHER "LS 2023"	CS 19191

YPC/OPC=YELLOW/ORANGE PLASTIC CAP CS=COUNTY SURVEY  
 FD=FOUND IP=IRON PIPE IR= IRON REBAR AC=ALUMINUM CAP

**LEGEND**

- (IR#) SEE SHEET 2 FOR REFERENCE INFORMATION
- SET MONUMENT NOTED ON SHEET 4
- FOUND MONUMENT NOTED IN TABLE

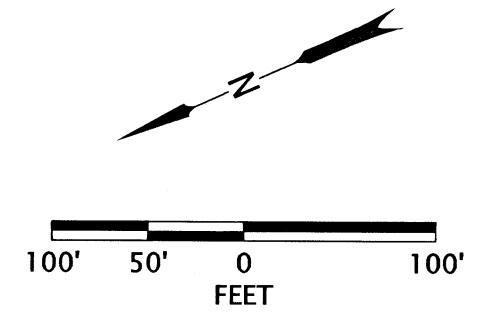

REGISTERED PROFESSIONAL LAND SURVEYOR  
*Jason Robert Weisz*  
 OREGON MARCH 14, 2017  
 JASON ROBERT WEISZ 91618  
 RENEWS: 6-30-2020

**OREGON DEPARTMENT OF TRANSPORTATION**  
 HORIZONTAL CONTROL, RECOVERY, RETRACEMENT, AND MONUMENTATION MAP  
 OR62: CURB RAMP UPGRADES PROJECT  
 JACKSON COUNTY

ODOT REGION 3 TECH CENTER  
 100 ANTELOPE RD.  
 WHITE CITY, OR 97503 KEY NO. 22127

MAY 21, 2019  
 SCALE: 1" = 100'  
 SHEET 5 OF 15



SW 1/4 SECTION 3 T36S R1W WM SE 1/4 SECTION 4 T36S R1W WM  
NE 1/4 SECTION 9 T36S R1W WM NW 1/4 SECTION 10 T36S R1W WM

'NY' CURVE TABLE

CURVE	DEG. OF CURVE	RADIUS	DELTA	TANGENT
'NY' C1	23°17'06" C.L.	246.06'	36°05'23"	80.16'
(C2)R4	-	75m	36°05'23"	-

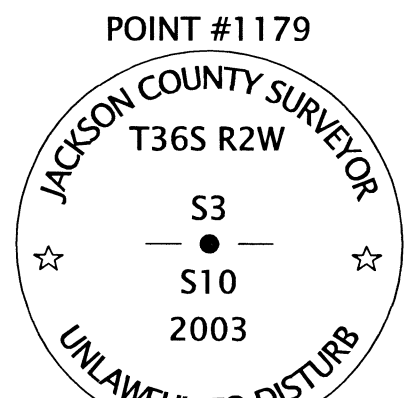

CURVE TABLE

CURVE	RADIUS	DELTA	LENGTH	CHORD	CH. BRG.
C3	82.02'	64°08'46"	91.83'	87.11'	N 55°50'06" E
(C4)R6	(25m)R6	(64°08'48")R6	(27.989m)R6	(26.550m)R6	(N 57°45'31" E)R6
C5	1936.86'	7°20'00"	248.28'	248.11'	S 22°31'50" W
(C6)R8	(1936.86')R8	-	(248.28')R8	(248.11')R8	(S 22°52'20" W)R8

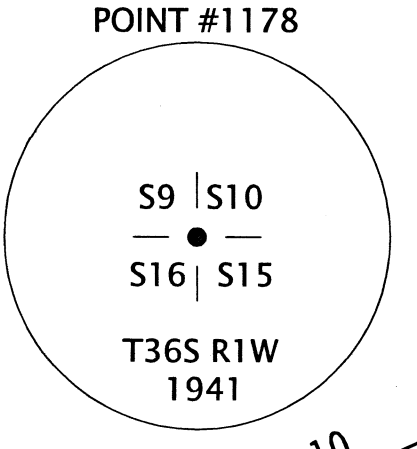
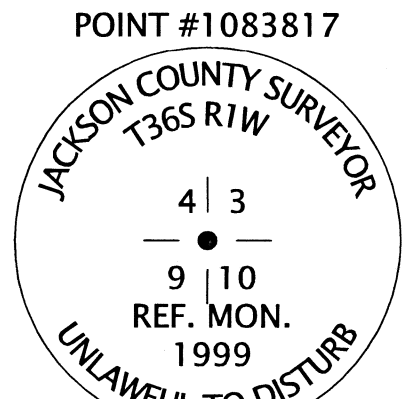

\*\* RECEIVED \*\*  
DATE 6/19/20 BY PB  
This survey consists of:  
15 sheet(s) Map  
0 page(s) Narrative  
JACKSON COUNTY SURVEYOR

SEE SHEET 5 OF 15

SEE SHEET 7 OF 15

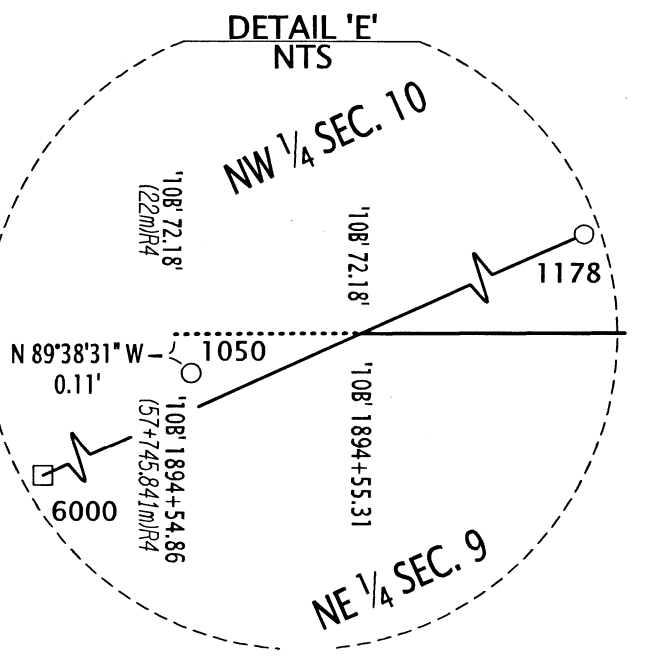
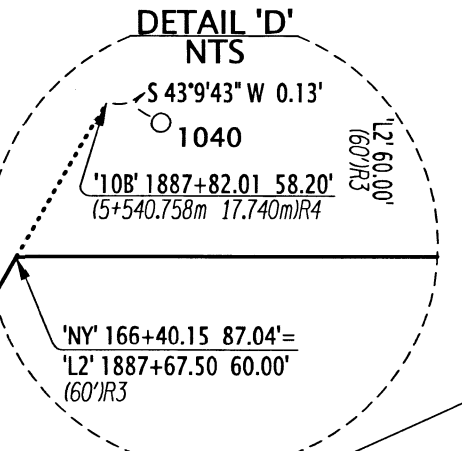
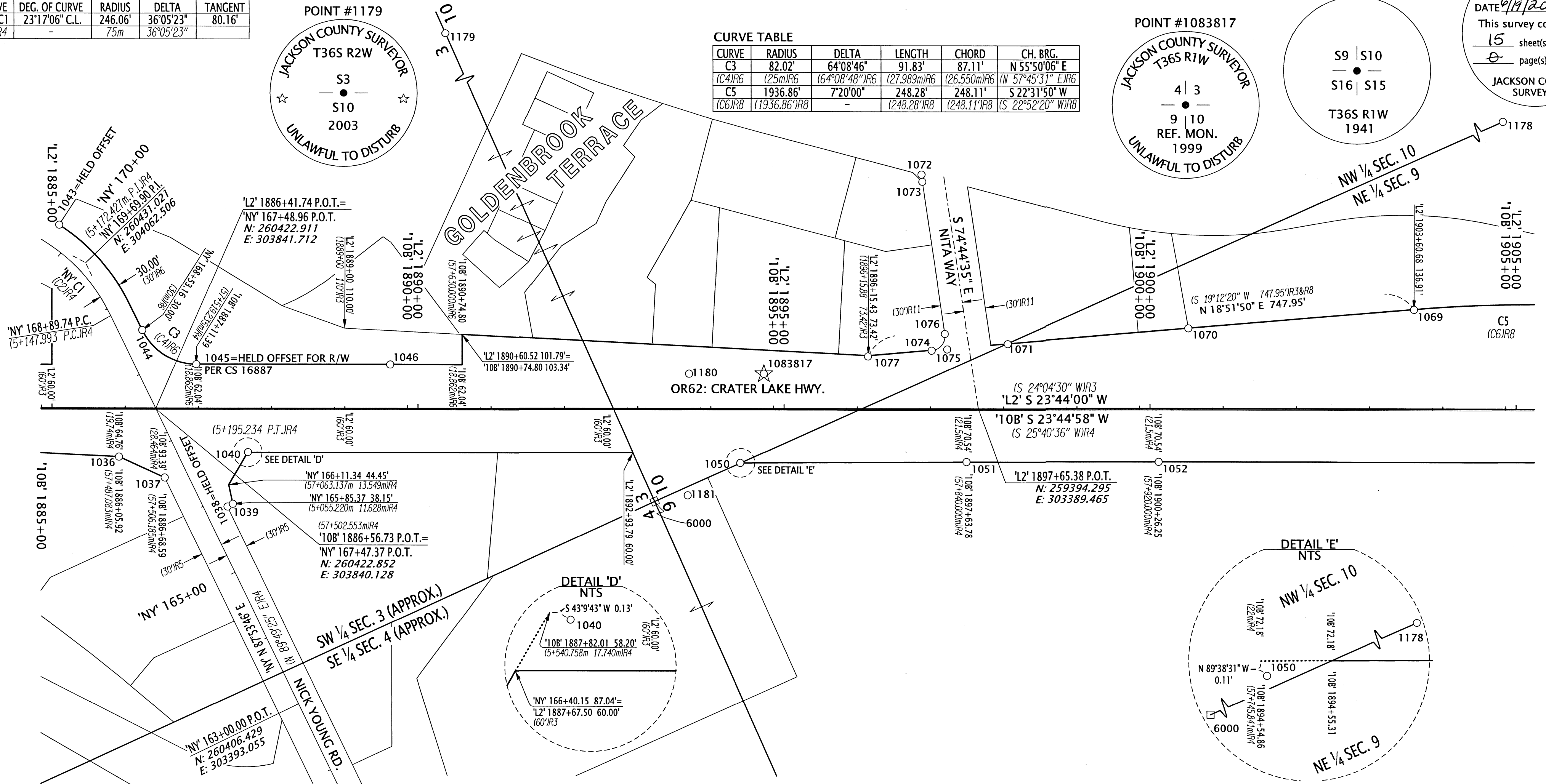

RECOVERED MONUMENT TABLE

PT. NO.	STATION	OFFSET	OCRS NORTHING	OCRS EASTING	DATE	DESCRIPTION	REFERENCE DOCUMENT
1036	'10B' 1886+06.00	64.85	260495.41	303801.20	2/11/2020	FD IR w/ AC "OTAK INC."	CS 16586
1037	'10B' 1886+68.67	93.36	260449.52	303749.86	2/11/2020	FD IR w/ AC "OTAK INC."	CS 16586
1038	'NY' 165+85.33	30.00	260386.92	303679.29	2/11/2020	FD SCREW w/ TAG "OTAK INC."	CS 16586
1039	'NY' 165+85.51	38.17	260378.77	303679.77	2/11/2020	FD 5/8" IR, BENT E, TIED SPIN HOLE	CS 16586
1040	'10B' 1887+82.13	58.24	260331.53	303736.31	2/12/2020	FD SCREW w/ TAG "OTAK INC.", IN BROKEN SIDEWALK	CS 16586
1043	'NY' 170+23.17	30.00	260442.90	304124.42	2/12/2020	FD IR w/ AC "OREGON DEPT. OF TRANSP. RIGHT OF WAY"	CS 16887
1044	'NY' 168+53.12	30.04	260396.72	303946.90	2/12/2020	FD 5/8" IR, BENT E, TIED SPIN HOLE, 1.3" DN	CS 16887
1045	'10B' 1887+11.48	-62.04	260347.76	303874.86	2/12/2020	FD 5/8" IR, BENT E, TIED SPIN HOLE	CS 16887
1046	'10B' 1889+76.45	-61.98	260105.25	303768.10	2/12/2020	FD IR w/ AC "ODOT RIGHT OF WAY"	CS 16887
1050	'10B' 1894+54.90	72.28	259721.38	303452.52	2/13/2020	FD IR w/ AC "OTAK INC."	CS 16586
1051	'10B' 1897+63.85	70.52	259437.89	303329.71	2/13/2020	FD IR w/ AC "OTAK INC."	CS 16586
1052	'10B' 1900+26.25	70.74	259197.80	303223.82	2/13/2020	FD IR w/ AC "OTAK INC."	CS 16586
1069	'L2' 1903+60.66	-136.30	258794.50	303274.65	2/14/2020	FD IR w/ YPC "KAISER RLS 803", 1" DN	CS 12360
1070	'L2' 1900+52.36	-110.15	259087.26	303374.79	2/14/2020	FD IR w/ OPC "HARDEY ENG. & ASSOC."	CS 19346
1071	'L2' 1898+05.64	-89.08	259321.59	303454.81	2/14/2020	FD 5/8" IR, LEANING W, 1.8" DN (1898+05.91 89.61 LT)	ODOT 68-18-6
1072	-	-	259336.50	303714.30	2/14/2020	FD 5/8" IR w/ BROKEN YPC	CS 19736
1073	-	-	259339.37	303704.84	2/14/2020	FD TACK w/ WASHER "LS 1913"	CS 19736
1074	'L2' 1897+01.57	-79.98	259420.52	303488.37	2/14/2020	FD 5/8" IR	CS 19736
1075	'L2' 1897+22.81	-81.75	259400.36	303481.43	2/14/2020	FD IR w/ YPC "HOFFBUHR AND ASSOC INC"	CS 19736
1076	-	-	259394.66	303502.11	2/14/2020	FD IR w/ YPC, ILLEGIBLE	CS 19736
1077	'L2' 1896+14.81	-72.08	259503.12	303516.05	2/14/2020	FD 5/8" IR (1896+15.88 73.42 LT)	ODOT 68-18-6
1178	-	-	254544.64	303492.23	4/3/2020	FD 3-1/2" BRASS DISK "T36S R1W S9/S10/S16/S15"	JCS 3RD RE-ESTAB 1/20/87
1179	-	-	259866.82	306106.50	4/3/2020	FD 3-1/2" BRASS DISK "T36S R1W 1/4 S3/S10"	JCS 4TH RE-ESTAB 5/23/13
1180	'L2' 1893+70.43	-47.94	259736.55	303592.31	4/3/2020	FD 1" BRASS CAP IN SIDEWALK, REF FOR 1078	JCS 4TH RE-ESTAB 7/26/99
1181	'L2' 1893+68.66	118.39	259805.12	303440.76	4/3/2020	FD IR w/ YPC "JACKSON CS", REF FOR 1078	JCS 4TH RE-ESTAB 7/26/99
6000	'L2' 1893+23.56	126.54	259849.70	303451.44	-	CALCULATED POSITION PER JACO RE-ESTAB NOTES	JCS 4TH RE-ESTAB 7/26/99
1083817	'L2' 1894+72.49	-47.88	259643.15	303551.18	3/18/2020	FD 2-1/2" BRASS CAP "JACKSON COUNTY SURVEYOR T36S R1W 4/3/10/9 REF MON 1999 UNLAWFUL TO DISTURB"	JCS 4TH RE-ESTAB 7/26/199

JCS=JACKSON COUNTY SURVEYOR  
FD=FOUND IR= IRON REBAR CS=COUNTY SURVEY  
YPC/OPC=YELLOW/ORANGE PLASTIC CAP AC=ALUMINUM CAP

LEGEND

(JR#)	SEE SHEET 2 FOR REFERENCE INFORMATION
☆	FOUND CONTROL POINT NOTED IN TABLE
○	FOUND MONUMENT NOTED IN TABLE
□	CALCULATED POINT NOTED IN TABLE

OREGON DEPARTMENT OF TRANSPORTATION  
HORIZONTAL CONTROL, RECOVERY, RETRACEMENT, AND MONUMENTATION MAP  
OR62: CURB RAMP UPGRADES PROJECT  
JACKSON COUNTY

ODOT REGION 3 TECH CENTER  
100 ANTELOPE RD.  
WHITE CITY, OR 97503 KEY NO. 22127

MAY 21, 2019  
SCALE: 1" = 100'  
SHEET 6 OF 15

REGISTERED PROFESSIONAL LAND SURVEYOR  
JASON ROBERT WEISZ  
91618  
RENEWS: 6-30-2020

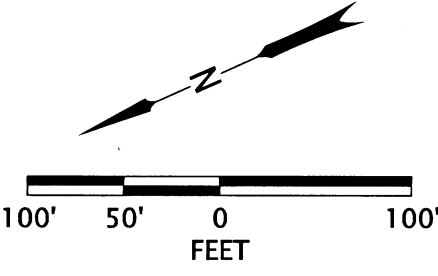

NE 1/4 SECTION 9 T36S R1W WM SE 1/4 SECTION 9 T36S R1W WM

**\*\* RECEIVED \*\***  
 DATE 6/19/20 BY RB  
 This survey consists of:  
 15 sheet(s) Map  
 0 page(s) Narrative  
 JACKSON COUNTY SURVEYOR

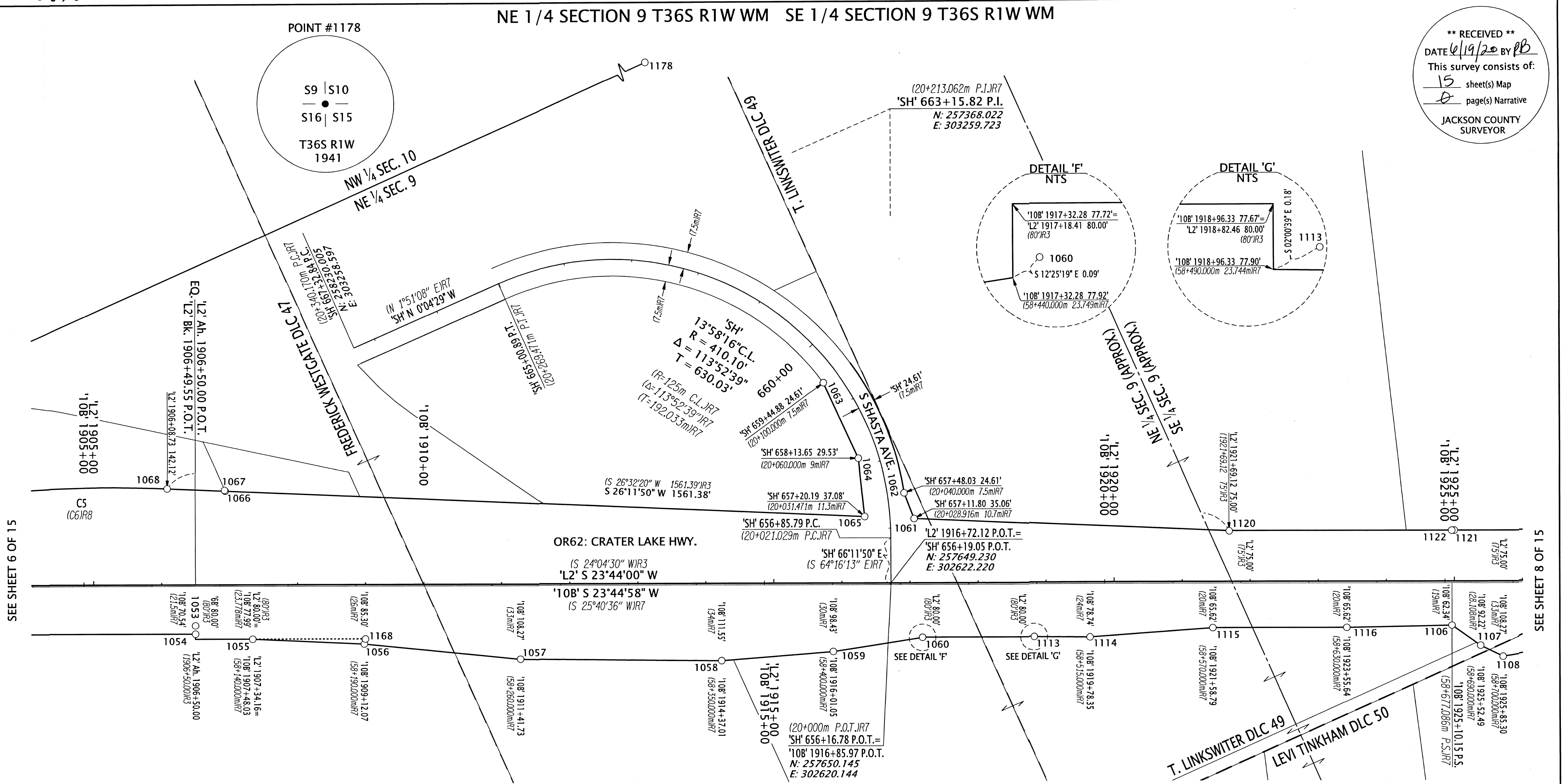
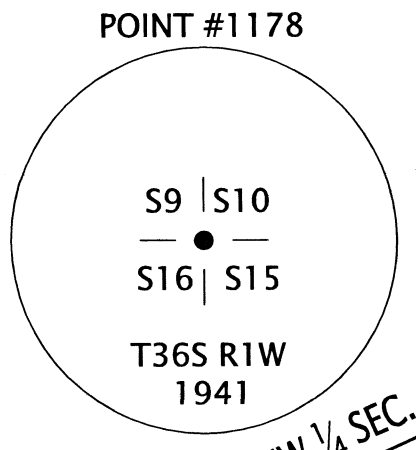

SEE SHEET 6 OF 15

SEE SHEET 8 OF 15

JCS=JACKSON COUNTY SURVEYOR  
 YPC=YELLOW PLASTIC CAP CS=COUNTY SURVEY  
 FD=FOUND IR= IRON REBAR AC=ALUMINUM CAP

RECOVERED MONUMENT TABLE

PT. NO.	STATION	OFFSET	OCRS NORTHING	OCRS EASTING	DATE	DESCRIPTION	REFERENCE DOCUMENT
1178	-	-	254544.64	303492.23	4/3/2020	FD 3-1/2" BRASS DISK "T36SR1W S9/S10/S16/S15"	JCS 3RD RE-ESTAB 1/20/87
1053	'L2' 1906+50.00	60.02	258609.06	302978.66	2/13/2020	FD 5/8" IR	ODOT 68-18-6
1054	'10B' 1906+64.10	70.40	258613.83	302967.25	2/13/2020	FD IR w/ AC "OTAK INC.", BENT N, TIED SPINHOLE	CS 16586
1055	'10B' 1907+48.22	77.90	258539.86	302926.51	2/14/2020	FD 5/8" IR	CS 16586
1056	'10B' 1909+12.30	85.41	258392.69	302853.55	2/14/2020	FD IR w/ AC "OTAK INC.", BENT NE, TIED SPINHOLE	CS 16586
1057	'10B' 1911+41.82	108.23	258191.80	302740.23	2/14/2020	FD IR w/ AC "OTAK INC."	CS 16586
1058	'10B' 1914+37.08	111.54	257922.87	302618.28	2/14/2020	FD IR w/ AC "OTAK INC."	CS 16586
1059	'10B' 1916+01.15	98.46	257767.43	302564.18	2/14/2020	FD IR w/ AC "OTAK INC."	CS 16586
1060	'10B' 1917+32.35	77.87	257639.05	302530.19	2/14/2020	FD IR w/ AC "OTAK INC."	CS 16586
1061	'SH' 657+11.68	35.10	257579.66	302695.17	2/14/2020	FD IR w/ AC "OTAK INC."	CS 16586
1062	'SH' 657+48.03	24.61	257577.83	302735.50	2/14/2020	FD IR w/ AC "OTAK INC."	CS 16586
1063	'SH' 659+44.87	-24.60	257620.99	302931.54	2/14/2020	FD IR w/ AC "OTAK INC."	CS 16586
1064	'SH' 658+13.63	-29.53	257618.99	302809.40	2/14/2020	FD IR w/ AC "OTAK INC."	CS 16586
1065	'SH' 657+20.05	-37.08	257644.85	302727.25	2/14/2020	FD IR w/ AC "OTAK INC."	CS 16586
1066	'L2' 1906+94.34	-138.38	258488.62	303142.44	2/14/2020	FD IR w/ YPC "KAISER RLS 803"	CS 12360
1067	'L2' 1906+93.40	-139.54	258489.02	303143.87	2/14/2020	FD 5/8" IR	CS 7184
1068	'L2' 1906+08.54	-141.97	258565.31	303180.07	2/14/2020	FD IR w/ YPC "KAISER RLS 803"	CS 12360
1106	'10B' 1925+10.14	62.42	256920.90	302231.09	2/25/2020	FD IR w/ AC "OTAK INC."	CS 16586
1107	'10B' 1925+52.45	92.10	256894.15	302186.89	2/25/2020	FD IR w/ AC "OTAK INC."	CS 16586
1108	'10B' 1925+85.35	108.27	256870.59	302158.85	2/25/2020	FD IR w/ AC "OTAK INC.", LEANING S	CS 16586
1113	'10B' 1918+96.49	77.82	257488.79	302464.13	2/25/2020	FD IR w/ AC "OTAK INC."	CS 16586
1114	'10B' 1919+78.46	78.69	257414.11	302430.32	2/25/2020	FD IR w/ AC "OTAK INC."	CS 16586
1115	'10B' 1921+58.86	65.67	257243.75	302369.59	2/25/2020	FD IR w/ AC "OTAK INC."	CS 16586
1116	'10B' 1923+55.72	65.64	257063.54	302290.32	2/25/2020	FD IR w/ AC "OTAK INC."	CS 16586
1120	'L2' 1921+69.41	-74.52	257164.01	302490.28	2/25/2020	FD 3/4" IR w/ BLANK PADDLE	ODOT 68-18-6
1121	'L2' 1924+99.96	-75.00	256861.21	302357.68	2/27/2020	FD 3/4" IR w/ BLANK PADDLE	ODOT 68-18-6
1122	'10B' 1925+10.16	-77.38	256864.59	302359.04	2/27/2020	FD IR w/ AC "OTAK INC."	CS 16586
1168	'L2' 1909+00.01	80.06	258388.27	302859.69	3/5/2020	FD 3/4" IR	ODOT 68-18-6

**LEGEND**

(IR)# SEE SHEET 2 FOR REFERENCE INFORMATION

○ FOUND MONUMENT NOTED IN TABLE

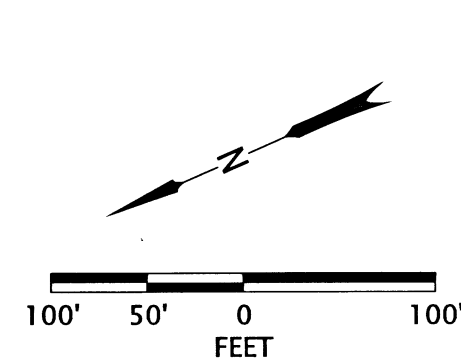

REGISTERED PROFESSIONAL LAND SURVEYOR

*Jason Robert Weisz*

OREGON  
 MARCH 14, 2017  
 JASON ROBERT WEISZ  
 91618  
 RENEWS: 6-30-2020

**OREGON DEPARTMENT OF TRANSPORTATION**

HORIZONTAL CONTROL, RECOVERY, RETRACEMENT, AND MONUMENTATION MAP

OR62: CURB RAMP UPGRADES PROJECT  
 JACKSON COUNTY

ODOT REGION 3 TECH CENTER  
 100 ANTELOPE RD.  
 WHITE CITY, OR 97503 KEY NO. 22127

MAY 21, 2019  
 SCALE: 1" = 100'  
 SHEET 7 OF 15

**\*\* RECEIVED \*\***  
 DATE 6/19/20 BY RB  
 This survey consists of:  
15 sheet(s) Map  
0 page(s) Narrative  
 JACKSON COUNTY  
 SURVEYOR

SEE SHEET 7 OF 15

SEE SHEET 9 OF 15

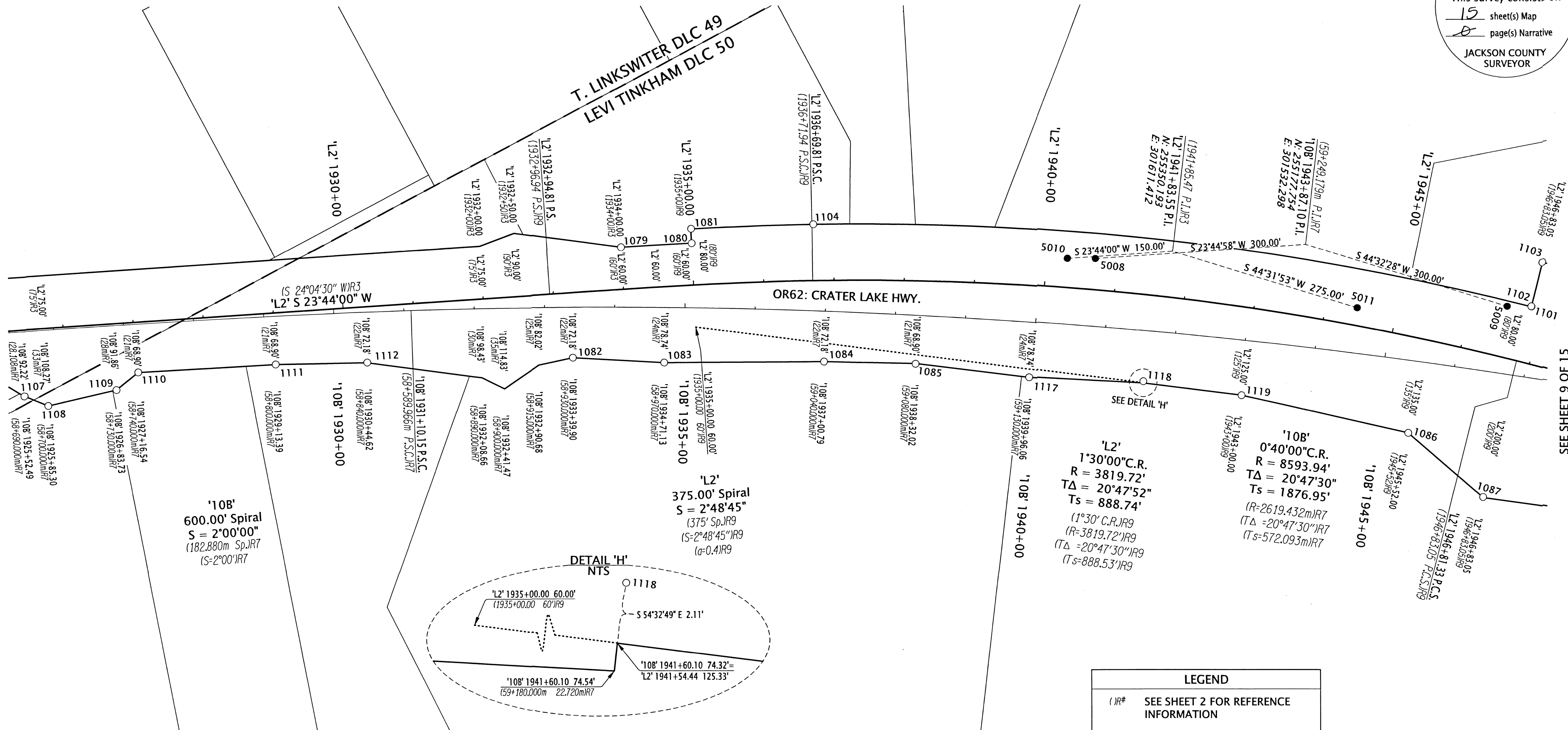

**LEGEND**

- ( )# SEE SHEET 2 FOR REFERENCE INFORMATION
- SET MONUMENT NOTED IN TABLE
- FOUND MONUMENT NOTED IN TABLE

RECOVERED MONUMENT TABLE

PT. NO.	STATION	OFFSET	OCRS NORTHING	OCRS EASTING	DATE	DESCRIPTION	REFERENCE DOCUMENT
1079	'L2' 1933+99.97	-59.88	256043.25	301981.39	2/14/2020	FD IR w/ OPC "B. KAISER RLS 52923"	CS 19799
1080	'L2' 1935+00.24	-59.59	255951.34	301939.70	2/14/2020	FD 3/4" IR	ODOT 68-18-6
1081	'L2' 1935+00.42	-80.14	255942.63	301958.31	2/14/2020	FD 3/4" IR	ODOT 68-18-6
1082	'10B' 1933+39.97	72.18	256176.89	301873.46	2/24/2020	FD IR w/ AC "OTAK INC."	CS 16586
1083	'10B' 1934+71.16	78.72	256064.82	301807.19	2/24/2020	FD IR w/ AC "OTAK INC."	CS 16586
1084	'10B' 1937+00.75	72.22	255862.50	301702.82	2/24/2020	FD IR w/ AC "OTAK INC."	CS 16586
1085	'10B' 1938+32.17	69.41	255748.35	301639.85	2/24/2020	FD IR w/ AC "OTAK INC."	CS 16586
1086	'L2' 1945+52.53	135.05	255172.19	301226.99	2/25/2020	FD IR w/ AC "OTAK INC."	CS 16586
1087	'L2' 1946+82.61	199.44	255120.02	301097.02	2/25/2020	FD 1/2" SMOOTH IR, BENT NE, TIED SPINHOLE	ODOT 68-3-10
1101	'L2' 1946+83.01	-80.38	254933.44	301305.54	2/27/2020	FD IR w/ YPC "HOFFBUHR AND ASSOC INC"	CS 22505
1102	'L2' 1946+82.75	-80.48	254933.57	301305.80	2/27/2020	FD 1/2" SMOOTH IR, BENT NE, TIED SPINHOLE	ODOT 68-3-10
1103	'L2' 1946+82.96	-144.38	254890.86	301353.34	2/27/2020	FD IR w/ YPC "HOFFBUHR AND ASSOC INC"	CS 22505
1104	'L2' 1936+71.77	-79.92	255785.53	301883.20	2/27/2020	FD IR w/ OPC "B. KAISER RLS 52923"	CS 19799
1107	'10B' 1925+52.45	92.10	256894.15	302186.89	2/25/2020	FD IR w/ AC "OTAK INC."	CS 16586
1108	'10B' 1925+85.35	108.27	256870.59	302158.85	2/25/2020	FD IR w/ AC "OTAK INC.", LEANING S	CS 16586
1109	'10B' 1926+83.86	91.99	256774.12	302134.01	2/25/2020	FD IR w/ AC "OTAK INC."	CS 16586
1110	'10B' 1927+16.66	68.85	256734.84	302141.89	2/25/2020	FD IR w/ AC "OTAK INC."	CS 16586
1111	'10B' 1929+13.46	68.89	256556.20	302061.24	2/25/2020	FD IR w/ AC "OTAK INC."	CS 16586
1112	'10B' 1930+44.77	72.11	256439.30	302003.23	2/25/2020	FD IR w/ AC "OTAK INC.", LEANING SW	CS 16586
1117	'10B' 1939+96.16	78.68	255613.94	301547.91	2/25/2020	FD IR w/ AC "OTAK INC."	CS 16586
1118	'10B' 1941+60.20	72.22	255472.91	301466.72	2/25/2020	FD IR w/ AC "OTAK INC."	CS 16586
1119	'L2' 1943+00.52	125.13	255358.16	301384.31	2/25/2020	FD IR w/ AC "OTAK INC."	CS 16586

FD=FOUND IR= IRON REBAR CS=COUNTY SURVEY  
 YPC/OPC=YELLOW/ORANGE PLASTIC CAP AC=ALUMINUM CAP

SET MONUMENT TABLE

PT. NO.	STATION	OFFSET	OCRS NORTHING	OCRS EASTING	DATE	DESCRIPTION
5008	'10B' 1940+77.59	-96.08	255452.35	301653.12	5/21/2020	SET 5/8" X 30" IR w/ AC "ODOT RIGHT OF WAY"
5009	'10B' 1946+61.32	-96.08	254963.93	301321.87	5/21/2020	SET 5/8" X 30" IR w/ AC "ODOT RIGHT OF WAY"
5010	'L2' 1940+29.57	-41.09	255487.51	301671.78	5/21/2020	SET 5/8" X 30" IR w/ AC "ODOT RIGHT OF WAY"
5011	'L2' 1944+44.50	-25.23	255154.15	301418.55	5/21/2020	SET 5/8" X 30" IR w/ AC "ODOT RIGHT OF WAY"

IR=IRON REBAR AC=ALUMINUM CAP

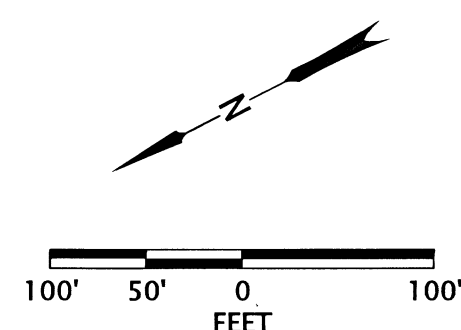

REGISTERED PROFESSIONAL LAND SURVEYOR  
  
 OREGON  
 MARCH 14, 2017  
 JASON ROBERT WEISZ  
 91618  
 RENEWS: 6-30-2020

**OREGON DEPARTMENT OF TRANSPORTATION**  
 HORIZONTAL CONTROL, RECOVERY, RETRACEMENT, AND MONUMENTATION MAP  
 OR62: CURB RAMP UPGRADES PROJECT  
 JACKSON COUNTY

ODOT REGION 3 TECH CENTER  
 100 ANTELOPE RD.  
 WHITE CITY, OR 97503 KEY NO. 22127

MAY 21, 2019  
 SCALE: 1" = 100'  
 SHEET 8 OF 15



SE 1/4 SECTION 9 T36S R1W WM SW 1/4 SECTION 9 T36S R1W WM  
NE 1/4 SECTION 16 T36S R1W WM NW 1/4 SECTION 16 T36S R1W WM

**\*\* RECEIVED \*\***  
DATE 6/19/20 BY RB  
This survey consists of:  
15 sheet(s) Map  
0 page(s) Narrative  
JACKSON COUNTY SURVEYOR

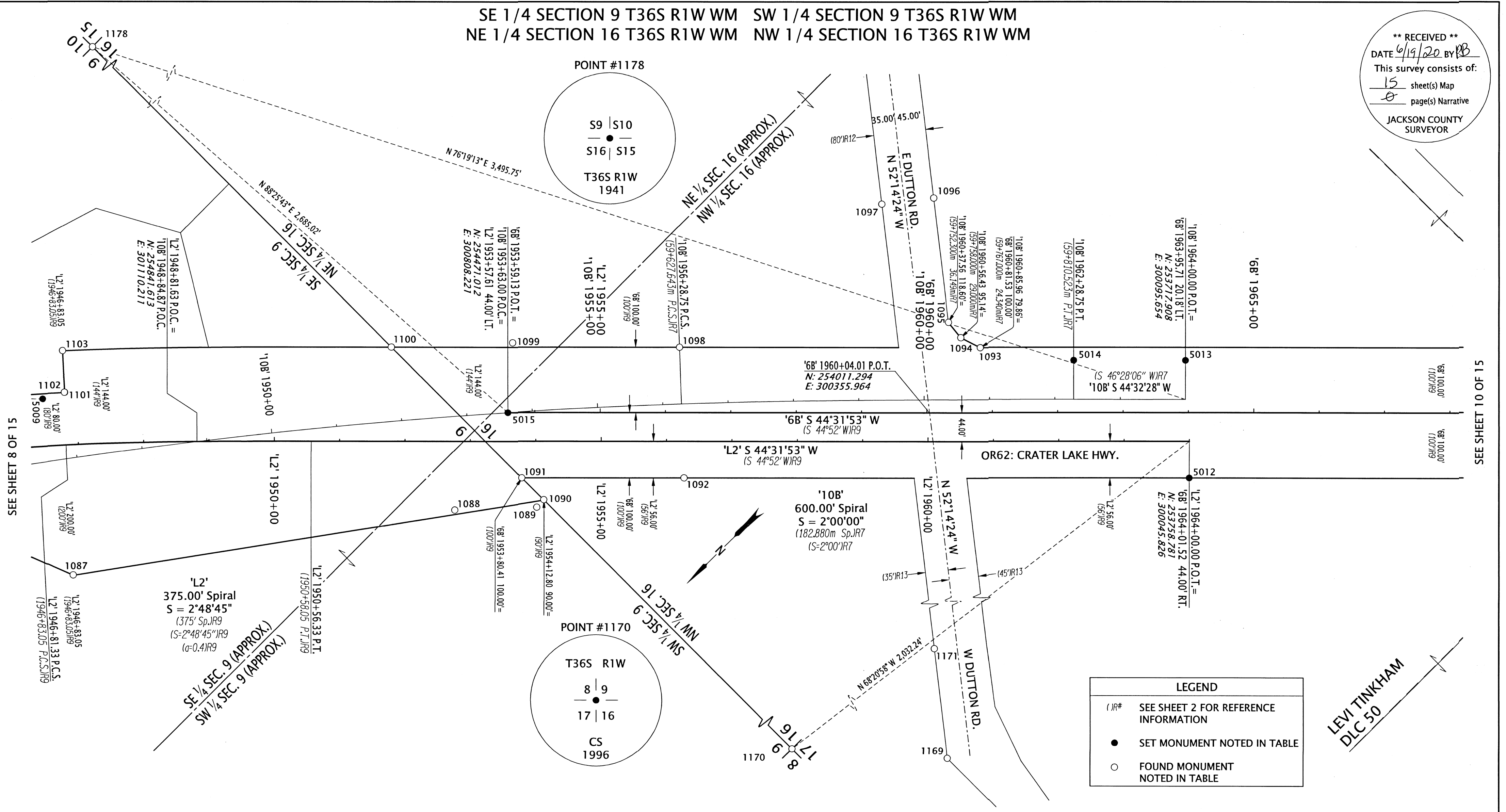

SEE SHEET 8 OF 15

SEE SHEET 10 OF 15

LEVI TINKHAM  
DLC 50

JCS=JACKSON COUNTY SURVEYOR  
FD=FOUND IR=IRON REBAR CS=COUNTY SURVEY  
YPC/OPC=YELLOW/ORANGE PLASTIC CAP AC=ALUMINUM CAP

RECOVERED MONUMENT TABLE

PT. NO.	STATION	OFFSET	OCRS NORTHING	OCRS EASTING	DATE	DESCRIPTION	REFERENCE DOCUMENT
1087	'L2' 1946+82.61	199.44	255120.02	301097.02	2/25/2020	FD 1/2" SMOOTH IR, BENT NE, TIED SPINHOLE	ODOT 6B-3-10
1088	'L2' 1952+76.48	105.16	254633.45	300758.78	2/27/2020	FD IR w/ AC W&H PACIFIC NW RP"	CS 16395
1089	'6B' 1954+03.24	144.93	254541.21	300673.97	2/27/2020	FD IR w/ AC W&H PACIFIC SW RP"	CS 16395
1090	'L2' 1954+12.41	89.43	254525.52	300674.67	2/27/2020	FD 1/2" SMOOTH IR, LEANING E	ODOT 6B-3-10
1091	'6B' 1953+80.36	100.00	254526.01	300722.05	2/27/2020	FD IR w/ AC "OTAK INC."	CS 16586
1092	'10B' 1956+28.82	113.38	254349.06	300548.01	2/27/2020	FD IR w/ AC "OTAK INC."	CS 16586
1093	'10B' 1960+86.04	-79.93	253885.80	300372.88	2/27/2020	FD IR w/ OPC "HARDEY ENG. & ASSOC."	CS 19204
1094	'10B' 1960+56.53	-95.17	253896.27	300404.48	2/27/2020	FD IR w/ OPC "HARDEY ENG. & ASSOC."	CS 19204
1095	'10B' 1960+37.83	-118.63	253893.29	300434.37	2/27/2020	FD IR w/ OPC "HARDEY ENG. & ASSOC."	CS 19204
1096	-	-	253776.14	300585.99	2/27/2020	FD IR w/ OPC "HARDEY ENG. & ASSOC."	CS 19204
1097	-	-	253839.43	300635.01	2/27/2020	FD 5/8" IR	CS 6343
1098	'10B' 1956+28.81	-86.73	254213.78	300695.46	2/27/2020	FD IR w/ AC "OTAK INC."	CS 16586
1099	'6B' 1953+66.50	-107.03	254390.70	300879.35	2/27/2020	FD 5/8" IR w/ YPC REMNANTS	JCS 4TH RE-ESTAB 12/23/76
1100	'L2' 1951+79.39	-144.16	254527.82	301004.61	2/27/2020	FD 3/4" IR	ODOT 6B-3-10
1101	'L2' 1946+83.01	-80.38	254933.44	301305.54	2/27/2020	FD IR w/ YPC "HOFFBUHR AND ASSOC INC"	CS 22505
1102	'L2' 1946+82.75	-80.48	254933.57	301305.80	2/27/2020	FD 1/2" SMOOTH IR, BENT NE, TIED SPINHOLE	ODOT 6B-3-10
1103	'L2' 1946+82.96	-144.38	254890.86	301353.34	2/27/2020	FD IR w/ YPC "HOFFBUHR AND ASSOC INC"	CS 22505
1169	-	-	254539.31	299731.42	3/5/2020	FD 5/8" IR w/ BROKEN YPC	CS 15791
1170	-	-	254508.56	298156.95	3/5/2020	FD 2-1/2" BRASS DISK SEC COR 8/9/17/16	JCS 4TH RE-ESTAB 9/24/96
1171	-	-	254435.78	299865.03	3/5/2020	FD IR w/ YPC "JACKSON CO PUBLIC WORKS"	CS 15791
1178	-	-	254544.64	303492.23	4/3/2020	FD 3-1/2" BRASS DISK "T36SR1W S9/S10/S16/S15"	JCS 3RD RE-ESTAB 1/20/87

SET MONUMENT TABLE

PT. NO.	STATION	OFFSET	OCRS NORTHING	OCRS EASTING	DATE	DESCRIPTION
5009	'10B' 1946+61.32	-96.08	254963.93	301321.87	5/21/2020	SET 5/8" X 30" IR w/ AC "ODOT RIGHT OF WAY"
5012	'L2' 1964+00.00	56.00	253798.05	300005.91	5/21/2020	SET 5/8" X 30" IR w/ AC "ODOT RIGHT OF WAY"
5013	'10B' 1964+00.00	-60.00	253675.82	300138.42	5/21/2020	SET 5/8" X 30" IR w/ AC "ODOT RIGHT OF WAY"
5014	'10B' 1962+28.75	-60.00	253797.88	300258.53	5/21/2020	SET 5/8" X 30" IR w/ AC "ODOT RIGHT OF WAY"
5015	'6B' 1953+59.13	0.00	254471.01	300808.22	5/21/2020	SET 1" COPPER PLUG "ODOT"

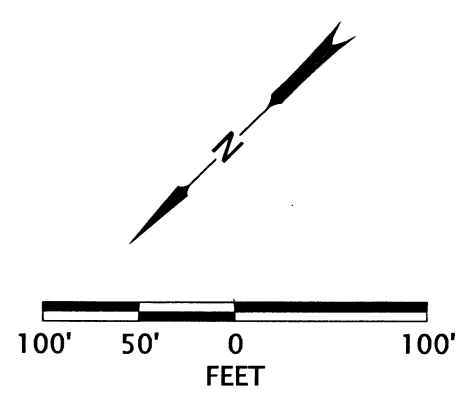

REGISTERED PROFESSIONAL LAND SURVEYOR  
*Jason Robert Weisz*  
OREGON  
MARCH 14, 2017  
JASON ROBERT WEISZ  
91618  
RENEWS: 6-30-2020

**OREGON DEPARTMENT OF TRANSPORTATION**  
HORIZONTAL CONTROL, RECOVERY, RETRACEMENT, AND MONUMENTATION MAP  
OR62: CURB RAMP UPGRADES PROJECT  
JACKSON COUNTY

ODOT REGION 3 TECH CENTER  
100 ANTELOPE RD.  
WHITE CITY, OR 97503 KEY NO. 22127

MAY 21, 2019  
SCALE: 1" = 100'  
SHEET 9 OF 15

NW 1/4 SECTION 16 T36S R1W WM SW 1/4 SECTION 16 T36S R1W WM  
NE 1/4 SECTION 17 T36S R1W WM

**\*\* RECEIVED \*\***  
DATE 6/19/20 BY RB  
This survey consists of:  
15 sheet(s) Map  
8 page(s) Narrative  
JACKSON COUNTY  
SURVEYOR

SEE SHEET 9 OF 15

SEE SHEET 11 OF 15

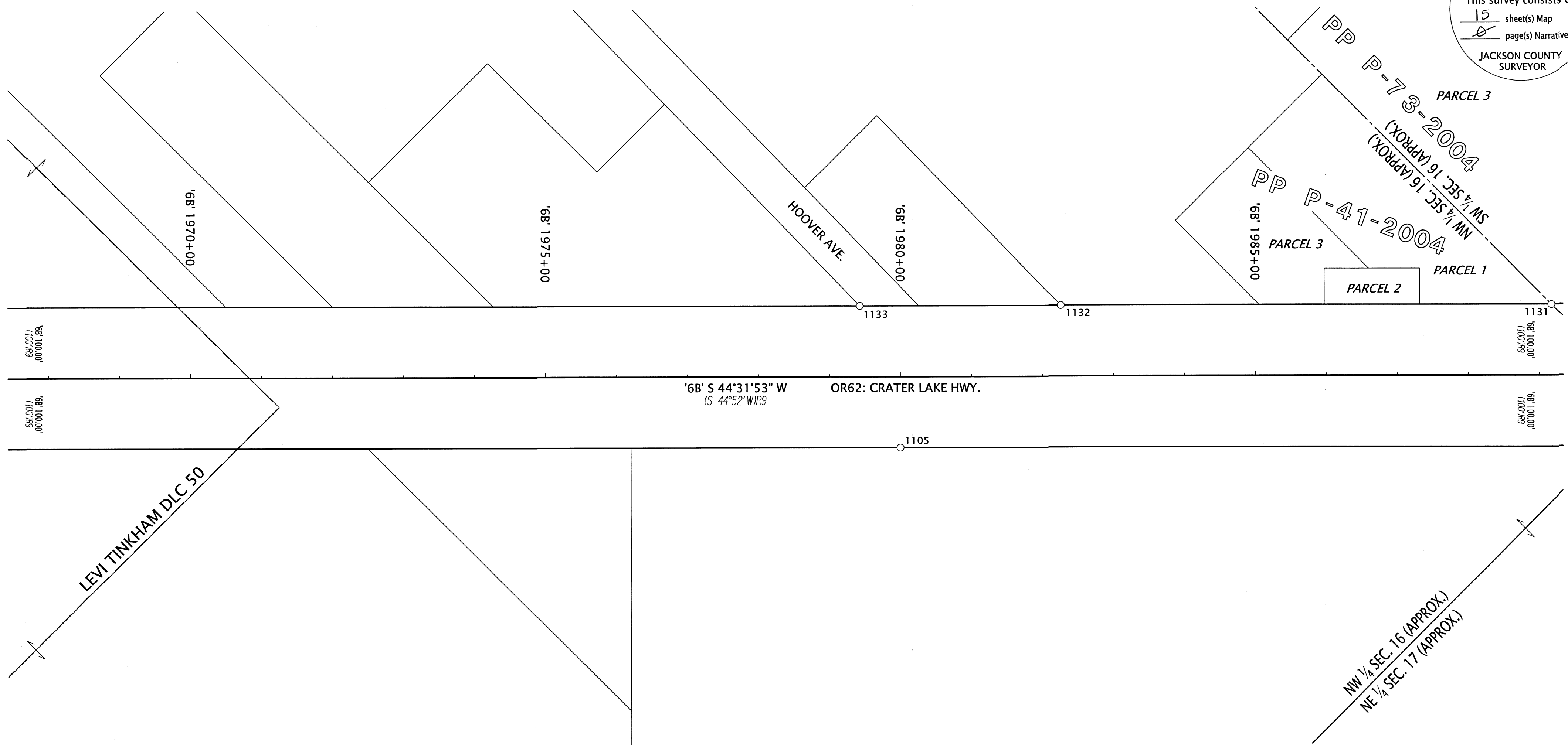

RECOVERED MONUMENT TABLE

PT. NO.	STATION	OFFSET	OCRS NORTHING	OCRS EASTING	DATE	DESCRIPTION	REFERENCE DOCUMENT
1105	'6B' 1980+00.22	99.93	252658.35	298884.80	2/25/2020	FD IR w/ AC "OREG STATE HWY DEPT", w/ PADDLE "SHRW 1980+00 125"	ODOT 8B-32-12
1131	'6B' 1989+17.37	-99.75	251864.50	298383.94	2/27/2020	FD 3/4" IP w/ BLANK PADDLE	ODOT 8B-32-12
1132	'6B' 1982+26.18	-99.81	252357.19	298868.71	2/27/2020	FD 3/4" IR	CS 1015
1133	'6B' 1979+43.05	-99.96	252558.92	299067.38	2/27/2020	FD 5/8" IR w/ PADDLE "SHRW 1979+41.87 74.90"	CS 1015

FD=FOUND IP=IRON PIPE IR= IRON REBAR AC=ALUMINUM CAP CS=COUNTY SURVEY

LEGEND	
( )R#	SEE SHEET 2 FOR REFERENCE INFORMATION
○	FOUND MONUMENT NOTED IN TABLE

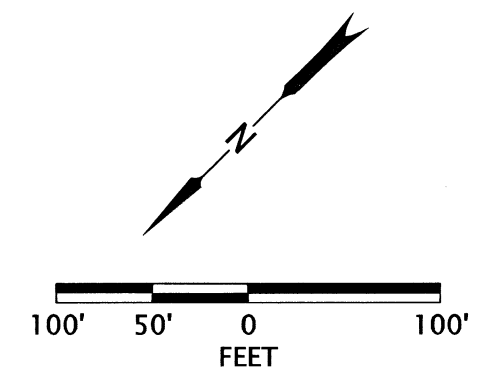

REGISTERED PROFESSIONAL LAND SURVEYOR  
*Jason Robert Weisz*  
OREGON  
MARCH 14, 2017  
JASON ROBERT WEISZ  
91618  
RENEWS: 6-30-2020

**OREGON DEPARTMENT OF TRANSPORTATION**  
HORIZONTAL CONTROL, RECOVERY, RETRACEMENT, AND MONUMENTATION MAP  
OR62: CURB RAMP UPGRADES PROJECT  
JACKSON COUNTY



ODOT REGION 3 TECH CENTER  
100 ANTELOPE RD.  
WHITE CITY, OR 97503 KEY NO. 22127

MAY 21, 2019  
SCALE: 1" = 100'  
SHEET 10 OF 15





SE 1/4 SECTION 17 T36S R1W WM SW 1/4 SECTION 17 T36S R1W WM  
 NE 1/4 SECTION 20 T36S R1W WM NW 1/4 SECTION 20 T36S R1W WM

**\*\* RECEIVED \*\***  
 DATE 6/19/20 BY RB  
 This survey consists of:  
15 sheet(s) Map  
0 page(s) Narrative  
 JACKSON COUNTY  
 SURVEYOR

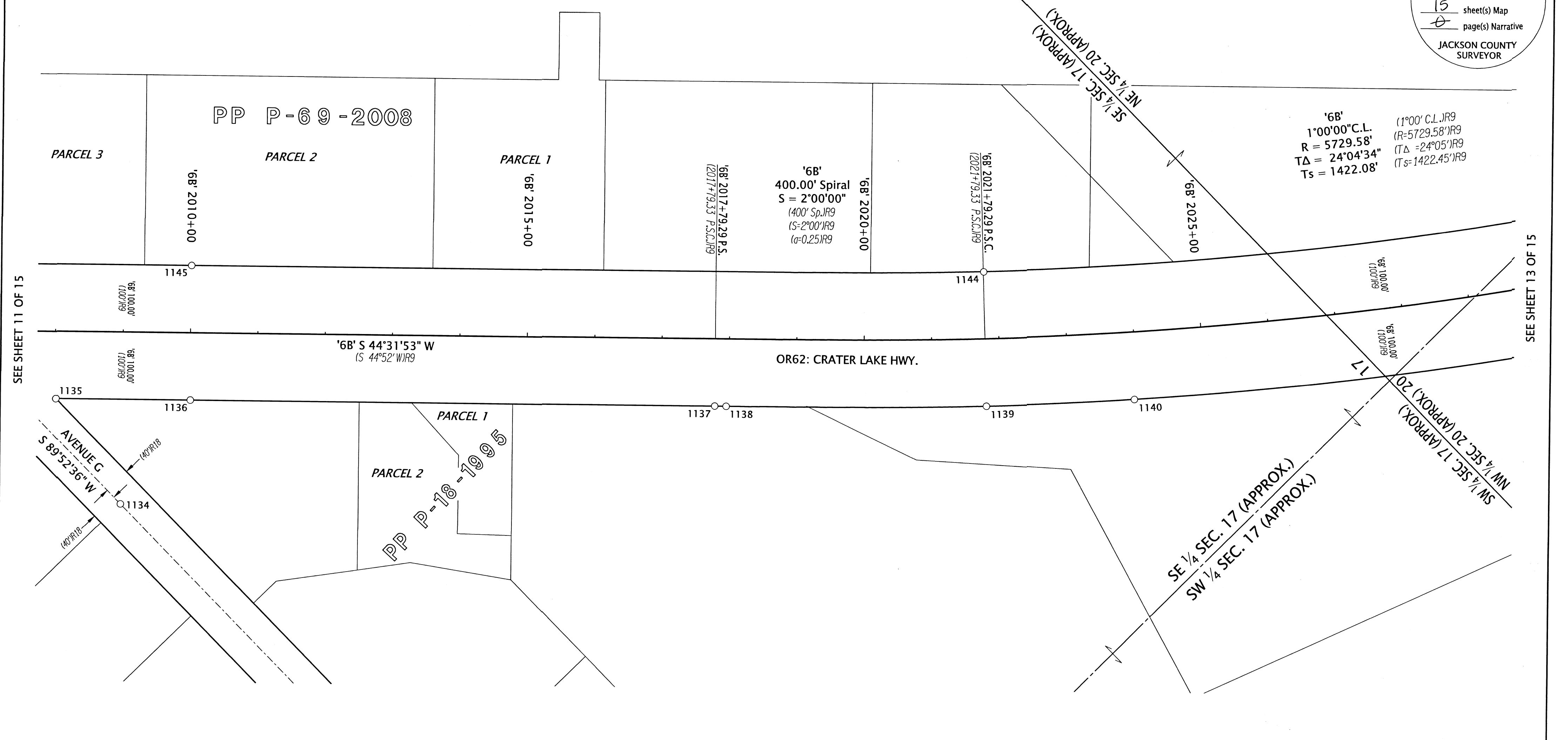

'6B'  
 1°00'00" C.L.  
 R = 5729.58'  
 Δ = 24°04'34"  
 Ts = 1422.08'  
 (1°00' C.L.) IR9  
 (R = 5729.58') IR9  
 (Δ = 24°05' IR9  
 (Ts = 1422.45') IR9

SEE SHEET 11 OF 15

SEE SHEET 13 OF 15

**LEGEND**

(IR# SEE SHEET 2 FOR REFERENCE INFORMATION

○ FOUND MONUMENT NOTED IN TABLE

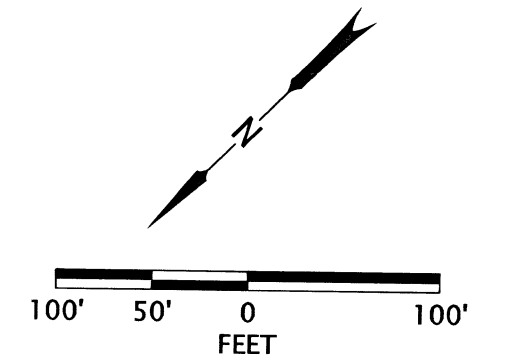

RECOVERED MONUMENT TABLE

PT. NO.	STATION	OFFSET	OCRS NORTHING	OCRS EASTING	DATE	DESCRIPTION	REFERENCE DOCUMENT
1134	-	-	250701.18	296741.50	2/26/2020	FD AC IN CONCRETE "HEA LS 1069"	ORIGIN UNKNOWN
1135	'6B' 2008+01.46	100.12	250661.56	296920.15	2/26/2020	FD IR w/ OPC "HARDEY ENG. & ASSOC."	CS 20238
1136	'6B' 2010+00.88	100.12	250519.40	296780.30	2/26/2020	FD IR w/ AC "OREG STATE HWY DEPT", w/ PADDLE "SHRW 2010+00 125"	ODOT 88-32-12
1137	'6B' 2017+79.33	100.00	249964.39	296234.46	2/27/2020	FD 5/8" IR	ODOT 68-3-10
1138	'6B' 2017+96.24	100.17	249952.45	296222.47	2/26/2020	FD IR w/ AC "OREG STATE HWY DEPT", w/ PADDLE "SHRW P.S. 2017+96.20 125"	ODOT 88-32-12
1139	'6B' 2021+79.29	100.06	249673.55	295954.87	2/26/2020	FD 1/2" IR, BENT E, TIED SPINHOLE	ODOT 68-3-10
1140	'6B' 2023+95.27	100.34	249509.04	295809.19	2/26/2020	FD IR w/ AC "OREG STATE HWY DEPT", w/ PADDLE "SHRW P.S.C. 2023+96.20"	ODOT 88-32-12
1144	'6B' 2021+79.98	-99.58	249538.10	296101.53	2/26/2020	FD 1/2" IR, BENT S, TIED SPINHOLE	ODOT 68-3-10
1145	'6B' 2010+00.73	-99.85	250379.27	296922.95	2/26/2020	FD IR w/ AC "OREG STATE HWY DEPT", w/ PADDLE "SHRW 2010+00 75"	ODOT 88-32-12

OPC=ORANGE PLASTIC CAP CS=COUNTY SURVEY  
 FD=FOUND IR= IRON REBAR AC=ALUMINUM CAP

REGISTERED PROFESSIONAL LAND SURVEYOR  
  
 OREGON  
 MARCH 14, 2017  
 JASON ROBERT WEISZ  
 91618  
 RENEWS: 6-30-2020

**OREGON DEPARTMENT OF TRANSPORTATION**  
 HORIZONTAL CONTROL, RECOVERY, RETRACEMENT, AND MONUMENTATION MAP  
 OR62: CURB RAMP UPGRADES PROJECT  
 JACKSON COUNTY

ODOT REGION 3 TECH CENTER  
 100 ANTELOPE RD.  
 WHITE CITY, OR 97503 KEY NO. 22127

MAY 21, 2019  
 SCALE: 1" = 100'  
 SHEET 12 OF 15

SE 1/4 SECTION 17 T36S R1W WM SW 1/4 SECTION 17 T36S R1W WM  
 NE 1/4 SECTION 20 T36S R1W WM NW 1/4 SECTION 20 T36S R1W WM

**\*\* RECEIVED \*\***  
 DATE 6/19/20 BY PB  
 This survey consists of:  
 15 sheet(s) Map  
 0 page(s) Narrative  
 JACKSON COUNTY SURVEYOR

SEE SHEET 12 OF 15

SEE SHEET 14 OF 15

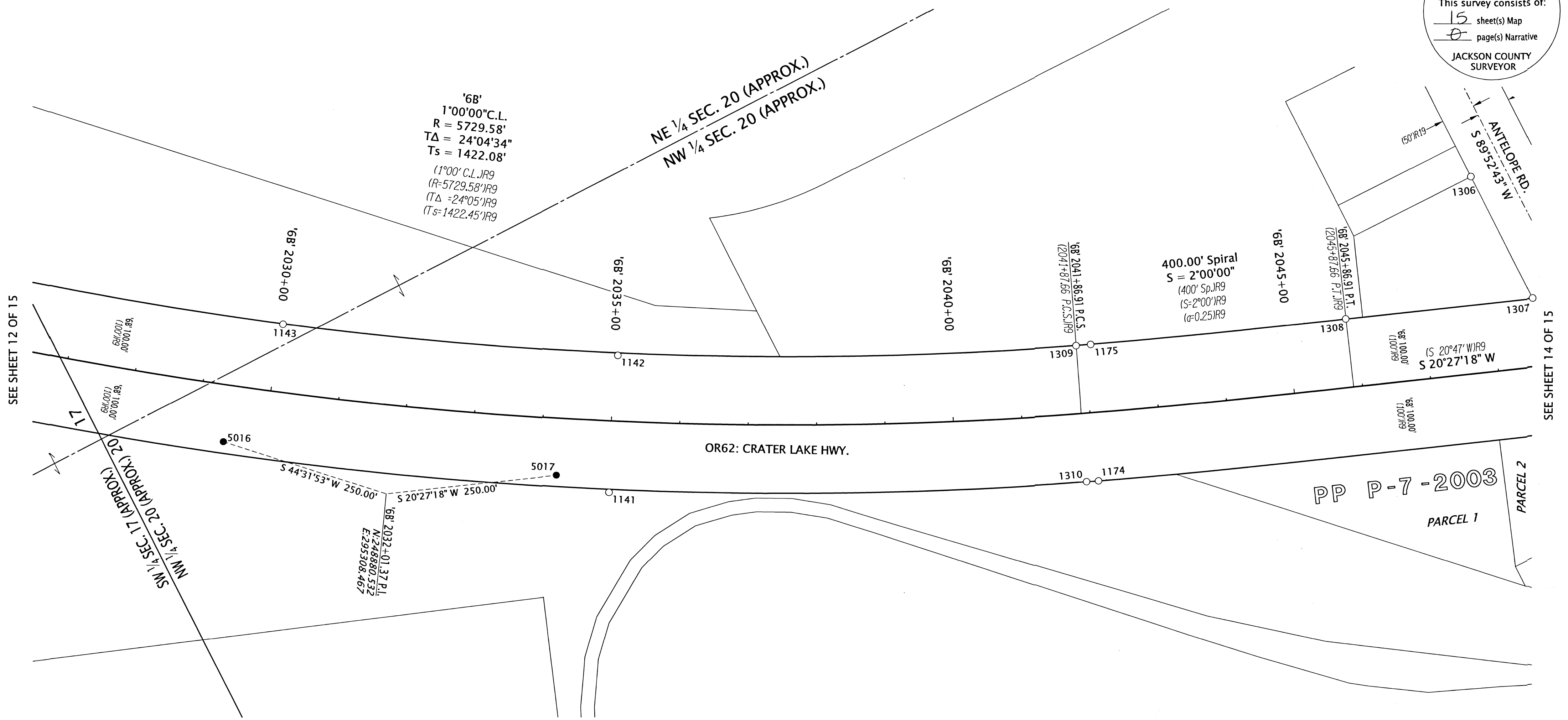

SET MONUMENT TABLE

PT. NO.	STATION	OFFSET	OCRS NORTHING	OCRS EASTING	DATE	DESCRIPTION
5016	'6B' 2029+42.02	83.03	249058.75	295483.79	5/21/2020	SET 5/8" X 30" IR w/ AC "ODOT RIGHT OF WAY"
5017	'6B' 2034+24.18	83.03	248646.30	295221.10	5/21/2020	SET 5/8" X 30" IR w/ AC "ODOT RIGHT OF WAY"

IR=IRON REBAR AC=ALUMINUM CAP

RECOVERED MONUMENT TABLE

PT. NO.	STATION	OFFSET	OCRS NORTHING	OCRS EASTING	DATE	DESCRIPTION	REFERENCE DOCUMENT
1141	'6B' 2035+01.16	104.48	248588.97	295163.70	2/26/2020	FD 5/8" IR, BENT BADLY, TIED SPINHOLE, w/ PADDLE "SHRW 2035+00"	ODOT 88-32-12
1142	'6B' 2035+05.00	-96.30	248487.37	295336.92	2/26/2020	FD 5/8" IR, BENT N, TIED SPINHOLE, w/ PADDLE "SHRW 2035+00"	ODOT 88-32-12
1143	'6B' 2030+05.07	-99.23	248903.45	295598.09	2/26/2020	FD IR w/ OPC "HARDEY ENG. & ASSOC.", BENT SW, TIED SPINHOLE, w/ PADDLE "2030+00"	ODOT 88-32-12
1174	'6B' 2042+04.59	100.14	247942.84	294856.23	3/5/2020	FD IR w/ AC "OREG STATE HWY DEPT", w/ U-POST	ODOT 88-32-12
1175	'6B' 2042+08.69	-99.60	247863.37	295039.53	3/5/2020	FD IR w/ AC "OREG STATE HWY DEPT", w/ PADDLE "SHRW P.C.S. 2042+04.53"	ODOT 88-32-12
1306	-	-	247256.32	295009.22	2/26/2020	FD 3/4" IR	CS 3826
1307	'6B' 2048+61.47	-100.03	247255.91	294809.26	2/26/2020	FD 5/8" IR	CS 3826
1308	'6B' 2045+86.61	-100.17	247513.39	294905.45	2/26/2020	FD 3/4" IR, BENT NE, TIED SPINHOLE	CS 4970
1309	'6B' 2041+86.85	-99.57	247883.24	295047.66	2/26/2020	FD 5/8" IR, BENT NW, TIED SPINHOLE	ODOT 68-3-10
1310	'6B' 2041+87.32	100.01	247959.03	294863.03	2/26/2020	FD 5/8" IR	ODOT 68-3-10

OPC=ORANGE PLASTIC CAP CS=COUNTY SURVEY  
 FD=FOUND IR= IRON REBAR AC=ALUMINUM CAP

**LEGEND**

( )R# SEE SHEET 2 FOR REFERENCE INFORMATION

● SET MONUMENT NOTED IN TABLE

○ FOUND MONUMENT NOTED IN TABLE

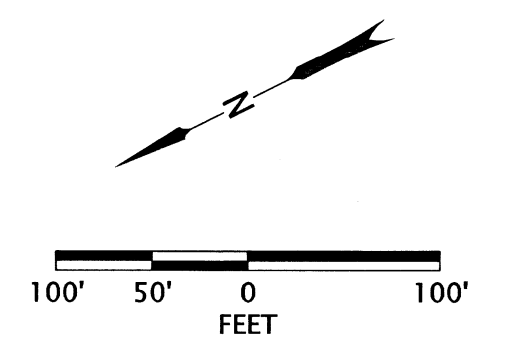

REGISTERED PROFESSIONAL LAND SURVEYOR

*Jason Robert Weisz*

OREGON  
 MARCH 14, 2017  
 JASON ROBERT WEISZ  
 91618

RENEWS: 6-30-2020

**OREGON DEPARTMENT OF TRANSPORTATION**

HORIZONTAL CONTROL, RECOVERY, RETRACEMENT, AND MONUMENTATION MAP

OR62: CURB RAMP UPGRADES PROJECT  
 JACKSON COUNTY

ODOT REGION 3 TECH CENTER  
 100 ANTELOPE RD.  
 WHITE CITY, OR 97503 KEY NO. 22127

MAY 21, 2019  
 SCALE: 1" = 100'  
 SHEET 13 OF 15

NW 1/4 SECTION 20 T36S R1W WM SW 1/4 SECTION 20 T36S R1W WM

**\*\* RECEIVED \*\***  
 DATE 6/19/20 BY RPB  
 This survey consists of:  
15 sheet(s) Map  
6 page(s) Narrative  
 JACKSON COUNTY SURVEYOR

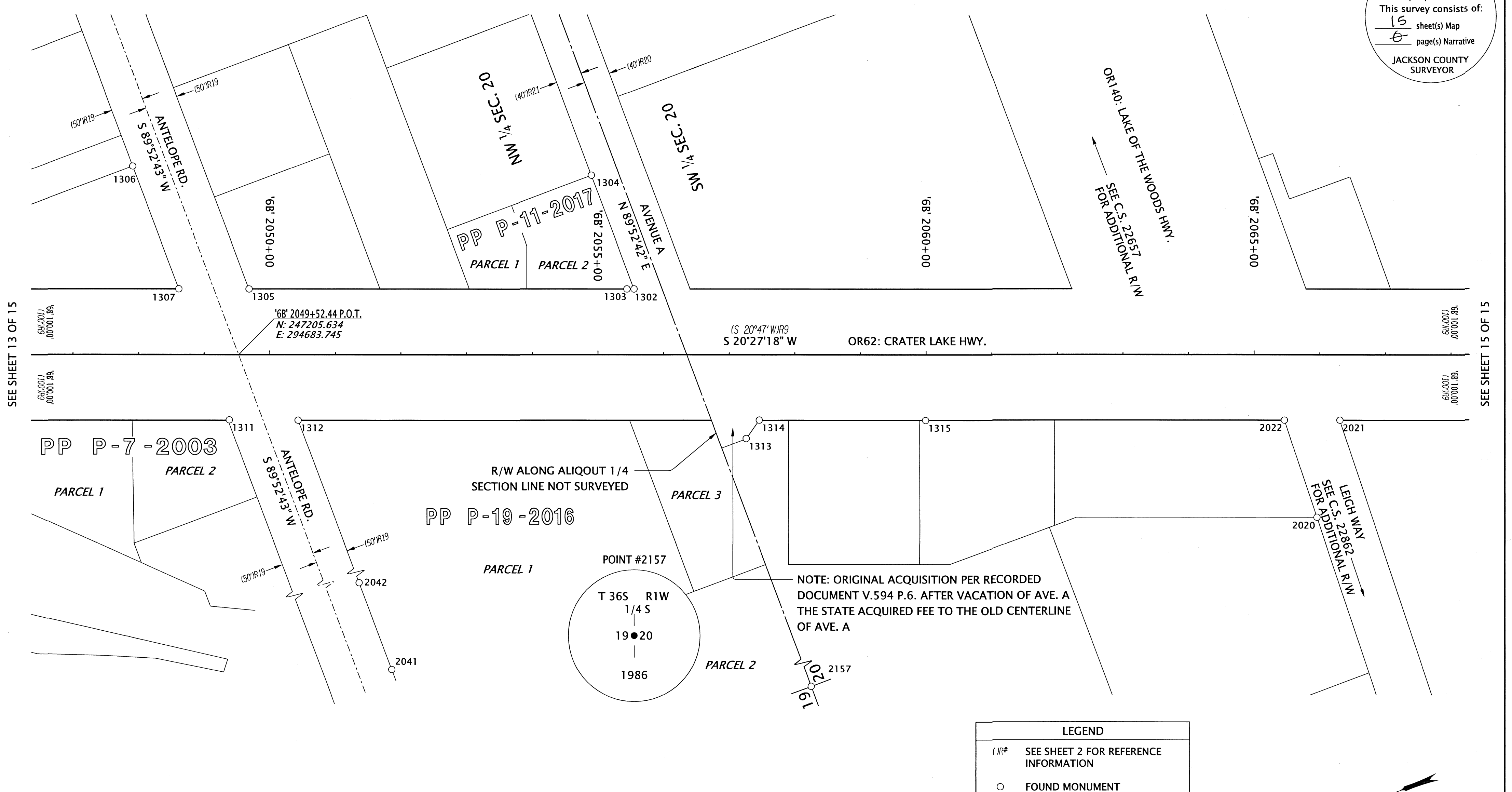

JCS=JACKSON COUNTY SURVEYOR  
 IR= IRON REBAR AC=ALUMINUM CAP CS=COUNTY SURVEY  
 FD=FOUND BPC/YPC/OPC=BLUE/YELLOW/ORANGE PLASTIC CAP IP=IRON PIPE

PT. NO.	STATION	OFFSET	OCRS NORTHING	OCRS EASTING	DATE	DESCRIPTION	REFERENCE DOCUMENT
1302	'6B' 2055+55.19	-100.09	246605.91	294566.88	2/25/2020	FD 5/8" IR w/ YPC PUNCHED THROUGH, LEANING W	CS 20920
1303	'6B' 2055+44.40	-100.06	246616.03	294570.62	2/25/2020	FD 5/8" IR	ORIGIN UNKNOWN
1304	-	-	246606.35	294751.95	2/25/2020	FD IR w/ YPC "BRADSHAW LS 2271"	CS 20920
1305	'6B' 2049+68.64	-99.94	247155.53	294771.72	2/25/2020	FD 3/4" IP	CS 3151
1306	-	-	247256.32	295009.22	2/26/2020	FD 3/4" IR	CS 3826
1307	'6B' 2048+61.47	-100.03	247255.91	294809.26	2/26/2020	FD 5/8" IR	CS 3826
1311	'6B' 2049+38.49	99.39	247253.44	294595.50	2/25/2020	FD 5/8" IR	CS 17651
1312	'6B' 2050+43.38	99.95	247155.36	294558.32	2/26/2020	FD IR w/ OPC "B. KAISER RLS 52923"	CS 21992
1313	'6B' 2057+26.06	127.81	246525.46	294293.64	2/25/2020	FD IR w/ YPC, ILLEGIBLE, BENT NE, TIED SPINHOLE, 1.6' DN	CS 4062
1314	'6B' 2057+45.94	99.77	246497.03	294312.96	2/25/2020	FD 5/8" IR, BENT SE, TIED SPINHOLE	CS 4062
1315	'6B' 2059+99.49	100.24	246259.64	294223.91	2/25/2020	FD IR w/ AC, ILLEGIBLE, 1.3' DN	ODOT 8B-32-12
2020	-	-	245752.54	293877.61	9/6/2018	FD 5/8" IR, BENT SW, 0.4' DN IN ASPHALT	CS 13459
2021	'6B' 2066+30.81	100.00	245668.04	294003.51	9/6/2018	FD 5/8" IR, BENT E'LY, 0.5' DN	CS 15958
2022	'6B' 2065+46.19	100.03	245747.34	294033.05	9/6/2018	FD IR w/ BPC "D. MINNECI LS 2349"	CS 13459
2041	-	-	247152.85	293402.38	10/22/2018	FD 3/4" IR, 0.6' DN	CS 6990
2042	-	-	247153.16	293543.54	10/22/2018	FD IR w/ YPC "D.W. EDWARDS LS 741"	CS 15336
2157	-	-	246562.51	292944.00	11/19/2018	FD 3" BRASS DISK "T36S R1W 1/4 S 19/20 1986"	JCS 5TH RE-ESTAB 11/17/86

**LEGEND**  
 ( )IR# SEE SHEET 2 FOR REFERENCE INFORMATION  
 ○ FOUND MONUMENT NOTED IN TABLE

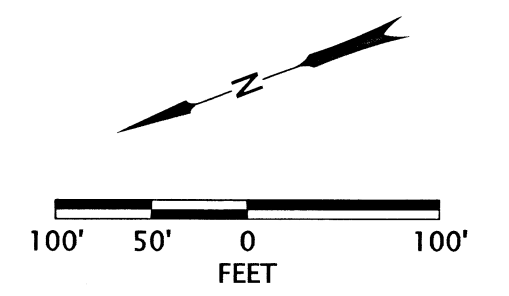

REGISTERED PROFESSIONAL LAND SURVEYOR  
  
 OREGON  
 MARCH 14, 2017  
 JASON ROBERT WEISZ  
 91618  
 RENEWS: 6-30-2020

**OREGON DEPARTMENT OF TRANSPORTATION**  
 HORIZONTAL CONTROL, RECOVERY, RETRACEMENT, AND MONUMENTATION MAP  
 OR62: CURB RAMP UPGRADES PROJECT  
 JACKSON COUNTY

ODOT REGION 3 TECH CENTER  
 100 ANTELOPE RD.  
 WHITE CITY, OR 97503 KEY NO. 22127

MAY 21, 2019  
 SCALE: 1" = 100'  
 SHEET 14 OF 15



SW 1/4 SECTION 20 T36S R1W WM NW 1/4 SECTION 29 T36S R1W WM

**\*\* RECEIVED \*\***  
 DATE 6/19/20 BY PB  
 This survey consists of:  
15 sheet(s) Map  
0 page(s) Narrative  
 JACKSON COUNTY  
 SURVEYOR

SEE SHEET 14 OF 15

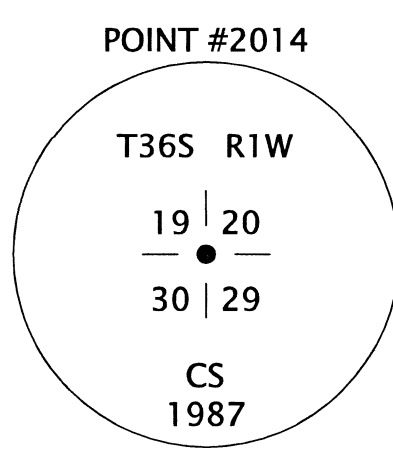
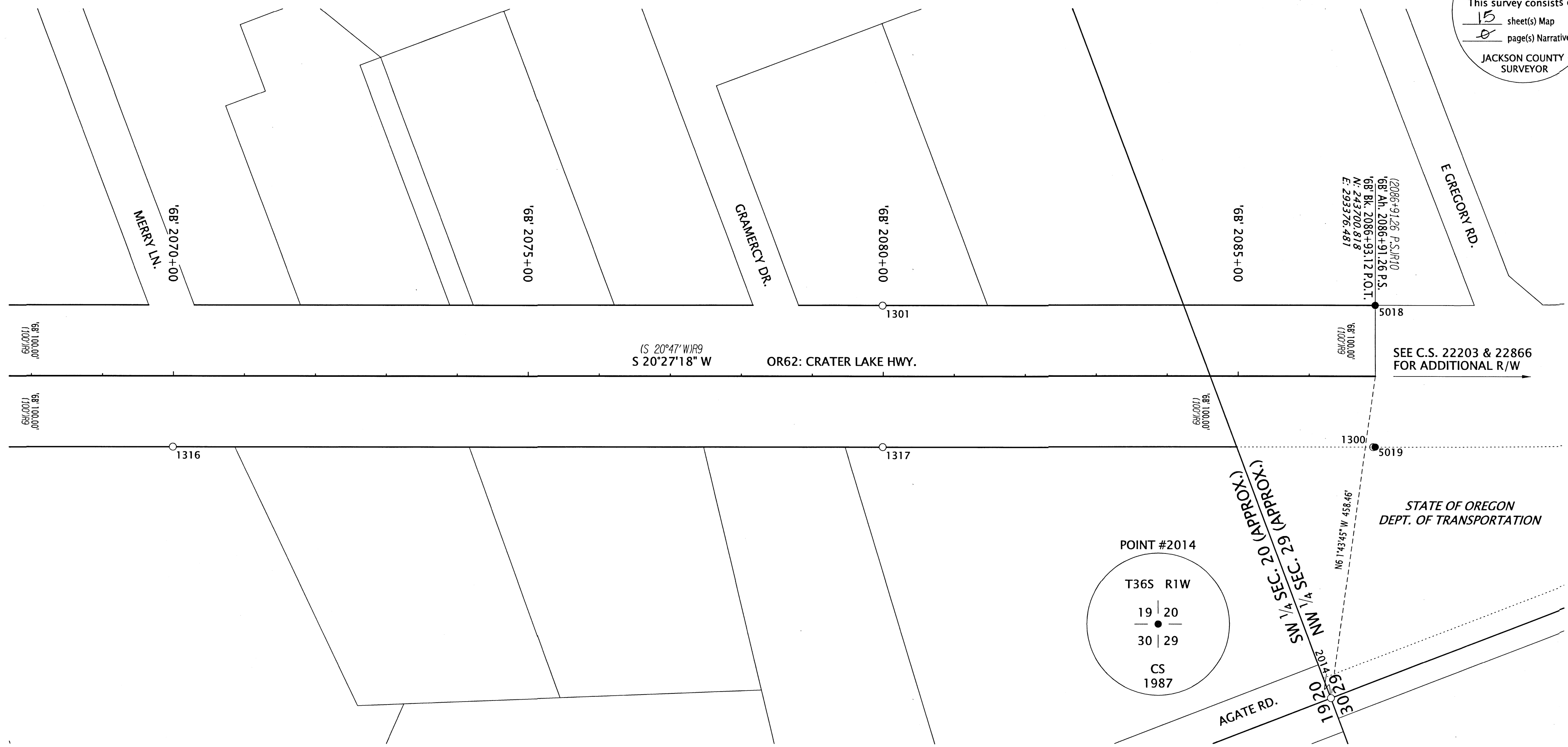

SET MONUMENT TABLE

IR=IRON REBAR AC=ALUMINUM CAP

PT. NO.	STATION	OFFSET	OCRS NORTHING	OCRS EASTING	DATE	DESCRIPTION
5018	'6B' Bk. 2086+93.12	-100.00	243665.87	293470.18	5/21/2020	SET 5/8" X 30" IR w/ AC "ODOT RIGHT OF WAY"
5019	'6B' Bk. 2086+93.12	100.00	243735.77	293282.79	5/21/2020	SET 5/8" X 30" IR w/ AC "ODOT RIGHT OF WAY"

RECOVERED MONUMENT TABLE

JCS=JACKSON COUNTY SURVEYOR  
 FD=FOUND IR= IRON REBAR AC=ALUMINUM CAP DN=DOWN

PT. NO.	STATION	OFFSET	OCRS NORTHING	OCRS EASTING	DATE	DESCRIPTION	REFERENCE DOCUMENT
1300	'6B' 2086+90.32	100.20	243738.46	293283.58	2/25/2020	FD 5/8" IR, BENT W, TIED SPINHOLE	ODOT 6B-3-11
1301	'6B' 2079+99.09	-99.76	244316.22	293712.50	2/25/2020	FD IR w/ AC, ILLEGIBLE, w/ PADDLE "SHRW 2080+00 125"	ODOT 8B-32-12
1316	'6B' 2069+99.43	99.93	245322.63	293874.75	2/26/2020	FD IR w/ AC, ILLEGIBLE, 0.8' DN	ODOT 8B-32-12
1317	'6B' 2079+99.31	99.88	244385.78	293525.36	2/26/2020	FD 5/8" IR	ODOT 8B-32-12
2014	-	-	243917.96	292972.71	9/4/2018	FD 2.5" BRASS DISK "19/20/30/29 C.S. 1987"	JCS 3RD RE-ESTAB 1/6/87

**LEGEND**

(IR#) SEE SHEET 2 FOR REFERENCE INFORMATION

● SET MONUMENT NOTED IN TABLE

○ FOUND MONUMENT NOTED IN TABLE

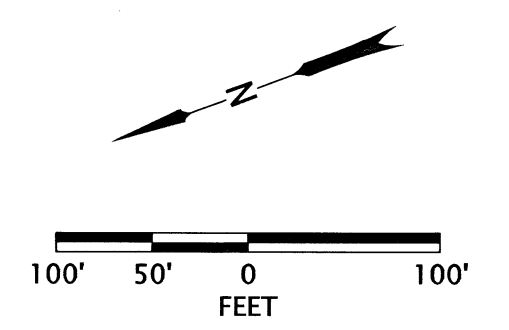

REGISTERED PROFESSIONAL LAND SURVEYOR  
*Jason Robert Weisz*  
 OREGON  
 MARCH 14, 2017  
 JASON ROBERT WEISZ  
 91618  
 RENEWS: 6-30-2020

**OREGON DEPARTMENT OF TRANSPORTATION**  
 HORIZONTAL CONTROL, RECOVERY, RETRACEMENT, AND MONUMENTATION MAP  
 OR62: CURB RAMP UPGRADES PROJECT  
 JACKSON COUNTY

ODOT REGION 3 TECH CENTER  
 100 ANTELOPE RD.  
 WHITE CITY, OR 97503 KEY NO. 22127

MAY 21, 2019  
 SCALE: 1" = 100'  
 SHEET 15 OF 15