

OREGON CORNER RESTORATION FORM

23037

SECTION 2

TOWNSHIP 35 S.

RANGE 3 W.

COUNTY JACKSON

DATE 2/24/2020

TRACT SARDINE CREEK

CORNER DESIGNATION:

T35S R3W

S2 1/4
○
S11

POINT IDENTIFIER 540600

- CONDITION REPORT ONLY
- NOT FOUND
- RENEWED
- UNRECORDED
- SURVEYED IN
- REFERENCED OUT

PREVIOUS RENEWALS/SURVEYS, ETC:

ACCESSORIES FOUND: (CONDITION AND SOURCE)

29" PINE BEARS S80°E 5.3 FT. AS PER BLM BT TAG THAT READS N80°W 8 lks., WELL HEALED FACE
27" PINE BEARS N14 1/2°E 11.9 FT. AS PER BLM BT TAG READS S14 1/2°W 18 lks., WELL HEALED FACE

SKETCH:
(NOT TO SCALE)

MONUMENT DETAIL:

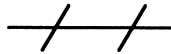
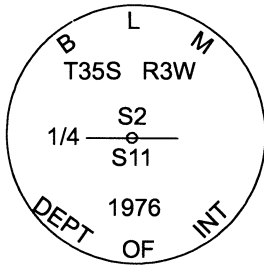

PROPERTY LINE REBLAZED FROM EXISTING BLAZES AND TAGS BY McMAHAN PLS 1913, 1997 MAP #15466 FILED IN JACKSON CO.SURVEYORS OFFICE.

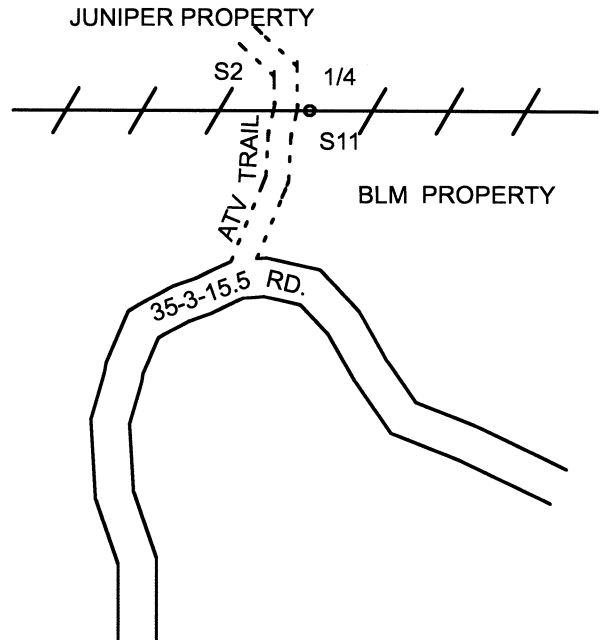

MONUMENT:

FOUND 1971 BLM BCIP PER BLM FIELD NOTES FILED IN JACKSON COUNTY SURVEYORS OFFICE

NEW ACCESSORIES:

15" DOUG FIR BEARS N83°W 29.1 FT. WE SCRIBE T35S R3W 1/4 S2 BT AND TAG TREE
13" DOUG FIR BEARS S43°W 55.1 FT. WE SCRIBE T35S R3W 1/4 S11 BT AND TAG TREE

LOCATION & COMMENTS:

FOUND 1971 BLM BCIP AT EAST EDGE OF ATV TRAIL,
APPROX. 175 FT. NORTHERLY OF 35-3-15.5 ROAD.
PUT METAL U-POST APPROX. 1.0 FT. NORTH OF
CORNER MONUMENT.

BEARING BASIS: MAGNETIC COMPASS

BEARING (16° DECLINATION)

FIRM/AGENCY: LONE ROCK TIMBER MANAGEMENT CO.

ADDRESS: P.O. BOX 1127

ROSEBURG, OR 97470

PARTY CHIEF: KEN W. HOFFINE

NOTES: GARY ANGIOLET

WITNESS: IGNACIO ROMAN

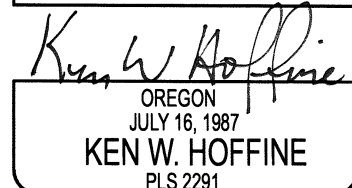
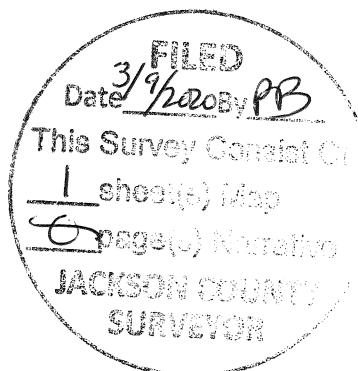

EXPIRES 6-30-21