

CORNER OF SECTIONS 5 & 6, T.34S., R.3E., AND SECTIONS 31 & 32, T.33S., R.3E.:
 FOUND 2" I.D. IRON POST WITH 3 1/4" BC STAMPED "T33S R3E S31 S32 S6 S5 T34S 1983", 4" ABOVE GROUND, IN A 2' COLLAR OF STONE, PER R2, FROM WHICH BEARS:
 32" WF WITH HB N80 3/4°E 56.4' F=R2 & R3
 8" WF WITH VS N21 1/2°W 5.6' F= R3
 2" O.D. IRON PIPE WITH IRON CAP, ILLEGIBLE, N17°56'E 30.22' F (N18°42'E 29.7' R2)

JOHN HANCOCK
 LIFE INSURANCE
 COMPANY (U.S.A.)
 D.N. 2017-010772
 T.L. 800

C-E 1/16 CORNER OF SECTION 6:
 FOUND 5/8" REBAR WITH 1 1/2" AC, STAMPED "RE 4186 CE 1/16 S8 [IN-CORRECTLY STAMPED] T34S R3E", 6" ABOVE GROUND, PER R1, FROM WHICH BEARS:

11" WF SCRIBED "XBT" THIS SURVEY S75°E 16.8'
 12" WF SCRIBED "XBT" THIS SURVEY N51°W 7.9'
 WF STUMP, ROTTED, S80 1/4°W 26.0' F=R4

1/4 CORNER OF SECTIONS 5 & 6:
 FOUND 2" I.D. IRON POST WITH 3 1/4" BC STAMPED "1/4 S6 S5 T33S R3E 1964", 6" ABOVE GROUND, IN A 2 1/2' COLLAR OF STONE, PER R4, FROM WHICH BEARS:

19" WF SCRIBED "XBT" THIS SURVEY N59°E 5.2'
 9" WF SCRIBED "XBT" THIS SURVEY S4 3/4°E 27.4'

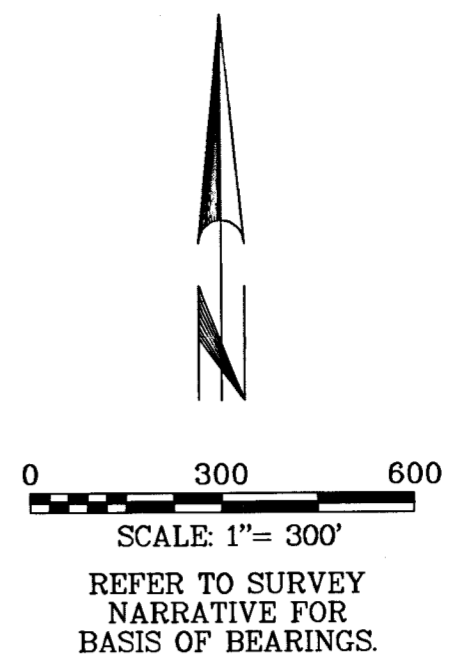
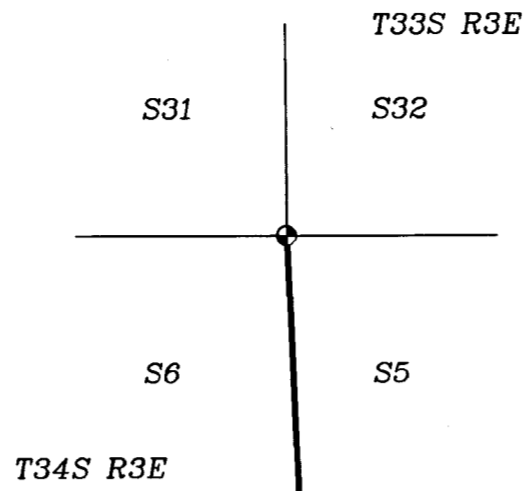

U.S.A.
 T.L. 700

U.S.A.
 T.L. 700

C-S 1/16 CORNER OF SECTION 6:
 FOUND 5/8" REBAR WITH 1 1/2" AC, STAMPED "RE 4186 CS 1/16 S8 [IN-CORRECTLY STAMPED] T34S R3E", 12" ABOVE GROUND, IN A 2' STONE COLLAR, PER R1, FROM WHICH BEARS:

11" CH WITH VS, D&D, S79°W 7.7' F=R1
 40" DF WITH HB S64°E 24.2' F (S60°E 23.7' R1)

S88°30'18"W 1287.04' F
 (N88°30'E 1286.7' R1)

SE 1/16 CORNER OF SECTION 6:
 FOUND 5/8" REBAR WITH 1 1/2" AC, STAMPED "RE 4186 SE 1/16 S8 [IN-CORRECTLY STAMPED] T34S R3E", 8" ABOVE GROUND, PER R1, FROM WHICH BEARS:

40" WF WITH HB N14°W 23.9' F (N11°W R1)
 36" DF WITH HB N29°E 27.3' F (N33°E R1)

SURVEY NARRATIVE:

THE PURPOSE OF THIS SURVEY IS TO POST AND BLAZE THE LINE BETWEEN TAX LOTS 700 & 800, AS SHOWN IN BOLD HEREON.

USING FOUND MONUMENTS AS SHOWN, I RETRACED THE 1975 SURVEY BY LORNE VAN SWEARINGTON (CS 6108), TO MARK THE LINES AS DESCRIBED IN DEED FOR TAX LOT 800 (D.N. 2017-010772).

THIS SURVEY WAS CONDUCTED USING A TOPCON GTS 3003W TOTAL STATION AND TOPCON HIPER AND GR3 STATIC GPS RECEIVERS. THE FIELD SURVEY COMMENCED OCT. 15, 2019 AND WAS COMPLETED OCT. 17, 2019.

THE BASIS OF BEARINGS FOR THIS SURVEY IS GEODETIC (NAD83), AT THE CORNER OF SECTIONS 5, 6, 31, & 32 SHOWN HEREON, BASED ON STATIC GPS OBSERVATIONS TO CONTINUOUSLY OPERATING REFERENCE STATIONS (EPOCH 2010.00).

ALL FIELD BEARING AND DISTANCES TO BEARING TREES ARE TO THE CENTER OF THE TREE AT THE GROUND.

LEGEND OF SYMBOLS & ABBREVIATIONS

- ⊙ FOUND MONUMENT AS NOTED.
- AC ALUMINUM CAP
- BC BRASS CAP
- BLM BUREAU OF LAND MANAGEMENT
- CH CHINQUAPIN
- D&D DEAD & DOWN
- DF DOUGLAS FIR
- D.N. DOCUMENT NUMBER
- F FIELD MEASUREMENT
- GIP GALVANIZED IRON PIPE
- HB HEALED BLAZE
- I.D. INSIDE DIAMETER
- O.D. OUTSIDE DIAMETER
- WF WHITE FIR
- VS VISIBLE SCRIBING
- () INDICATES RECORD DATA

REFERENCES:

- R1 = CS 6108
- R2 = BLM NOTES FOR 1983 SURVEY BY TERRANCE O. NICKERSON.
- R3 = CS FIRST REESTABLISHMENT OF NORTHEAST CORNER OF SEC. 6, T.34S., R.3E., W.M.
- R4 = BLM 1964 REMONUMENTATION NOTES BY JOSEPH S. GAWRON.

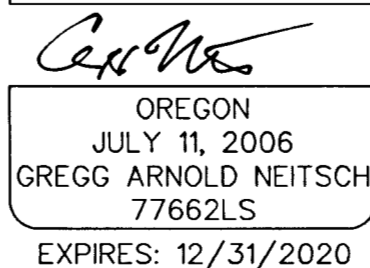
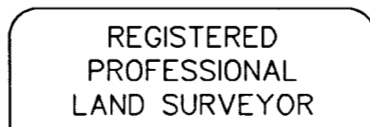
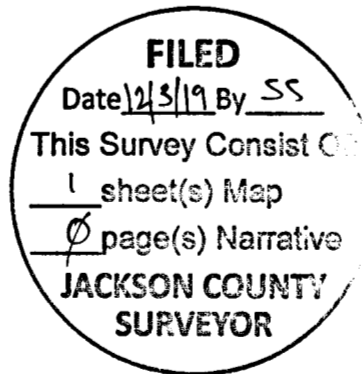

MAP OF SURVEY

FOR
 HANCOCK FOREST MANAGEMENT

IN THE EAST HALF OF SECTION 6,
 T. 34 S., R. 3 E., W.M.,
 JACKSON COUNTY, OREGON

NORTH STATE LAND SURVEYING
 1511 KYLYNN CT.
 MOUNT SHASTA, CA

OCT. 2019 SCALE: 1"=300' SHEET 1 OF 1
 FREDGND.ASC FRED2 MOS.GXD JOB NO. 593