



BASIS OF BEARING IS TRUE NORTH, NAD 83/91 DATUM, AS DERIVED BY GLOBAL POSITIONING SYSTEM OBSERVATIONS.

MAP OF SURVEY
 located in the
 SOUTHEAST AND SOUTHWEST QUARTER SECTION OF 17
 TOWNSHIP 33 SOUTH, RANGE 3 EAST,
 WILLAMETTE MERIDIAN, JACKSON COUNTY, OREGON
 for
HANCOCK FOREST MANAGEMENT
 572 PARSONS DRIVE, SUITE 124
 MEDFORD, OREGON 97501

LEGEND

⊠ = FOUND 2 1/2" BRASS CAP

- RECORD SURVEY DATA IS SHOWN IN PARENTHESIS ADJACENT TO MEASURED SURVEY DATA WHERE APPLICABLE.
- INST. NO. = INSTRUMENT NUMBER AS RECORDED IN THE OFFICIAL RECORDS OF JACKSON COUNTY, OREGON.

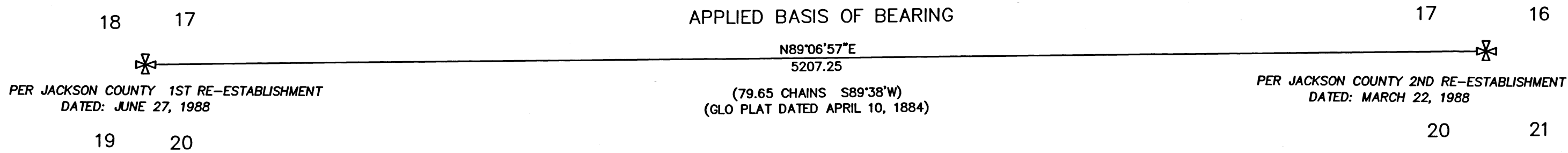

NOTE: LINE WAS MARKED AND BLAZED TO HANCOCK FOREST MANAGEMENT STANDARDS.

**** FILED ****
 DATE 10/29/18 BY PB
 This survey consists of:
 1 sheet(s) Map
 2 page(s) Narrative
 JACKSON COUNTY SURVEYOR

REGISTERED PROFESSIONAL LAND SURVEYOR
Richard E. Stein
 OREGON
 FEBRUARY 8, 2000
 RICHARD E. STEIN
 49593LS
 RENEWAL DATE: 06/30/2020

SURVEY NARRATIVE TO COMPLY WITH O.R.S. 209.250

PURPOSE: TO SURVEY AND MARK A PORTION OF THE BOUNDARY OF THAT PARCEL OF LAND DESCRIBED AS TRACT 19.1, IN INSTRUMENT NUMBER 2017-10772, OF THE OFFICIAL RECORDS OF JACKSON COUNTY, OREGON. THE PROJECT NAME IS LILAC PLOT. I REVIEWED WORK PREVIOUSLY DONE BY FARBER AND FIND IT TO MEET ALL REQUIREMENTS OF ORS 209.250

PROCEDURE: A FIELD SURVEY WAS CONDUCTED AND MONUMENTS OF RECORD WERE RECOVERED AND TIED AS SHOWN. A CLOSED TRAVERSE WAS RUN TO ESTABLISH THE BOUNDARY, AND THE LINE WAS BLAZED AND MARKED PER HANCOCK FOREST MANAGEMENT STANDARDS. A SEARCH FOR THE SOUTH 1/4 CORNER OF SECTION 17 WAS CONDUCTED, BUT NO EVIDENCE WAS FOUND. NO MONUMENTS WERE SET DURING THIS SURVEY.

Surveyed by:
 FARBER & SONS, INC. dba



PO BOX 5286
 431 OAK STREET
 CENTRAL POINT, OREGON 97502
 (541) 664-5599

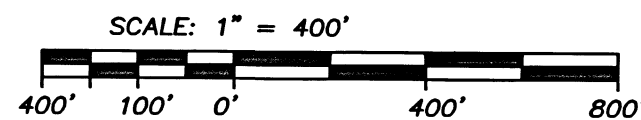

Sheet 1 of 1