

**SURVEY FOR:**  
 CECIL OLINE  
 8814 OAKDALE DRIVE  
 MEDFORD, OR 97501

**SURVEY BY:**  
 L.J. FRIAR & ASSOCIATES, P.C.  
 CONSULTING LAND SURVEYORS  
 PO BOX 1947  
 PHOENIX, OR 97535  
 PHONE: (541) 772-2782  
 EMAIL: LJFRIAR@CHARTER.NET

**DATE:**  
 AUGUST 12, 2018

**MAP OF SURVEY**  
 In Lot 19 of HOLMES PARK &  
 located in the N.E. 1/4 of Sec. 36, T.37S, R.2W., W.M.  
 City of Medford Jackson County, Oregon

**LEGEND:**

- ⊙ = FD. COUNTY SURVEYOR'S BRASS CAPPED MONUMENT PER {YEAR} RE-ESTAB'S.
- ⊙ = FD. BRASS CAP MKD. CITY OF MEDFORD SURVEYOR IN CONCRETE PER FS15116.
- = FD. 1" IRON PIPE PER HP.
- ⊙ = FD. 2" BOLT AT BASE OF SIGNAL LIGHT. SEE COUNTY RE-ESTABS FOR SW COR DLC #44.
- = SET 5/8" X 24" IRON PIN & PLASTIC CAP MKD. L.J. FRIAR & ASSOC.

- C1 = SEE COURSE DATA TABLE.
- ORJCO = OFFICIAL RECORDS OF JACKSON COUNTY, OREGON.
- WC = WITNESS CORNER.
- ( ) = RECORD DATA PER HP.
- FS = FILED SURVEY #.
- HP = HOLMES PARK.
- { } = RECORD DATA PER COUNTY SURVEYOR RE-ESTAB'S.
- RW1 = RIGHT OF WAY PER PER DOC. 89-04234, ORJCO.
- RW2 = RIGHT OF WAY PER PER DOC. 89-04232, ORJCO.
- X- = FENCE LINE.

**BASIS OF BEARINGS:**  
 CENTERLINE OF STEWART AVENUE PER DOC. 89-04234, ORJCO AS SHOWN HEREON.  
 UNIT OF MEASUREMENT = FEET SCALE: 1" = 30'

**SURVEY NARRATIVE TO COMPLY WITH O.R.S. 209-250**

**PURPOSE:** TO SURVEY AND MONUMENT THE LINE BETWEEN LOTS 19 & 20 OF HOLMES PARK.

**PROCEDURE:** USING TRIMBLE R8 G.P.S. RECEIVERS AND TRIMBLE S8 ROBOTIC TOTAL STATION, MADE TIES TO MONUMENTS OF RECORD AS SHOWN HEREON TO CONTROL THE R/W AND THE SUBJECT TRACT. COMPUTED THIS PORTION OF HOLMES PARK USING THE FOUND MONUMENTS AS SHOWN AND THEN USED PROPORTIONATE METHOD TO POSITION THE LINE BETWEEN LOTS 19 & 20. THE R/W OF STEWART AVENUE WAS CONTROLLED BY DOC. 89-04232 & 89-04234, ORJCO. WITH THE POSITION OF THE LOT LINE POSITIONED, SET MONUMENTS AT THE LOCATIONS SHOWN HEREON.

NUM	DELTA	ARC	RADIUS	CHORD
C1	89°56'25"	23.55	15.00	S45°05'29"W 21.20
C2	90°04'11"	23.58	15.00	N44°54'13"W 21.23
C3	90°16'05"	23.63	15.00	N45°13'18"E 21.26
C4	90°04'04"	23.58	15.00	S44°54'45"E 21.23
C5	03°26'12"	149.61	2494.29	N88°13'12"W 149.59
C6	02°35'05"	112.52	2494.29	N88°38'46"W 112.51
C7	00°51'07"	37.09	2494.29	N86°55'40"W 37.09
C8	03°26'12"	150.57	2510.29	S88°13'12"E 150.55
C9	01°05'48"	48.05	2510.29	S87°03'01"E 48.05
C10	02°10'11"	95.07	2510.29	S88°41'00"E 95.06
C11	00°10'12"	7.45	2510.29	S89°51'12"E 7.45

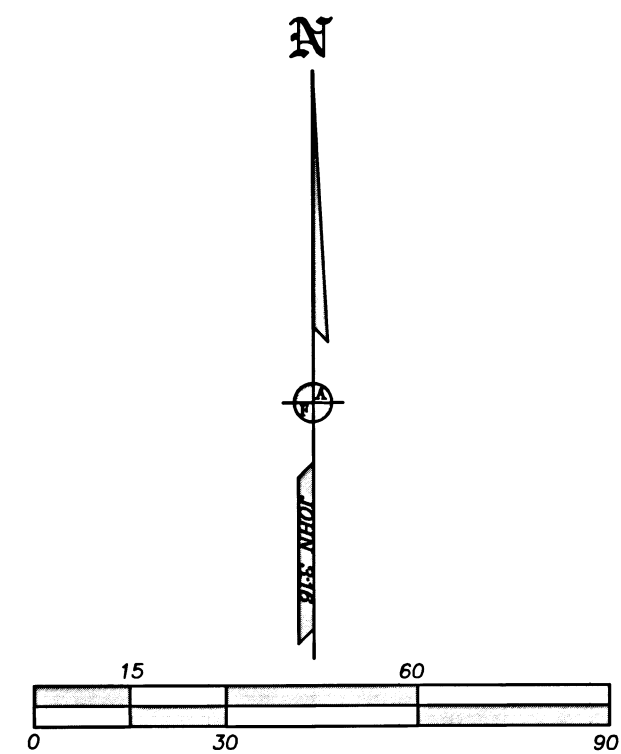

REGISTERED PROFESSIONAL LAND SURVEYOR  
 JAMES E. HIBBS  
 OREGON  
 JULY 17, 1986  
 RENEWAL DATE: 6-30-19

FILED  
 Date 8/16/18 By PB  
 This Survey Consists Of:  
 1 sheet(s) Map  
 0 page(s) Narrative  
 JACKSON COUNTY SURVEYOR