

# Map of Survey

Located at:  
**Gebhard Road/Beebe Road, Central Point, OR 97502**  
 Township 37 South, Range 2 West, Section 2  
 (37-2W-2 Tax Lot 2700/2701)

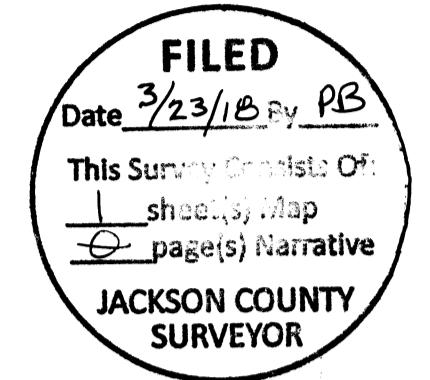

**Survey For:** Adroit Construction  
 PO Box 690  
 Ashland, OR 97520

**Survey By:** Pariani Land Surveying  
 P.O. Box 551  
 Shady Cove, OR 97539

**Survey Data:**  
 Basis of Bearing: The north line of DLC 55 per: Filed Survey 10523  
 Equipment: Trimble S6, fully robotic Total Station

The purpose of this survey is to establish the boundaries of that property described in deed 2014-033870.

Gebhard Road was resolved using the 1/2" pipe on the center line of the 1910 road survey and the 1-1/2" pipe corner on the north line of DLC 55 and west of center line 25 feet, per filed survey 10523. When offsetting this center 20 feet to the west and extending to the north, it fit very well with the Neathamer corner on the west line per filed survey 20202.

Beebe Road center line was resolved using the 3/4" bolt set at the P.I. per Jackson County Road Department survey in roll map number 35/6, and then rotating the record alignment per said roll map 35/6 to a point that is on the east line of DLC 55 and 1413.30 feet northerly from the SE corner DLC 55 per FS 1026.

The easterly line of the subject property was resolved by holding the Farber pins per filed survey 21110, which fit well with the record and deed locations.

The westerly line was determined by deed distances. However, there is an apparent gap between the westerly line of the subject property and the east line of Gebhard Road. The gap width varies. Also, Volume 179, Page 89 excepted out right of way calls to the NE Corner of DLC 55 from the beginning and end of the excepted out area, these calls are approximate, do not fit the existing roadway and have about 99 feet of error in its closure. I adjusted the location of the excepted out area to the south to fit the existing road. Ties to the NE Corner of DLC 55 are defined with Point A and Point B on the map. Below are the calculated vs. record values of the ties to the NE Corner DLC 55.  
 Point A: 1927.40' West, 957.96' South ((1927.4± West, 937.5± South))  
 Point B: 1241.94' South, 1768.26' West ((1320± South, 1768.2± West))

Property corners were not set on this survey.

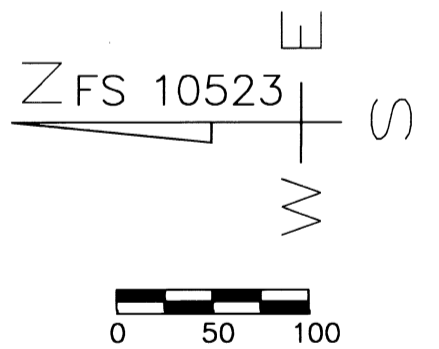

### Legend:

- Existing Edge of Pavement
- - - Center Line
- - - DLC Lines
- Boundary Lines
- Calculated Corner Position
- Found Monument as Noted
- Filed Survey
- ( ) Record Data per FS 10523
- (( )) Record Data per Vol. 174, Pg. 89
- R= Jackson County Road Records File
- D= Record Data per FS 21110
- D= Record Data per Deed 2014-33870

REGISTERED  
 PROFESSIONAL  
 LAND SURVEYOR

*John R. Pariani*

OREGON  
 July 13, 1999  
 JOHN R. PARIANI  
 #51382

Renews: December 31, 2018

## Pariani Land Surveying

P.O. Box 551  
 Shady Cove, OR 97539  
 541-890-1131

Date:	Scale:	Job No.:	Sheet:
March 22, 2018	1" = 100'	2016-316	1 of 1

37S-2W-S02 TL2700 & TL2701