

MAP OF SURVEY FOR LUANN CASEY 61-470 KAMEHAMEHA HIGHWAY HALEIWA, HI 96721

AT 106 SOUTH PIONEER STREET LOCATED IN THE NORTHWEST QUARTER OF SECTION 9, TOWNSHIP 39 SOUTH, RANGE 1 EAST OF THE WILLAMETTE MERIDIAN, JACKSON COUNTY, OREGON

FILED Date 12/19/17 By PB This Survey Consists Of: 1 sheet(s) Map 1 page(s) Narrative JACKSON COUNTY SURVEYOR

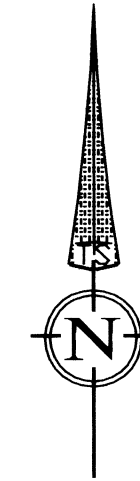

DATE: 11-28-17 SCALE: 1"= 80'

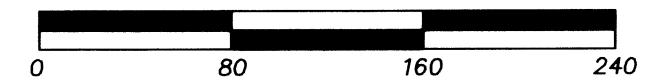

LEGEND

- S/N SURVEY NUMBER, FILED AT THE SURVEYOR'S OFFICE, JACKSON COUNTY, OREGON. VOL. PG. VOLUME AND PAGE OF THE DEED RECORDS OF JACKSON COUNTY, OREGON. INST. No. INSTRUMENT NUMBER OF THE OFFICIAL RECORD OF JACKSON COUNTY, OREGON. P.R. PLAT RECORD PER MAP OF HARGADINE TRACT IN THE TOWN OF ASHLAND, OREGON. - x - FENCE AS INDICATED. O FOUND 5/8 INCH IRON PIN MONUMENT PER S/N 20783 OR AS INDICATED. S FOUND 5/8 INCH IRON PIN MONUMENT PER S/N 7902 OR AS INDICATED. B FOUND BRASS CAP AS INDICATED. ● SET 5/8 BY 24 INCH IRON PIN WITH ORANGE PLASTIC CAP MARKED "FRANTZ LS 50077" OR AS INDICATED. ● SET LEAD AND TACK W/BRASS TAG MARKED "LS50077". R1 IS RECORD DATA PER 1888 MAP OF THE CITY OF ASHLAND. R2 IS RECORD DATA PER S/N 20783. R3 IS RECORD DATA PER S/N 16917. R4 IS RECORD DATA PER S/N 11034. R5 IS RECORD DATA PER S/N 7902. R6 IS RECORD DATA PER S/N 3961. R7 IS RECORD DATA PER S/N 12095. BASIS OF BEARING IS THE SOUTH LINE OF D.L.C. 40 PER S/N 7920 AS SHOWN HEREON. SAID BEARING BEING S 89°51'58"E. NARRATIVE IS A SEPERATE DOCUMENT.

REGISTERED PROFESSIONAL LAND SURVEYOR

Fred A. Frantz OREGON JULY 12, 2005 FRED A. FRANTZ No. 50077

Renewal 12-31-17

S.E. CORNER DLC No. 40 FOUND BRASS DISK ATOP 6" BY 6" CONCRETE POST PER S/N 8130

173.35' (173.37')R3 CENTER LINE TO DLC CORNER

FOUND 1" SQUARE BOLT BEARS: N54°33'55"W 0.10' FROM SOUTH LINE DLC 40

958.28' (958.20')R4 N89°51'58"W 2471.69' (BASIS OF BEARING)

S.W. CORNER DLC No. 40 FOUND BRASS DISK IN TOP CONCRETE STEP PER S/N 11188

FOUND 5/8" IRON PIN PER S/N 12095 BEARS: S44°57'16"E 0.34'

MONUMENT BEARS: N44°57'16"W 0.23'

MONUMENT BEARS: S44°57'16"E 0.13'

FOUND 1/2" IRON PIPE IN MONUMENT CASE

FOUND LEAD AND TACK W/BRASS TAG PER S/N 17534

FOUND 1/2" IRON PIPE PER S/N 97

FOUND 5/8" IRON PIN PER S/N 16917

INST. No. 2017-022086

SW COR. VOL. 113 PG. 406

FOUND 3/4" IRON PIPE IN CONCRETE (NOT OF RECORD)

FOUND 1/2" IRON PIPE IN MONUMENT CASE

SEE DETAIL

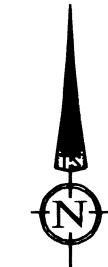
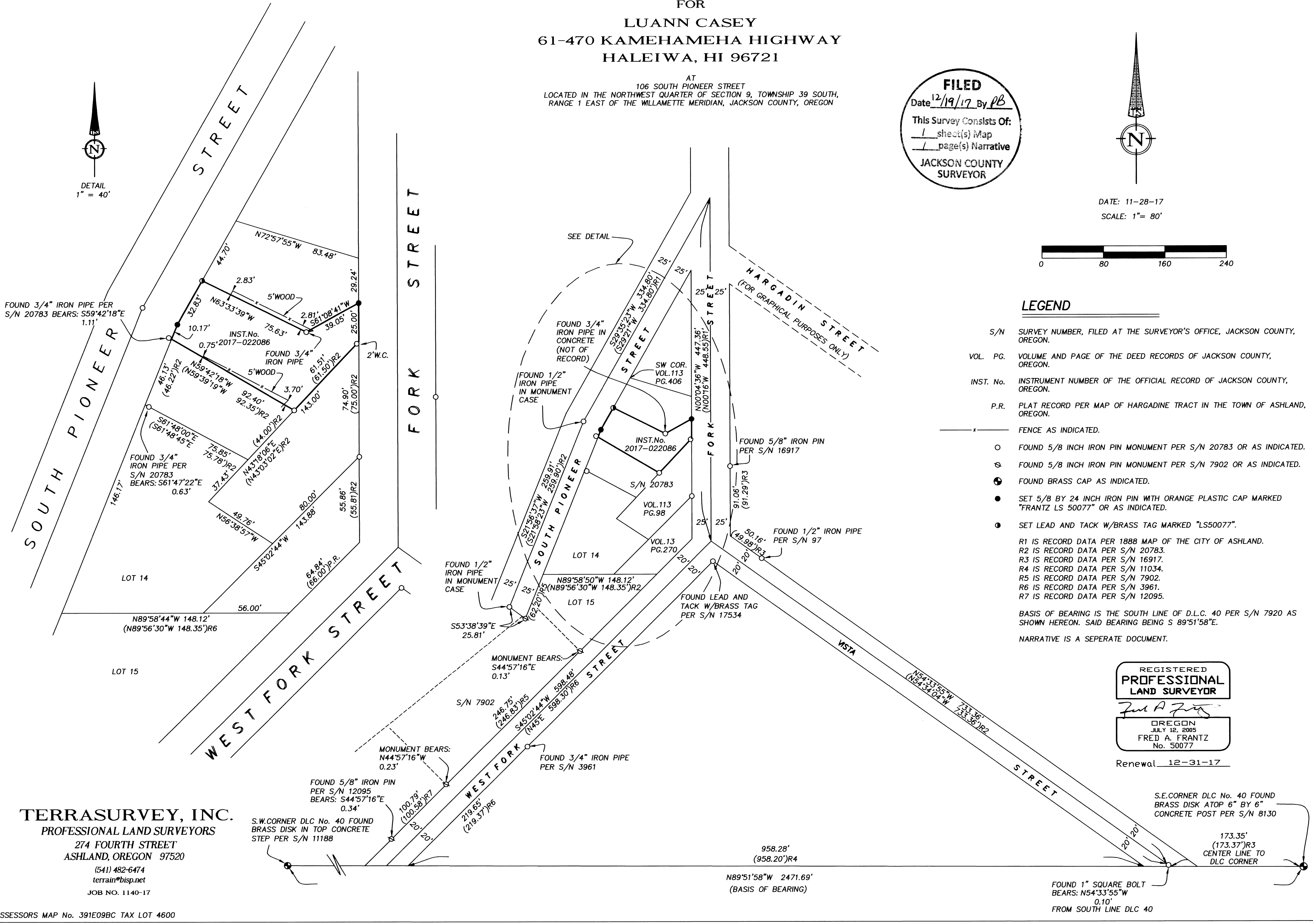

DETAIL 1" = 40'

FOUND 3/4" IRON PIPE PER S/N 20783 BEARS: S59°42'18"E 1.11'

INST. No. 0.75-2017-022086

FOUND 3/4" IRON PIPE

FOUND 3/4" IRON PIPE PER S/N 20783 BEARS: S61°47'22"E 0.63'

FOUND 3/4" IRON PIPE PER S/N 20783 BEARS: S61°48'45"E

FOUND 3/4" IRON PIPE PER S/N 20783 BEARS: S61°48'45"E

FOUND 3/4" IRON PIPE PER S/N 20783 BEARS: S61°48'45"E

FOUND 3/4" IRON PIPE PER S/N 20783 BEARS: S61°48'45"E

FOUND 3/4" IRON PIPE PER S/N 20783 BEARS: S61°48'45"E

FOUND 3/4" IRON PIPE PER S/N 20783 BEARS: S61°48'45"E

FOUND 3/4" IRON PIPE PER S/N 20783 BEARS: S61°48'45"E

FOUND 3/4" IRON PIPE PER S/N 20783 BEARS: S61°48'45"E

FOUND 3/4" IRON PIPE PER S/N 20783 BEARS: S61°48'45"E

FOUND 3/4" IRON PIPE PER S/N 20783 BEARS: S61°48'45"E

FOUND 3/4" IRON PIPE PER S/N 20783 BEARS: S61°48'45"E

FOUND 3/4" IRON PIPE PER S/N 20783 BEARS: S61°48'45"E

FOUND 3/4" IRON PIPE PER S/N 20783 BEARS: S61°48'45"E

FOUND 3/4" IRON PIPE PER S/N 20783 BEARS: S61°48'45"E

FOUND 3/4" IRON PIPE PER S/N 20783 BEARS: S61°48'45"E

FOUND 3/4" IRON PIPE PER S/N 20783 BEARS: S61°48'45"E

FOUND 3/4" IRON PIPE PER S/N 20783 BEARS: S61°48'45"E

TERRASURVEY, INC. PROFESSIONAL LAND SURVEYORS 274 FOURTH STREET ASHLAND, OREGON 97520 (541) 482-6474 terrain@bisp.net JOB NO. 1140-17

Survey Number 22435

**SURVEY NARRATIVE**

TO COMPLY WITH PARAGRAPH 209.250, OREGON REVISED STATUTES

DATE OF SURVEY:

November 28, 2017

SURVEYED BY:

Terrasurvey, Inc  
274 Fourth Street  
Ashland, Oregon 97520

SURVEY FOR:

Luann Casey  
61-470  
Kam Highway  
Haleiwa, HI 96721

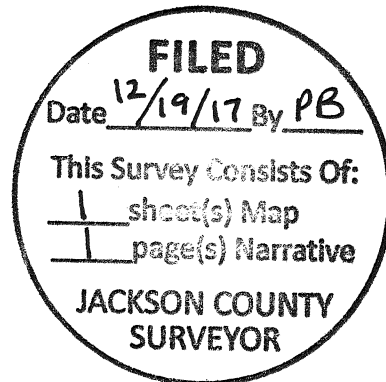

LOCATION:

Located in the Northwest Quarter of Section 9, Township 39 South, Range 1 East of the Willamette Meridian, Jackson County, Oregon.

PURPOSE:

To survey and monument that tract described in Instrument Number 2017-022086 of the official Records of Jackson County, Oregon.

BASIS OF BEARINGS:

Basis of bearing is the south line of Donation Land Claim per filed Survey Number 7902 at the Jackson County Surveyor's Office. Said bearing being N 89°51'58" West.

PROCEDURE:

Utilizing Trimble R10 units and using static and real time kinematic methods and Trimble S6 robotic total station and reflecting prisms, I tie the monuments as shown. The center line intersection monument of Vista, Fork and West Fork Street was destroyed by construction and I hold tied monuments as shown to establish the intersection. The center line of Fork Street is determined by holding the above mentioned centerline intersection and the found monuments per filed survey numbers 16917 and 20783 as shown. Monuments set per filed survey number 20783, adjoining this survey's tract were tied and accepted. The 3/4 inch iron pipe, not of record, found at the angle point along the north line of the subject tract appears to be of the same age and appearance of those recovered and held by filed survey number 20783 along South Pioneer Street and was within acceptable limits of the computed position and was held as an original monument being set without record. South Pioneer Street center line monuments were tied and the northerly most tangent was resolved by bearing distance intersection with Fork Street, holding the distance from the 1888 Map of the City of Ashland for South pioneer and the bearing as derived from found monuments along Vista as shown. This results in a longer tangent distance along Fork than shown by record measurement between lost center line monuments but is also the result of the best available evidence.

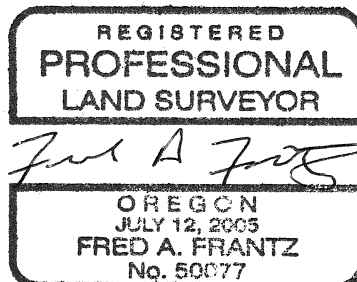

Renewal 12-31-17