

SURVEY IN BLOCK 22, EXTENSION
OF SISKIYOU HEIGHTS ADDITION
TO THE CITY OF MEDFORD, OREGON
FOR
I. B. C. HOMES

NE CORNER DLC 50
T. 37S., R.1W.

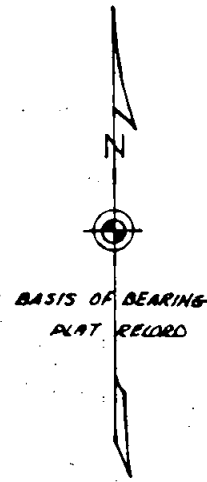

SURVEY BY CHARLES H. HURST
MEDFORD, OREGON
JULY, 1963

REGISTERED
OREGON
LAND SURVEYOR

Charles H. Hurst

OCTOBER 30, 1959
CHARLES H. HURST
433

767.25' (FROM SURVEY 486)

30'

CRESTBROOK

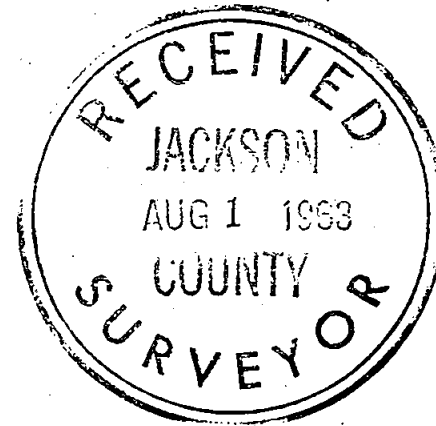
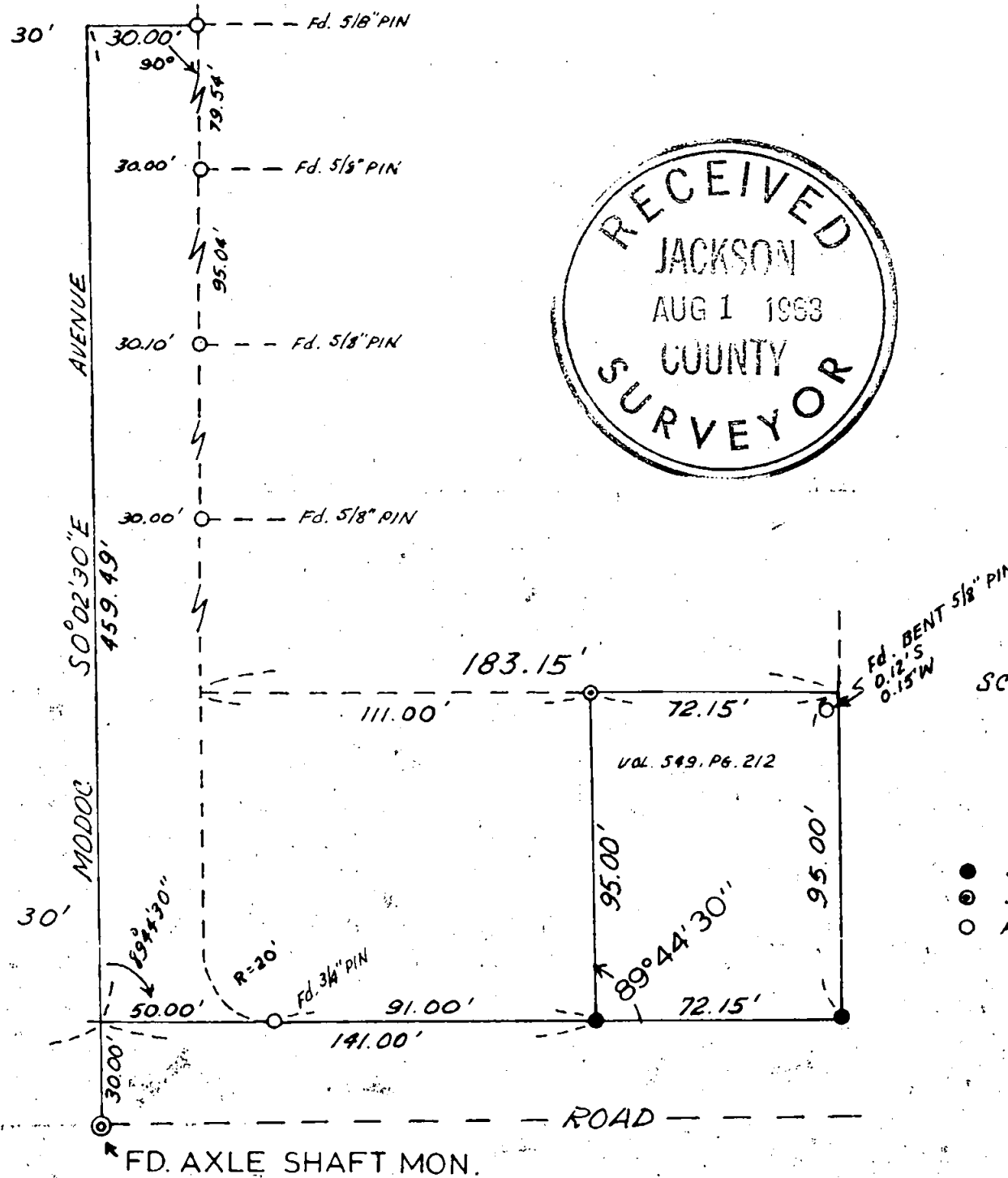

SCALE 1" = 50'

- LEGEND
- SET 5/8" IRON PIN
 - ⊙ SET CONC. NAIL & SHINER IN ROCK
 - FD. PINS - SURVEY 486

Survey No. 2243

Survey narrative to comply with ORS 209.120 and 209.250

Survey for:

Mr. Jack Lewis
c/o IBC Homes
27 North Fir
Medford, Oregon

Survey by :

Charles H. Hurst
765 Sunrise Avenue
Medford, Oregon

Basis of bearing:

Record

Equipment of survey:

Optical transit and 100' steel
tape compared to standard

Purpose of survey :

To locate the monuments known to be in
existence and define the boundaries and
monument the corners of that tract of
land described in Deed Record volume 549,
page 212 in relation to these monuments.

Procedure of survey:

Located the monuments previously set during
the course of survey 486 and proceeded per
attached plat.

July 29, 1963

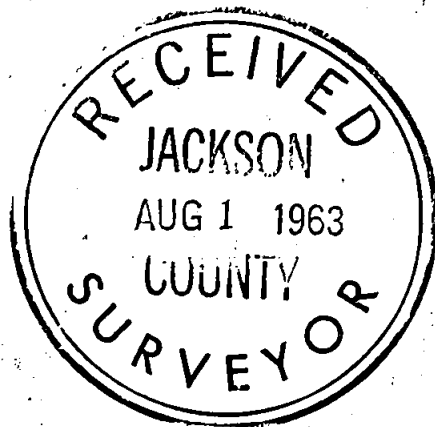

Charles H. Hurst

