

OREGON CORNER RESTORATION FORM

22321

SECTION 27

TOWNSHIP 32 S.

RANGE 2 E

COUNTY JACKSON

DATE 6/5/2017

TRACT M32-2E-26

CORNER DESIGNATION:

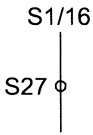

- CONDITION REPORT ONLY
- NOT FOUND
- RENEWED
- UNRECORDED
- SURVEYED IN
- REFERENCED OUT

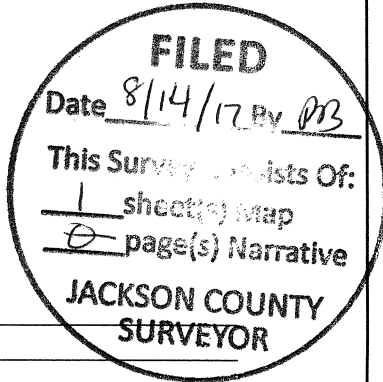

PREVIOUS RENEWALS/SURVEYS, ETC:

SET IN 1985 SURVEY 10253 FILED IN JACKSON COUNTY SURVEYORS OFFICE.

ACCESSORIES FOUND: (CONDITION AND SOURCE)

9" CEDAR BEARS S78 1/2°W 9.6 FT. AS PER RECORD FROM SURVEY 10253 HEALED FACE AND TAG

11" LOW FIR STUMP NO MARKS VISIBLE BEARS N50 1/4°W 26.2 FT. AS PER RECORD FROM SURVEY 10253

MONUMENT DETAIL:

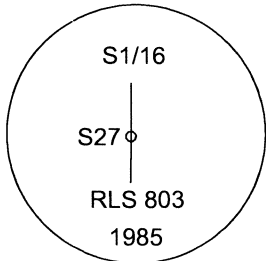

LEGEND:

- LINES BLAZED, AND PAINTED, FROM EXISTING BLAZES.
- FOUND 1985 KAISER CAP PER SURVEY 10253
- FOUND 1982 KAISER CAP PER SURVEY 9359

MONUMENT:

FOUND 1985 KAISER CAP SET IN SURVEY 10253 FILED JACKSON COUNTY SURVEYORS OFFICE.

NEW ACCESSORIES:

8" DOUGLAS FIR BEARS N35°W 26.8 FT. WE SCRIBE S1/16 S27 BT AND TAG TREE

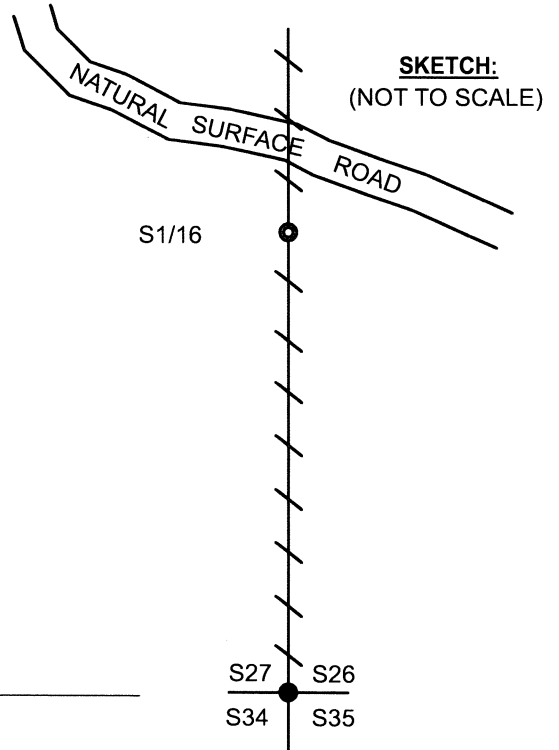

LOCATION & COMMENTS:

DURING THE COURSE OF REBLAZING THE SECTION LINE BETWEEN SECTIONS 26 AND 27 FROM EXISTING BLAZES WE FIND THAT THE SOUTH 1/16 CORNER FOR SECTION 27 ONLY HAD ONLY ONE LIVE BEARING TREE. THEREFORE WE SCRIBED A NEW BEARING TREE. FOUND 1 1/2" ALUMINUM CAP AT GROUND LEVEL AND APPROX. 120 FEET SOUTH OF MAIN ROAD. LOCATION TAG ON STUMP NORTH OF ROAD. PUT METAL U-POST APPROX. 0.8 FEET NORTH OF CORNER.

BEARING BASIS: MAGNETIC COMPASS

BEARING

FIRM/AGENCY: LONE ROCK TIMBER MANAGEMENT CO.

ADDRESS: P.O. BOX 1127
ROSEBURG, OR 97470

PARTY CHIEF: KEN W. HOFFINE

NOTES: GARY ANGIOLET

WITNESS: IGNACIO ROMAN

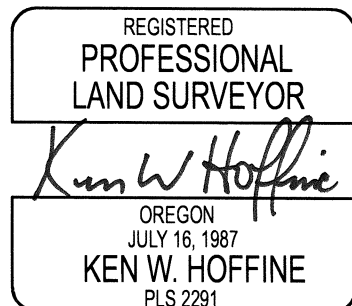

EXPIRES 6-30-19