

22112

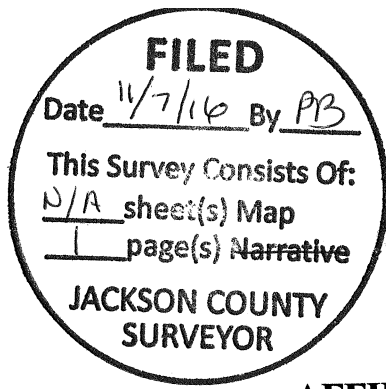

Jackson County Official Records **2016-036626**
 R-ACO
 Crit=1 SHINGLJS 11/07/2016 09:33:37 AM
 \$5.00 \$10.00 \$5.00 \$8.00 \$11.00 Total:\$83.00
 \$20.00 \$4.00 \$20.00



I, Christine Walker, County Clerk for Jackson County, Oregon, certify that the instrument identified herein was recorded in the Clerk records.
 Christine Walker - County Clerk

AFFIDAVIT OF CORRECTION
 Pursuant to O.R.S. 209.255

I, Richard F. Alspach, being duly sworn, depose and say that I am the surveyor who surveyed the property depicted on and filed as Survey No. 20510 in the Office of the Jackson County Surveyor and that the following correction should be made:

The distance of the course located on the centerline of East Main Street labeled N55°15' 45"W 671.88 should read 715.22. This was due to a drafting error.

Date: 10/25/16

Surveyor: *Richard F. Alspach*
 Richard F. Alspach, PLS

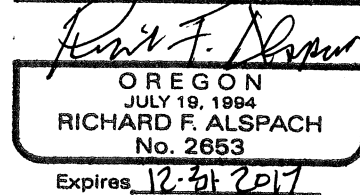
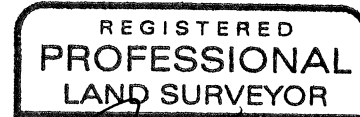

State of Oregon)
) SS
 County of Jackson)

Signed before me this, the 25th Day of Oct, 2016

Julie Schamaneck
 Notary Public for the State of Oregon

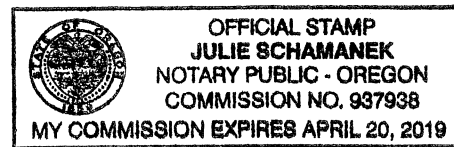

I, Scott Fein, Jackson County Surveyor, do hereby certify that I have examined this Affidavit of Correction and that the changes are permitted in accordance with Chapter 209, Paragraph 255, Oregon Revised Statutes.

Date: 10/31/16

Scott Fein
 Scott Fein, Jackson County Surveyor