

Survey For
SELDON D. HILL
Located in Lot 5,
The Cooksey Addition
To Central Point, Oregon
By: Mark E. Boyden
April, 1963

REGISTERED
OREGON
LAND SURVEYOR
Mark E. Boyden
NOVEMBER 9, 1951
MARK E. BOYDEN
281

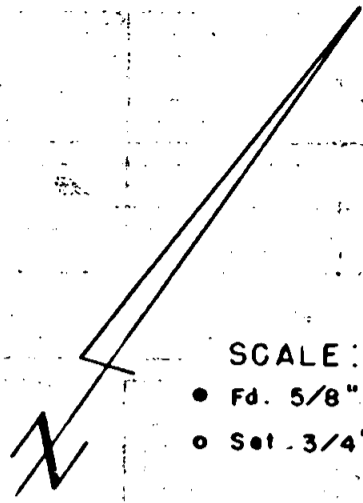

SCALE: 1" = 50'
● Fd. 5/8" Re-Bar
○ Set 3/4" Capped Pipe

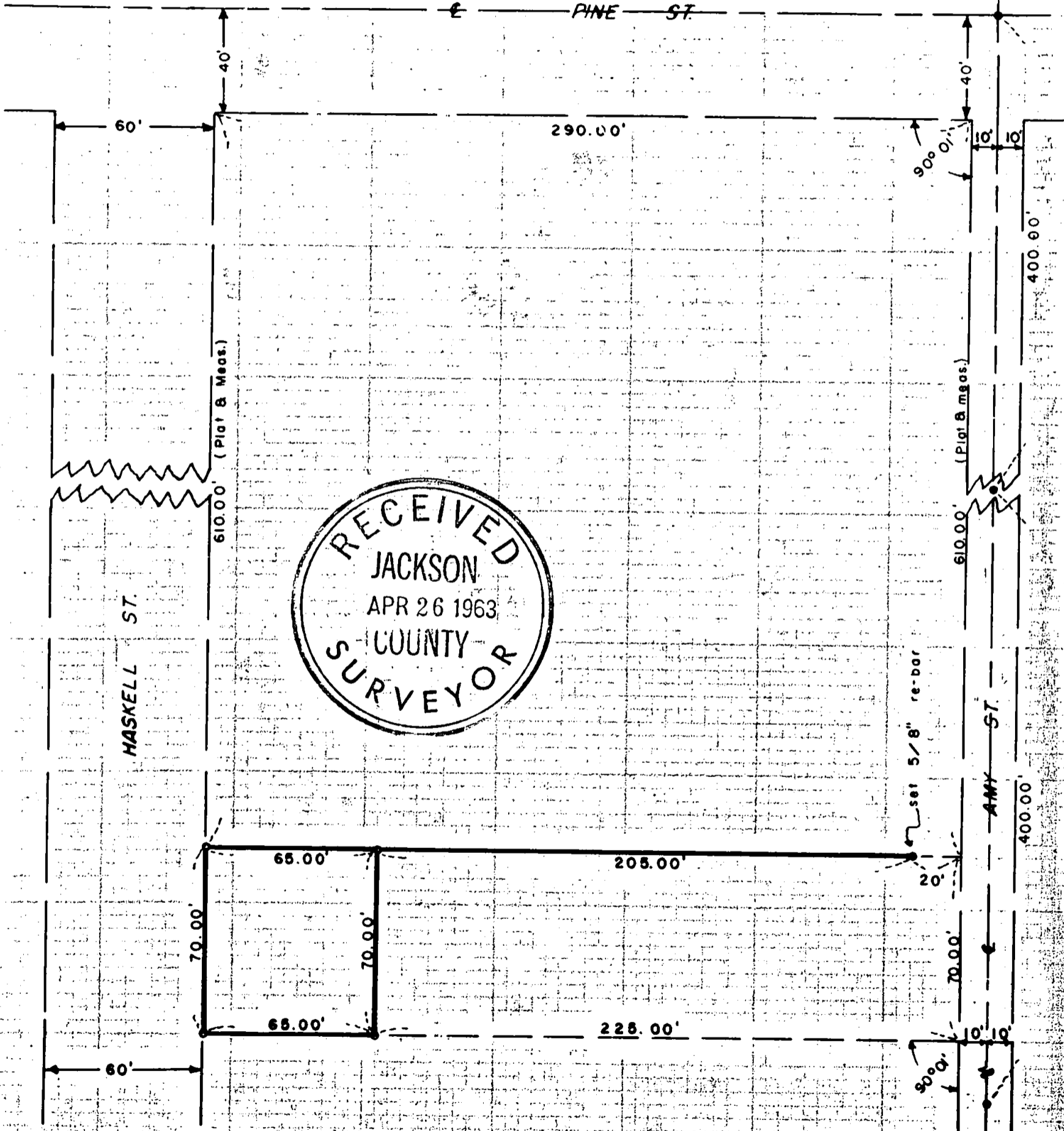

SURVEY NARRATIVE TO COMPLY WITH O.R.S. 209.250

FOR: Seldon D. Hill
160 South Amy Street
Central Point, Oregon

LOCATION: Lot 5 of THE COOKSEY ADDITION to Central Point,
Oregon.

PURPOSE: To monument that tract described in Volume 544,
Page 154 of the Deed Records of Jackson
County, Oregon.

PROCEDURE:

Found pins previously set for control of the
centerline of Amy Street on Recorded Survey No. 2056.

Monumented the tract plat record distance
Southerly from Pine Street and plat record distance
Westerly from Amy Street.

The distances on the centerline of Amy and
Haskell Streets Southerly from Pine Street to the
North boundary of DLC #54 develop more distance than
the distances shown on the plat. However, the
fractional lots along the South boundary of
THE COOKSEY ADDITION do not mathematically close.

It is also evident from existing improvements,
that the plat was originally monumented Southerly from
Pine Street, with the fractional lot distances intended
to be more or less to the true DLC boundary.

April 1963

