

# MAP OF SURVEY FOR HORIZONTAL CONTROL AND MONUMENT RECOVERY Valley View Road AND Talent Avenue

SITUATED IN  
SECTION 23, T 38 S, R 1 W, W.M.  
CITY OF TALENT  
JACKSON COUNTY, OREGON

## LEGEND

- Found monument as noted
- △ Control point set as noted
- S/N Filled Survey Number
- CS County Surveyor
- ( ) Record data
- RPC Red plastic cap
- YPC Yellow plastic cap

## SURVEY MONUMENTS

- |  |  |  |   |
|--|--|--|---|
| 338<br>FD COPPER DISC<br>"ODOT CONTROL"<br>FLUSH IN CONCRETE<br>N 219215.647<br>E 4302352.917<br>S/N 19696       | 347<br>FD REBAR W/RPC<br>"DA EDWARDS"<br>1" DEEP<br>N 219444.098<br>E 4302258.067<br>S/N 14133         | 360<br>FD 3/4" (1/2") PIPE<br>BENT S'LY<br>4" DEEP<br>N 219009.678<br>E 4302312.613<br>S/N 257 & 14544 | 364<br>FD 5/8" REBAR<br>2" DEEP<br>N 219050.198<br>E 4302571.304<br>S/N 10683   |
| 339<br>FD ALUMINUM CAP<br>"ODOT RIGHT-OF-WAY"<br>4" DEEP IN GRAVEL<br>N 219207.367<br>E 4302189.863<br>S/N 19696 | 348<br>FD 3/4" PIPE<br>8" DEEP<br>N 219382.274<br>E 4302189.863<br>S/N 3494                            | 361<br>FD 1" (3/4") PIN<br>14" DEEP<br>N 218969.224<br>E 4302331.501<br>S/N 257 & 14544                | 3004<br>FD 3/4" PIPE<br>TOP 8" BENT SW'LY<br>10" DEEP AT ANGLE POINT<br>N 219410.673<br>E 4302144.616<br>S/N 3494 & 14133 |
| 340<br>FD 1/2" PIPE<br>5" DEEP<br>N 219648.144<br>E 4301892.236<br>S/N 3494 & 14133                              | 349<br>FD 3/4" PIPE<br>LEANING W'LY<br>1" DEEP<br>N 219479.237<br>E 4302377.239<br>S/N 3494 & 14133    | 362<br>FD 5/8" PIN<br>BENT S'LY<br>2" DEEP<br>N 218955.055<br>E 4302337.513<br>S/N 257 & 14544         | 3005<br>FD 3/4" PIPE<br>TOP 10" BENT E'LY<br>5" DEEP AT ANGLE POINT<br>N 219407.227<br>E 4302274.537<br>S/N 3494 & 14133  |
| 341<br>FD 1/2" PIN<br>BENT NE'LY<br>5" DEEP<br>N 219562.758<br>E 4301930.732<br>S/N 3494 & 14133                 | 353<br>FD 1/2" PIN<br>BENT NE'LY<br>1" DEEP<br>N 219474.817<br>E 4302379.622<br>ORIGIN UNKNOWN         | 363<br>FD 3/4" (1/2") PIPE<br>4" DEEP<br>N 218927.843<br>E 4302349.918<br>S/N 257 & 14544              |   |
| 342<br>FD 5/8" REBAR<br>6" DEEP<br>N 219335.718<br>E 4302031.585<br>S/N 3494 & 14133                             | 355<br>FD 3/4" PIPE<br>8" DEEP<br>N 219373.801<br>E 4302161.077<br>S/N 3494 & 14133                    |  |   |
| 343<br>FD 1/2" PIN<br>1" DEEP<br>N 219668.347<br>E 4302158.101<br>S/N 3494 & 14133                               | 356<br>FD 1" PIPE (5/8" PIN)<br>9" DEEP<br>N 218894.709<br>E 4302229.559<br>S/N 14544                  |  |   |
| 344<br>FD REBAR W/RPC<br>"DA EDWARDS"<br>FLUSH<br>N 219545.158<br>E 4302212.979<br>S/N 14133                     | 357<br>FD REBAR W/RPC<br>"DA EDWARDS LS 2339"<br>5" DEEP<br>N 218922.337<br>E 4302219.003<br>S/N 14544 |  |   |
| 345<br>FD REBAR W/RPC<br>"DA EDWARDS"<br>2" DEEP<br>N 219548.705<br>E 4302079.021<br>S/N 14133                   | 358<br>FD REBAR W/YPC<br>"LJ FRIAR & ASSOC."<br>3" DEEP<br>N 218976.635<br>E 4302192.260<br>S/N 15307  |  |   |
| 346<br>FD REBAR W/RPC<br>"DA EDWARDS"<br>1" DEEP<br>N 219558.896<br>E 4302074.504<br>S/N 14133                   | 359<br>FD TAG & TACK<br>"LS 2234"<br>FLUSH<br>N 219032.677<br>E 4302172.297<br>S/N 15307               |  |   |

## NARRATIVE

**SURVEY FOR:** ZCS ENGINEERING  
ATTN: JUSTIN GERLITZ, PE  
550 SW 6TH ST. SUITE C  
GRANTS PASS, OR 97526

URBAN RENEWAL AGENCY  
CITY OF TALENT, OREGON  
ATTN: MARLA CATES  
PO BOX 445  
TALENT, OR 97540

**PURPOSE:** TO LOCATE EXISTING MONUMENTATION WHICH MAY BE DISTURBED OR DESTROYED DURING THE IMPROVEMENT OF VALLEY VIEW ROAD AND TALENT AVE. IN TALENT, OREGON.

**PROCEDURE:** A CLOSED CONTROL TRAVERSE WAS RUN TYING ALL FOUND PROPERTY CORNER MONUMENTS AND STREET MONUMENTS OF RECORD INTO OUR CONTROL NET. OUR PRIMARY CONTROL POINTS FOR THIS AREA ARE SHOWN ON THIS MAP.

**COORDINATE SYSTEM:** LOCAL DATUM PLANE BASED UPON OREGON SPCS (SOUTH ZONE)  
REFERENCE FRAME: NAD83 (CORS 96) (EPOCH 2002)  
UNITS: INTERNATIONAL FEET

**BASIS OF BEARINGS:** S/N 17937 AND S/N 19696

**DATE:** JUNE 2010

**\*\* RECEIVED \*\***  
DATE 6-14-10 BY SB  
This survey consists of:  
1 sheet(s) Map  
2 page(s) Narrative  
JACKSON COUNTY  
SURVEYOR

## CONTROL

- 7 SET MAG NAIL  
N 219265.862  
E 4302612.390
- 16 SET MAG NAIL  
N 218818.290  
E 4302200.629
- 18 SCRIBED "X" IN CONCRETE  
N 219393.770  
E 4302749.214
- 22 SET MAG NAIL  
N 219791.453  
E 4302274.765
- 23 SCRIBED "X" IN CONCRETE  
N 219272.563  
E 4301981.565
- 25 SCRIBED "X" IN CONCRETE  
N 219658.759  
E 4302572.405

## SURVEY MONUMENTS

- 26 SET MAG NAIL  
N 219238.863  
E 4303087.985
- 28 SET MAG NAIL  
N 219224.242  
E 4302222.860
- 31 SCRIBED "X" IN CONCRETE  
N 219799.922  
E 4302112.704
- 33 SCRIBED "X" IN CONCRETE  
N 219512.497  
E 4301945.800
- 34 SET MAG NAIL  
N 219778.961  
E 4301766.830
- 302 FD ALUMINUM CAP  
PUNCHED - NO MARKINGS  
FLUSH  
N 218921.302  
E 4302182.445  
S/N 15307

- 13 FD TACK & TACK  
"LS 2234"  
N 219203.954  
E 4302096.604  
S/N 15307
- 300 FD TAG & TACK  
"LS 2234"  
N 219207.836  
E 4302088.284  
S/N 15307
- 301 FD ALUMINUM CAP  
PUNCHED - NO MARKINGS  
FLUSH IN ASPHALT  
N 218931.626  
E 4302177.831  
S/N 15307
- 302 FD ALUMINUM CAP  
PUNCHED - NO MARKINGS  
FLUSH  
N 218921.302  
E 4302182.445  
S/N 15307
- 306 FD ALUMINUM CAP  
PUNCHED - NO MARKINGS  
FLUSH IN ASPHALT  
N 219324.155  
E 4302003.036  
S/N 15307
- 307 FD ALUMINUM CAP  
"LJ FRIAR & ASSOC."  
FLUSH IN ASPHALT  
N 219420.791  
E 4301960.050  
S/N 15307
- 308 FD ALUMINUM CAP  
"CITY OF TALENT LS 2339"  
FLUSH IN ASPHALT  
N 219800.837  
E 4301790.906  
S/N 13555
- 320 FD ALUMINUM CAP  
"LJ FRIAR & ASSOC."  
FLUSH IN ASPHALT  
N 218752.285  
E 4302257.661  
S/N 15307

- 322 FD BRASS DISC  
"SE DLC 60..."  
FLUSH IN CONCRETE  
N 219381.889  
E 4302781.242  
CS 2006 RE-ESTAB NOTES
- 326 FD ALUMINUM CAP  
"ODOT RE-SET"  
N 219802.364  
E 4302322.258  
S/N 19696
- 332 FD ALUMINUM CAP  
"ODOT RIGHT-OF-WAY"  
FLUSH IN ASPHALT  
N 219317.843  
E 4302843.897  
S/N 19696
- 333 FD COPPER DISC  
"ODOT CONTROL"  
FLUSH IN SIDEWALK  
N 219325.145  
E 4302794.628  
S/N 19696

- 334 FD ALUMINUM CAP  
"ODOT RIGHT-OF-WAY"  
FLUSH  
N 219243.449  
E 4302515.730  
S/N 19696
- 335 FD ALUMINUM CAP  
"ODOT RIGHT-OF-WAY"  
FLUSH IN ASPHALT  
N 219405.579  
E 4302735.048  
S/N 19696
- 336 FD ALUMINUM CAP  
"ODOT RIGHT-OF-WAY"  
FLUSH IN ASPHALT  
N 219378.522  
E 4302731.464  
S/N 19696
- 337 FD ALUMINUM CAP  
ILLEGIBLE  
N 219160.394  
E 4302075.994  
S/N 15307

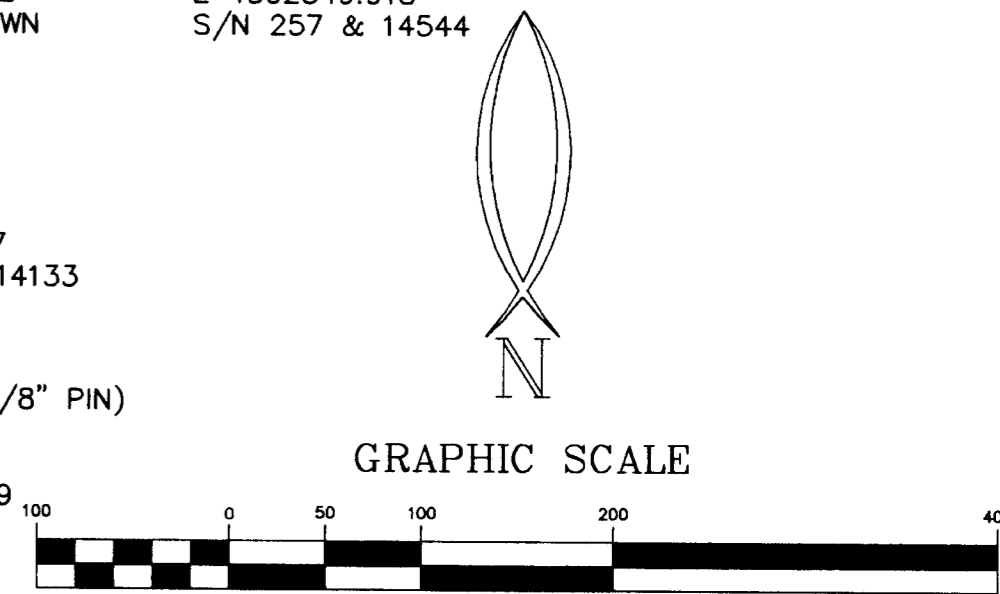

REGISTERED  
PROFESSIONAL  
LAND SURVEYOR  
*Richard L. Bath*  
OREGON  
JULY 30, 1976  
RICHARD L. BATH  
No. 1069  
RENEWS 12/31/11

**Hardey Engineering & Associates, Inc.**  
**HEA**  
ENGINEERING INTEGRITY  
P.O. BOX 1625  
MEDFORD, OREGON 97501-0063  
VOICE: 541-772-6880  
FAX: 541-772-9573  
EMAIL: info@hea-inc.com