

STOWE INDUSTRIAL PARK (A PAD LOT SUBDIVISION)

LOCATED IN:
LOT 7, BLOCK 3 IN NORTHWEST MEDFORD
LIGHT INDUSTRIAL PARK, UNIT NO. 1, IN THE SE
1/4 OF SECTION 23, T37S, R2W, WM, IN THE CITY
OF MEDFORD, JACKSON COUNTY, OREGON

*** DECLARATION ***

KNOW ALL MEN BY THESE PRESENTS THAT, KEVIN MILES AND CAROLE-CARSON MILES, TOM CHAVEZ, JEREMY RICHMOND AND KAILA RICHMOND, ARE THE OWNERS IN FEE SIMPLE OF THE LAND HEREON DESCRIBED, AND HAVE SUBDIVIDED THE SAME INTO LOTS AND COMMON PROPERTY AS SHOWN HEREON, AND THE NUMBER OF EACH LOT AND THE COURSE AND LENGTH OF ALL LINES ARE PLAINLY SET FORTH, AND THAT THIS PLAT IS A CORRECT REPRESENTATION OF THE SUBDIVISION, AND DO HEREBY GRANT TO THE CITY OF MEDFORD AND ITS ASSIGNEES AN EASEMENT FOR STORM-DRAINAGE AND ACCESS AND MAINTENANCE, OF DRAINAGE FACILITIES, ACROSS TRACT "A" AS SHOWN HEREON, AND DO ALSO HEREBY CREATE AN EASEMENT FOR ACCESS AND UTILITIES ACROSS TRACT "A", FOR THE BENEFIT OF THE OWNERS, HEIRS AND ASSIGNEES OF LOTS 1-4, AND DO HEREBY DESIGNATE SAID SUBDIVISION AS STOWE INDUSTRIAL PARK.

IN WITNESS WHEREOF, I HAVE SET MY HAND AND SEAL THIS 18 DAY OF Feb., 2010.

Kevin Miles
KEVIN MILES

Carole Carson Miles
CAROLE-CARSON MILES

THE FOREGOING INSTRUMENT WAS ACKNOWLEDGED BEFORE ME THIS 18 DAY OF Feb., 2010. BY KEVIN MILES AND CAROLE-CARSON MILES, KNOWN TO ME AS THE PERSONS WHO EXECUTED THE WITHIN INSTRUMENT, FREELY AND VOLUNTARILY.

BEFORE ME: Jamie L Weber
NOTARY Mar 24, 2010

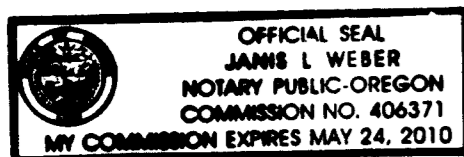

Tom Chavez
TOM CHAVEZ

THE FOREGOING INSTRUMENT WAS ACKNOWLEDGED BEFORE ME THIS 24th DAY OF FEB., 2010. BY TOM CHAVEZ, KNOWN TO ME AS THE PERSON WHO EXECUTED THE WITHIN INSTRUMENT, FREELY AND VOLUNTARILY.

BEFORE ME: Sandra D Gordon
NOTARY



Kaila Richmond
KAILA RICHMOND

Jeremy Richmond
JEREMY RICHMOND

THE FOREGOING INSTRUMENT WAS ACKNOWLEDGED BEFORE ME THIS 24th DAY OF Feb, 2010. BY JEREMY RICHMOND AND KAILA RICHMOND, KNOWN TO ME AS THE PERSONS WHO EXECUTED THE WITHIN INSTRUMENT, FREELY AND VOLUNTARILY.

BEFORE ME: Sandra D Gordon
NOTARY



APPROVED FOR RECORDING:

Ammy Jordan
COUNTY COMMISSIONER/ADMINISTRATOR

3-30-10
DATE

RECORDER:

FILED FOR RECORD THIS 30th DAY OF March, 2010 AT 1:030 CLOCK P.M. AND RECORDED IN VOLUME 36 OF PLATS AT PAGE 3 OF RECORDS OF JACKSON COUNTY, OREGON.

Christine D. Walker
COUNTY CLERK

Carmen D. Helman
DEPUTY

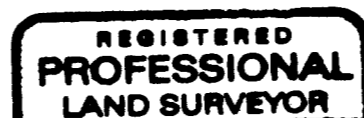
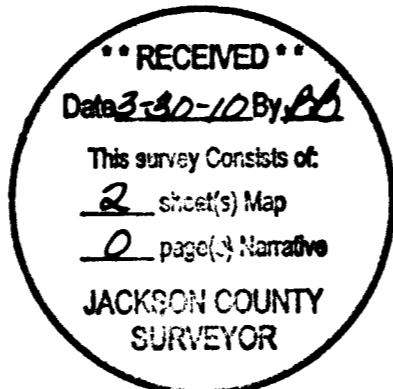

Douglas C. McMahon
DOUGLAS C. MCMAHAN
No. 1912
RENEWS 12/31/10

*** SURVEYOR'S CERTIFICATE ***

STATE OF OREGON)
County of Jackson) ss.

I, DOUGLAS C. MCMAHAN, A DULY REGISTERED PROFESSIONAL LAND SURVEYOR OF THE STATE OF OREGON DO HEREBY CERTIFY THAT I HAVE CORRECTLY SURVEYED AND MARKED WITH THE PROPER MONUMENTS AS PROVIDED BY LAW THE TRACT OF LAND HEREON SHOWN AND THAT THE PLAT IS A CORRECT REPRESENTATION OF THE SAME, AND THE FOLLOWING IS AN ACCURATE DESCRIPTION OF THE BOUNDARY LINES.

BEGINNING AT A POINT FOR THE NORTHEAST CORNER OF LOT 7, BLOCK 3 OF NORTHWEST MEDFORD LIGHT INDUSTRIAL PARK, UNIT NO. 1, ACCORDING TO THE OFFICIAL PLAT THEREOF, NOW OF RECORD IN JACKSON COUNTY, OREGON, SAID POINT BEING THE INITIAL POINT OF BEGINNING; THENCE SOUTH 00°02'40" WEST, ALONG THE EASTERLY BOUNDARY OF SAID LOT 7, A DISTANCE OF 271.51 FEET TO A POINT ON THE BOUNDARY LINE CREATED BY BOUNDARY LINE AGREEMENT PER INSTRUMENT NO. 83-09117 OF THE DEED RECORDS OF SAID JACKSON COUNTY; THENCE NORTH 89°45'00" WEST, ALONG SAID BOUNDARY LINE, A DISTANCE OF 354.99 FEET TO A POINT ON THE WESTERLY BOUNDARY OF SAID LOT 7; THENCE NORTH 00°02'40" EAST, ALONG SAID WESTERLY BOUNDARY, A DISTANCE OF 273.37 FEET TO THE NORTHWEST CORNER THEREOF; THENCE SOUTH 89°27'00" EAST, ALONG THE NORTHERLY BOUNDARY OF SAID LOT 7, A DISTANCE OF 355.00 FEET TO THE INITIAL POINT OF BEGINNING.

Douglas C. McMahon
SURVEYOR

*** APPROVALS ***

MEDFORD CITY PLANNING: (FILE NO. LDS-07-252)

I CERTIFY THAT, PURSUANT TO AUTHORITY GRANTED IN ORDINANCE NO. 5785 THIS PLAT IS HEREBY APPROVED.

James E. Heber
PLANNING DIRECTOR

March 25, 2010
DATE

EXAMINED AND APPROVED THIS 15th DAY OF March, 2010.

Laurie Becken
CITY ENGINEER

[Signature]
CITY SURVEYOR

EXAMINED AND APPROVED AS REQUIRED BY O.R.S. 92.100 AS OF March 30, 2010.

Amanda Alamo, deputy
ASSESSOR, DEPARTMENT OF ASSESSMENT

ALL TAXES, FEES, ASSESSMENTS OR OTHER CHARGES AS REQUIRED BY O.R.S. 92.095 HAVE BEEN PAID, AS OF March 30, 2010.

Cave Aruention, Deputy
TAX COLLECTOR

SURVEY NARRATIVE TO COMPLY WITH PARAGRAPH 209.250 OF THE OREGON REVISED STATUTES.

PURPOSE: TO SURVEY, MONUMENT, AND PREPARE FINAL PLAT FOR STOWE INDUSTRIAL PARK, PER CITY OF MEDFORD FILE NO. LDS-07-252 AND PER THE CLIENT'S REQUEST.

PROCEDURE: UTILIZING FOUND MONUMENTS AND INFORMATION PER S/N 16631 AND S/N 19546 AND PLATS OF NWMLIP UNITS NO. 1 AND NO. 2 FOR CONTROL, I ESTABLISH MONUMENTS AS SHOWN HEREON. INSTRUMENTS NO. 83-09117 AND NO. 2006-011249 OF THE J.C.D.R. WERE USED TO DETERMINE THE PROPERTY BOUNDARIES. AN ELECTRONIC TRIMBLE S6 TOTAL STATION WAS USED TO MAKE ALL MEASUREMENTS.

I certify this plat to be an exact photocopy of the original.
Douglas C. McMahon
SURVEYOR

(06183s1.dwg)
SHEET 1 OF 2

STOWE INDUSTRIAL PARK (A PAD LOT SUBDIVISION)

LOCATED IN:
 LOT 7, BLOCK 3 IN NORTHWEST MEDFORD
 LIGHT INDUSTRIAL PARK, UNIT NO. 1, IN THE SE
 1/4 OF SECTION 23, T37S, R2W, WM, IN THE CITY
 OF MEDFORD, JACKSON COUNTY, OREGON

FOR:
KEVIN MILES
 3737 SCENIC AVENUE
 CENTRAL POINT, OREGON 97502

HOFFBUHR & ASSOCIATES, INC.
 880 GOLF VIEW DRIVE, #201
 MEDFORD, OREGON 97504
 (541) 779-4641

BY: DOUGLAS C. McMAHAN PLS No. 1913
 SCALE: 1" = 40' DATE: DECEMBER 18, 2009
 BASIS OF BEARING: C/L OF PARSONS DRIVE PER
 PLAT OF NWMLIP, UNIT NO. 2

AREA TABLE	
LOT NO.	SQUARE FEET
1	7,360
2	7,411
3	9,720
4	9,720
TRACT "A"	65,501

- ⊗ = SET 5/8"x30" REBAR WITH PLASTIC YELLOW CAP STAMPED "HOFFBUHR AND ASSOC., INC."
- = SET 5/8"x24" REBAR WITH PLASTIC YELLOW CAP STAMPED "HOFFBUHR AND ASSOC., INC."
- ⊘ = FOUND 5/8" IRON PIN WITH PLASTIC CAP STAMPED "HOFFBUHR & ASSOC., INC." PER S/N 19546.
- = FOUND 5/8" IRON PIN WITH PLASTIC CAP STAMPED "L.J.FRIAR & ASSOC." PER S/N 16631.
- ⊙ = FOUND BRASS DISC IN MONUMENT CASE IN POSITION AS SHOWN PER PLATS OF NWMLIP UNIT NO. 1 AND UNIT NO. 2.
- = FOUND 5/8" IRON PIN PER PLAT OF NWMLIP (NO CAP).
- S/N = FILED SURVEY NUMBER
- J.C.D.R. = JACKSON COUNTY DEED RECORDS OR OFFICIAL RECORDS.
- NWMLIP = NORTHWEST MEDFORD LIGHT INDUSTRIAL PARK
- PUE = PUBLIC UTILITY EASEMENT PER PLAT OF NWMLIP UNIT NO. 1.
- WIT. = WITNESS MONUMENT

LINE TABLE		
LINE	BEARING	DISTANCE
L1	N49°44'35"W	26.44'
L2	N38°25'32"E	25.46'
L3	S76°54'52"E	16.42'
L4	S87°41'11"W	20.02'
L5	N00°35'42"E	19.26'
L6	N89°54'33"E	1.00'
L7	S00°02'40"W	20.00'
L8	S89°57'20"E	15.00'
L9	N00°02'40"E	10.00'
L10	N00°02'40"E	15.00'

I certify this plat to be an exact photocopy of the original.
Douglas C. Mc Mahan
 SURVEYOR

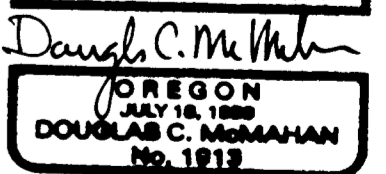
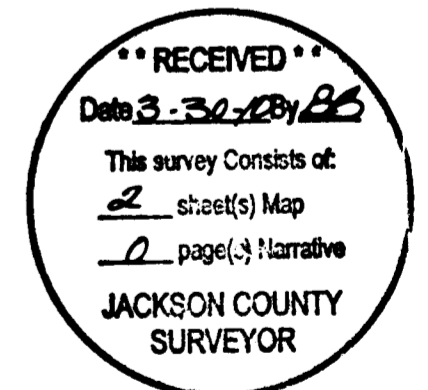

RENEWS 12/31/10

- NOTES:
- EASEMENT FOR TRANSMISSION AND DISTRIBUTION OF ELECTRICITY GRANTED THE CALIFORNIA OREGON POWER COMPANY, AS SET FORTH IN VOLUME 226, PAGE 411, VOLUME 233, PAGE 183 AND VOLUME 366, PAGE 186, J.C.D.R. SPECIFIC LOCATION NOT GIVEN.
 - EASEMENT FOR TRANSMISSION AND DISTRIBUTION OF ELECTRICITY, GRANTED THE PACIFIC POWER AND LIGHT COMPANY, AS SET FORTH IN DOCUMENT NO. 74-13246, OFFICIAL RECORDS OF JACKSON COUNTY. SPECIFIC LOCATION NOT GIVEN.

