

OREGON CORNER RESTORATION FORM

20571

Section 9 Township 35 Range 2 E
County Jackson Date 12/7/09

Corner Designation

T. 35 S. R. 2 E.

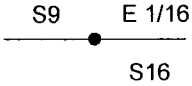

- Condition Report Only
- Not Found
- Renewed
- Unrecorded
- Surveyed In
- Referenced Out

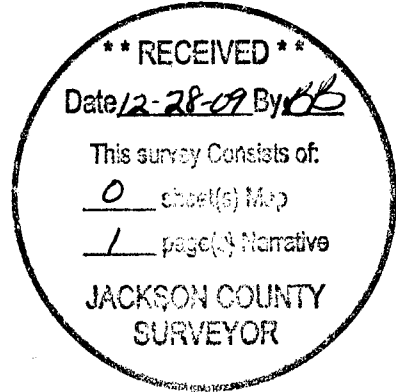

Previous Renewals/Surveys, etc. County Surveyors Office.

Surveys 4544, 8407, and 13134 filed in Jackson

Monument(s) & Accessories Found: (Condition and Source)

Found 5/8" Iron Rod with 1 1/2" aluminum cap.

14" Ash Bears N75°E 96.5 Ft. (Record N 75° E 96.3 Ft.) Visible Scribing & Tag.

16" Douglas Fir Stump Bears S70°W 112.6 Ft. (Record S73°E 113.0 Ft.) Healed Face No Tag.

Monument Detail

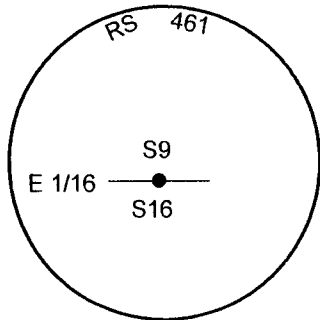

Sketch

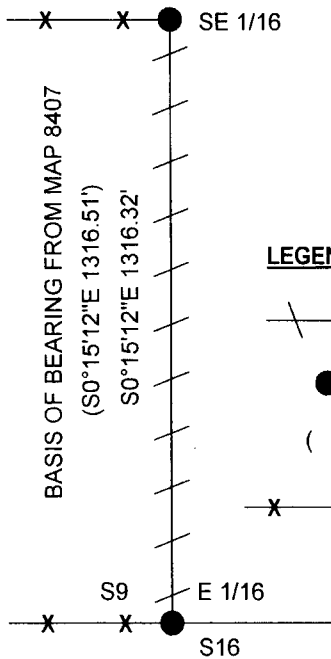

LEGEND:

- LINE BLAZED AND PAINTED & SET INTERVISIBILE FENCE POSTS
- FOUND 1 1/2" ALUMINUM CAP
- RECORD FROM MAP 8407
- EXISTING FENCE LINES

Monument Found

Found 1971 Smeltzer Aluminum Cap

New Accessories

8" Pine Bears S4°W 96.5 Ft. We Scribe E 1/16 S 16 B T & Tag.

Location & Comments

Corner is at ground level and approx. 1.5 feet west of small stream and approx. 1.5 feet south of fence corner, fence runs west and north.

Bearing Basis From Map 8407
Firm/Agency Lone Rock Timber Co.
Address P. O. Box 1127 Roseburg, Ore. 97470
Party Chief Ken W. Hoffine
Notes G. Angiolet
Witness I. Roman

