

OREGON PUBLIC LAND CORNER REPORT / RESTORATION REPORT
JACKSON County Surveyor's Office

20532

SECTION: NW1/4, NE1/4 SEC 29	TOWNSHIP: 37S	RANGE: R1W
--	-------------------------	----------------------

COUNTY: JACKSON	DATE: 11-4-09
---------------------------	-------------------------

CORNER DESIGNATION: POINT OF INTERSECTION OF THE NORTHERLY RIGHT-OF-WAY OF EAST MAIN STREET & THE EASTERLY RIGHT-OF-WAY OF GROVELAND AVENUE: PER THE AMENDED PLAT OF EUCLID PARK ADDITION, RECORDED IN THE JACKSON COUNTY RECORDING OFFICE AS VOL. 6 PAGE 10	(Please check one) <input type="checkbox"/> Condition Report Only <input type="checkbox"/> Not Found <input type="checkbox"/> Renewed <input type="checkbox"/> Unrecorded <input type="checkbox"/> Surveyed In <input checked="" type="checkbox"/> Referenced Out
--	---

Previous Renewals / Surveys, etc.:
AMENDED PLAT OF EUCLID PARK ADDITION, RECORDED IN THE JACKSON COUNTY RECORDING OFFICE AS VOL. 6 PAGE 10

Monument(s) & Accessories Found: (Condition & Source):
SEE ATTACHED EXHIBIT MAP

Monument Detail:
1-1/2" PIPE WITH NO TAG 2" DEEP. MONUMENT IS TO BE DESTROYED DURING CONSTRUCTION OF CITY SIDEWALK PROJECT.

Sketch:
SEE ATTACHED EXHIBIT MAP

**** RECEIVED ****

Date 11-10-09 By BB

This survey Consists of:

0 sheet(s) Map

2 page(s) Narrative

JACKSON COUNTY SURVEYOR

Monument Set (Procedures and Description):
NOTHING SET, MADE SURVEY TIES TO EXISTING MONUMENTS TO PERPETUATE MONUMENT LOCATION.

New Accessories:
MONUMENTS SHOWN ON ATTACHED EXHIBIT MAP

Location & Comments:
SEE ATTACHED EXHIBIT MAP

Compass Declination:
N/A

Firm / Agency: **City of Medford**

Address: **411 West 8th Street, Medford, OR 97501**

Party Chief:
Sean Metzger

Notes:

Witness:

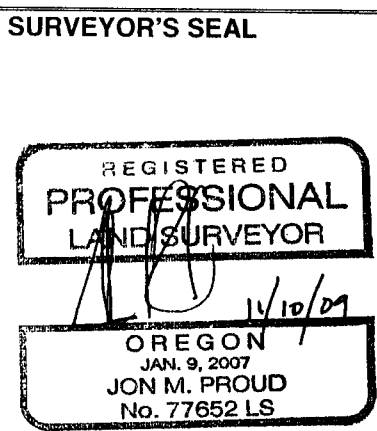

RENEWAL: DEC. 31, 2010

LEGEND

- FOUND MONUMENT AS NOTED
 - MONUMENT TO BE DESTROYED DURING CITY SIDEWALK PROJECT
- E.P.A. AMENDED PLAT OF EUCLID PARK ADDITION

INTERIOR ANGLES

- ① 14° 33' 20"
- ② 11° 00' 05"
- ③ 140° 04' 49"
- ④ 14° 26' 05"
- ⑤ 179° 55' 41"

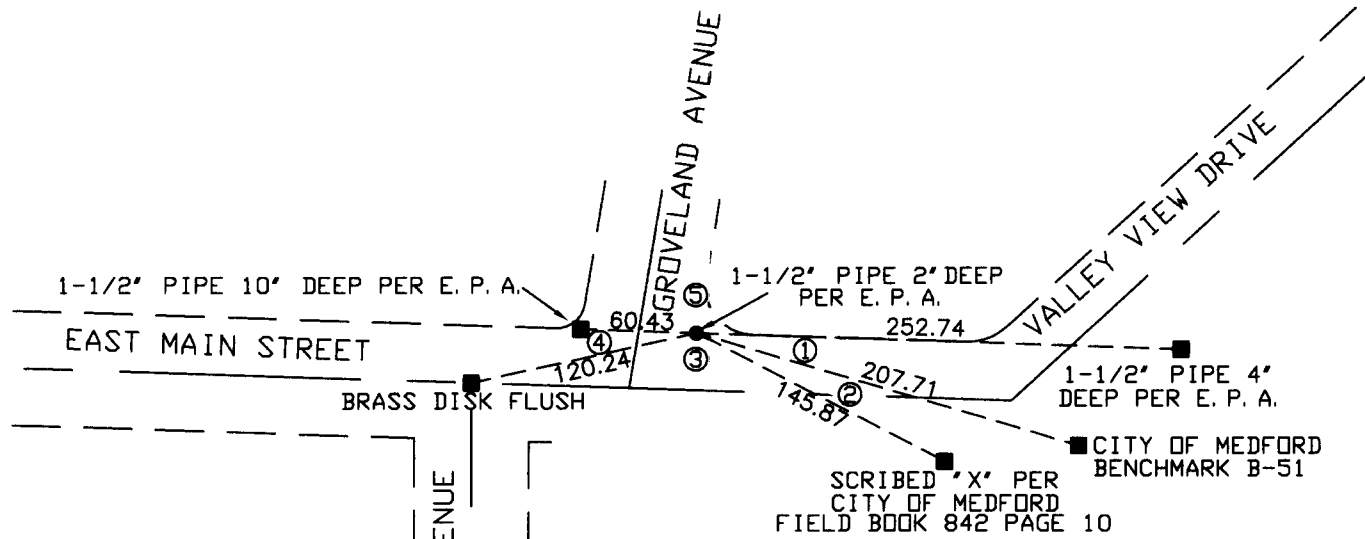

0' 100'
SCALE: 1"=100'

**** RECEIVED ****
Date 11-10-09 By BB
This survey Consists of:
0 sheet(s) Map
2 page(s) Narrative
JACKSON COUNTY
SURVEYOR

REGISTERED
PROFESSIONAL
LAND SURVEYOR

11/10/09
OREGON
JAN. 9, 2007
JON M. PROUD
No. 77652 LS

RENEWAL: DEC. 31, 2010

CITY OF MEDFORD - ENGINEERING DEPARTMENT		
Exhibit Map		
371W29AB TAXLOT 7400		
For Land Corner Report		
DRAWN BY	SPM	DATE 11-10-09
CHECKED BY:	JP	DATE 11-10-09
APPROVED		DATE
APPROVED CITY TRANSPORTATION MANAGER		DATE
REVIEWED BY CITY ENGINEER		DATE
APPROVED BY ORDINANCE NO		DATE
		PROJECT NO. M-599
		SHEET NO. 1 of 1