



I, Christine Walker, County Clerk for Jackson County, Oregon, certify that the instrument identified herein was recorded in the Clerk records.  
Christine Walker - County Clerk

**AFFIDAVIT OF MONUMENTATIO  
FOR  
DEFERRED MONUMENTS**

20277

**KNOW ALL MEN BY THESE PRESENTS**, that I, David M. Minneci, a duly Registered Professional Land Surveyor in the State of Oregon, do hereby affirm that I have established with proper monuments as required by law those monuments shown as deferred on the Official Plat of **TOWNHOMES AT OAK COURT, PHASES 1, 2, 3 & 4** as recorded in Volume 29 of Plats, Page 9 of Records in Jackson County, Oregon.

(See Exhibit "A" attached)

This Affidavit is to comply with Chapter 92.070 of the Revised Statues of the State of Oregon.

In Witness Hereof, signed this 8<sup>th</sup> day of DECEMBER, 2008.

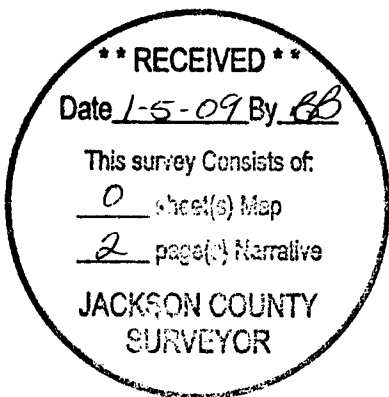

Expires 12/31/10

STATE OF OREGON ) ss.  
County of Jackson )

On this 8 day of December, 2008, personally appeared the above named David M. Minneci, a Registered Professional Land Surveyor, and acknowledged the foregoing instrument to be his voluntary act and deed.

Before me:

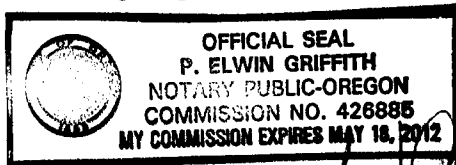

P. Elwin Griffith  
Notary

Approved: \_\_\_\_\_

Medford City Surveyor

12/22/08  
Date

Examined and approved this 30<sup>th</sup> day of December, 2008.

[Signature]  
Jackson County Surveyor

Exhibit "A"

TOWNHOMES AT OAK COURT,  
PHASES 1, 2, 3 & 4

Post Monument Map

Located In:

the S.W. 1/4 of Section 17 &  
the S.E. 1/4 of Section 18,  
Township 37 South, Range 1 West, W.M.,  
City of Medford, Jackson County, Oregon



BROOKHURST VILLAGE CONDOMINIUM

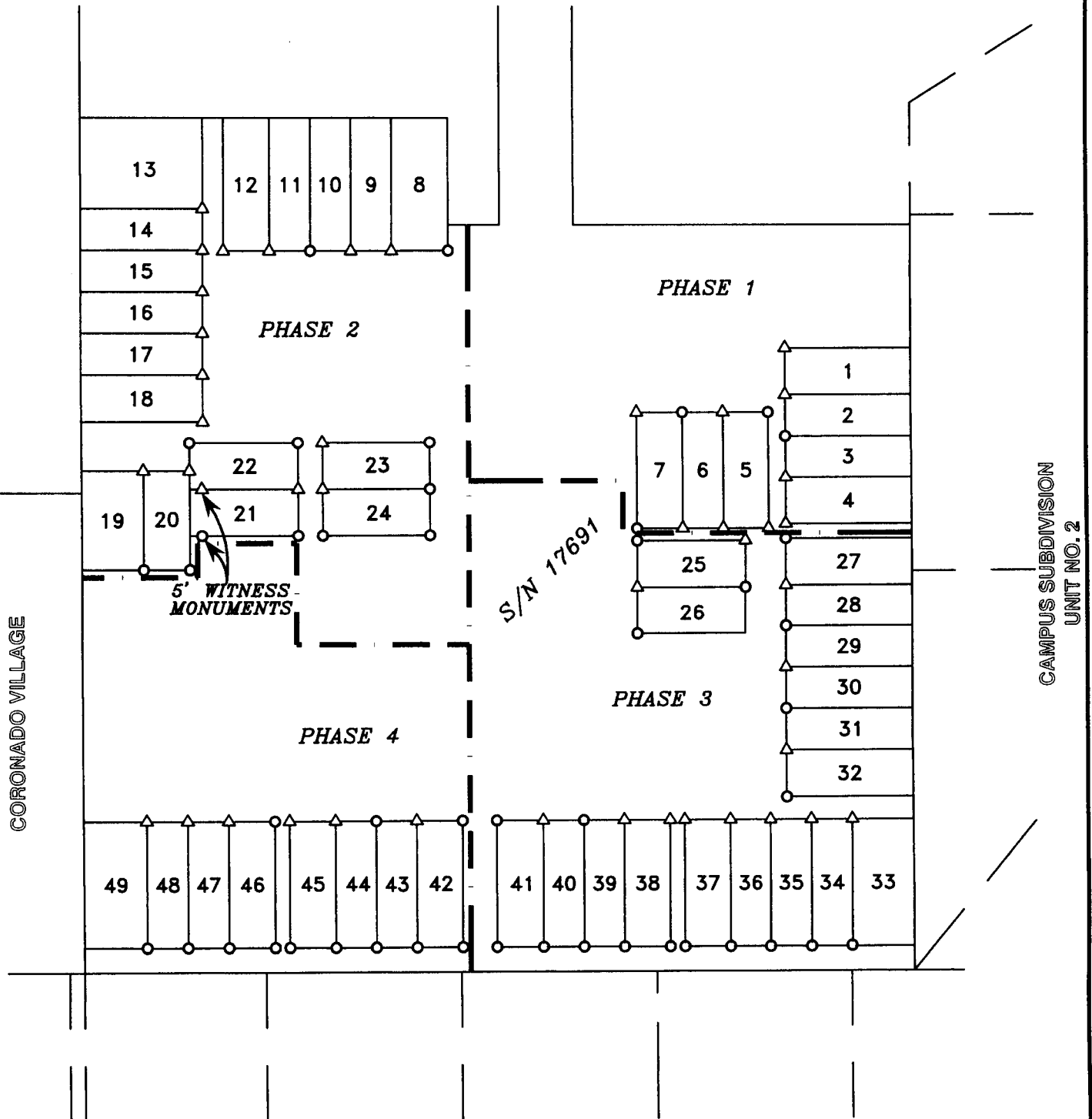

BLOSSOM HILL TERRACE  
UNITS NO. 3 & 4

HOFFBUHR & ASSOCIATES, INC.  
880 GOLF VIEW DR., STE. 201 MEDFORD, OREGON  
(541) 779-4641

BY: DAVID M. MINNECI RPLS NO. 2349  
SCALE: 1 INCH = 60' DECEMBER 2, 2008

REGISTERED  
PROFESSIONAL  
LAND SURVEYOR

*David M. Minnici*

OREGON  
JULY 26, 1998  
DAVID M. MINNECI  
2349

EXPIRES 12/31/10

- = SET 5/8" x 24" IRON PIN WITH PLASTIC CAP STAMPED "D. MINNECI LS 2349".
- △ = SET LEAD PLUG AND TACK WITH METAL WASHER STAMPED "LS 2349" IN CONCRETE.