

**SURVEY NARRATIVE**

PURPOSE: To survey and monument my client's deed corners.  
per O.R. 95-25386.

PROCEDURE: I recovered and tied monuments set on filed survey number 14662. Their positions fit very close to the record and were used for control. The Southeast corner has been destroyed by new construction. I computed the Southeast deed corner of Instrument number 95-25386 of the Deed Records, Jackson County, Oregon and set a monument, as shown.

**LEGEND**

- SET 5/8" X 30" REBAR WITH PLASTIC CAP MARKED 'TEMPLIN LS2359'
- FD. 1 1/2" IRON PIPE MONUMENT PER FS 14662
- ⊕ JACKSON COUNTY BRASS CAPPED MONUMENT
- △ INDICATES CALCULATED POSITION
- FS INDICATES FILED SURVEY

BASIS OF BEARING: FILED SURVEY NUMBER 14662

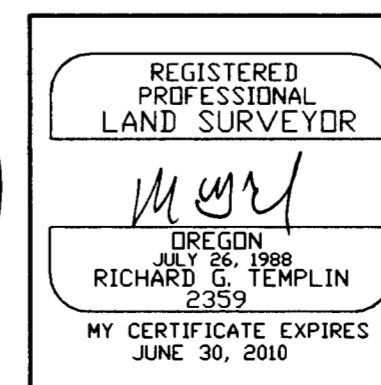
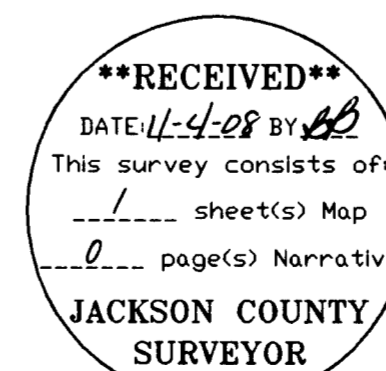

FILE: 'COLVTLANT.dwg'

RICHARD TEMPLIN LAND SURVEYING  
P.O. BOX 1946 899-2032 JACKSONVILLE, OREGON

**MAP OF SURVEY**

LOCATED IN  
THE SE 1/4 OF SECTION 23 ,T.38S., R.1 W., W.M.  
JACKSON COUNTY, OREGON

FOR: Colvin Oil Company  
2520 foothills Blvd.  
Grants Pass, Or. 97526 DATE: SEPTEMBER 29, 2008