

NE COR
DLC 37

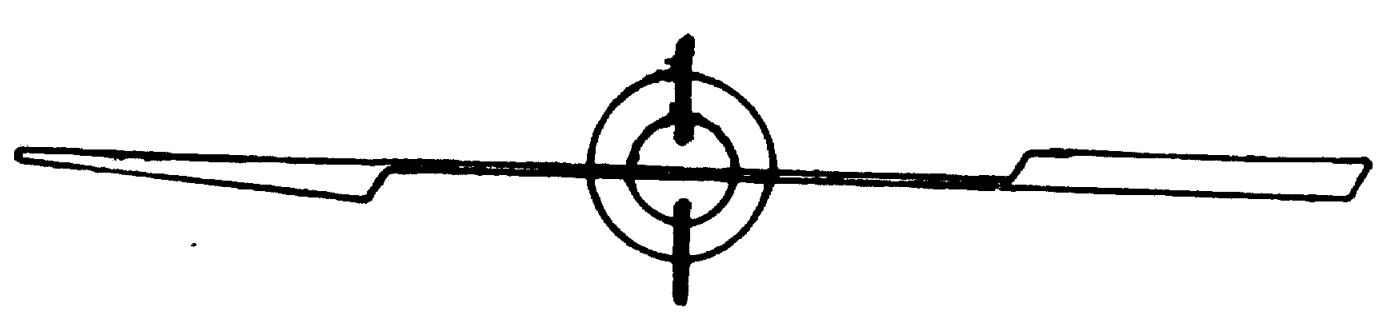

SURVEY IN THE CITY OF JACKSONVILLE
 FOR
 JOHN L. SULLIVAN
 62-19

BY EDWARD MCGINTY
 MEDFORD, OREGON
 JULY, 1962

SCALE 1"=100'
 ○ = 5/8" I. PIN
 ✕ = 3/4" I. PIPE

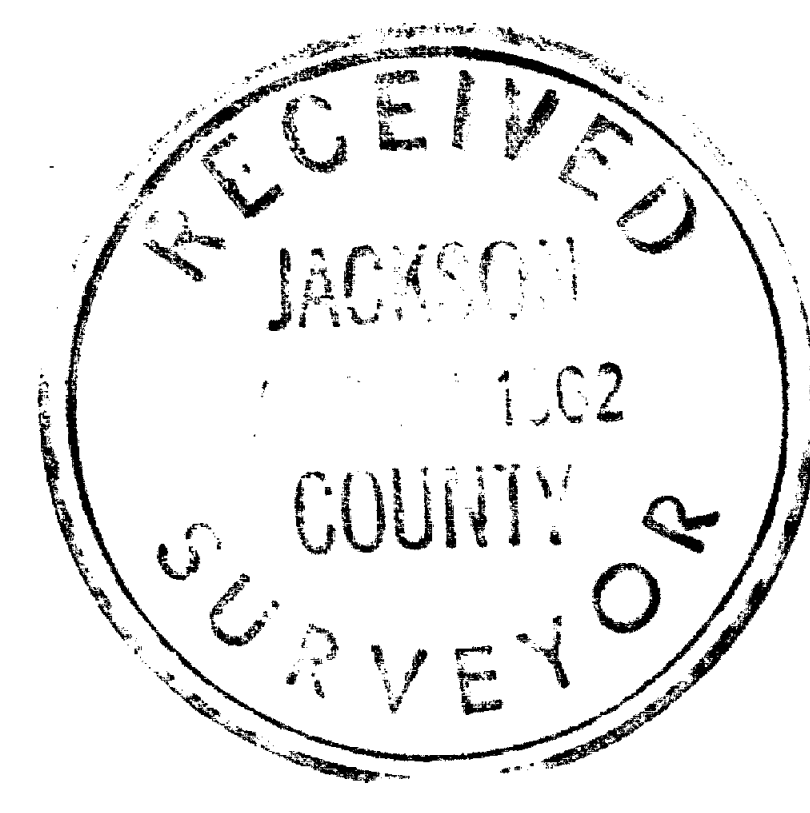

REGISTERED
 OREGON
 LAND SURVEYOR
 Edward A. McGinty
 JULY 1962
 EDWARD A. MCGINTY
 301

NW COR
DLC 37

SW COR
DLC 37

Survey No. 2002

Survey Narrative to comply with O.R.S. 209-250.

Survey for: John Sullivan
501 Old Stage Rd., J'ville

Survey by: Edward A. McGinty, L.S. 7/20/62

BASIS OF BEARING: Previous Survey No. 1339.

PRECEDENCE OF SURVEY:

The center of Oregon Street was determined from previous survey, using deed records, monuments found and the Valley View Sub-division. The Southwest corner of the Valley View Sub-div. was determined at a record plat distance from the Valley View Sub-div. on the DLC line from the Northwest corner of DLC 37. This corner is not identical to the monument shown on the 1st. Addition to the Jacksonville Cemetery.

The south line of the Valley View Sub-div. was determined from the north line of the old Hoffman tract, also Valley View Sub-div. as shown along Oregon St. This line is in close agreement with the existing fence.

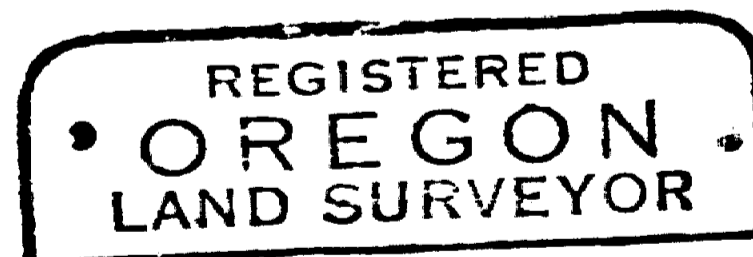

Edward A. McGinty
JULY 10, 1962
EDWARD A. MCGINTY
301