

PARTITION PLAT NO. P-19-2008

located in the
NORTHEAST QUARTER OF SECTION 11
AND SOUTHEAST QUARTER OF SECTION 11,
TOWNSHIP 38 SOUTH, RANGE 2 WEST,
WILLAMETTE MERIDIAN, JACKSON COUNTY, OREGON

for
FORESITE LLC

SITE ADDRESS
6423 PIONEER ROAD
MEDFORD, OREGON 97501

Surveyor's Certificate:

I, Herbert A. Farber, a duly registered Professional Land Surveyor of the State of Oregon, do hereby certify that I have correctly surveyed and marked with proper monuments, as provided by law, the tract of land hereon shown, this plat being a correct representation of the same, and the following is an accurate description of the boundary lines:

Commencing at the Southeast corner of Donation Land Claim 47 in Township 38 South, Range 2 West, of the Willamette Meridian, Jackson County, Oregon; thence South 89°54'07" West, along the south line of said Donation Land Claim, 114.79 feet; to the easterly boundary of the parcel described in Volume 466, Page 390 of the Deed records of Jackson County, Oregon; thence North 08°31'27" East, along said easterly boundary, 36.32 feet to the south boundary of the tract described in Instrument Number 2006-22838 of the official records of Jackson County, Oregon; thence North 86°16'39" East, along said south boundary, 392.28 feet to the POINT OF BEGINNING and the INITIAL POINT of the Partition; thence South 86°16'39" West, along said south boundary, 392.28 feet to the west boundary of said tract, also being the east boundary of said parcel; thence North 08°40'14" East, along said west boundary, 556.07 feet to the southerly right-of-way line of Pioneer Road; thence leaving said west boundary South 73°07'12" East, along said right-of-way, 350.96 feet to the east boundary of said tract; thence leaving said right-of-way, South 19°55'10" West, along said east boundary, 206.53 feet; thence continuing along said east boundary, South 12°47'38" East, 96.19 feet; thence South 08°49'08" East, along said east boundary, 135.97 feet to the POINT OF BEGINNING.

Herbert A. Farber
Herbert A. Farber, PLS 2189

Easement Notes:

An easement created by instrument (Volume 577, Page 157 Deed Records of Jackson County), including the terms and provisions thereof in favor of Pacific Power & Light Company has no specific location and could not be located.

Christine Savory
CHRISTINE SAVORY

State of Oregon)
County of Jackson)

This instrument was acknowledged before me this 21st day of March, 2008, by Christine Savory

Susan Morgan Farber
(Signature)
SUSAN MORGAN FARBER
(Printed Name)

Notary Public - Oregon Commission No. 426455

My commission expires April 21, 2012

Thomas Savory
THOMAS SAVORY

State of Oregon)
County of Jackson)

This instrument was acknowledged before me this 21st day of March, 2008, by Thomas Savory

Susan Morgan Farber
(Signature)
SUSAN MORGAN FARBER
(Printed Name)

Notary Public - Oregon Commission No. 426455

My commission expires April 21, 2012

Declaration:

KNOW ALL MEN BY THESE PRESENTS, that THOMAS SAVORY who took title as Thomas Savor, CHRISTINE SAVORY, CHARITY APRIL SAVORY, RENY TOWNSEND, AS TENANTS IN COMMON WITH RIGHTS OF SURVIVORSHIP are the owners of lands hereon described, and that they have partitioned the same into parcels as shown hereon and the number and size of the parcels and the courses and lengths of the lines are plainly set forth, and they hereby create the PRIVATE UTILITY EASEMENT easement for the benefit of parcel 2 and they do hereby create the irrigation easements for the benefit of Parcel 1, and that this plat is a correct representation of the Partition.

RENY TOWNSEND
RENY TOWNSEND

State of Oregon)
County of Jackson)

This instrument was acknowledged before me this 21st day of March, 2008, by RENY TOWNSEND

Susan Morgan Farber
(Signature)
SUSAN MORGAN FARBER
(Printed Name)

Notary Public - Oregon Commission No. 426455

My commission expires April 21, 2012

Charity April Savory
CHARITY APRIL SAVORY

State of Oregon)
County of Jackson)

This instrument was acknowledged before me this 21st day of March, 2008, by Charity April Savory

Susan Morgan Farber
(Signature)
SUSAN MORGAN FARBER
(Printed Name)

Notary Public - Oregon Commission No. 426455

My commission expires April 21, 2012

Approvals:

Examined and approved by the Jackson County Surveyor this 4th day of January, 2008.

Ronald Roberts
County Surveyor

Examined and approved by Jackson County Development Services and Development, File No. SUB2007-00087 MP this 24th day of March, 2008.

Susan G... ..
Planning Director

All taxes, fees, assessments, or other charges as required by O.R.S. 92.095 have been paid as of March 27, 2008

Karen M... .. Deputy Tax Collector 3-27-08 Date

Amanda Kirkpatrick deputy Assessor 3/27/08 Date

Recorder:

Filed for record this 27 day of MARCH, 2008 at 3:12 o'clock P. M. and recorded as Partition Plat No. P-19-2008 of the Records of Jackson County, Oregon, Index Volume 19, Page 19.

Christine D Walker County Clerk Barbara J Shaw Deputy

County Surveyor's File No. 19983

I, Herbert A. Farber, do hereby certify that this is an exact copy of the original.

Herbert A. Farber

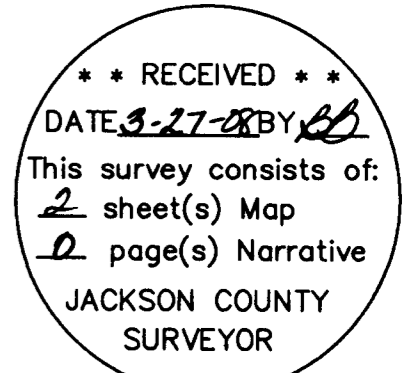
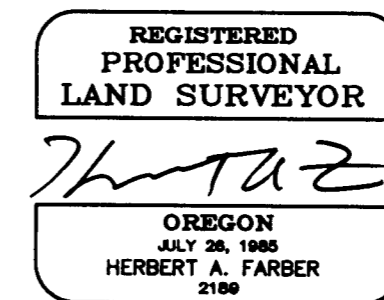

NUM	BEARING	DISTANCE
L1	N3217°00'E	21.52
L2	N57°43'00"W	10.00
L3	N3217°00'E	21.52

PARTITION PLAT NO. P-19-2008

located in the
NORTHEAST QUARTER OF SECTION 11
AND SOUTHEAST QUARTER OF SECTION 11,
TOWNSHIP 38 SOUTH, RANGE 2 WEST,
WILLAMETTE MERIDIAN, JACKSON COUNTY, OREGON

for
FORESITE LLC

MAILING ADDRESS
6403 PIONEER ROAD
MEDFORD, OREGON 97501

SITE ADDRESS
6423 PIONEER ROAD
MEDFORD, OREGON 97501

LEGEND

- ⊙ = FOUND DONATION LAND CLAIM CORNER AS DESCRIBED
- △ = FOUND 5/8" IRON PIN PER S/N 1635, 1416
- = FOUND MONUMENT AS DESCRIBED
- ⊙ = SET 5/8" x 30" IRON PIN w/ YELLOW PLASTIC CAP MARKED "FARBER PLS 2189"
- = SET 5/8" x 24" IRON PIN w/ YELLOW PLASTIC CAP MARKED "FARBER PLS 2189"
- S/N = RECORD FILED SURVEY NUMBER
- W.M. = WITNESS MONUMENT
- R.O.W. = RIGHT-OF-WAY
- [] = RECORD SURVEY DATA PER S/N 1635

- BASIS OF BEARING IS TRUE NORTH, NAD 83/91 DATUM, AS DERIVED BY GLOBAL POSITIONING SYSTEM OBSERVATIONS.
- RECORD SURVEY DATA IS SHOWN IN PARENTHESIS ADJACENT TO MEASURED SURVEY DATA WHERE APPLICABLE.
- INST. No. = INSTRUMENT NUMBER AS RECORDED IN THE OFFICIAL RECORDS OF JACKSON COUNTY, OREGON.
- PRIVATE UTILITY EASEMENT = AN EASEMENT FOR ELECTIC POWER, PHONE, GAS, AND CABLE TV.

SURVEY NARRATIVE TO COMPLY WITH O.R.S. 208.250

PURPOSE: TO SURVEY AND MONUMENT THE MINOR LAND PARTITION APPROVED BY JACKSON COUNTY DEVELOPMENT SERVICES PER FILE NUMBER SUB2007-00087 MP.

PROCEDURE: UTILIZING CONTROL ESTABLISHED IN THIS AND PREVIOUS SURVEYS I TIED THE FOUND MONUMENTS ESTABLISHED ON SN'S 1196, 1416 AND 1635 AS SHOWN HEREON. THE EAST AND SOUTH BOUNDARY WERE LOCATED UTILIZING THE FOUND MONUMENTS AS SHOWN HEREON. THE WEST BOUNDARY WAS LOCATED UTILIZING THE RECORD DATA FROM INSTRUMENT NUMBER 2006-22838, BEING THE SAME AS THE DATA FOUND IN SN'S 1196, 1416 AND 1635, ADJUSTED USING THE COMPASS METHOD TO FIT BETWEEN THE FOUND MONUMENTS ON THE WEST AND NORTH BOUNDARY. THE EVIDENCE FROM THE DESCRIBED SURVEYS INDICATES THE COUNTY ROAD DEPARTMENT RESURVEYED PIONEER ROAD IN 1960 WITH A ROLL MAP 27/4 DATED OCTOBER 1963 REFLECTING THIS SURVEY. THE COUNTY SURVEY AND THE EXISTING CENTER LINE OF THE ROAD APPEAR TO MATCH REASONABLY WELL HAVING ONLY A 27 MINUTE DIFFERENCE IN BEARING. THE PREVIOUSLY MENTIONED SURVEYS HAVE A BEARING DIFFERENCE IN DEGREES. IT IS ALSO NOTED THAT THE BEARING DIFFERENCE BETWEEN FOUND MONUMENTS IS FROM 4 TO 15 MINUTES. THE RESULTING BEARING OF THE COMPASS ADJUSTED DATE WAS USED AND INTERSECTED WITH THE SOUTH LINE OF THE EXISTING ROAD LOCATION DERIVED FROM THE EXISTING PHYSICAL CENTERLINE LOCATION. THE DEEDS ALL CALL FOR THE SOUTH RIGHT-OF-WAY OF THE COUNTY ROAD THEREFORE THIS CALL WAS HELD. THE RECOVERED MONUMENT AT THE NORTH EASTERLY CORNER AND THE SET MONUMENT AT THE NORTHWESTERLY CORNER ARE WITNESS MONUMENTS TO THE RIGHT-OF-WAY OF PIONEER ROAD.

FARBER & SONS, INC.
Surveyed by:
dba FARBER SURVEYING
(541) 664-5599
PO BOX 5286
431 OAK STREET
CENTRAL POINT, OREGON 97502

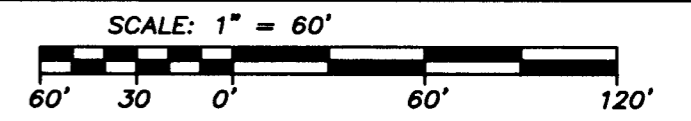

DATE: November 11, 2007
JOB NO.: 1492-07
DRAWING FILE: JOBS\Griffin Crk-Pioneer Road\Pioneer Rd Projects\
Savory-2\MicroSurvey\FINAL PLAT PLAT\FINAL PARTITION PLAT.DWG

** RECEIVED **
DATE 3-27-08 BY ab
This survey consists of:
2 sheet(s) Map
2 page(s) Narrative
JACKSON COUNTY
SURVEYOR

I, Herbert A. Farber, do hereby certify
that this is an exact copy of the original.

REGISTERED
PROFESSIONAL
LAND SURVEYOR

OREGON
JULY 26, 1985
HERBERT A. FARBER
2189
RENEWAL DATE 12-31-09