

*** SURVEYOR'S CERTIFICATE ***

I, Bary D. Kaiser, a duly registered professional land surveyor of the State of Oregon, do hereby certify that I have correctly surveyed and marked with proper monuments as provided by law the attached partition plat, said plat being a correct representation of the same, and the following is an accurate description of the boundary lines:

Parcel No. One (1) of Partition Plat No. P-65-2004 recorded October 12, 2004 in "Record of Partition Plats" in Jackson County, Oregon, and filed as Survey No. 18457 in the Office of the County Surveyor.

Bary D Kaiser
SURVEYOR

*** DECLARATION ***

KNOWN ALL MEN BY THESE PRESENTS, that DAVID C. MCFALL and RUTH A. MCFALL, as tenants by the entirety, are the owner of the lands represented on this Partition Plat and more particularly described in the Surveyor's Certificate, and has caused the same to be partitioned into parcels as shown on the Partition Plat.

IN WITNESS WHEREOF, WE HAVE SET OUR HANDS AND SEALS THIS 10 DAY OF May, 2007.

David C McFall
DAVID C. MCFALL

Ruth A McFall
RUTH A. MCFALL

STATE OF OREGON
COUNTY OF JACKSON)^{ss}

Personally appeared the above named DAVID C. MCFALL and RUTH A. MCFALL, and acknowledged the forgoing instrument to be their voluntary act and deed.

Subscribed and sworn to before me this 10 day of May, 2007.

(SIGN) *Carol Sartain*
Carol Sartain NOTARY PUBLIC - OREGON
(PRINT)
COMMISSION NO. 363868
MY COMMISSION EXPIRES 9-22-2008

*** APPROVALS ***

Examined and approved by the City Administrator/Planning Director of the City of Eagle Point, Jackson County, Oregon. (File PA #05/06-22: EXP/PLP)

Daniel R. Marshall
CITY ADMINISTRATOR/PLANNING DIRECTOR

Examined and approved this 23rd day of MAY, 2007.

Gregory R. Roberts 7/16/07
JACKSON COUNTY SURVEYOR

All taxes, fees, assessments or other charges as required by O.R.S. 92.095 have been paid as of the 29th day of November, 2007.

Amanda Kirkpatrick, deputy 11/29/07
ASSESSOR DATE

Karen W. Meade, Deputy 11/29/07
TAX COLLECTOR DATE

*** RECORDER'S CERTIFICATE ***

Filed for record, this 30th day of NOVEMBER, 2007, at 10:10 O'clock A.m., and recorded as Partition Plat No. P-71-2007 of the Records of Jackson County, Oregon Index Volume 18, Page 71.

Kathleen S Beckett *Barbara J SHAW*
COUNTY CLERK DEPUTY

COUNTY SURVEYOR FILE No. 19845

I HEREBY CERTIFY THAT THIS IS A
PHOTOCOPY OF THE ORIGINAL PLAT

Bary D Kaiser
SURVEYOR

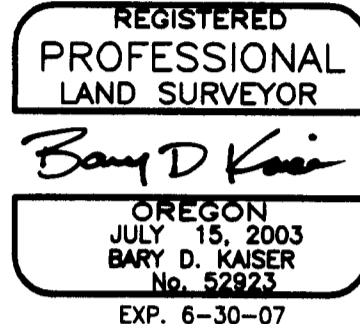

SCALE: 1" = 40'

PARTITION PLAT No. P-71-2007

Located in the N.E. 1/4 of Section 34, T.35S.,R.1W., W.M.,
City of Eagle Point, Jackson County, Oregon

SURVEY FOR:
Dave C. McFall
P.O. Box 924
Eagle Point, OR. 97524

DATE:
August 25, 2006

SURVEY BY:
Kaiser Surveying
19754 Highway 62
Eagle Point, OR. 97524

EASEMENTS SHOWN ON A CURRENT TITLE REPORT

- 1. Power Line Easement described in Vol. 234, Page 154 D.R. refers to easement on Lot 17 EPM.
- 2. The subject premises may be subject to covenants, conditions, restrictions setbacks and easements as disclosed in Inst. No. 72-02317 O.R.. The 10-foot wide irrigation easement shown on S.N. 3501 and indicated on Inst. No. 72-02317 O.R. is shown hereon.

LEGEND

- o = Found 5/8" Rebar With Aluminum Cap - BHE1
- Δ = Found 5/8" Rebar with Plastic Cap - BHE1
- = Set 5/8" x 24" Rebar with Aluminum Cap marked "B KAISER RLS 52923"
- = Set 5/8" x 24" Rebar with Plastic Cap marked "B KAISER RLS 52923"
- S.N. = Filed Survey Number County Surveyors Office
- P.U.E. = Public Utility Easement
- EPM = EAGLE POINT MEADOWS
- BHE1 = BARTON HILLS ESTATES - PHASE 1
- () = Record/EPM

SURVEY NARRATIVE TO COMPLY WITH O.R.S. 209.250

PURPOSE: Partition Survey of Parcel No. 1 of Partition Plat No. P-65-2004.

PROCEDURE: The outside boundary of subject property was determined by information from Survey No. 18457 and the plat of BARTON HILLS ESTATES - PHASE 1. The Parcel boundaries were located per the clients direction and the City Approval.

