

# MAP OF SURVEY

FOR  
CITY OF ASHLAND  
PUBLIC WORKS DEPARTMENT  
20 EAST MAIN STREET  
ASHLAND, OREGON 97520

LOCATED IN

IN THE SOUTHEAST 1/4 OF SECTION 10  
TOWNSHIP 39 SOUTH, RANGE 1 EAST, WILLAMETTE MERIDIAN,  
CITY OF ASHLAND, JACKSON COUNTY, OREGON

SCALE: 1" = 100'  
DATE OF SURVEY: AUGUST 22, 2007  
ALL DISTANCES ARE IN FEET AND DECIMALS THEREOF

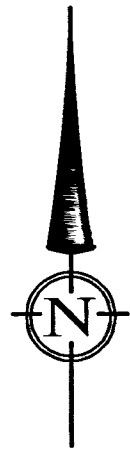

NE COR DLC NO. 45  
FD 1 1/4" IRON PIPE  
W/PLASTIC PLUG  
PLUG NOT LEGIBLE  
(REF. FS 16051)

SET 5/8" X 6" IRON PIN  
IN ASPHALT BIKE PATH  
WITH CAP MARKED:  
OSMUS PLS 2464  
(PIN DRIVEN TO REFUSAL  
IN ROCK UNDER PATH)

FD 5/8" IRON PIN W/CAP  
MARKED: FARBER, PLS 2189  
FROM FS 16826

FS 16826

### LEGEND

- SURVEYED PROPERTY LINE
- SET 5/8" X 30" IRON PIN WITH CAP MARKED 'OSMUS PLS 2464' UNLESS OTHERWISE NOTED
- FOUND MONUMENT AS NOTED
- FS FILED SURVEY, JACKSON COUNTY, OREGON
- VOL., PG. DEED RECORDS, JACKSON COUNTY, OREGON
- OR- OFFICIAL RECORDS, JACKSON COUNTY, OREGON
- FD FOUND
- DLC DONATION LAND CLAIM

**RECEIVED**  
Date 8-30-07 By SS  
This survey consists of:  
1 sheet(s) Map  
1 page(s) Narrative  
JACKSON COUNTY SURVEYOR

### REFERENCES

- ( DR ) DEED RECORD BEARINGS OR DISTANCES
- ( R1 ) RECORD BEARINGS OR DISTANCES, FS 6055
- ( R2 ) RECORD BEARINGS OR DISTANCES, FS 15594

I CERTIFY THAT THIS SURVEY WAS PREPARED WITH HEWLETT PACKARD INK #51640A ON COMSTOCK MYLAR #130444.

*Stuart M. Osmus*

STUART M. OSMUS, PLS 2464

REGISTERED  
PROFESSIONAL  
LAND SURVEYOR

OREGON  
JULY 28, 1999  
STUART M. OSMUS  
No. 2464  
Expires 12/31/09

**TERRASURVEY, INC.**  
PROFESSIONAL LAND SURVEYORS

274 FOURTH STREET  
ASHLAND, OREGON 97520

(541) 482-6474  
terrain@bisp.net

SHEET 1 OF 1

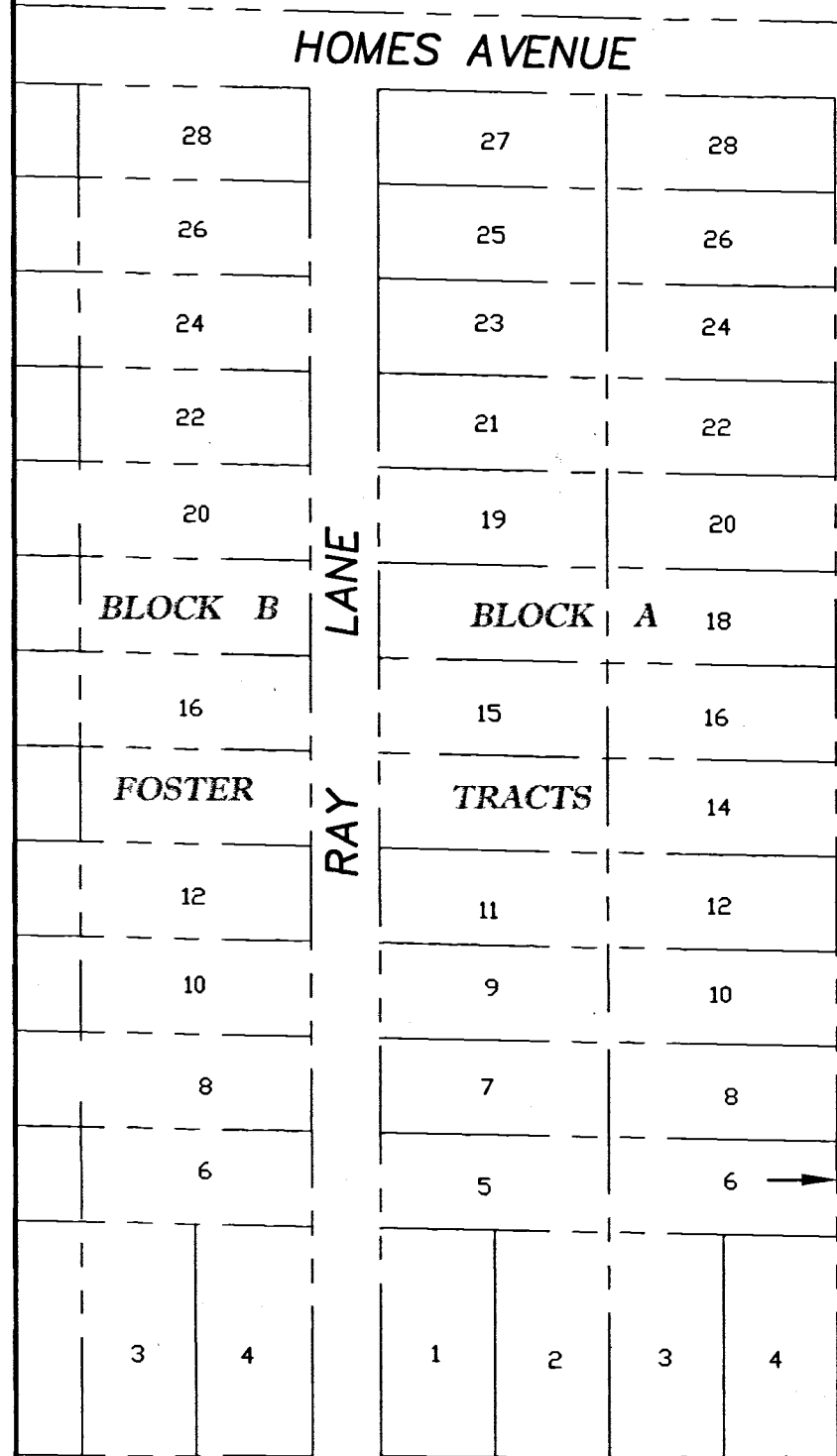

N00°05'49"E 2554.77'  
N00°05'49"E 977.05'  
(DR=N00°20'E)

### BASIS OF BEARING

BEARINGS BASED ON THE EAST LINE OF DONATION LAND CLAIM NO. 45, AS SHOWN ON FILED SURVEY NO. 16051.

SE COR DLC NO. 45  
FD 2 1/2" BRASS CAP  
IN CONCRETE. MARKED:  
CS 1988  
N00°05'49"E 1507.72'

45' RIGHT OF WAY FROM OR 72-13286

(R2=N88°15'W)  
(R1=N88°15'W)  
N89°43'40"W  
1096.75'

FS 6055 **ASHLAND STREET (HIGHWAY NO. 66)**

WIDTH OF STREET VARIES, SEE FS 6055

### SHAMROCK LANE

FD 5/8" IRON PIN W/CAP  
CAP NOT LEGIBLE  
FROM FS 15594

FS 15594

N68°58'23"W  
388.45'

SECTION CORNER  
FD BRASS CAP IN PAVEMENT  
MARKED: JACKSON COUNTY SURVEYOR  
T 39 S, R 1 E  
2003

N89°52'40"W  
9.46'

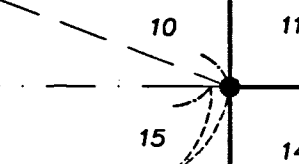

**SURVEY NARRATIVE**  
TO COMPLY WITH PARAGRAPH 209.250, OREGON REVISED STATUTES

**DATE OF SURVEY:**

August 22, 2007

**SURVEYED BY:**

Terrasurvey, Inc.  
274 Fourth Street  
Ashland, Oregon 97520

**SURVEY FOR:**

City of Ashland  
20 East Main Street  
Ashland, Oregon 97520

**LOCATION:**

Located in the Southeast Quarter of Section 10, Township 39 South, Range 1 East, Willamette Meridian, City of Ashland, Jackson County, Oregon.

**PURPOSE:**

To monument the easterly line of Normal Avenue between Ashland Street and the Southern Pacific Railroad.

**BASIS OF BEARINGS:**

The east line of Donation Land Claim No. 45 as shown on Filed Survey No. 16051.

**PROCEDURE:**

This portion of Normal Avenue was dedicated to public use by the recording of the Foster Tracts in 1948. The east line of the street right of way is shown as the east line of Donation Land Claim No. 45. The descriptions of the properties which comprise the Mountain View Cemetery begin at the southeast corner of Section 10 and go westerly to a point 0.60' past the DLC line but do not call to the line. Considering the time when these deeds were created (1904 and 1921), I feel that the intent was to convey the land up to the edge of the Claim. The northerly line of Ashland Street, as shown on this Map, is based on the descriptions in Document No. 72-13286. The narrative for Survey No. 15594 discusses the discrepancies between monuments set along this northerly line by the State of Oregon and the locations shown on Filed Survey No. 6055 which was based on this Document.

The southwesterly line of the Southern Pacific Railroad right of way is shown fifty feet from the centerline of the existing tracks. This location fits well with a found pin from Filed Survey No. 16826. The narrative for that survey discusses the original 200 foot wide right of way grant for the railroad verses the surrounding deed records which imply a 100 foot wide right of way.

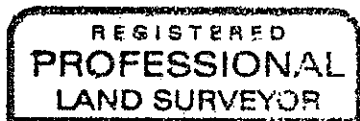

*S.M.O.*

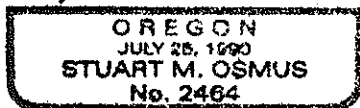

Expires 12/31/08

August 28, 2007

Stuart M. Osmus, PLS 2464  
Terrasurvey, Inc.  
274 Fourth Street  
Ashland, Oregon 97520

