

01277653200700356420030038

I, Kathleen S. Beckett, County Clerk for Jackson County, Oregon, certify that the instrument identified herein was recorded in the Clerk records.

Kathleen S. Beckett - County Clerk

**AFFIDAVIT OF DEFERRED MONUMENTS, TO COMPLY WITH 92.070**  
**OF THE OREGON REVISED STATUTES**

19722

Know all persons by these presents, that I, Cael E. Neathamer, a Registered Land Surveyor in the State of Oregon (Registrant No. 56545), do hereby affirm that I have established, with proper monuments, the subdivision corners depicted as "DEFERRED MONUMENT", on the official plat of MEADOWBROOK PARK II AT NORTH MOUNTAIN, as recorded on October 19, 2006, in Volume 32 of Plats, at Page 87 of the Records of Jackson County, Oregon, and filed as Survey Number 19378 in the office of the Jackson County Surveyor. Exception to which described as follows:

- (1) The first two symbols in the LEGEND per said plat, stated as a set 5/8-inch diameter by either 24-inches or 30-inches in length, with an orange plastic cap marked "C. Neathamer LS 56545", were physically established with an orange plastic cap marked "Neathamer Surveying";
- (2) A Witness Monument on the north line of Lot 20, being North 86°04'12" West, 2.00 feet from the northeast corner thereof;
- (3) A Witness Monument on the line common to Lots 40-42, being North 86°57'26" West, 2.00 feet from the southeast corner of Lot 40;
- (4) A Witness Monument on the west line of Lot 52, being North 00°00'12" East, 3.00 feet from the southwest corner thereof;
- (5) A Witness Monument on the centerline of Alley "G", being South 86°04'12" West, 4.00 feet from the intersection of Alley "G" and Alley "F", set due to a storm drain inlet at said intersection;
- (6) Set in concrete, an 038 caliber shell with lead, tack and brass washer marked "Neathamer Surveying" as follows:

Lot 1 at the northwest and southeast corners, and the easterly end of Curve Number C46;

On the northerly right of way line of Stone Ridge Avenue, at the corners common to Lots 1-2, 2-3, 3-4, 4-5, 5-6, 6-7, and 7-8;

At the westerly end of Curve Number C47, Lot 8;

At the ends of the Curve Number C50, Lot 10;

On the southerly right of way line of Stone Ridge Avenue, at the corners common to Lots 10-11, 11-12, and 12-13;

The northwest corner of Lot 13;

The northeast corner and the north end of Curve Number C53, Lot 14;

Witness Monuments set on the north line of Lot 14 (being South 86°37'42" East, 1.00 foot from the east end of Curve Number 52), and on the west line of Lot 14 (being along Curve Number C53, 1.00 foot northerly from the southerly end thereof);

On the easterly right of way of Kestrel Parkway at the corners common to Lots 14-15, 15-16, and 16-17;

On the easterly right of way of Patton Lane, at the common corner of Lots 58-59;

On the westerly right of way of Camelot Drive, at the corners common to Lots 53-54, 54-55, 55-56, 56-57, 57-58, 58-59, 59-60, 60-61, 61-62, 62-63, 63-64, the southerly end of Curve Number C129 (Lot 58), the northerly end of Curve Number C124 (Lot 63), and at the northeast corner of Lot 64;

On the easterly right of way of Camelot Drive, at the corner common to Lots 65-81 and Lots 72-81;

The centerline of Alley C at its intersection with the northerly line of Lot 81 (being the southerly end of Line Number L22 and the northerly end of Line Number L23);

The northeast corner of Lot 72;

On the southerly right of way of Fair Oaks Avenue, at the corners common to Lots 74-75, 75-76, at the easterly end of Curve Number C139, and at the easterly end of Curve C143;

Monuments described herein were established between December 18, 2006, and February 2007.

this 23<sup>rd</sup> day of July, 2007:     Cael E. Neathamer      
Surveyor's Signature

Prepared by: Neathamer Surveying, Inc.  
3132 State St., Suite 110  
PO Box 1584  
Medford, OR 97501

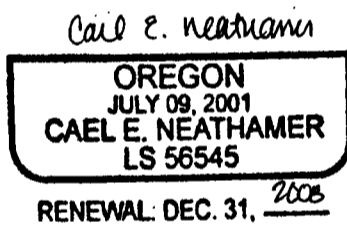
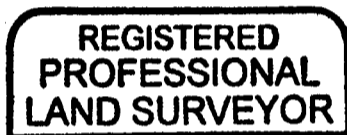

CITY OF OREGON        )  
                              ) ss  
CITY OF JACKSON     )

I appeared before me this 23 day of July, 2007, appeared before me the above Cael E. Neathamer, known to me to be an Oregon Licensed Land Surveyor (LS56545).

Mark Neathamer  
Notary Public for Oregon

July 23<sup>rd</sup> 07  
Date



Witnessed and approved this 23 day of July, 2007.

Janet Olsen  
City Surveyor, City of Ashland

7/23/07  
Date

Witnessed and approved this 30<sup>th</sup> day of July, 2007.

Roger Roberts  
Jackson County Surveyor

July 30<sup>th</sup> 2007  
Date

The north end of Curve Number C54, Lot 16;

The ends of the Curve Number C56, and the southeast corner of Lot 17;

The southwest corner of Lot 18;

On the northerly right of way of Fair Oaks Avenue at the corners common to Lots 18-19 and 19-20;

The westerly end of Curve Number C60, at Lot 19;

The ends of Curve Number C58, at Lot 20;

The ends of Curve Number C65, Lot 21;

On the easterly right of way of Kestrel Parkway at the common corners of Lots 21-22, 22-23, 23-24, and 24-25;

The northerly end of Curve Number C66, Lot 23;

On the southerly right of way of Fair Oaks Avenue at the corners common to Lots 26-27;

The ends of Curves Numbered C74 and C75, Lot 27;

On the westerly right of way of Stone Ridge Avenue at the corners common to Lots 27-28, 28-29 and 29-30, and at the southerly end of Curve Number C79;

On the southerly right of way of Fair Oaks Avenue at the end of Curve Number C88 Lot 33, and at the northeast corner thereof;

A Witness Monument on the northerly line of Lot 33, being North  $61^{\circ}39'27''$  West, 1.00 foot from the westerly end of Curve Number C89;

The northeast corner of Lot 33;

The ends of Curve Number C90, Lot 34;

On the northerly right of way of Fair Oaks Avenue, at the corner common to Lots 34-35;

The ends of Curves Numbered C94 and C95, Lot 35;

On the easterly right of way of Stone Ridge Avenue, at the corner common to Lots 34-36;

The southwest and northeast corners of Lot 38;

The northeast corner of Lot 41;

The easterly end of Curve Number C101, Lot 50;

The easterly end of Curve Number C113 and the ends of Curve Number C112, Lot 53;

The northwest and southeast corners of Lot 52;

On the westerly right of way of Patton Lane, at the southerly end of Line Number L21 and the angle point North  $89^{\circ}59'08''$  West from the southerly end of Line Number L21, Lot 52;