

SURVEY IN SEC. 16&21 T.36S., R.1W., WM.
FOR
BUD HOOVER

BY EDWARD A. MC GINTY
 MEDFORD, OREGON
 APRIL, 1962

SCALE 1"=300'
 O= 5/8" I.PIN
 ⊙= A. E. BRASS DISC
 □= CON. MON. FD.
 ⊠= LEAD PLUG CON. MON.

REGISTERED
OREGON
 LAND SURVEYOR
Edward A. McGinty
 JULY 10, 1953
 EDWARD A. MCGINTY
 301

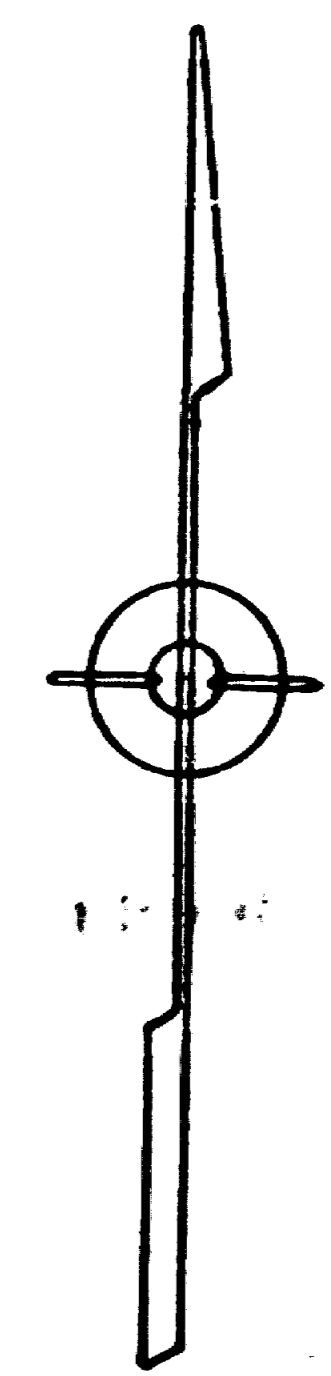

RECEIVED
 JACKSON
 JUL 13, 1962
 COUNTY
 SURVEYOR

1964

Survey No. _____

Survey Narrative to comply with O.R.S. 209-250.

Survey for: Bud Hoover

Survey by: Edward A. McGinty, L.S.
5/25/62

BASIS OF BEARING: Agate Sub-Div. No. 2.

PRECEDENCE OF SURVEY:

Surveyed parcels of land as shown, the westerly line being projected northerly of the west line of Agate Sub-D. Ext. No. 2.

The westerly line of Atlantic Ave. was determined from the Sub-division of Agate Sub-division Ext. No. 5.

The streets as shown on this survey, with the exception of Atlantic Ave. and Antelope Road, are intended to be retained as private roads at the time of this survey.

The line shown as the accepted line and agreed to by adjacent owners, may or maynot be the deeded line. This was surveyed approx. 15 yrs. ago by Watkins and has been maintained as the accepted line between adjacent owners.

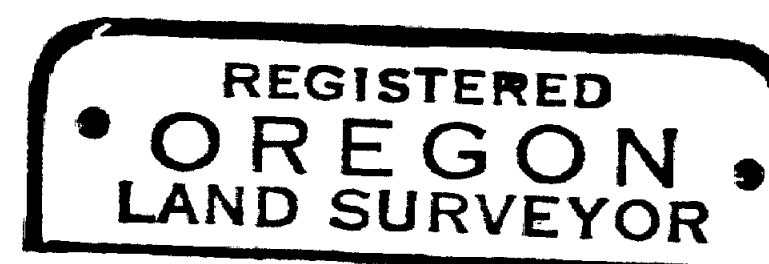
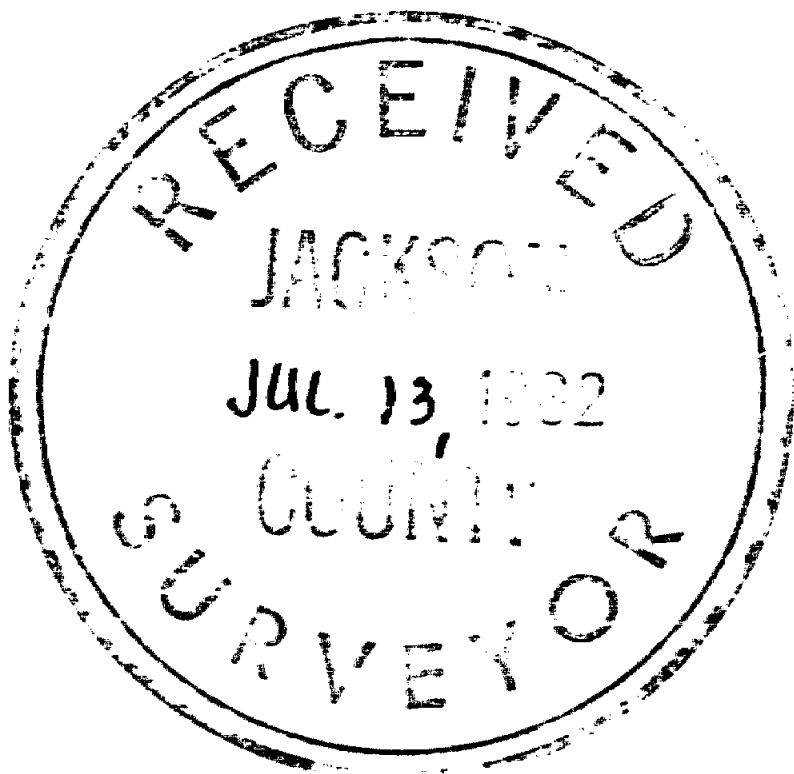

Edward A. McGinty

