

SURVEY IN SEC. 21 T.34S. R.4W. W.M.

FOR

CAL-ORE RANCHES

BY EDWARD MCGINTY
 MEDFORD OREGON
 JULY 1962

SCALE 1" = 200'
 ○ = 5/8" I. PIN
 ● = 3/4" I. PIPE

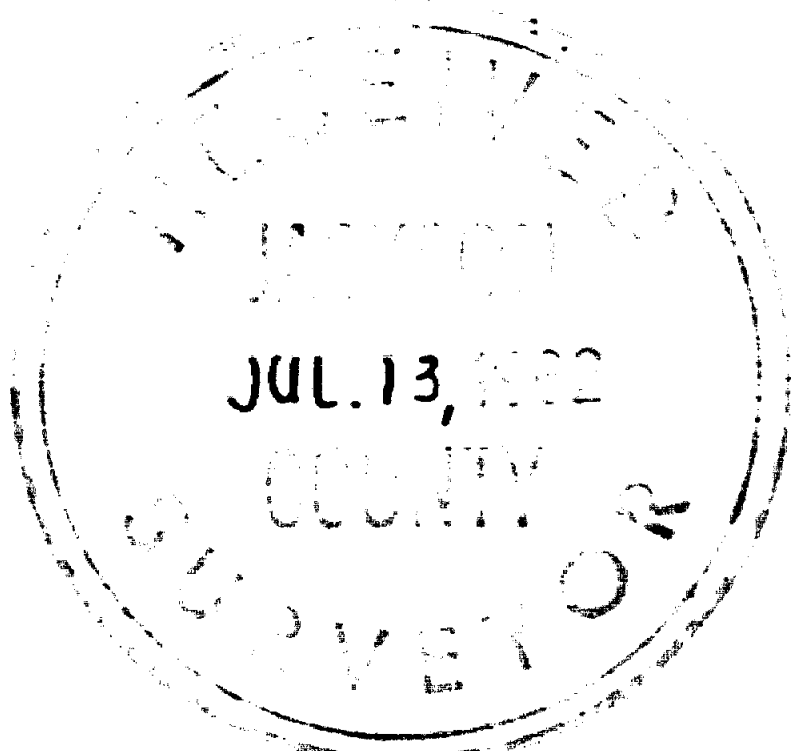
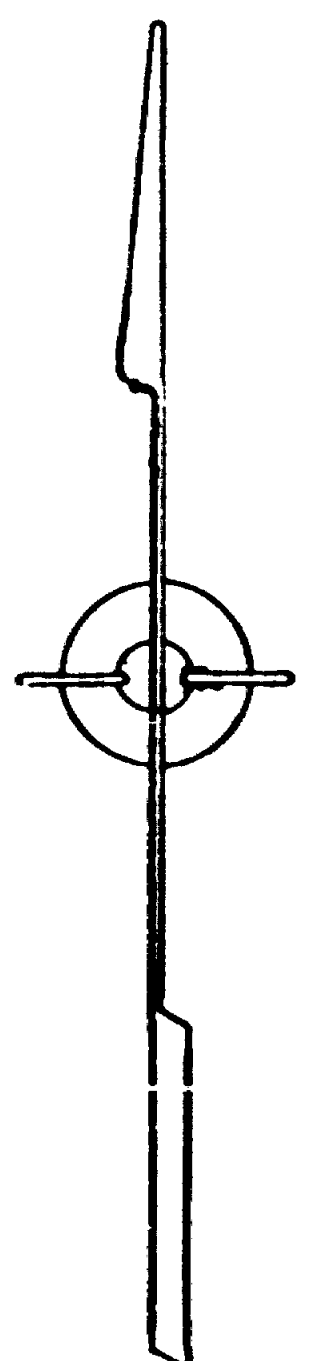

62-24

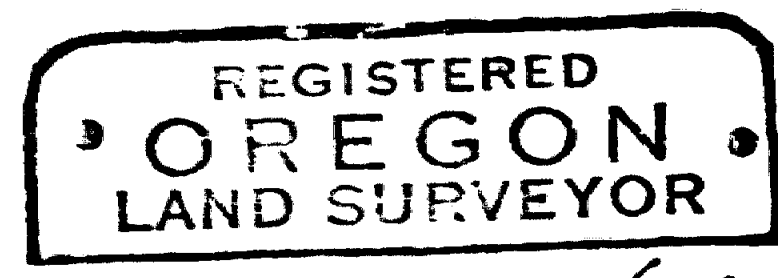

Edward A. McGinty
 JULY 10, 1962
 EDWARD A. MCGINTY
 301

21 22
 28 27

1956

Survey No. _____

Survey Narrative to comply with O.R.S. 209-250.

Survey for: CAL-ORE RANCHES

Survey by: Edward A. McGinty, L.S. 7/10/62

BASES OF BEARING: Solar observation.

PRECEDENCE OF SURVEY:

To determine the Northeast and Southeast corners of approximate 5 acre tracts along the east line of Section 21 as shown; all of the corners along the west line are only approximate and in no way should be construed as true corners. The client requested this type of survey in order to save cost of subdividing a section and is aware of the conditions or changes which could result in a legal subdivision of a section.

At the Southeast corner of Section 21 was found a brass cap monument. At the East quarter corner of Section 21 was found a double blazed cedar tree in the Northwest quadrant with a portion of the scribe being barely visible. Said tree now being a 22 inch cedar bears North 24° West, 8.6 feet. A black oak 12 inches in diameter bears North 73½° East, 24.4 feet to the blaze.

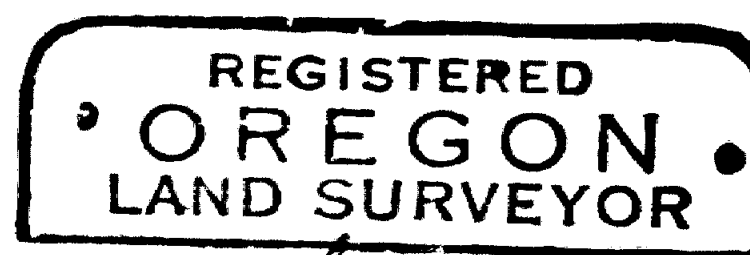
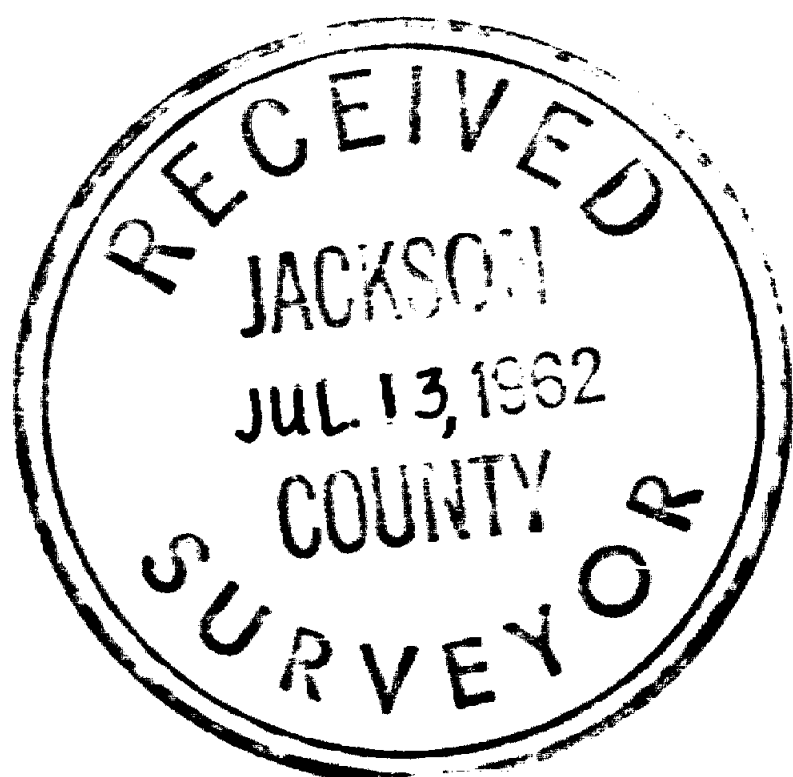

Edward A. McGinty

