

MAP OF SURVEY

LOCATED IN
THE WEST HALF OF
THE NORTHWEST QUARTER OF SECTION 36,
TOWNSHIP 34 SOUTH, RANGE 1 EAST,
WILLAMETTE MERIDIAN,
JACKSON COUNTY, OREGON

FOR
GEORGE D. & TAMMY Y. HEPPNER
2200 RILEY ROAD
EAGLE POINT, OREGON 97524

BY
SMITH SURVEYING
LLOYD R. "BUTCH" SMITH
7050 HIGHWAY 140
EAGLE POINT, OREGON 97524
(541) 826-2509
SEPTEMBER 15, 2006

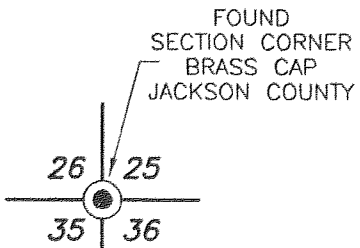
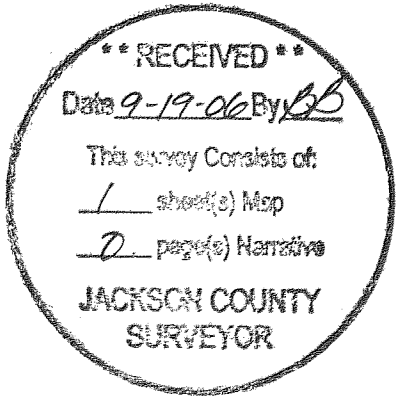

LEGEND

- FOUND 3/4" PIN PER F.S. 1409.
- ◆ FOUND 5/8" PIN (BENT) PER F.S. 1409.
- SET 5/8"x24" REBAR W/PLASTIC CAP STAMPED "LS 2011".
- F.S. FILED SURVEY WITH JACKSON COUNTY SURVEYOR'S OFFICE.
- O.R. OFFICIAL RECORDS OF JACKSON COUNTY, OREGON.
- [...] RECORD DATA PER F.S. 1409.
- (...) RECORD DATA PER F.S. 7497.
- x- EXISTING BARBED WIRE FENCE.

NARRATIVE

PURPOSE: SET DEED CORNERS AS REQUESTED BY CLIENT.

PROCEDURE: FOUND CORNERS SET IN FILED SURVEY 7497 AND HELD THESE CORNERS FOR CONTROL OF WESTERLY BOUNDARY. SET WITNESS MONUMENTS AT TOE OF BUTTE FALLS ROAD EMBANKMENT AS SHOWN. FILED SURVEY 1409 CORNERS WERE FOUND ON SOUTHERLY BOUNDARY AS SHOWN.

(BASIS OF BEARINGS PER F.S. 7497)
S 00°03'42" W 2656.30'

BUTTE FALLS ROAD
N 67°49' W 612.80'[618.2']

WITNESS MONUMENTS

FOUND
2" IRON PIPE
W/BRASS TAG
STAMPED "838"
PER F.S. 1409

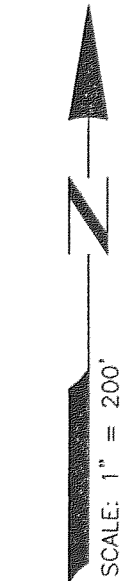

PARCEL 3
F.S. 7497

REGISTERED
PROFESSIONAL
LAND SURVEYOR

Lloyd R. Smith

OREGON
JULY 16, 1982
LLOYD R. SMITH
No. 2011

Exp 6/30/08

O.R. 73-00510

