

SURVEY IN DLC 81, T38S, R.1W, WM.

FOR
LESTER GARR

59 - 29

BY EDWARD MCGINTY
MEDFORD, OREGON
DECEMBER, 1961

SCALE 1" = 100'
● = 5/8" I. PIN
● = 1/2" I. PIN

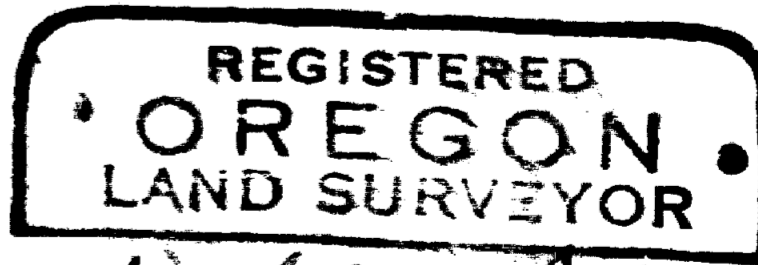

Edward A. McGinty

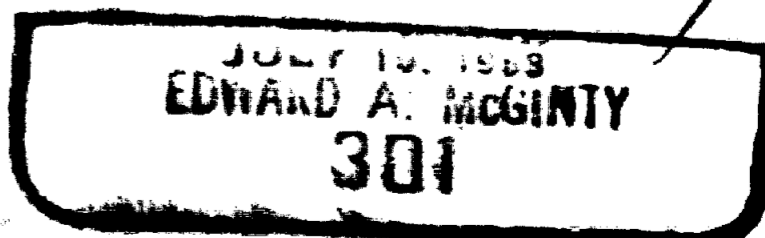

Survey No. 1927

Survey Narrative to comply with O.R.S. 209-205 and O.R.S. 209-120.

Survey for: Lester Carr

Survey by: Edward A. McGinty, L.S.
1/12/62

BASIS OF BEARING: Survey No. 988.

PRECEDENCE OF SURVEY:

The purpose of this survey was to segregate a parcel of land, as shown, being a portion of Deed Record Vol. 285 page 625.

The easterly line of deed was determined previously as the DLC line.

The westerly line is parallel to the DLC line and 828.3 ft. west.

The southerly line was determined from the existing County road, using improvements and fence line and pavement.

An attempt was made to find the monument of a 1909 survey which controls the center line of Fern Valley Road, without success. Discussed procedure with the County Engineer.

