

BOUNDARY SURVEY OF PROPERTY
 SITUATE IN
 DLC. 44, SEC. 31, T37S., R1W., W.M.
 JACKSON COUNTY, OREGON
 FOR
 JAMES T. POOL
 L.P. LOVEJOY, L.S. MEDFORD, ORE.
 SCALE 1" = 40' APRIL 19, 1962

REGISTERED
OREGON
 LAND SURVEYOR
Leland P. Lovejoy
 NOVEMBER 10, 1949
 LELAND P. LOVEJOY
 262

BEARINGS BY PREVIOUS SURVEY
 ○ = SET 5/8" STEEL PIN

Survey No. 1921

SURVEY NARRATIVE TO COMPLY WITH SECTION 87-330

1947 OREGON STATE LAWS

SURVEY FOR: James Pool
1256 South Riverside Avenue
Medford, Oregon

PURPOSE OF SURVEY: To establish property boundaries.

SURVEY LOCATION: D.L.C. No. 44, Section 31, Township 37
South, Range 1 West, Willamette Meridian,
Jackson County, Oregon

SURVEY PROCEDURE: Found corners Recorded Survey #1846, other
survey points and D.L.C. corners as shown
on map and used same as basis for survey
control. Set 5/8" steel pins as shown.

Leland P. Lovejoy
Registered Land Surveyor
Work completed April 19, 1962

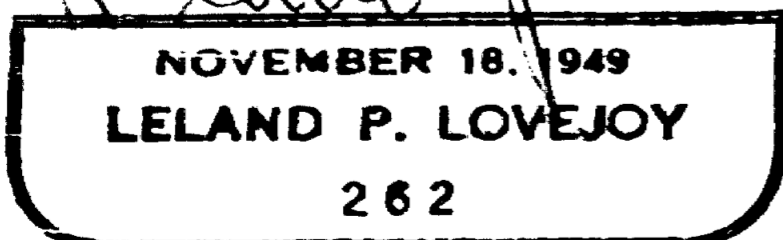
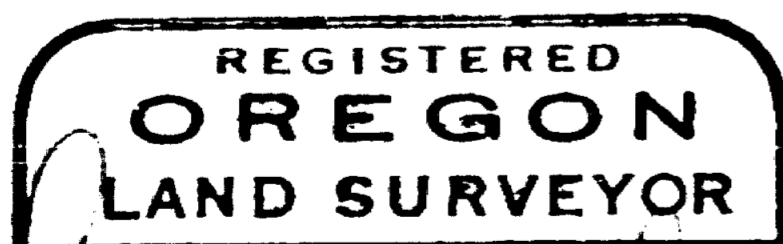
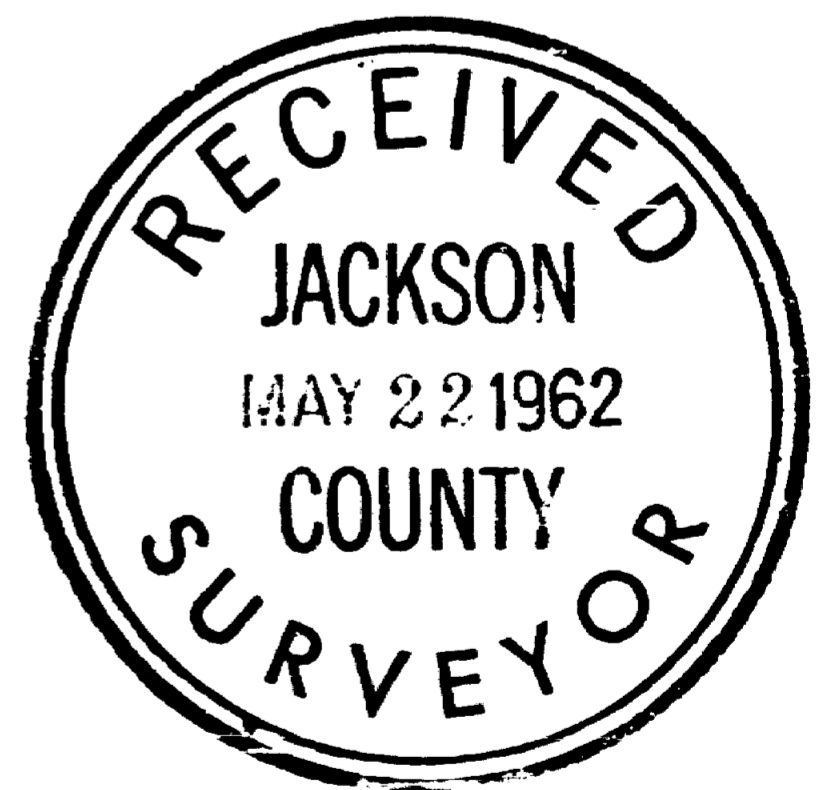

Leland P. Lovejoy