

SURVEY FOR:
GARY SHONTZ
4766 ROGUE RIVER HIGHWAY
GOLD HILL, OR 97525

SURVEY BY:
L.J. FRIAR & ASSOCIATES, P.C.
CONSULTING LAND SURVEYORS
816 WEST EIGHTH STREET
MEDFORD, OREGON 97501
PHONE: (541) 772-2782
EMAIL: ljfriar@charter.net

MAP OF SURVEY

Located in the N.W. 1/4 of Section 27,
T.36S, R.4W., W.M. Jackson County, Oregon

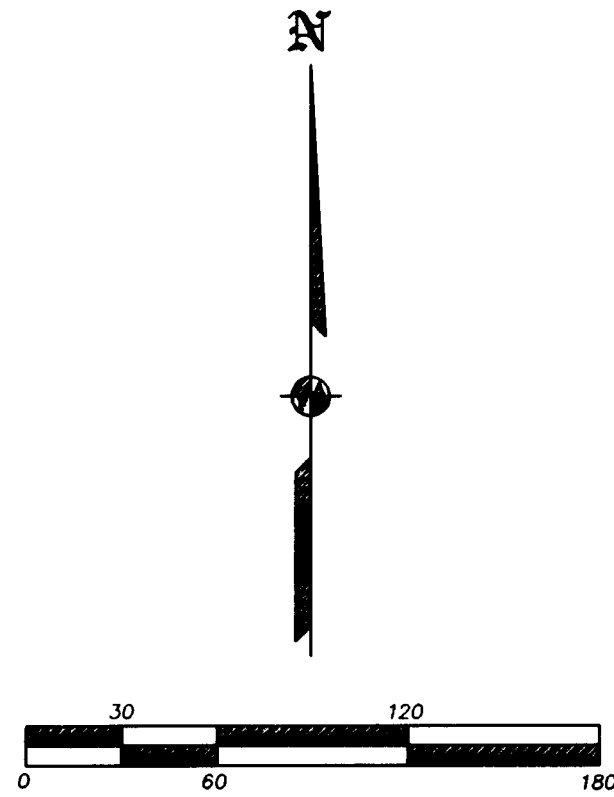
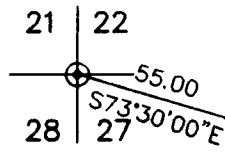

LEGEND:

- ⊙ = FD. COUNTY SURVEYOR'S BRASS CAPPED MONUMENT. NOT TIED THIS SURVEY.
- = FD. 5/8" IRON PIN PER FS3512.
- = SET 5/8" X 30" IRON PIN W/ PLASTIC CAP MKD. L.J. FRIAR & ASSOC.
- ⊗ = SET BRASS TAG MKD. L.J. FRIAR & ASSOC. IN LEAD PLUG IN CONCRETE.

- IEE = PROPOSED INGRESS-EGRESS EASEMENT FOR TRACT DESCRIBED IN DOC. 96-13762, ORJCO.
- ORJCO = OFFICIAL RECORDS OF JACKSON COUNTY, OREGON.
- WC = WITNESS CORNER.
- () = RECORD DATA AS SHOWN.
- DR = DEED RECORD DATA.
- FS = FILED SURVEY #.
- X- = FENCE LINE.
- AC = ASPHALT DRIVEWAY.

BASIS OF BEARINGS:

SURVEY NO. 3512 AS SHOWN HEREON.

UNIT OF MEASUREMENT = FEET DATE: APRIL 25, 2006 SCALE: 1" = 60'

SURVEY NARRATIVE TO COMPLY WITH O.R.S. 209.250

PURPOSE: TO SURVEY AND MONUMENT CERTAIN CORNERS OF THAT TRACT DESCRIBED IN DOC. 2005-047141, ORJCO AND LOCATE IMPROVEMENTS IN ORDER TO PREPARE A LEGAL DESCRIPTION FOR AN INGRESS-EGRESS EASEMENT.

PROCEDURE: MADE TIES TO MONUMENTS OF RECORD AS SHOWN HEREON TO CONTROL THE R/W OF ROGUE RIVER HIGHWAY. COMPUTED THE POSITION OF THE SECTION CORNER FROM WHICH MANY OF THE LEGALS IN THIS AREA ARE BASED UPON. FROM THIS SECTION CORNER POSITION, I USED DEED RECORD DATA PER DOC. 2005-047141, ORJCO TO COMPUTE THE EXTERIOR OF THE SUBJECT PROPERTY AND SET THE MONUMENTS AT THE LOCATIONS SHOWN HEREON. TIES WERE THEN MADE TO THE IMPROVEMENTS AS SHOWN AND A LEGAL DESCRIPTION WAS PREPARED FOR THE INGRESS-EGRESS EASEMENT.

REGISTERED
PROFESSIONAL
LAND SURVEYOR

James E. Hibbs
OREGON
JULY 17, 1986
JAMES E. HIBBS
2234
RENEWAL DATE 6-30-07

*** RECEIVED ***
DATE 5-12-06 BY AB
This survey consists of:
1 sheet(s) Map
0 page(s) Narrative
JACKSON COUNTY
SURVEYOR