

PARTITION PLAT No. P-72-2005

SURVEY FOR:

WILLIAM E. ANEY
LAURA J. ANEY
LONNIE E. ANEY
14465 AVALON ROAD
WHITE CITY, OREGON 97503

DATE: SEPTEMBER 1, 2005

of
A PORTION OF LOT 2, BLOCK 15, AGATE SUBDIVISION EXTENSION NO. 3
located in the
NORTHEAST 1/4 OF SECTION 21, TOWNSHIP 36 SOUTH, RANGE 1 WEST,
WILLAMETTE MERIDIAN, JACKSON COUNTY, OREGON

SURVEY BY:

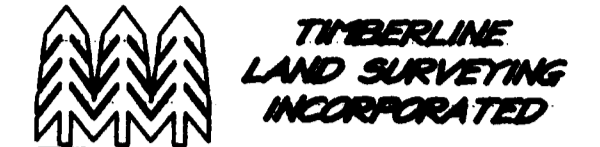

KERRY K. BRADSHAW L.S. 2271
P.O. BOX 3064
CENTRAL POINT, OREGON 97502
(541)664-7510 CELL: 944-6692

DECLARATION

KNOW ALL MEN BY THESE PRESENTS THAT WILLIAM E. ANEY AND LAURA J. ANEY, HUSBAND AND WIFE, AND LONNIE E. ANEY ARE THE OWNERS, NOT AS TENANTS IN COMMON, BUT WITH THE RIGHT OF SURVIVORSHIP, OF THE LANDS REPRESENTED ON THIS PARTITION PLAT AND MORE PARTICULARLY DESCRIBED IN THE SURVEYOR'S CERTIFICATE AND HAVE CAUSED THE SAME TO BE PARTITIONED INTO PARCELS, AS SHOWN HEREON, AND DO HEREBY CREATE THE 14-FOOT WIDE SHARED ACCESS EASEMENT ACROSS PARCEL 1 FOR THE BENEFIT OF PARCELS 1 AND 2, AS SHOWN HEREON.

William Aney Laura J. Aney Lonnie E. Aney
WILLIAM E. ANEY LAURA J. ANEY LONNIE E. ANEY

STATE OF OREGON)
) SS
COUNTY OF JACKSON)

THE FOREGOING INSTRUMENT WAS ACKNOWLEDGED BEFORE ME THIS 6th DAY OF October, 2005, BY WILLIAM E. ANEY AND ACKNOWLEDGED THIS TO BE HIS VOLUNTARY ACT AND DEED.

W. Michael Perry
NOTARY PUBLIC



STATE OF OREGON)
) SS
COUNTY OF JACKSON)

THE FOREGOING INSTRUMENT WAS ACKNOWLEDGED BEFORE ME THIS 6th DAY OF October, 2005, BY LAURA J. ANEY AND ACKNOWLEDGED THIS TO BE HER VOLUNTARY ACT AND DEED.

W. Michael Perry
NOTARY PUBLIC

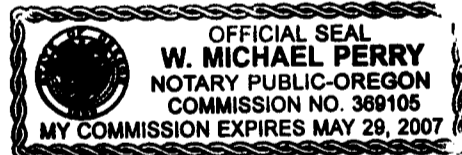

STATE OF OREGON)
) SS
COUNTY OF JACKSON)

THE FOREGOING INSTRUMENT WAS ACKNOWLEDGED BEFORE ME THIS 6th DAY OF October, 2005, BY LONNIE E. ANEY AND ACKNOWLEDGED THIS TO BE HIS VOLUNTARY ACT AND DEED.

W. Michael Perry
NOTARY PUBLIC

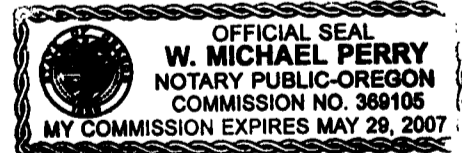

TAX STATEMENT

ALL FEES, TAXES, ASSESSMENTS OR OTHER CHARGES AS REQUIRED BY O.R.S. 92.095 HAVE BEEN PAID AS OF 10/06, 2005.

James Clark, Deputy 10/6/05
TAX COLLECTOR DATE

Amanda Kirkpatrick, Deputy 10/6/05
ASSESSOR DATE

SURVEYOR'S CERTIFICATE

I, KERRY K. BRADSHAW, A DULY REGISTERED SURVEYOR IN THE STATE OF OREGON, DO HEREBY CERTIFY THAT THIS PLAT CORRECTLY REPRESENTS A SURVEY MADE BY ME AND COMPLIES WITH THE REGULATIONS FOR LAND PARTITIONS AND THE FOLLOWING IS AN ACCURATE DESCRIPTION OF THE PARENT TRACT AS SET FORTH HEREON.

THE WEST 84.0 FEET OF LOT TWO (2) IN BLOCK FIFTEEN (15), AGATE SUBDIVISION EXTENSION NO. 3 IN JACKSON COUNTY, OREGON, ACCORDING TO THE OFFICIAL PLAT THEREOF, NOW OF RECORD.

Kerry K. Bradshaw
KERRY K. BRADSHAW, PLS 2271

RECORDING STATEMENT

FILED FOR RECORD THIS 06th DAY OF October, 2005 AT 2:21 O'CLOCK P M. AND RECORDED AS

PARTITION PLAT No. P-72-2005 OF THE "RECORDS OF PARTITION PLATS" IN JACKSON COUNTY, OREGON.

INDEX VOLUME 16, PAGE 72

FILED IN THE OFFICE OF THE JACKSON COUNTY SURVEYOR AS SURVEY No. 18919

NARRATIVE

PURPOSE:

TO PARTITION THE PARCEL OF LAND DESCRIBED IN INSTRUMENT No. 95-35009 AS DIRECTED BY THE CLIENT AND AS APPROVED BY THE JACKSON COUNTY PLANNING DEPARTMENT (FILE No. SUB2005-00010_MP).

PROCEDURE:

FOUND MONUMENTS FROM AGATE SUBDIVISION EXTENSION No. 2, AGATE SUBDIVISION EXTENSION No. 3 AND FILED SURVEY No.'s 16952, 18036 AND 18654 WERE TIED IN A CONTROL SURVEY USING A WILD T-1000 TOTAL STATION. I HELD THE POSITIONS OF THE FOUND MONUMENTS FROM SAID EXTENSION No.'s 2 AND 3, COMPUTED THE BOUNDARY OF THE CLIENT'S PARENT TRACT AND MONUMENTED THE PARCELS AS SHOWN HEREON.

APPROVALS

Thomas Bigner 10/5/05
JACKSON COUNTY PLANNING DEPARTMENT (FILE No. SUB2005-00010_MP) DATE

EXAMINED AND APPROVED THIS 22nd DAY OF September, 2005.

Robert Roberts
JACKSON COUNTY SURVEYOR

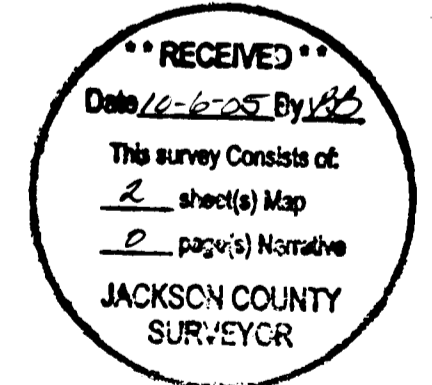

Kerry K. Bradshaw
OREGON
JULY 16, 1987
KERRY K. BRADSHAW
2271

EXP. 12-31-05

PARTITION PLAT No. P-72-2005

of
A PORTION OF LOT 2, BLOCK 15, AGATE SUBDIVISION EXTENSION NO. 3
located in the
NORTHEAST 1/4 OF SECTION 21, TOWNSHIP 36 SOUTH, RANGE 1 WEST,
WILLAMETTE MERIDIAN, JACKSON COUNTY, OREGON

SURVEY BY:

KERRY K. BRADSHAW L.S. 2271
P.O. BOX 3064
CENTRAL POINT, OREGON 97502
(541)664-7510 CELL: 944-6692

SURVEY FOR:
WILLIAM E. ANEY
LAURA J. ANEY
LONNIE E. ANEY
14465 AVALON ROAD
WHITE CITY, OREGON 97503
DATE: SEPTEMBER 1, 2006

BASIS OF BEARINGS

THE MONUMENTED NORTH RIGHT-OF-WAY OF AVENUE "A" SHOWN AS S89°55'50"W ON THE PLAT OF AGATE SUBDIVISION EXTENSION NO. 2 AND AGATE SUBDIVISION EXTENSION NO. 3.

- - FOUND 5/8" IRON PIN AS NOTED
 - - FOUND 5/8" IRON PIN WITH ALUMINUM CAP PER FS 18036
 - ⊕ - FOUND 5/8" IRON PIN PER FS 18654
 - ⊙ - FOUND BRASS CAP AT CENTERLINE INTERSECTION
 - ⊗ - FOUND 5/8" IRON PIN PER FS 16952
 - - SET 5/8" IRON PIN WITH YELLOW PLASTIC CAP STAMPED "BRADSHAW, LS 2271"
- FS - FILED SURVEY IN THE OFFICE OF THE JACKSON COUNTY SURVEYOR
WM - WITNESS MONUMENT

RECEIVED
Date 10-6-05 By JKD
This survey consists of:
2 sheet(s) Map
0 page(s) Narrative
JACKSON COUNTY
SURVEYOR

REGISTERED
PROFESSIONAL
LAND SURVEYOR

Kerry K. Bradshaw
OREGON
JULY 16, 1987
KERRY K. BRADSHAW
2271
EXP. 12-31-06



SCALE: 1" = 50'

Kerry K. Bradshaw
I CERTIFY THIS TO BE AN EXACT
COPY OF THE ORIGINAL PLAT.

