

PREPARED FOR:
 JOSEPH & FRANCISCA
 PEDROJETTI
 626 7TH FAIRWAY DRIVE
 MEDFORD, OREGON 97504

MAP OF SURVEY PROPERTY LINE ADJUSTMENT

Located within Lots 9, and 10 of FAIRWAYS EDGE, a Planned Community, in the Southeast One-quarter of Section 28, Township 37 South, Range 1 West, of the Willamette Meridian, City of Medford, Jackson County, Oregon.

NARRATIVE TO COMPLY WITH O.R.S. 209.250

Purpose: Pursuant to Clients Instructions, perform a field survey, prepare and process a Property Line Adjustment application with the City of Medford Planning Department, monument the resultant boundary corners and file a Map of Survey with Jackson County, Oregon.

Procedure: Utilizing a Nikon DTM-520 Total Station and a Ranger 200-R Data Collector with TDS software, all found monuments, as depicted hereon, were tied in a closed loop traverse or with redundant ties.

Based on said traverse and ties, FAIRWAYS EDGE, a planned community, as recorded in Volume 22 of Plats at Page 29 of Records of Jackson County, Oregon, and filed as Survey Number 15507 in the office of the Jackson County Surveyor, of Jackson County Oregon, Documents Numbered 05-31506 and 05-31507 of the Official Records of Jackson County, Oregon, and the Property Line Adjustment approved by the City of Medford Planning Department, the resultant boundaries were monumented as depicted hereon.

LEGEND

- Indicates a set 5/8-inch diameter Iron pin, 24 inches in length, with a yellow plastic cap marked "NEATHAMER LS 2675", top set flush with the surface.
- ⊠ Indicates a set 38-caliber shell casing with brass tag marked "NEATHAMER LS 2675" top set at or just below the surface.
- Indicates a found 5/8-inch diameter Iron pin with a red plastic cap marked "D. MINNECI LS 2349", per SN 15507.
- ▲ Indicates a found lead plug with a tack and washer marked "LS 2349", per SN 15507.
- Indicates a computed position, nothing found or set.
- SN Indicates a survey filed number in the office of the Jackson County Surveyor.
- Doc. No. Indicates a document number pursuant to the Official Records of Jackson County, Oregon.
- () Indicates Record information, per FAIRWAYS EDGE, a planned community, as recorded in Volume 22 of Plats at Page 29 of the records of Jackson County, Oregon and filed as Survey Number 15507 in the office of the Jackson County Surveyor.

CURVE TABLE

CURVE #	DELTA	RADIUS	ARC	CHORD BEARING	CHORD
C1	73°02'18"	61.50'	78.40'	S82°58'52"E	73.20'
C2	21°57'47"	61.50'	23.57'	S57°26'34"E	23.43'
C3	14°07'01"	61.50'	15.15'	S53°31'14"E	15.11'
C4	07°30'40"	61.50'	8.42'	S64°30'04"E	8.41'
C5	51°04'37"	61.50'	54.82'	N86°02'17"E	53.02'
C6	42°50'00"	75.00'	56.07'	S21°16'00"E	54.77'
C7	23°35'44"	250.50'	103.16'	S11°38'52"E	102.43'

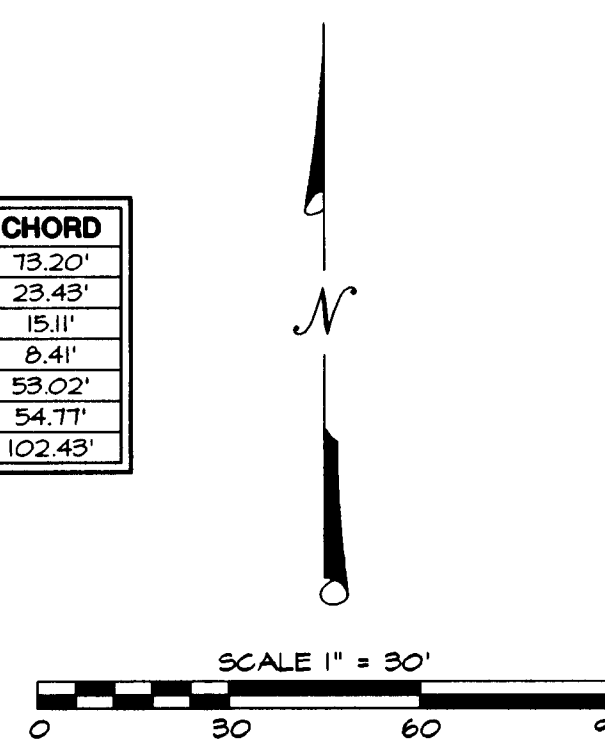

RECEIVED
 DATE 7-1-05 BY [Signature]
 This survey consists of:
 1 sheet(s) Map
 2 page(s) Narrative
 JACKSON COUNTY SURVEYOR

REGISTERED PROFESSIONAL LAND SURVEYOR

[Signature]

OREGON
 JULY 19, 1994
 ROBERT V. NEATHAMER
 2675

Renewal Date 12/31/06

BASIS OF BEARINGS:
 FAIRWAYS EDGE as recorded in Volume 22 of Plats at Page 29 of Records of Jackson County, Oregon, and filed as Survey Number 15507 in the office of the Jackson County Surveyor bearings applied to the Centerline of Calle Vista Drive as depicted hereon.

PREPARED BY: Neathamer Surveying, Inc.
 3126 State Street, Suite 200
 P.O. Box 1584
 Medford, Oregon 97501-0120
 Phone (541) 732-2869
 FAX (541) 732-1382

PROJECT NUMBER: 04071 DATE: June 30, 2005
 Sheet 1 of 1 © LTM

