

SURVEY NO. 18718

SURVEY NARRATIVE TO COMPLY WITH O.R.S. 92.250

SURVEY FOR:

Mike and Bobby Rainey
4865 Highway 238
White City, Oregon 97503

SURVEY BY:

Timberline Land Surveying, Inc.
P.O. Box 3064
Central Point, Oregon 97502

LOCATION:

Northeast 1/4 of Section 26, Township 35 South, Range 2 West,
Willamette Meridain, Jackson County, Oregon.

PURPOSE:

To survey and monument the adjusted property line as instructed by the client and per direction of the Jackson County Planning Department.

PROCEDURE:

The subject property had been previously surveyed by this office and a map filed (Survey No. 17578). Using a Wild T-1000 total station, control from said survey was utilized to monument the adjusted property line and a map was prepared and filed with the Jackson County Surveyor's Office.

BASIS OF BEARING:

The east line of Section 26 shown as S00°05'22"E, on filed survey No. 17578 and 5442.

DATE:

March 23, 2005

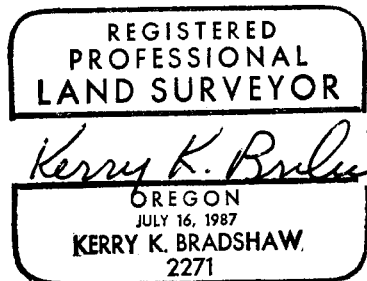
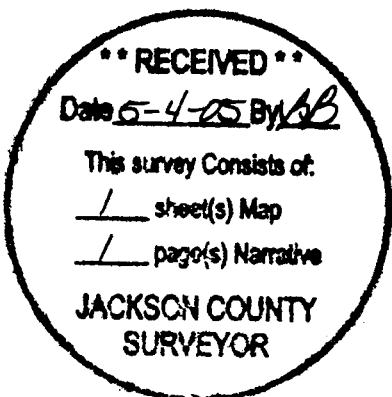

MAP OF SURVEY

PROPERTY LINE ADJUSTMENT

LOCATED IN THE NORTHEAST 1/4 OF SECTION 26, TOWNSHIP 35 SOUTH,
RANGE 2 WEST, WILLAMETTE MERIDIAN, JACKSON COUNTY, OREGON

MARCH 23, 2005

SURVEY FOR:

MIKE AND BOBBY RAINEY
4865 HIGHWAY 234
WHITE CITY, OREGON 97503



SCALE = 100'

- FOUND 5/8" REBAR WITH YELLOW PLASTIC CAP STAMPED "BRADSHAW LS 2271" PER FS 139877
 - ⊕ FOUND BRASS CAP MONUMENT AS NOTED
 - ⊗ SET 5/8" X 24" REBAR WITH YELLOW PLASTIC CAP STAMPED "BRADSHAW LS 2271"
 - ⊗ FOUND REBAR WITH ALUMINUM CAP STAMPED "SWAIN SURVEYING, RLS 759"
- FS = FILED SURVEY WITH JACKSON COUNTY SURVEYOR'S OFFICE
() DEED REDORD PER 96-18951
ORJCO = OFFICIAL RECORDS OF JACKSON COUNTY, OREGON
BASIS OF BEARING: East line of Section 26 shown as N00°05'22"W per FS 5442.

SURVEY BY:



KERRY K. BRADSHAW L.S. 2271
P.O. BOX 3064
CENTRAL POINT OREGON 97502
(541)664-7510 CELL 944-6692

