

#1870

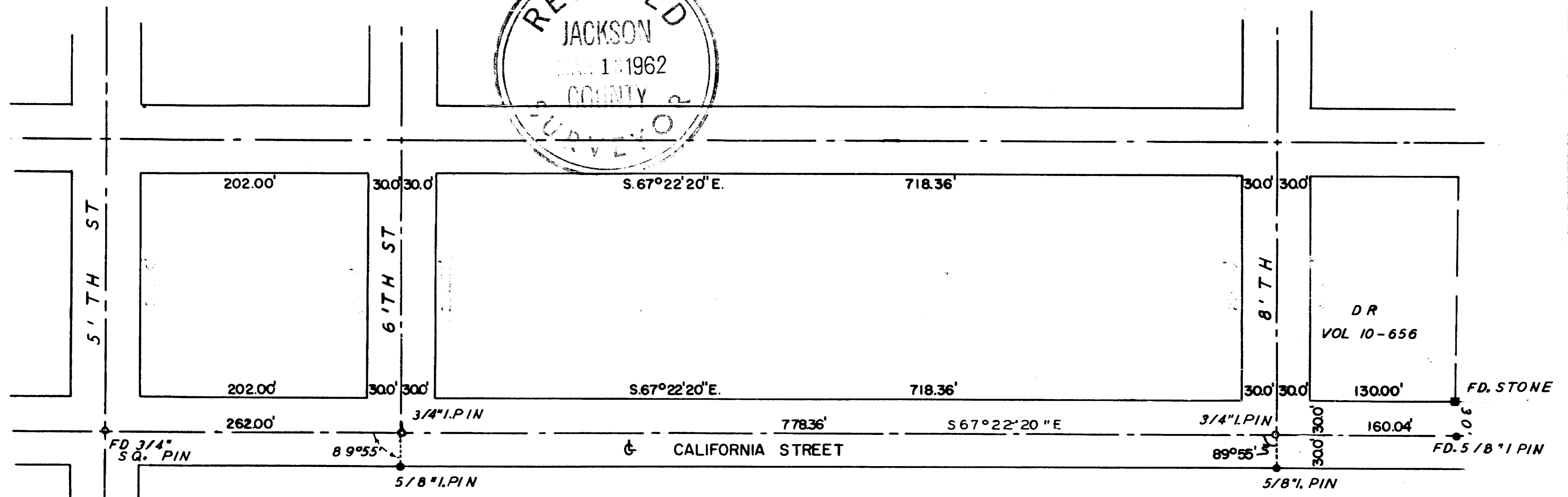
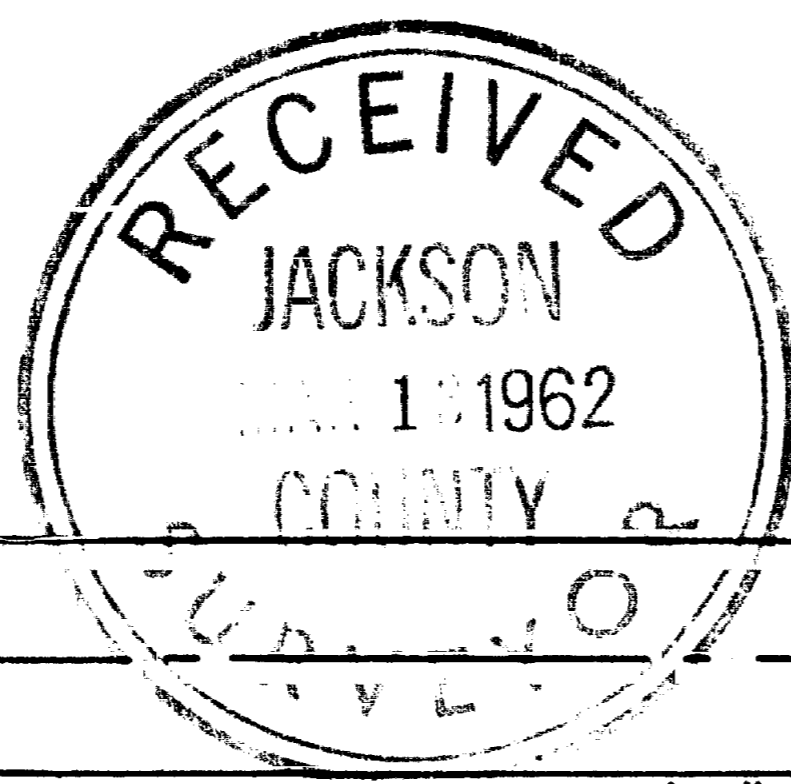

SURVEY IN CITY OF JACKSONVILLE FOR CITY OF JACKSONVILLE

J-2

BY EDWARD MC GINTY MED FORD, OREGON

SCALE 1" = 100' FEBRUARY, 1962

REGISTERED OREGON LAND SURVEYOR

Edward A. McGinty

JULY 10, 1953 EDWARD A. MCGINTY 301

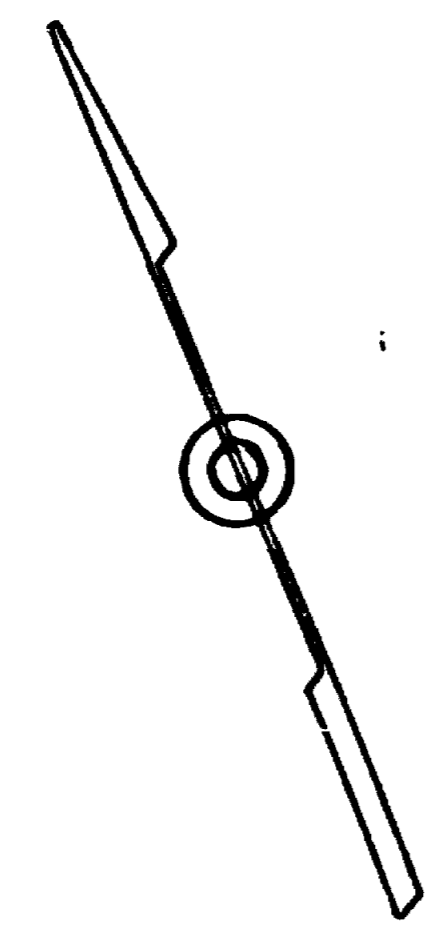

#1870

1870

Survey No. 1870

Survey Narrative to comply with O.R.S. 209-205 and O.R.S. 209-120.

Survey for: City of Jacksonville

Survey by: Edward A. McGinty, L.S.
3/1/62

BASIS OF BEARING: Survey No. 1776.

PRECEDENCE OF SURVEY:

Set center line monuments at the intersection of 6th St. & Calif. St. and 8th St. & Calif. St., at request of the City of Jacksonville

Center line of California St. was determined from iron pin found at 5th St. and California St. and a stone on the northerly line of California St, 130 feet easterly from the east line of 8th St. which is of deed record in Vol. 10 page 656.

J-2

