

# PARTITION PLAT NO. P-11-2005

(FILE NO. SUB 2004-00004)

Located in:  
**LOT 5, BLOCK 11, AGATE SUBDIVISION EXTENSION NO.2  
IN THE N.E. 1/4 OF SECTION 21, T.36S, R.1W, W.M.  
JACKSON COUNTY, OREGON**

FOR:

**DANNY R. KRUSE  
3725 AVENUE "A"  
WHITE CITY, OREGON 97503**

### SURVEYOR'S CERTIFICATE:

I, MATTHEW W. WASSON, A DULY REGISTERED SURVEYOR OF THE STATE OF OREGON, DO HEREBY CERTIFY THAT THIS MAP CORRECTLY REPRESENTS A SURVEY MADE BY ME OR UNDER MY DIRECTION AND COMPLIES WITH THE REGULATIONS FOR LAND PARTITIONS. THE FOLLOWING IS AN ACCURATE DESCRIPTION OF THE PARENT TRACT:

THE WEST 192.0 FEET OF LOT 5, BLOCK 11, AGATE SUBDIVISION - EXTENSION NO. 2, IN JACKSON COUNTY, OREGON.

*Matthew Wasson*  
Surveyor

### APPROVALS:

#### JACKSON COUNTY PLANNING DEPARTMENT:

*Thomas Reigan* 3/8/05  
Planner Date

Examined and approved this 15<sup>th</sup> day of March, 2005.

*James R. Shultz*  
County Surveyor

FILED IN THE OFFICE OF THE JACKSON COUNTY SURVEYOR AS NO. 18654

All taxes, fees, assessments or other charges as required by O.R.S. 92.095 have been paid. As of MARCH 11<sup>th</sup>, 2005.

*James Clark* DEPUTY  
Assessor Date 3/11/05  
Tax Collector Date 3/11/05

### SURVEY NARRATIVE TO COMPLY WITH PARAGRAPH 209.250 OREGON REVISED STATUTES

**PURPOSE:** TO PREPARE FINAL PLAT OF A 2-LOT PARTITION PER JACKSON COUNTY PLANNING FILE NO. SUB-2004-00004 AND PER THE CLIENT'S REQUEST.

**PROCEDURE:** UTILIZING FOUND MONUMENTATION AND INFORMATION PER FILED SURVEY NO. 7579 AND PLAT OF AGATE SUBDIVISION EXTENSION NO. 2, FOR CONTROL, I ESTABLISHED PROPER MONUMENTS AS SHOWN HEREON. INSTRUMENT NO. 99-30669 OF THE DEED RECORDS OF JACKSON COUNTY WAS USED TO DETERMINE CLIENTS PROPERTY. AN ELECTRONIC TOTAL STATION WAS USED TO MAKE ALL MEASUREMENTS.

### DECLARATION:

KNOW ALL MEN BY THESE PRESENTS, THAT DANNY R. KRUSE AND CATHERINE L. KRUSE ARE THE OWNERS IN FEE SIMPLE OF THE REAL PROPERTY REPRESENTED ON THIS PARTITION PLAT AND MORE PARTICULARLY DESCRIBED IN THE SURVEYOR'S CERTIFICATE, AND HAVE CAUSED THE SAME TO BE PARTITIONED INTO PARCELS AS SHOWN HEREON.

IN WITNESS WHEREOF, SIGNED THIS 24<sup>th</sup> DAY OF Feb, 2005.

*Danny R. Kruse*  
DANNY R. KRUSE

STATE OF Oregon  
COUNTY OF Jackson ss.

PERSONALLY APPEARED THE ABOVE NAMED DANNY R. KRUSE AND, ACKNOWLEDGED THE FOREGOING INSTRUMENT TO BE HIS VOLUNTARY ACT AND DEED BEFORE ME THIS 24<sup>th</sup> DAY OF Feb, 2005.

*Donna O'Grady*  
NOTARY



IN WITNESS WHEREOF, SIGNED THIS 24<sup>th</sup> DAY OF Feb, 2005.

*Catherine L. Kruse*  
CATHERINE L. KRUSE

STATE OF Oregon  
COUNTY OF Jackson ss.

PERSONALLY APPEARED THE ABOVE NAMED CATHERINE L. KRUSE, AND ACKNOWLEDGED THE FOREGOING INSTRUMENT TO BE HIS VOLUNTARY ACT AND DEED BEFORE ME THIS 24<sup>th</sup> DAY OF Feb, 2005.

*Donna O'Grady*  
NOTARY



### RECORDER'S CERTIFICATE:

FILED FOR RECORD THIS 11<sup>th</sup> DAY OF MARCH, 2005, AT 11:16 O'CLOCK, A.M. AND RECORDED AS PARTITION PLAT NO. P-11-2005 OF "RECORD OF PARTITION PLATS" IN JACKSON COUNTY, OREGON (INDEX VOLUME 16 PAGE 11).

*Kathleen S. Beckett*  
COUNTY CLERK

*Barbara J. Shaw*  
DEPUTY

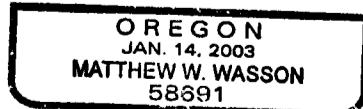
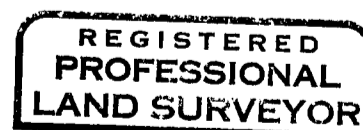
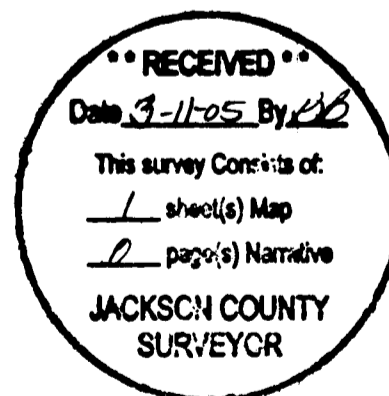

RENEWS 6/30/06

I certify this plat to be an exact photocopy of the original.  
*Matthew Wasson*  
SURVEYOR

**HOFFBUHR & ASSOCIATES, INC.**  
880 GOLF VIEW DRIVE, SUITE 201 MEDFORD, OREGON  
(541) 779-4641  
SCALE: 1" = 50'  
BASIS OF BEARING: FEBRUARY 15, 2005  
FILED SURVEY NO. 7579

- S/N = FILED SURVEY NUMBER
- = SET 5/8"X24" REBAR WITH YELLOW PLASTIC CAP STAMPED "HOFFBUHR AND ASSOC., INC."
- = FOUND 5/8" IRON PIN PER S/N 7579 (OR AS NOTED)

