

Survey No. 1836

Survey Narrative to comply with O.R.S. 209-120 and O.R.S. 209-205.

Survey for: Oak Street Associates, Inc.

Survey by: Edward A. McGinty, L.S.
11/20/61

BASIS OF BEARING: Valley Center Sub-division.

PRECEDENCE OF SURVEY:

The southerly line of tract was determined from the projection of the south line of Valley Center Sub-div.

The easterly line of the Highway was determined from highway right of way monuments found, as shown.

The northerly line of tract was determined from the projection of the north line of Lot 9.

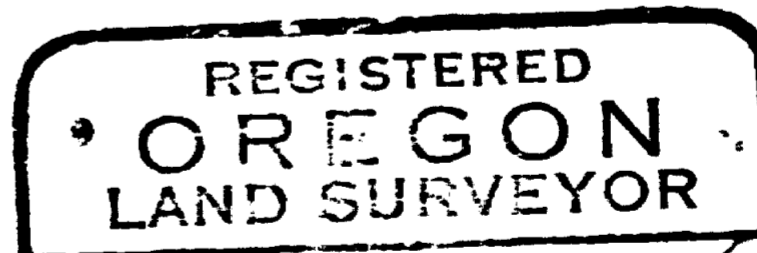
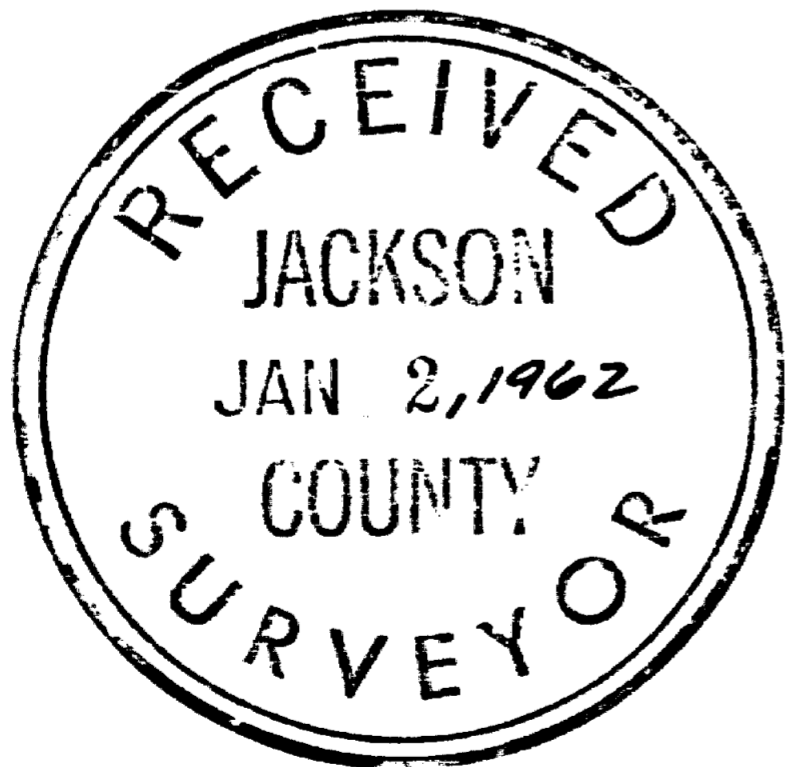

Edward A. McGinty

