

SURVEY NO 18303

**SURVEY NARRATIVE TO COMPLY WITH PARAGRAPH 209.250
OREGON REVISED STATUTES**

*Vol. 30 Pg. 37
Book 15 pg. 91
13R/49*

Survey for: Steven and Cathy Heady
P.O. Box 2397
White City, Oregon 97503

Location: The Northeast one-quarter (1/4) of Section 17, Township 36 South,
Range 1 West, Willamette Meridian, Jackson County, Oregon.

Purpose: To survey, monument and record a Subdivision Plat for DUTTON
ROAD INDUSTRIAL PARK.

Procedure: Utilizing found monuments and control from previous surveys done
by this Office, I set monuments as shown on the accompanying
Subdivision Plat.

Basis of
Bearing: The South line of West Dutton Road per Survey No. 14902.

Date: November 10, 2003.



David M. Minneci
L.S. 2349 - Oregon
Expires 12/31/04
3155 Alameda St., Ste. 201
Medford, Oregon 97504

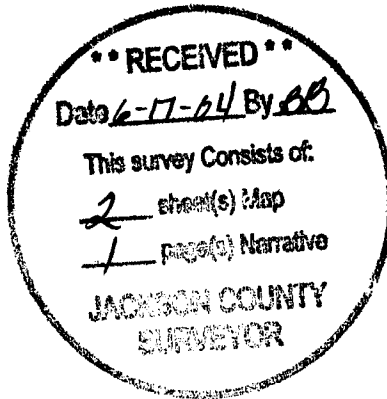

(Duttonnar.doc)

DUTTON ROAD INDUSTRIAL PARK

Located in:

in the Northeast 1/4 of Section 17,
Township 36 South, Range 1 West, W.M.,
Jackson County, Oregon

Jackson County Planning File Nos. 2002-5-S,
2002-20-CUP, 2002-01-PU & 2002-06-V

WEST DUTTON ROAD

FD 2 1/2" BRASS DISC
FLUSH PER 1996 JACKSON
COUNTY RE-ESTABLISHMENT

40.00'
S00°21'47"E

INITIAL POINT

FD 3" BRASS DISC IN
6" X 6" CONCRETE MONUMENT
PER S/N 6869

CURVE TABLE

CURVE	DELTA	RADIUS	LENGTH	CHORD	BEARING
1	90°00'00"	20.00'	31.42'	28.28'	S45°00'00"W
2	90°00'00"	5.00'	7.85'	7.07'	S45°00'00"W
3	90°00'00"	5.00'	7.85'	7.07'	N45°00'00"W
4	90°00'00"	20.00'	31.42'	28.28'	N45°00'00"W
5	41°53'05"	19.75'	14.44'	14.12'	S24°11'32"E

DETAIL "A"
Scale: 1" = 5'

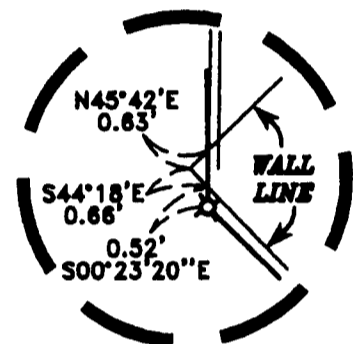

DETAIL "B"
Scale: 1" = 10'

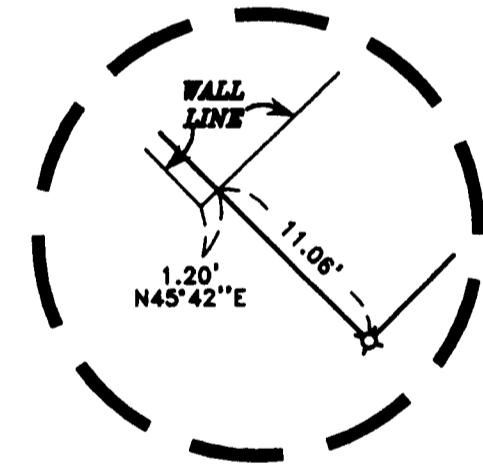

LINE TABLE

LINE	BEARING	DISTANCE
L1	NORTH	12.10'
L2	WEST	25.00'
L3	SOUTH	19.18'
L4	N86°45'00"E	4.90'
L5	S03°15'00"E	10.38'
L6	S45°08'05"E	2.10'

I certify this plot to be an
exact photocopy of the original.
David M. Minnecci
SURVEYOR

REGISTERED
PROFESSIONAL
LAND SURVEYOR

David M. Minnecci
OREGON
JULY 28, 1988
DAVID M. MINNECCI
2349

EXPIRES 12/31/04

TEMPORARY LICENSE FOR
ACCESS PER DOC. NO. 2004-02886A,
OFFICIAL RECORDS OF JACKSON COUNTY

15' EASEMENT GRANTED BEAR
CREEK VALLEY SANITARY AUTHORITY
FOR SEWER LINES AND RELATED
FACILITIES PER DOC. NO. 97-22104,
OFFICIAL RECORDS OF JACKSON COUNTY

FOUND EXPOSED 0.5' (NO CAP)
BENT SLIGHTLY TO NORTHWEST
S50°21'30"W 1.67'

NOTES:

- UNABLE TO ACCURATELY LOCATE EASEMENT FOR TRANSMISSION AND DISTRIBUTION OF ELECTRICITY GRANTED PACIFICORP AS SET FORTH IN DOC. NO. 84-44172, OFFICIAL RECORDS OF JACKSON COUNTY, OREGON.
- UNABLE TO ACCURATELY LOCATE EASEMENT FOR INSTALLATION OF SEWER PIPE AND ELECTRIC PIPE PER DOC. NO. 96-08668, OFFICIAL RECORDS OF JACKSON COUNTY, OREGON.
- DECLARANTS, BEING CURRENT OWNERS OF PARCEL 2 OF PARTITION PLAT P-66-1998 OF THE "RECORD OF PARTITION PLATS" OF JACKSON COUNTY, OREGON, STATE THAT THE WATER AND SEWER LINES SHOWN ON PARCEL 2 OF SAID PARTITION PLAT ARE NOW ABANDON.

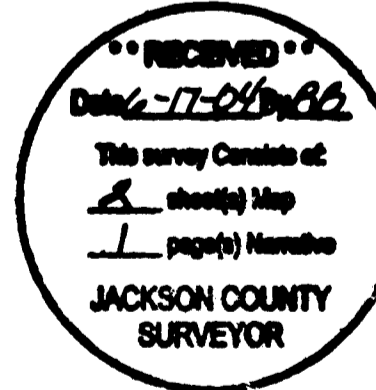

HOFFBUHR & ASSOCIATES, INC.
3155 ALAMEDA ST., STE 201 MEDFORD, OREGON
(541) 778-4641

BY: DAVID M. MINNECCI RPLS NO. 2349
SCALE: 1 INCH = 40' NOVEMBER 18, 2003
BASIS OF BEARING: SURVEY NUMBER 14902
(SOUTH LINE OF WEST DUTTON ROAD)

- = SET 5/8" x 24" IRON PIN WITH PLASTIC CAP STAMPED "D. MINNECCI LS 2349".
- ⊗ = SET 5/8" x 30" IRON PIN WITH PLASTIC CAP STAMPED "D. MINNECCI LS 2349".
- = SET LEAD PLUG, TACK AND METAL WASHER STAMPED "LS 2349" IN CONCRETE.
- = FOUND 5/8" IRON PIN WITH PLASTIC CAP STAMPED "D. HOFFBUHR LS 1840" PER S/N 12975.
- ⋈ = FOUND 5/8" PIN WITH PLASTIC CAP STAMPED "D. MINNECCI LS 2379" PER S/N 13878.
- ⊗ = FOUND 5/8" PIN WITH PLASTIC CAP STAMPED "D. MINNECCI LS 2379" PER S/N 14802.
- ⊙ = FOUND BRASS CAP MONUMENT AS NOTED
- S/N = SURVEY NUMBER
- PUE = EASEMENT FOR PUBLIC UTILITIES, STORM DRAINAGE, GAS TELEPHONE, WATER, ELECTRIC, CABLE TELEVISION AND SANITARY SEWER CONSTRUCTION AND MAINTENANCE.

DUTTON ROAD INDUSTRIAL PARK

Located in:
in the Northeast 1/4 of Section 17,
Township 36 South, Range 1 West, W.M.,
Jackson County, Oregon

*** DECLARATION ***

KNOW ALL MEN BY THESE PRESENTS, THAT WE, STEVEN R. HEADY AND CATHY ANNE HEADY, TRUSTEES OF THE S-C TRUST, ARE THE OWNERS IN FEE SIMPLE OF THE LANDS HEREON DESCRIBED, AND THAT WE HAVE SUBDIVIDED THE SAME INTO LOTS AS SHOWN HEREON, AND THE NUMBER OF EACH LOT AND THE COURSE AND LENGTH OF ALL LINES ARE PLAINLY SET FORTH, AND THAT THIS PLAT IS A CORRECT REPRESENTATION OF THE SUBDIVISION. WE HEREBY DEDICATE TO THE PUBLIC FOR PUBLIC USE THOSE EASEMENTS LABELED AS PUBLIC UTILITY EASEMENTS. WE HEREBY CREATE FOR THE BENEFIT OF THE OWNERS, THEIR HEIRS AND ASSIGNS OF LOTS 1-5, A PRIVATE ROAD EASEMENT OVER AND ACROSS LOTS 1-5 AS SHOWN HEREON. WE HEREBY DESIGNATE SAID SUBDIVISION AS DUTTON ROAD INDUSTRIAL PARK.

S-C TRUST.

IN WITNESS WHEREOF, SIGNED THIS THE 30th DAY OF April, 2004

Steven R. Heady Trustee
STEVEN R. HEADY, TRUSTEE

STATE OF OREGON)
COUNTY OF JACKSON) SS

THE FOREGOING INSTRUMENT WAS ACKNOWLEDGED BY ME THIS 30th DAY OF April, 2004 BY STEVEN R. HEADY, KNOWN TO ME AS THE PERSON WHO EXECUTED THE WITHIN INSTRUMENT ON BEHALF OF THE S-C TRUST.

WITNESS MY HAND AND OFFICIAL SEAL.

[Signature]
NOTARY

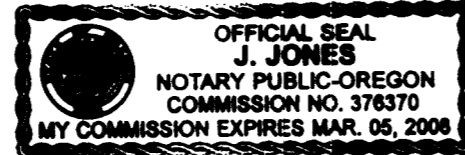

IN WITNESS WHEREOF, SIGNED THIS THE 30th DAY OF April, 2004

Cathy Anne Heady, trustee
CATHY ANNE HEADY, TRUSTEE

STATE OF OREGON)
COUNTY OF JACKSON) SS

THE FOREGOING INSTRUMENT WAS ACKNOWLEDGED BY ME THIS 30th DAY OF April, 2004 BY CATHY ANNE HEADY, KNOWN TO ME AS THE PERSON WHO EXECUTED THE WITHIN INSTRUMENT ON BEHALF OF THE S-C TRUST.

WITNESS MY HAND AND OFFICIAL SEAL.

[Signature]
NOTARY

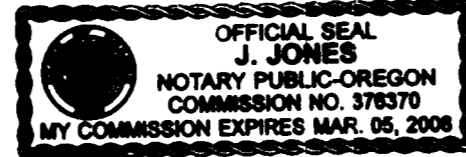

BANK OF SOUTHERN OREGON, DBA PREMIERWEST BANK, THE UNDERSIGNED BENEFICIARY OF A CERTAIN TRUST DEED DATED APRIL 20, 2000 AND RECORDED APRIL 21, 2000 AS DOCUMENT NO. 00-16470, OFFICIAL RECORDS OF JACKSON COUNTY, OREGON, AFFECTING THE LAND DESCRIBED HEREIN, HEREBY RELEASES FROM THE LIEN OF SAID TRUST DEED ALL PROPERTY SHOWN HEREON AS DEDICATED TO THE PUBLIC FOR PUBLIC USE.

IN WITNESS WHEREOF, SIGNED THIS 30th DAY OF April, 2004.

Steve Young
AUTHORIZED REPRESENTATIVE
BANK OF SOUTHERN OREGON DBA PREMIERWEST BANK
VP Area Credit Administrator

STATE OF Oregon)
COUNTY OF Jackson) SS.

THE FOREGOING INSTRUMENT WAS ACKNOWLEDGED BEFORE ME THIS 30th DAY OF April, 2004, BY Steve Young, KNOWN TO ME AS THE PERSON WHO EXECUTED THE WITHIN INSTRUMENT ON BEHALF OF BANK OF SOUTHERN OREGON DBA PREMIERWEST BANK.

WITNESS MY HAND AND OFFICIAL SEAL.

Carol Morejohn
NOTARY



FOR ORDER OF THE COUNTY COURT APPROVING THIS PLAT SEE VOLUME 207, PAGE 476-478 OF COUNTY COMMISSIONERS JOURNAL OF PROCEEDINGS.

FILED FOR RECORD THIS 17 DAY OF June, 2004 AT 9:53 O'CLOCK A.M. AND RECORDED IN VOLUME 30 OF PLATS AT PAGE 37 OF RECORDS OF JACKSON COUNTY, OREGON.

Kathleen S. Beckell
COUNTY CLERK

Christy DeWalt
DEPUTY

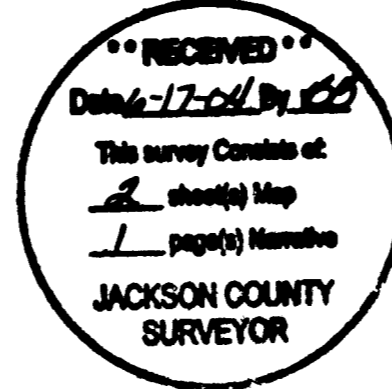

I certify this plat to be an exact photocopy of the original.
David M. Minnici
SURVEYOR



*** SURVEYOR'S CERTIFICATE ***

STATE OF OREGON)
COUNTY OF JACKSON) SS

I, DAVID M. MINNECI, A DULY REGISTERED PROFESSIONAL LAND SURVEYOR OF THE STATE OF OREGON, DO HEREBY CERTIFY THAT I HAVE CORRECTLY SURVEYED AND MARKED WITH THE PROPER MONUMENTS AS PROVIDED BY LAW THE TRACT OF LAND HEREON SHOWN AND THE PLAT IS A CORRECT REPRESENTATION OF THE SAME, AND THE FOLLOWING IS AN ACCURATE DESCRIPTION OF THE BOUNDARY LINES:

COMMENCING AT THE CORNER COMMON TO SECTIONS 8, 9, 16 AND 17 IN TOWNSHIP 36 SOUTH, RANGE 1 WEST OF THE WILLAMETTE MERIDIAN IN JACKSON COUNTY, OREGON; THENCE SOUTH 00°21'47" EAST 40.00 FEET TO A POINT ON THE SOUTHERLY RIGHT-OF-WAY LINE OF WEST DUTTON ROAD; THENCE, ALONG SAID SOUTHERLY LINE, NORTH 89°37'00" WEST 498.65 FEET TO THE NORTHEAST CORNER OF THAT TRACT DESCRIBED IN DOCUMENT NO. 96-03555, OFFICIAL RECORDS OF SAID JACKSON COUNTY FOR THE INITIAL POINT OF BEGINNING; THENCE, ALONG THE BOUNDARY OF SAID TRACT AS FOLLOWS: SOUTH 73.64 FEET; THENCE SOUTH 44°51'55" WEST 530.41 FEET; THENCE NORTH 45°08'05" WEST 110.04 FEET; THENCE NORTH 00°23'20" WEST 375.00 FEET TO THE AFORESAID SOUTHERLY RIGHT-OF-WAY LINE OF WEST DUTTON ROAD; THENCE, ALONG SAID SOUTHERLY LINE, SOUTH 89°37'00" EAST 454.72 FEET TO THE POINT OF BEGINNING.

David M. Minnici
SURVEYOR

*** APPROVALS ***

Ali Tuit 8 June 2004
PLANNING DIRECTOR

EXAMINED AND APPROVED THIS 5th DAY OF May, 2004.

Robert Roberts
COUNTY SURVEYOR

EXAMINED AND APPROVED AS REQUIRED BY O.R.S. 92.100 THIS 9th DAY OF May JUNE, 2004.

William Johnson Deputy
ASSESSOR, DEPARTMENT OF ASSESSMENT

ALL TAXES, FEES, ASSESSMENTS OR OTHER CHARGES AS REQUIRED BY O.R.S. 92.095 HAVE BEEN PAID AS OF THIS 9th DAY OF June, 2004.

Patty Budson, Deputy
TAX COLLECTOR

PREMIERWEST BANK, THE UNDERSIGNED BENEFICIARY OF A CERTAIN TRUST DEED DATED DECEMBER 27, 2000 AND RECORDED DECEMBER 28, 2000 AS DOCUMENT NO. 00-52308, OFFICIAL RECORDS OF JACKSON OREGON, AFFECTING THE LAND DESCRIBED HEREIN, HEREBY RELEASES FROM THE LIEN OF SAID TRUST DEED ALL PROPERTY SHOWN HEREON AS DEDICATED TO THE PUBLIC FOR PUBLIC USE.

IN WITNESS WHEREOF, SIGNED THIS 30th DAY OF April, 2004.

Steve Young
AUTHORIZED REPRESENTATIVE
PREMIERWEST BANK
VP Area Credit Administrator

STATE OF Oregon)
COUNTY OF Jackson) SS.

THE FOREGOING INSTRUMENT WAS ACKNOWLEDGED BEFORE ME THIS 30th DAY OF April, 2004, BY Steve Young, KNOWN TO ME AS THE PERSON WHO EXECUTED THE WITHIN INSTRUMENT ON BEHALF OF PREMIERWEST BANK.

WITNESS MY HAND AND OFFICIAL SEAL.

Carol Morejohn



PREMIERWEST BANK, THE UNDERSIGNED BENEFICIARY OF A CERTAIN TRUST DEED DATED JUNE 26, 2001 AND RECORDED JULY 2, 2001 AS DOCUMENT NO. 01-30692, OFFICIAL RECORDS OF JACKSON OREGON, AFFECTING THE LAND DESCRIBED HEREIN, HEREBY RELEASES FROM THE LIEN OF SAID TRUST DEED ALL PROPERTY SHOWN HEREON AS DEDICATED TO THE PUBLIC FOR PUBLIC USE.

IN WITNESS WHEREOF, SIGNED THIS 30th DAY OF April, 2004.

Steve Young
AUTHORIZED REPRESENTATIVE
PREMIERWEST BANK
VP Area Credit Administrator

STATE OF Oregon)
COUNTY OF Jackson) SS.

THE FOREGOING INSTRUMENT WAS ACKNOWLEDGED BEFORE ME THIS 30th DAY OF April, 2004, BY Carol Morejohn, KNOWN TO ME AS THE PERSON WHO EXECUTED THE WITHIN INSTRUMENT ON BEHALF OF PREMIERWEST BANK.

WITNESS MY HAND AND OFFICIAL SEAL.

Carol Morejohn

