

LITTLE BUTTE MEADOWS A REPLAT OF BARTLETT SUBDIVISION

LOCATED IN:
BARTLETT SUBDIVISION IN
THE S.W. 1/4 OF SECTION 3, T.36S., R.1W., W.M.
CITY OF EAGLE POINT, JACKSON COUNTY, OREGON

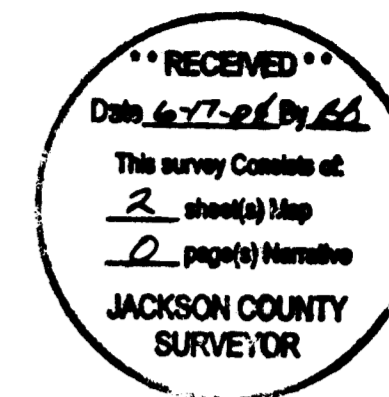

*** DECLARATION ***

KNOW ALL MEN BY THESE PRESENTS, that PACIFIC CREST PROPERTIES, an Oregon Corporation, is the owner in fee simple of the lands hereon described, and has subdivided the same into lots and streets as shown hereon, and the number of each lot and the course and length of all lines are plainly set forth, and that this plat is a correct representation of the subdivision, and does hereby dedicate to the public for public use the streets shown hereon, together with those easements labeled as public utility easements, and does hereby create the temporary turnaround easement as shown on Lot 9 to be used as a turnaround for emergency vehicles and other vehicles as needed, the turnaround easement is only temporary and will be removed when another turnaround is provided or the street is extended, and does also hereby grant to the City of Eagle Point, in fee simple, the area portrayed and designated hereon as a one-foot street plug, by its approval of this plat, the City of Eagle Point declares that upon dedication of the extension of the affected street, it thereby the street plug for public street purpose and does hereby create the 10' Storm Drainage and Irrigation across Lots 3-6, and does also hereby designate said subdivision as LITTLE BUTTE MEADOWS.

PACIFIC CREST PROPERTIES:

Gary T. Whittle - Pres
GARY T. WHITTLE, President

STATE OF OREGON)
County of Jackson) ss
This instrument was acknowledged before me this 4th day of June, 2004, by GARY T. WHITTLE, known to me as the person who executed the within instrument on behalf of PACIFIC CREST PROPERTIES, an Oregon Corporation.

Before me: Amanda M. Mahan-Grendoff
Notary

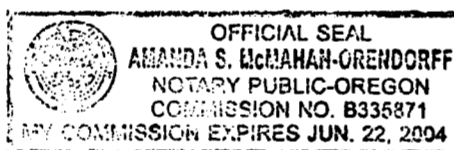

AFFIDAVITS OF CONSENT FOR SUBDIVISION:

From: Russel K. Vaughn and Laura L. Vaughn per Instrument No. 2004-032472 Jackson County Deed Records.

From: Harold C. Munson & A.E. Munson, Trustees, under the Munson Living Trust dated July 9, 1991 per Instrument No. 2004-032473 Jackson County Deed Records.

For order of the County Court approving this plat see Volume 207, Page 470-472 of County Commissioners Journal of Proceedings.

*** RECORDERS CERTIFICATE ***

Filed for record this 17th day of JUNE, 2004, at 9:00 o'clock A.M. and recorded in Volume 30 of Plats at page 35 of records of Jackson County, Oregon.

Kathleen S. Beckett
County Clerk

Cheryl Avgeris
Deputy

*** SURVEYOR'S CERTIFICATE ***

STATE OF OREGON)
County of Jackson) ss

I, Darrell L. Huck, a duly Registered Professional Land Surveyor of the State of Oregon, do hereby certify that I have correctly surveyed and marked with the proper monuments as provided by law the tract of land hereon shown and the plat is a correct representation of the same, and the following is an accurate description of the boundary lines.

BEGINNING at a point for the most-Southerly corner of Lot 1, Block 1 of BARTLETT SUBDIVISION in the City of Eagle Point, according to the Official Plat thereof, now of record in Jackson County, Oregon, said point being a metal disc in concrete on the Northwesterly right-of-way line of Royal Avenue for the INITIAL POINT OF BEGINNING; thence along the boundary of said subdivision North 42°30'00" West 413.055 feet; thence North 43°08'50" East 295.89 feet; thence South 42°35'03" East (Record South 42°36'00" East) 159.48 feet; thence South 47°24'00" West 45.63 feet (Record 45.65 feet); thence South 42°32'34" East 86.51 feet (Record South 42°36'00" East 86.52 feet); thence South 47°24'00" West 139.89 feet (Record 140.00 feet); thence South 42°57'06" East 189.00 feet to a point on the aforementioned Northwesterly right-of-way line of Royal Avenue; thence South 47°24'00" West along said right-of-way line, 111.31 feet (Record 111.43 feet) to the INITIAL POINT OF BEGINNING.

Darrell L. Huck
SURVEYOR

*** APPROVALS ***

Examined and approved this 10th day of June, 2004.

Roger Roberts
Jackson County Surveyor

Examined and recommended for approval this 11th day of June, 2004.

John Handley
City Engineer

Examined and recommended for approval by Rogue Valley Sewer Services this 10th day of June, 2004.

Alton
District Engineer

Examined and approved by the City Administrator/Planning Director of the City of Eagle Point, Jackson County, Oregon, Dated this 11th day of JUNE, 2004.

David A. Russell
City Administrator/ Planning Director

Examined and approved as required by O.R.S. 92.100 as of JUNE 14, 2004.

Willie Johnson
Assessor, Department of Assessment

All taxes, fees, assessments or other charges as required by O.R.S. 92.095 have been paid, as of June 14, 2004.

Jamie Clark
Deputy Tax Collector

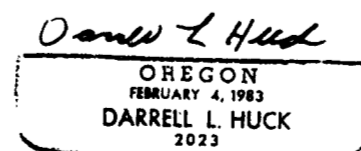
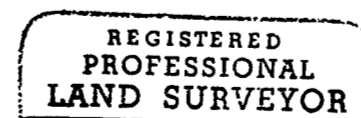

I certify this plat to be an exact photocopy of the original.
Darrell L. Huck
SURVEYOR

RENEWS 6/30/05

LITTLE BUTTE MEADOWS

A REPLAT OF BARTLETT SUBDIVISION

LOCATED IN:
 BARTLETT SUBDIVISION IN
 THE S.W. 1/4 OF SECTION 3, T.36S., R.1W., W.M.
 CITY OF EAGLE POINT, JACKSON COUNTY, OREGON

FOR:
 PACIFIC CREST PROPERTIES, INC.
 P.O. BOX 1488
 MEDFORD, OREGON 97501

CURVE TABLE					
CURVE	DELTA	RADIUS	LENGTH	CHORD	CHORD BEARING
1	90°11'14"	20.00	31.48	28.33	N02°18'23"E
2	09°54'54"	65.00	11.25	11.23	S37°49'47"E
3	40°51'48"	65.00	46.36	45.39	S12°26'25"E
4	18°08'05"	65.00	20.57	20.49	S17°03'31"W
5	21°16'26"	65.00	24.14	24.00	S36°45'47"W
6	90°11'14"	30.00	47.22	42.50	S02°18'23"W
7	90°11'14"	45.00	70.83	63.74	N02°18'23"E

LOT SIZE	
LOT NO.	SQUARE FEET
1	5,089
2	4,667
3	4,648
4	4,632
5	8,984
6	8,177
7	4,538
8	4,622
9	7,156
10	4,917
11	5,623
12	6,351

SURVEY NARRATIVE TO COMPLY WITH PARAGRAPH 209.250 OF THE OREGON REVISED STATUTES

PURPOSE: TO SURVEY, MONUMENT AND PREPARE FINAL PLAT OF LITTLE BUTTE MEADOWS SUBDIVISION

PROCEDURE: UTILIZING FOUND MONUMENTATION PER FILED SURVEYS NO. 4285, 6506 AND 7083 AND BARTLETT SUBDIVISION AND ROYAL SUBDIVISION FOR CONTROL, I ESTABLISH PROPER MONUMENTS AS SHOWN HEREON. THIS IS A REPLAT OF BARTLETT SUBDIVISION. THAT PORTION OF PLATT PLACE WITHIN BARTLETT SUBDIVISION PLAT WAS VACATED BY CITY OF EAGLE POINT PRIOR TO REPLAT, PER INSTRUMENT NO. 03-03289 J.C.D.R. I USED INSTRUMENT NO. 02-52649 J.C.D.R. FOR CLIENTS' PROPERTIES. AN ELECTRONIC TOTAL STATION WAS USED TO MAKE ALL MEASUREMENTS.

HOFFBUHR & ASSOCIATES, INC.

880 GOLF VIEW DRIVE, SUITE 201 MEDFORD, OREGON 97504
 (541) 779-4641

SCALE: 1" = 50'
 BASIS OF BEARING: DATE: MAY 3, 2004
 BARTLETT SUBDIVISION

- = Set 5/8"x24" rebar with plastic cap stamped "HOFFBUHR AND ASSOC., INC."
- ⊗ = Set 5/8"x30" rebar with plastic cap stamped "HOFFBUHR AND ASSOC., INC."
- = Found 5/8" iron pin, per plat of BARTLETT SUBDIVISION, unless otherwise shown.
- ⦿ = Found 5/8" iron pin, per plat of ROYAL SUBDIVISION.
- ⊙ = Set 5/8"x30" rebar with metal cap stamped "HOFFBUHR & ASSOC INC"
- PUE = Easement for public utilities, storm drainage, gas, water, electric, telephone, cable television and sanitary sewer construction and maintenance
- S/N = Filed survey number
- J.C.D.R. = Jackson County Deed Records

NOTES:

- 10' STORM DRAINAGE AND IRRIGATION EASEMENT, BEING CREATED HEREON.
- THIS PORTION OF PLATT PLACE VACATED PER INSTRUMENT NO. 03-03289 J.C.D.R.
- THE 10' PUE'S ALONG THE RIGHT-OF-WAY LINES OF THE NOW VACATED PORTION OF PLATT PLACE ARE BEING REALIGNED WITH THE RECORDING OF THIS PLAT AS SHOWN HEREON.
- ALL EASEMENTS CREATED AS SHOWN ON THE PLAT OF BARTLETT SUBDIVISION ARE REMOVED BY RECORDING OF THIS PLAT EXCEPT AS SHOWN HEREON.
- PORTION OF PLATT ROAD DEDICATED PER BARTLETT SUBDIVISION. THIS AREA WAS NOT PART OF THE PLATT PLACE VACATED PER INSTRUMENT 03-03289 J.C.D.R.
- A 5' EASEMENT FOR THE INSTALLATION, OPERATION AND MAINTENANCE FOR COMMUNICATIONS PURPOSES TO SOUTHERN OREGON BROADCASTING COMPANY PER INSTRUMENT NO. 80-21257 J.C.D.R. SPECIFIC LOCATION NOT GIVEN.

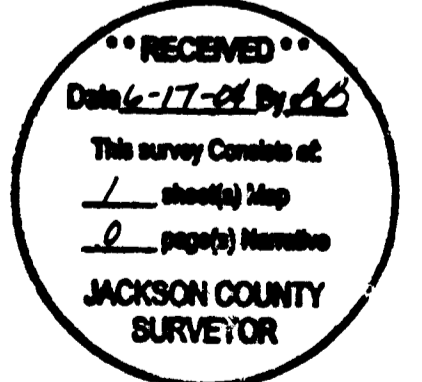

REGISTERED PROFESSIONAL LAND SURVEYOR

Darrell L. Huck
 OREGON
 FEBRUARY 4, 1993
 DARRELL L. HUCK
 2023

RENEWS 6/30/05

I certify this plat to be an exact photocopy of the original
Darrell L. Huck
 SURVEYOR

(02064S2.DWG)
 SHEET 2 OF 2

13R/47
 CS