

PROJECT LOCATED IN THE SE 1/4 SEC 30; NE 1/4 SEC 31;
 NW, SW, SE 1/4'S SEC 32 OF T37S, R1W, W.M.; AND
 NE 1/4 SEC 5; NW, SW, SE 1/4'S SEC 4; NE 1/4 SEC 9;
 NW, SW 1/4'S SEC 10; NE, SE 1/4'S SEC 15; SW 1/4 SEC 14;
 NW, NE, SE 1/4'S SEC 23; SW 1/4 SEC 24; NW, NE 1/4'S SEC 25
 OF T38S, R1W, W.M.; AND SW, SE 1/4'S SEC 30; NE 1/4 SEC 31;
 NW, NE, SE 1/4'S SEC 32; SW, SE 1/4'S SEC 33 OF T38S, R1E, W.M.

CONTROL AND I-5 CENTER LINE RECOVERY SURVEY FOR
 OREGON DEPT. OF TRANSPORTATION
 REGION 3

I-5: N. ASHLAND - 12TH STREET
 JACKSON COUNTY
 KEY NO. 11783

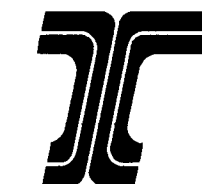

17355 SW BOONES FERRY RD.
 LAKE OSWEGO, OREGON 97035
 PHONE: (503) 635-3618
 FAX: (503) 635-5395
 www.otak.com

PROJECT NO. 11732-014-001
 DECEMBER 4, 2003
 SHEET 1 OF 9

TABLE OF CONTENTS

SHEET 1	NARRATIVE
SHEET 2	CONTROL NETWORK SCHEMATIC
SHEET 3	RECOVERED MONUMENTS
SHEET 4	RECOVERED MONUMENT COORDINATES & DESCRIPTIONS
SHEET 5	CENTER LINE PER ODOT DRAWINGS
SHEET 6	CENTER LINE RECOVERY FROM EXISTING GOVERNMENT CORNER MONUMENTS
SHEET 7-9	CENTER LINE RECOVERY FROM EXISTING CENTER LINE MONUMENTS

REGISTERED
 PROFESSIONAL
 LAND SURVEYOR

J. A. Carlson

OREGON
 JULY 15, 1983
 JOHN A. CARLSON
 2044

RENEWS 12-31-2005

NARRATIVE

PURPOSE OF SURVEY

THE PURPOSE OF THIS SURVEY WAS TO RECOVER THE CENTER LINE OF INTERSTATE HIGHWAY NO. 5 FROM MILEPOST 18.73 (BUTLER CREEK ROAD IN ASHLAND) TO MILEPOST 26.72 (12TH STREET IN MEDFORD) FOR A HIGHWAY PRESERVATION (REPAVING) PROJECT.

BASIS OF BEARINGS

THE BASIS OF BEARINGS FOR THIS SURVEY IS THE OREGON COORDINATE SYSTEM OF 1983, SOUTH ZONE, BASED ON GPS OBSERVATIONS AT STATION "ASH" (PID NZ1326) AND STATION "PACIFIC SURVEY" (PID A12003).

HORIZONTAL PROJECT CONTROL

EXISTING GEODETIC CONTROL MONUMENTS "ASH" AND "PACIFIC SURVEY" WERE RECOVERED, AND PROJECT CONTROL MONUMENT NOS. 1-8 SET AT APPROXIMATELY EQUIDISTANT INTERVALS BETWEEN THE RECOVERED CONTROL. CONTROL MONUMENT NOS. 9-12 WERE SET AT THE BEAR CREEK BRIDGE STRUCTURES FOR USE IN ACQUIRING TOPOGRAPHIC DATA AT THE FOUR STRUCTURES. MEASUREMENTS WERE PERFORMED ON SEPTEMBER 23 THROUGH SEPTEMBER 26, 2003 AS SHOWN ON SHEET 2 OF THIS SURVEY USING TWO TRIMBLE MODEL 5700 AND TWO TRIMBLE MODEL 5800 GPS RECEIVERS WITH ZEPHYR ANTENNAS, AND TERRESTRIAL MEASUREMENTS WERE MADE WITH A GEODIMETER MODEL 610 TOTAL STATION. ALL GPS OBSERVATIONS WERE PROCESSED USING LEICA SKI-PRO VERSION 2.1.0.0 SOFTWARE, AND THE GPS VECTORS AND TERRESTRIAL OBSERVATIONS WERE SIMULTANEOUSLY ADJUSTED USING STAR*NET VERSION 6.0.25 LEAST SQUARES ADJUSTMENT SOFTWARE. THE NETWORK WAS CONSTRAINED TO THE PUBLISHED 1983(91) OREGON COORDINATE SYSTEM, SOUTH ZONE VALUES OF STATION "ASH" AND "PACIFIC SURVEY". THE 83(91) VALUES WERE USED (INSTEAD OF MORE CURRENT ADJUSTMENTS) IN ORDER TO CORRESPOND WITH PREVIOUS SURVEYS IN THE AREA. THE MAXIMUM 95% CONFIDENCE REGION ERRORS OF ANY CONTROL POINT WAS +/- 0.034 FEET WITH RESPECT TO THE EXISTING GEODETIC CONTROL.

REAL-TIME KINEMATIC (RTK) MONUMENT TIES

EXISTING MONUMENTS WERE DOUBLE-TIED USING RTK GPS EQUIPMENT AND PROCEDURES. MEASUREMENTS WERE PERFORMED ON SEPTEMBER 26 THROUGH OCTOBER 1, 2003, AND OCTOBER 15 THROUGH OCTOBER 16, 2003 USING A TRIMBLE MODEL 5700 BASE AND A TRIMBLE MODEL 5800 ROVER GPS RECEIVERS WITH ZEPHYR ANTENNAS. EACH MONUMENT WAS TIED FROM AT LEAST TWO CONTROL POINTS AND THE RESULTING BASELINE AND COVARIANCE MEASUREMENT DATA WAS ADJUSTED USING STAR*NET VERSION 6.0.25 LEAST SQUARES ADJUSTMENT SOFTWARE. THE MAXIMUM 95% CONFIDENCE REGION ERRORS OF ANY RECOVERED MONUMENT WAS +/- 0.128 FEET WITH RESPECT TO THE EXISTING PROJECT CONTROL.

LOCAL DATUM PLANE (LDP) COORDINATES

IN ORDER TO REPRESENT GROUND SURFACE VALUES, OREGON STATE PLANE COORDINATE VALUES WERE SCALED FROM THE GRID TO THE GROUND SURFACE USING A SCALE FACTOR BASED ON THE AVERAGE LATITUDE AND ELEVATION OF THE PROJECT. THE LDP COORDINATES SHOWN IN THIS SURVEY ARE IN UNITS OF INTERNATIONAL FEET, AND ARE BASED ON THE COMBINED SCALE FACTOR AT CONTROL POINT NO. 6. TO CONVERT LDP COORDINATES AND DISTANCES TO OREGON STATE PLANE, SOUTH ZONE VALUES, MULTIPLY THE LDP DATA BY 0.9999468855.

CONVERSION OF SURVEY NO. 17166 COORDINATES

THE COORDINATES IN SURVEY NO. 17166, JACKSON COUNTY SURVEY RECORDS, ARE IN METRIC UNITS, AND ARE REPRESENTED TO BE LDP COORDINATES BASED ON NAD83(1991) VALUES OF EXISTING JACKSON COUNTY GEODETIC CONTROL. WHEN THE SURVEY NO. 17166 COORDINATE VALUES WERE SCALED TO STATE PLANE GRID VALUES USING THE SURVEY NO. 17166 LOCAL SCALE FACTOR OF 0.99994213, THEN SCALED TO BACK TO GROUND SURFACE USING THIS PROJECT'S LOCAL SCALE FACTOR OF 0.9999468855, THE SURVEY NO. 17166 COORDINATE VALUES FOR SURVEY NO. 17166 MONUMENT NOS. 613, 614, 1006, 1007 AND 1205 DID NOT MATCH THIS SURVEY'S MEASURED VALUES. THE SURVEY NO. 17166 COORDINATES WERE TRANSFORMED BY +0.41 FEET IN THE NORTHINGS, AND -3.71 FEET IN THE EASTINGS TO BEST FIT THIS SURVEY'S MEASURED COORDINATES.

INTERSTATE HIGHWAY NO. 5 CENTER LINE RECOVERIES

THE CENTER LINE OF INTERSTATE HIGHWAY NO. 5 IS SHOWN ON TWO SETS OF OREGON DEPARTMENT OF TRANSPORTATION MAPS. DRG. 7B-28-16 AND DRG. 9B-2-5 SHOW THE CONSTRUCTION CENTER LINE OF THE HIGHWAY, AND IS THE SAME CENTER LINE AS THAT ONE SHOWN ON THE 1975 "SEVEN OAKS - S. ASHLAND INTERCHANGE SECTION" CONSTRUCTION PLAN SET. DRG. 8B-10-20, 8B-10-21, 8B-12-15, 8B-15-22 SHOW THE LOCATED HIGHWAY CENTER LINE, AND IS THE CENTER LINE USED FOR THE ACQUISITION OF THE HIGHWAY RIGHT OF WAY. THE CONSTRUCTION AND LOCATED CENTER LINES ARE NOT THE SAME. THIS SURVEY ATTEMPTED TO RECOVER THE LOCATED HIGHWAY CENTER LINE. MONUMENTS WERE RECOVERED AT THE MAJORITY OF THE CURVE AND TANGENT POINTS ALONG THE ALIGNMENT. AN INITIAL REVIEW OF THE RELATIVE POSITIONS OF THE MONUMENTS WITH RESPECT TO THE DATA SHOWN ON THE RIGHT OF WAY DRAWINGS SHOWED THAT THE DISTANCES ALONG, AND THE ANGULAR RELATIONSHIPS BETWEEN, TANGENT SECTIONS DID NOT CORRESPOND. ADDITIONALLY, THE RELATIONSHIP BETWEEN MONUMENTED CENTER LINE AND THE ACTUAL POSITIONS OF GOVERNMENT CORNERS ADJACENT TO THE CENTER LINE DID NOT CORRESPOND TO THE RIGHT OF WAY DRAWING DATA. BECAUSE OF THE DISCREPANCY BETWEEN MEASURED AND RECORD DATA, AND THE DISCREPANCY BETWEEN THE MONUMENTED CENTER LINE AND OTHER EXISTING MONUMENTATION, TWO SEPARATE RECOVERIES WERE PERFORMED.

CENTER LINE FROM RECOVERED GOVERNMENT CORNER MONUMENTS

DRG. 8B-10-20, 8B-10-21, 8B-12-15, 8B-15-22 SHOW THE POSITION OF THE LOCATED HIGHWAY CENTER LINE WITH RESPECT TO VARIOUS SECTION AND DONATION LAND CLAIM CORNERS ADJACENT TO THE HIGHWAY. A MATHEMATICAL MODEL LINKING THE RECORD POSITION OF THE CENTER LINE TO THE VARIOUS RECOVERED GOVERNMENT CORNERS WAS CREATED AND MULTIPLE SCENARIOS RUN WHEREIN DIFFERENT RECOVERED MONUMENTS WERE HELD IN THE ANALYSIS. THE SCENARIOS WERE BASED UPON THE ASSUMPTIONS THAT THE ORIGINAL SURVEY WORK INCLUDED STANDARD DISTANCE ERRORS OF 0.1 FEET PLUS 250 PPM (1:4000) FOR DISTANCE MEASUREMENTS, AND 10 SECONDS FOR ANGULAR MEASUREMENTS. SHEET 6 OF THIS SURVEY SHOWS THE BEST RESULT OF THE DIFFERENT SCENARIOS MATCHING RECORD DATA TO THE EXISTING GOVERNMENT CORNERS. THIS CENTER LINE IS APPROXIMATELY TWO FEET NORTHEASTERLY OF THE MONUMENTED CENTER LINE DESCRIBED BELOW.

CENTER LINE FROM RECOVERED CENTER LINE MONUMENTS

DRG. 8B-10-20, 8B-10-21, 8B-12-15, 8B-15-22 SHOW THAT SOME MONUMENTS REFERENCING THE LOCATED LINE WERE SET AT VARYING LOCATIONS ALONG THE ALIGNMENT (SEE SHEET 5). THOSE MONUMENTS, ADDITIONAL RECOVERED CENTER LINE MONUMENTS, AND DATA FROM SURVEY NO. 17166 WERE HELD TO GENERATE THE CENTER LINE SHOWN ON SHEETS 7-9 OF THIS SURVEY.

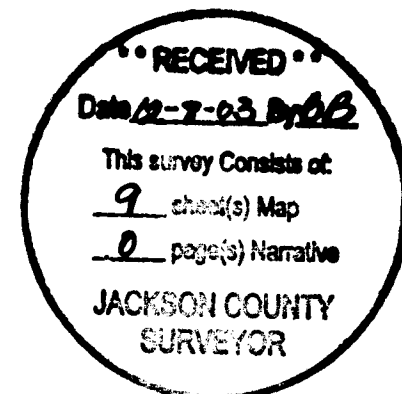

PROJECT LOCATED IN THE SE 1/4 SEC 30; NE 1/4 SEC 31;
NW, SW, SE 1/4'S SEC 32 OF T37S, R1W, W.M.; AND
NE 1/4 SEC 5; NW, SW, SE 1/4'S SEC 4; NE 1/4 SEC 9;
NW, SW 1/4'S SEC 10; NE, SE 1/4'S SEC 15; SW 1/4 SEC 14;
NW, NE, SE 1/4'S SEC 23; SW 1/4 SEC 24; NW, NE 1/4'S SEC 25
OF T38S, R1W, W.M.; AND SW, SE 1/4'S SEC 30; NE 1/4 SEC 31;
NW, NE, SE 1/4'S SEC 32; SW, SE 1/4'S SEC 33 OF T38S, R1E, W.M.

CONTROL AND I-5 CENTER LINE RECOVERY SURVEY FOR
OREGON DEPT. OF TRANSPORTATION
REGION 3

I-5: N. ASHLAND - 12TH STREET
JACKSON COUNTY
KEY NO. 11783



17355 SW BOONES FERRY RD.
LAKE OSWEGO, OREGON 97035
PHONE: (503) 635-3618
FAX: (503) 635-5395
www.otak.com

PROJECT NO. 11732-014-001
DECEMBER 4, 2003
SHEET 9 OF 9

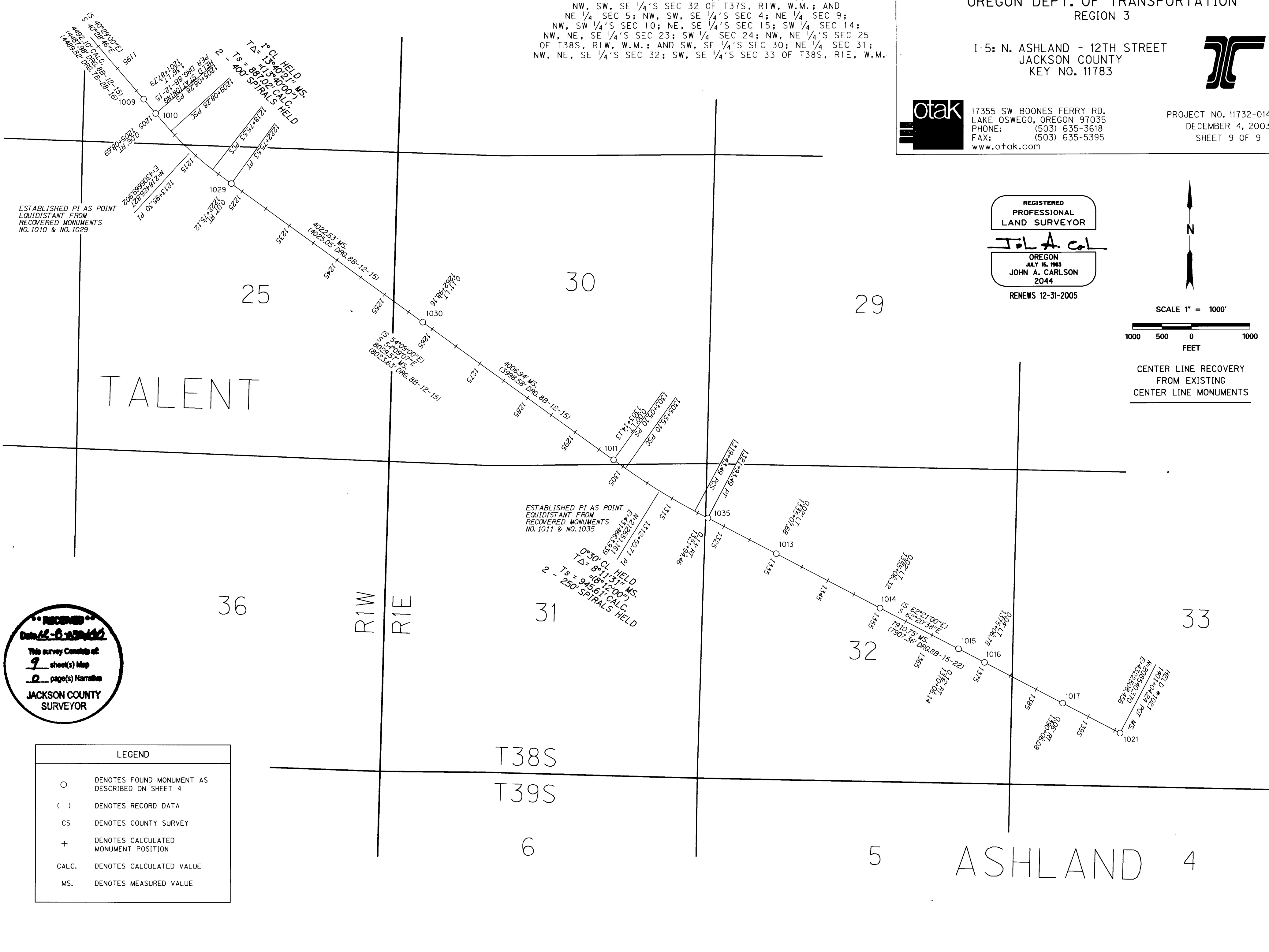

ESTABLISHED PI AS POINT
EQUIDISTANT FROM
RECOVERED MONUMENTS
NO. 1010 & NO. 1029

ESTABLISHED PI AS POINT
EQUIDISTANT FROM
RECOVERED MONUMENTS
NO. 1011 & NO. 1035

REGISTERED
PROFESSIONAL
LAND SURVEYOR
J. A. Carlson
OREGON
JULY 15, 1983
JOHN A. CARLSON
2044
RENEWS 12-31-2005

N
SCALE 1" = 1000'
1000 500 0 1000
FEET
CENTER LINE RECOVERY
FROM EXISTING
CENTER LINE MONUMENTS

RECEIVED
Date 12-8-2003
This survey consists of
9 sheet(s) Map
2 page(s) Narrative
JACKSON COUNTY
SURVEYOR

LEGEND	
○	DENOTES FOUND MONUMENT AS DESCRIBED ON SHEET 4
()	DENOTES RECORD DATA
CS	DENOTES COUNTY SURVEY
+	DENOTES CALCULATED MONUMENT POSITION
CALC.	DENOTES CALCULATED VALUE
MS.	DENOTES MEASURED VALUE

MEDFORD

PROJECT LOCATED IN THE SE 1/4 SEC 30; NE 1/4 SEC 31;
 NW, SW, SE 1/4'S SEC 32 OF T37S, R1W, W.M.; AND
 NE 1/4 SEC 5; NW, SW, SE 1/4'S SEC 4; NE 1/4 SEC 9;
 NW, SW 1/4'S SEC 10; NE, SE 1/4'S SEC 15; SW 1/4 SEC 14;
 NW, NE, SE 1/4'S SEC 23; SW 1/4 SEC 24; NW, NE 1/4'S SEC 25
 OF T38S, R1W, W.M.; AND SW, SE 1/4'S SEC 30; NE 1/4 SEC 31;
 NW, NE, SE 1/4'S SEC 32; SW, SE 1/4'S SEC 33 OF T38S, R1E, W.M.

CONTROL AND I-5 CENTER LINE RECOVERY SURVEY FOR
 OREGON DEPT. OF TRANSPORTATION
 REGION 3

I-5: N. ASHLAND - 12TH STREET
 JACKSON COUNTY
 KEY NO. 11783



17355 SW BOONES FERRY RD.
 LAKE OSWEGO, OREGON 97035
 PHONE: (503) 635-3618
 FAX: (503) 635-5395
 www.otak.com

PROJECT NO. 11732-014-001
 DECEMBER 4, 2003
 SHEET 7 OF 9

R2W
 R1W

31

32

33

T37S

T38S

T37S

T38S

6

5

4

3

8

9

10

850+00.00 PT
 N245549.68
 E428755.68
 CS 17166
 CALC. PI

S 44°15'10"E
 S 44°14'55"E
 CS 17166

885
 880+16.37 PSC
 N243597.87
 E4286648.99
 CS 17166
 CALC. PI

CALCULATED POSITION OF
 MON. NO. 1185 FROM CS 17166
 N 243289.65
 E 4286889.02
 140.00' LT.
 896+22.08

CALCULATED POSITION OF
 MON. NO. 1184 FROM CS 17166
 N 243121.10
 E 4287021.45
 140.00' LT.
 898+36.42

CALCULATED POSITION OF
 MON. NO. 1227 FROM CS 17166
 N 242284.78
 E 4287678.56
 140.00' LT.
 909+00.02

CALCULATED POSITION OF
 MON. NO. 1203 FROM CS 17166
 N 241974.08
 E 4287935.39
 149.99' LT.
 913+03.01

CALCULATED POSITION OF
 MON. NO. 1202 FROM CS 17166
 N 241796.70
 E 4287706.00
 139.98' LT.
 913+00.76

1000
 1001
 89°06'00"
 11.5870
 TΔ = 605.58' MS.
 16.05' CALC.
 T s = 504.90' CALC.
 2 - 400' SPIRALS HELD

S 38°09'30"E
 S 38°08'27"E
 CS 17166
 CALC. PI

REGISTERED
 PROFESSIONAL
 LAND SURVEYOR
 J. A. CARLSON
 OREGON
 JULY 15, 1983
 JOHN A. CARLSON
 2044
 RENEWS 12-31-2005

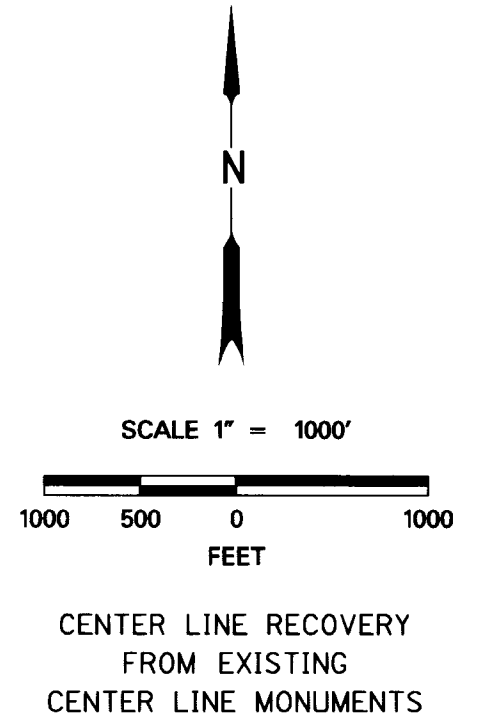

RECORDED
 Date 11/20/03
 This survey consists of
 2 sheets of Map
 2 pages of Narrative
 JACKSON COUNTY
 SURVEYOR

LEGEND	
○	DENOTES FOUND MONUMENT AS DESCRIBED ON SHEET 4
()	DENOTES RECORD DATA
CS	DENOTES COUNTY SURVEY
+	DENOTES CALCULATED MONUMENT POSITION
CALC.	DENOTES CALCULATED VALUE
MS.	DENOTES MEASURED VALUE

ESTABLISHED PI AS POINT
 EQUIDISTANT FROM
 RECOVERED MONUMENTS
 NO. 6 & NO. 1005
 N243272.69
 E4285195.91
 CS 17166
 CALC. PI
 1025+87.26
 1025
 1025+86.94 PSC
 1028+36.94 PSC
 1039+04.29 PT
 1036+54.29 PSC
 1045
 0°15' CR HELD MS.
 TΔ = 240.06' MS.
 16.05' CALC.
 T s = 659.11' CALC.
 2 - 250' SPIRALS HELD

PROJECT LOCATED IN THE SE 1/4 SEC 30; NE 1/4 SEC 31;
 NW, SW, SE 1/4'S SEC 32 OF T37S, R1W, W.M.; AND
 NE 1/4 SEC 5; NW, SW, SE 1/4'S SEC 4; NE 1/4 SEC 9;
 NW, SW 1/4'S SEC 10; NE, SE 1/4'S SEC 15; SW 1/4 SEC 14;
 NW, NE, SE 1/4'S SEC 23; SW 1/4 SEC 24; NW, NE 1/4'S SEC 25
 OF T38S, R1W, W.M.; AND SW, SE 1/4'S SEC 30; NE 1/4 SEC 31;
 NW, NE, SE 1/4'S SEC 32; SW, SE 1/4'S SEC 33 OF T38S, R1E, W.M.

CONTROL AND I-5 CENTER LINE RECOVERY SURVEY FOR
 OREGON DEPT. OF TRANSPORTATION
 REGION 3

I-5: N. ASHLAND - 12TH STREET
 JACKSON COUNTY
 KEY NO. 11783



17355 SW BOONES FERRY RD.
 LAKE OSWEGO, OREGON 97035
 PHONE: (503) 635-3618
 FAX: (503) 635-5395
 www.otak.com

PROJECT NO. 11732-014-001
 DECEMBER 4, 2003
 SHEET 4 OF 9

RECOVERED MONUMENT TABLE

PT. NO.	LDP (FT) NORTHING	LDP (FT) EASTING	DATE TIED	DESCRIPTION
6	233008.46	4294789.18	9/24/2003	FOUND 2 3/4" BRASS CAP IN CONCRETE (SEE TYPICAL SKETCH #1)-DOWN 0.30'
1000	242835.27	4287069.20	9/27/2003	FOUND 1 1/2" O.D. IRON PIPE WITH YPC "JACKSON C.S." (REF. MON NE DLC 46)-DOWN 0.20'
1001	242788.12	4287104.99	9/27/2003	FOUND 2 3/4" BRASS CAP IN CONCRETE (SEE TYPICAL SKETCH #1)-FLUSH
1002	234734.48	4300096.47	9/27/2003	FOUND 2 1/2" BRASS CAP SEC. COR. 2/3/10/11 (SEE SKETCH)-DOWN 0.20'
1003	229607.21	4294633.32	9/27/2003	FOUND 3" BRASS CAP IN MON. CASE SEC. COR. 9/10/15/16 (SEE SKETCH)-DOWN 0.90'
1004	240345.95	4289627.85	9/27/2003	FOUND 3" BRASS CAP SEC. COR. 32/33/4/5 (SEE SKETCH)-DOWN 1.30'
1005	231954.56	4295578.23	9/27/2003	FOUND 2 3/4" BRASS CAP IN CONCRETE (SEE TYPICAL SKETCH #1)-FLUSH
1006	229232.71	4297519.00	9/27/2003	FOUND 2 3/4" BRASS CAP IN CONCRETE (SEE TYPICAL SKETCH #1)-DOWN 0.20'
1007	228249.05	4298286.97	9/27/2003	FOUND 2 3/4" BRASS CAP IN CONCRETE (SEE TYPICAL SKETCH #1)-DOWN 0.10'
1008	227159.12	4299217.09	9/27/2003	FOUND 2 3/4" BRASS CAP IN CONCRETE (SEE TYPICAL SKETCH #1)-FLUSH
1009	219346.19	4305887.05	9/27/2003	FOUND 2 1/4" BRASS CAP IN CONCRETE (REF. MON NE DLC 69) (SEE SKETCH)-FLUSH
1010	219101.18	4306094.29	9/27/2003	FOUND 2 3/4" BRASS CAP IN CONCRETE (SEE TYPICAL SKETCH #1)-FLUSH
1011	213205.51	4313896.67	9/27/2003	FOUND 2 3/4" BRASS CAP IN CONCRETE (SEE TYPICAL SKETCH #1)-FLUSH
1012	213129.40	4312836.98	9/27/2003	FOUND 5/8" IRON ROD WITH YPC "JACKSON C.S." 1/4 COR. 30/31 -FLUSH
1013	211602.26	4316665.56	9/27/2003	FOUND 2 3/4" BRASS CAP IN CONCRETE STAMPED "1335" (SEE TYPICAL SKETCH #2)-DOWN 0.50'
1014	210674.57	4318435.87	9/27/2003	FOUND 2 3/4" BRASS CAP IN CONCRETE (SEE TYPICAL SKETCH #2)-DOWN 0.40'
1015	209978.29	4319764.26	9/27/2003	FOUND 2 3/4" BRASS CAP IN CONCRETE STAMPED "1370" (SEE TYPICAL SKETCH #1)-FLUSH
1016	209746.05	4320207.78	9/27/2003	FOUND 2 3/4" BRASS CAP IN CONCRETE STAMPED "1375" (SEE TYPICAL SKETCH #2)-DOWN 0.30'
1017	209050.04	4321535.74	9/27/2003	FOUND 2 3/4" BRASS CAP IN CONCRETE (SEE TYPICAL SKETCH #2)-DOWN 0.40'
1018	245563.38	4284823.51	9/27/2003	FOUND 1" BRASS CAP IN CONCRETE SIDEWALK "ODOT 613 CONTROL"-FLUSH
1019	245688.70	4284350.44	9/27/2003	FOUND 2" ALUMINUM CAP "OREGON STATE HWY. DIV. 614 CONTROL POINT"-DOWN 0.20'
1020	242964.82	4287072.36	9/27/2003	FOUND 2 1/2" BRASS CAP (REF. MON NE DLC 46) (SEE SKETCH)-FLUSH
1021	208540.37	4322508.46	9/27/2003	FOUND 2 3/4" BRASS CAP IN CONCRETE (SEE TYPICAL SKETCH #1)-DOWN 0.70'
1022	240898.84	4288475.65	10/15/2003	FOUND 2 1/2" BRASS CAP ON IRON PIPE (SSE DLC 51) (SEE SKETCH)-FLUSH
1023	235437.35	4293076.88	10/15/2003	FOUND 3" BRASS CAP ON IRON PIPE (SE DLC 40) (SEE SKETCH)-FLUSH
1024	240876.13	4289288.25	10/15/2003	FOUND 2 1/2" BRASS CAP ON IRON PIPE (NE DLC 48) (SEE SKETCH)-DOWN 0.30'
1025	230503.80	4297601.22	10/15/2003	FOUND PUNCHED 1" IRON ROD & PILE OF ROCKS (NE DLC 42)-FLUSH
1026	227490.34	4299556.88	10/15/2003	FOUND 3" BRASS CAP IN CONCRETE (SE DLC 42) (SEE SKETCH)-FLUSH
1027	223218.61	4302750.97	10/15/2003	FOUND 3" BRASS CAP IN CONCRETE (NE DLC 59) (SEE SKETCH)-DOWN 0.20'
1028	222214.91	4303082.93	10/15/2003	FOUND 2 1/2" BRASS CAP (NE DLC 60) (SEE SKETCH)-DOWN 0.40'
1029	217907.53	4307388.52	10/15/2003	FOUND 2 3/4" BRASS CAP IN CONCRETE (SEE TYPICAL SKETCH #1)-DOWN 0.20'
1030	215551.65	4310649.59	10/15/2003	FOUND 2 3/4" BRASS CAP IN CONCRETE (SEE TYPICAL SKETCH #1)-FLUSH
1031	212461.44	4313220.23	10/15/2003	FOUND 3" BRASS CAP IN CONCRETE (NW DLC 48) (SEE SKETCH)-FLUSH
1032	208114.68	4322718.93	10/15/2003	FOUND 3" BRASS CAP IN CONCRETE (NW DLC 53) (SEE SKETCH)-FLUSH
1033	207625.85	4323280.51	10/15/2003	FOUND 2 1/2" BRASS CAP & PILE OF ROCKS 1/4 COR. 33/4 (SEE SKETCH)-UP 0.10'
1034	207647.43	4323846.63	10/15/2003	FOUND 2 3/4" BRASS CAP IN CONCRETE (SEE TYPICAL SKETCH #2)-DOWN 0.40'
1035	212211.68	4315502.31	10/15/2003	FOUND 2 3/4" BRASS CAP IN CONCRETE (SEE TYPICAL SKETCH #1)-FLUSH
1036	225260.27	4301391.13	10/15/2003	FOUND 2 1/2" BRASS CAP ON IRON PIPE IN ROCK MOUND (NW DLC 80) (SEE SKETCH)-UP 0.20'
1037	246257.33	4284029.69	10/15/2003	FOUND 5/8" IRON ROD WITH CARSONITE POST MARKED "STA E855+21.85 PS 65LT"-FLUSH
1038	246081.79	4284254.02	10/15/2003	FOUND 5/8" IRON ROD-DOWN 0.20'
1039	246082.20	4284254.36	10/15/2003	FOUND 5/8" IRON ROD WITH YPC "L.J. FRIAR & ASSOC."-DOWN 0.20'
1040	246496.55	4283787.64		CALC POINT (NW DLC 50) NOT RECOVERED DUE TO BEE HIVE AT MONUMENT - CALCULATED POSITION ONLY

NOTES:

- LDP DENOTES LOCAL DATUM PLANE COORDINATES
- ALL MONUMENTS FOUND IN "GOOD CONDITION"
- YPC DENOTES YELLOW PLASTIC CAP
- SEE SHEET 3 FOR MONUMENT CAP SKETCHES
- TO CONVERT LDP COORDINATES TO THE OREGON COORDINATE SYSTEM OF 1983 (1991 ADJUSTMENT), SOUTH ZONE, MULTIPLY THE LDP COORDINATE VALUES BY 0.9999468855

REGISTERED
 PROFESSIONAL
 LAND SURVEYOR

J.A.C.L.

OREGON
 JULY 15, 1983
 JOHN A. CARLSON
 2044

RENEWS 12-31-2005

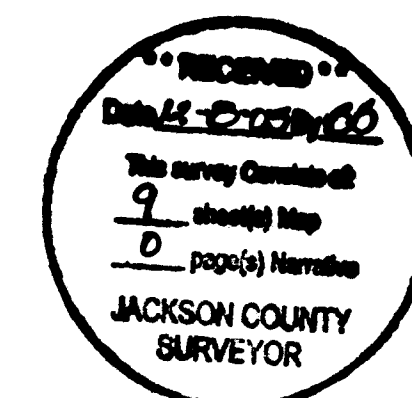

PROJECT LOCATED IN THE SE 1/4 SEC 30; NE 1/4 SEC 31; NW, SW, SE 1/4'S SEC 32 OF T37S, R1W, W.M.; AND NE 1/4 SEC 5; NW, SW, SE 1/4'S SEC 4; NE 1/4 SEC 9; NW, SW 1/4'S SEC 10; NE, SE 1/4'S SEC 15; SW 1/4 SEC 14; NW, NE, SE 1/4'S SEC 23; SW 1/4 SEC 24; NW, NE 1/4'S SEC 25 OF T38S, R1W, W.M.; AND SW, SE 1/4'S SEC 30; NE 1/4 SEC 31; NW, NE, SE 1/4'S SEC 32; SW, SE 1/4'S SEC 33 OF T38S, R1E, W.M.

CONTROL AND I-5 CENTER LINE RECOVERY SURVEY FOR OREGON DEPT. OF TRANSPORTATION REGION 3

I-5: N. ASHLAND - 12TH STREET JACKSON COUNTY KEY NO. 11783



17355 SW BOONES FERRY RD. LAKE OSWEGO, OREGON 97035 PHONE: (503) 635-3618 FAX: (503) 635-5395 www.otak.com

PROJECT NO. 11732-014-001 DECEMBER 4, 2003 SHEET 3 OF 9

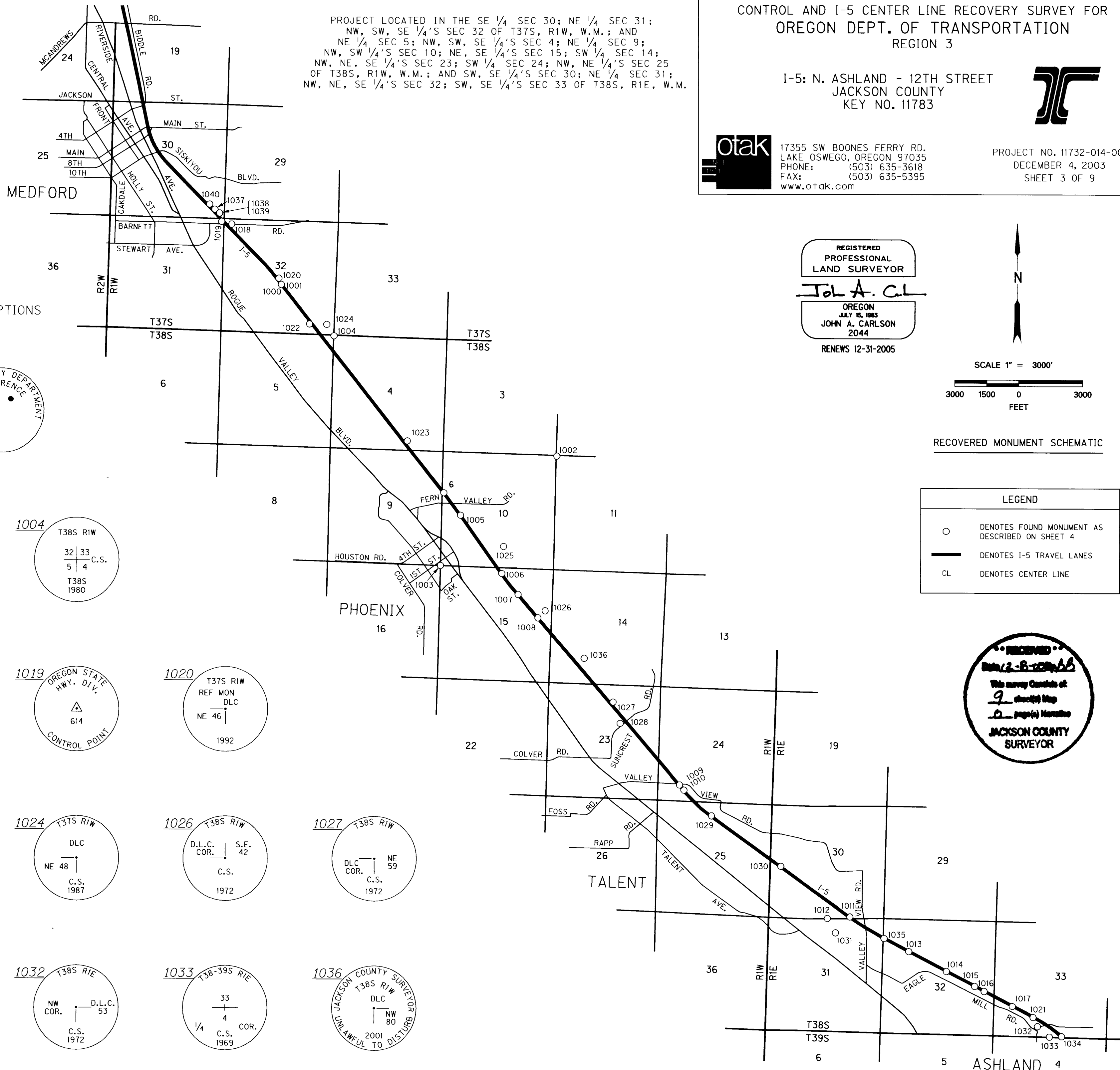

MONUMENT SKETCHES SEE SHEET 4 FOR COORDINATES AND DESCRIPTIONS

TYPICAL #1

CL MONUMENTS: 6, 1001, 1005, 1006, 1007, 1008, 1010, 1011, 1015, 1021, 1029, 1030, 1035

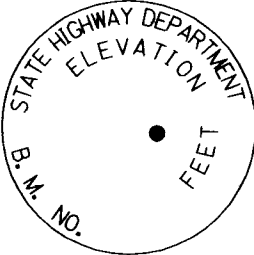

TYPICAL #2

CL MONUMENTS: 1013, 1014, 1016, 1017, 1034

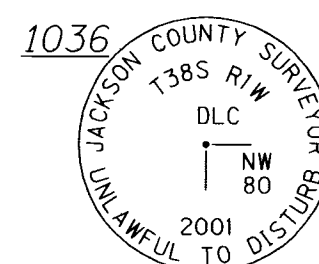
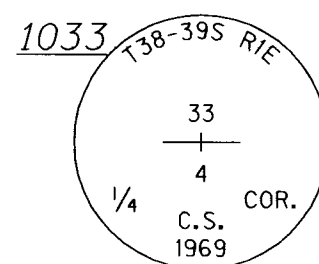
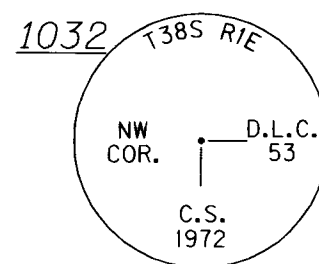
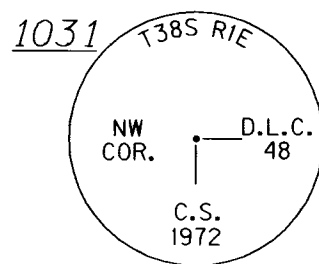
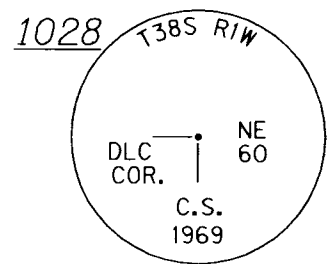
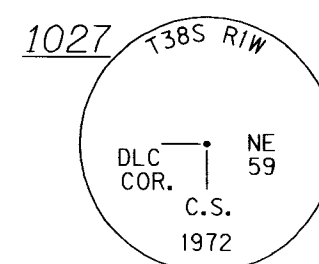
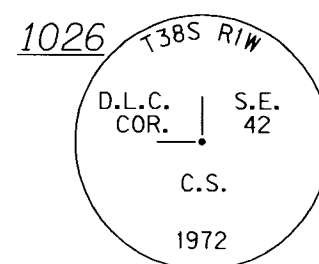
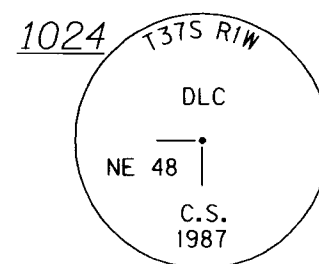
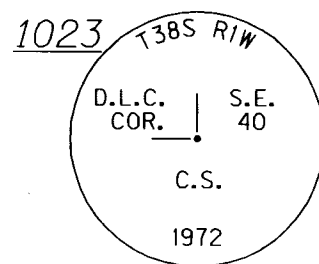
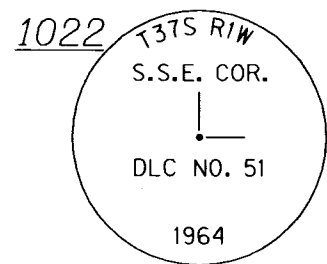
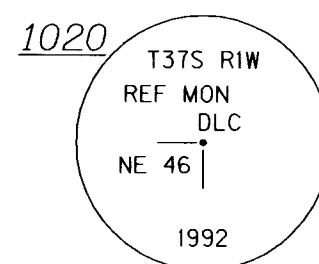
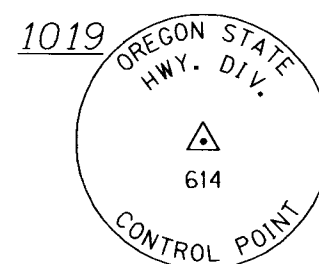
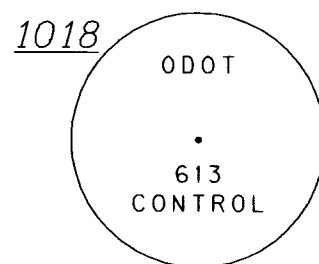
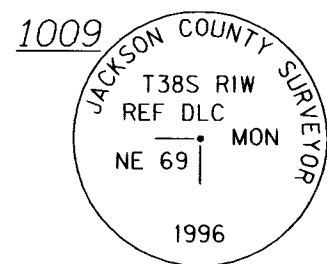
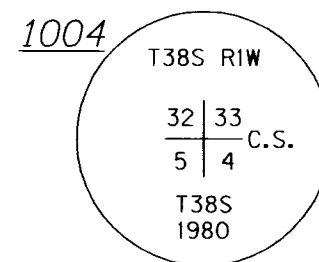
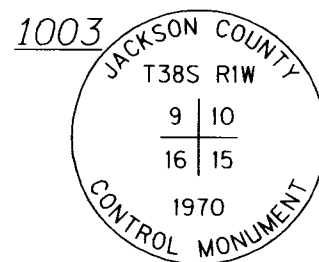
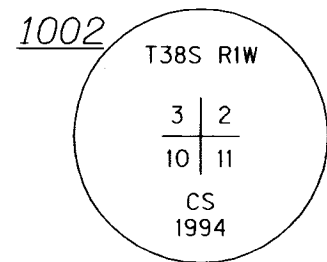
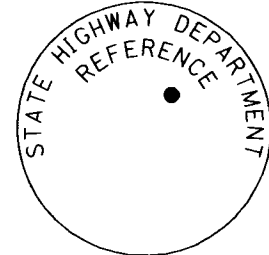

REGISTERED PROFESSIONAL LAND SURVEYOR John A. Carlson OREGON JULY 15, 1983 JOHN A. CARLSON 2044 RENEWS 12-31-2005

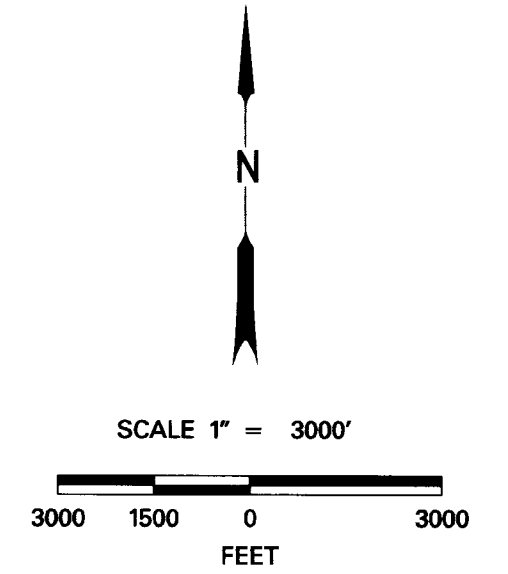

RECOVERED MONUMENT SCHEMATIC

LEGEND: Circle with dot denotes found monument as described on sheet 4; Thick line denotes I-5 travel lanes; CL denotes center line.

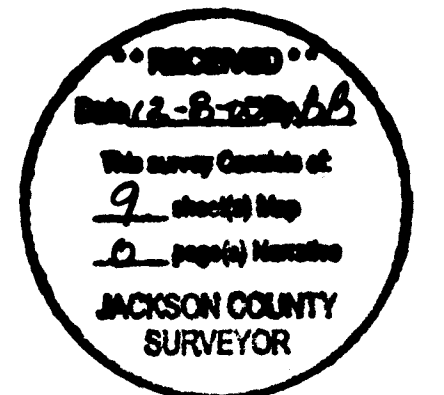

CONTROL AND I-5 CENTER LINE RECOVERY SURVEY FOR
OREGON DEPT. OF TRANSPORTATION
REGION 3

I-5: N. ASHLAND - 12TH STREET
JACKSON COUNTY
KEY NO. 11783



17355 SW BOONES FERRY RD.
LAKE OSWEGO, OREGON 97035
PHONE: (503) 635-3618
FAX: (503) 635-5395
www.otak.com

PROJECT NO. 11732-014-001
DECEMBER 4, 2003
SHEET 2 OF 9

LEGEND	
☆	FOUND GPS MONUMENT
○	FOUND MONUMENT
★	SET GPS MONUMENT
▲	SET NETWORK MONUMENT
---	OBSERVATION LINES
---	GPS STATIC
---	GPS RTK
---	TERRESTRIAL
OCS	OREGON COORDINATE SYSTEM OF 1983, SOUTH ZONE (1991 ADJUSTMENT)
LDP	LOCAL DATUM PLANE

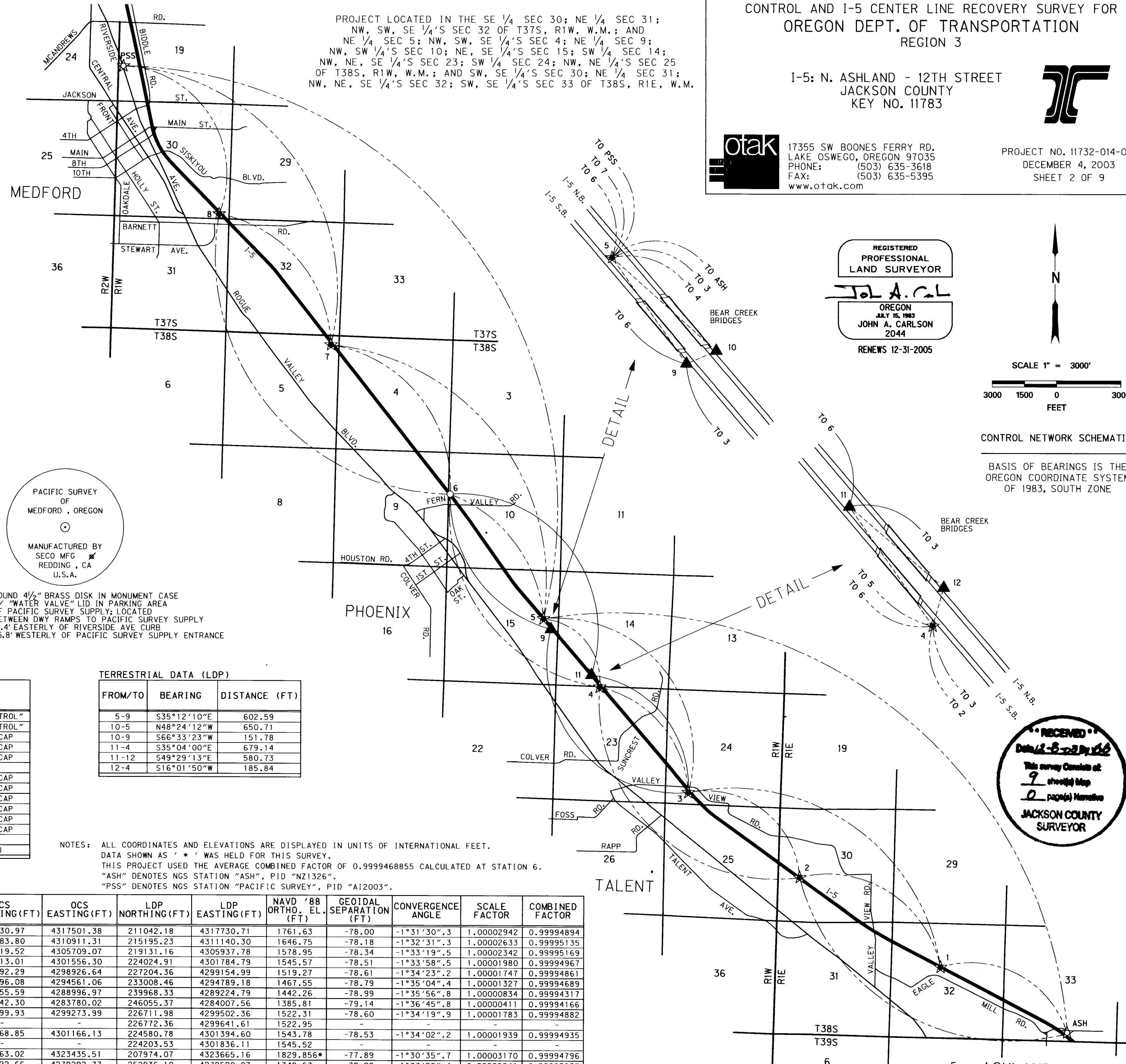

REGISTERED PROFESSIONAL LAND SURVEYOR
JOHN A. CARLSON
OREGON
JULY 15, 1983
JOHN A. CARLSON
2044
RENEWS 12-31-2005

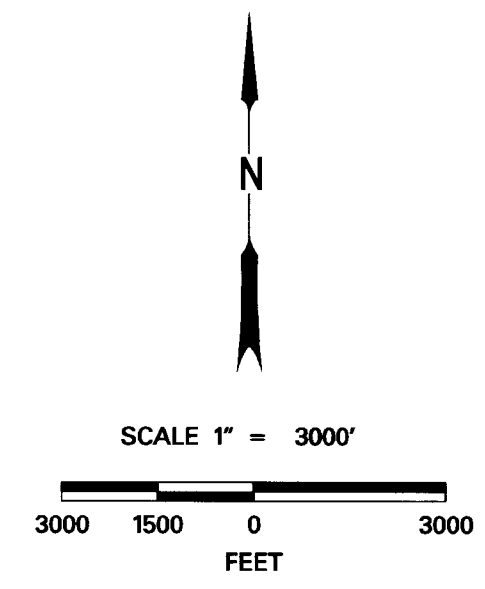

CONTROL NETWORK SCHEMATIC
BASIS OF BEARINGS IS THE OREGON COORDINATE SYSTEM OF 1983, SOUTH ZONE

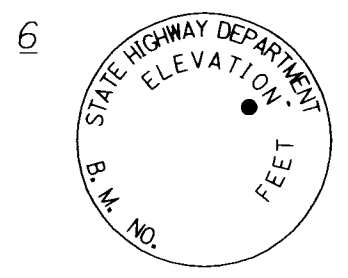

FOUND 2 3/4" BRASS DISK IN CONCRETE; DOWN 0.30'; APPROXIMATE CENTER LINE STATION 1025+87

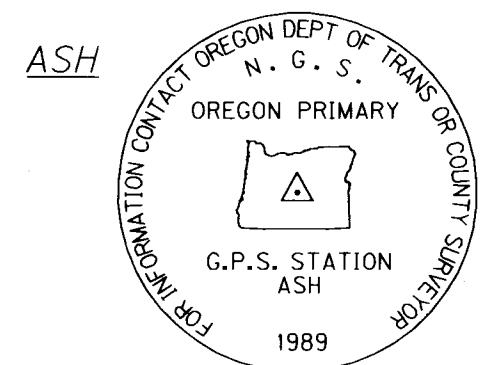

FOUND 4" BRASS DISK IN 6" SQUARE CONCRETE POST; FLUSH AT TOP OF CUT BANK; SOUTH OF MICROWAVE BLDG. AND DISH; APPROX MP 17.2; 10' WESTERLY OF 'T' IN WIRE FENCE 80' +/- N. EASTERLY OF I-5 PAVEMENT

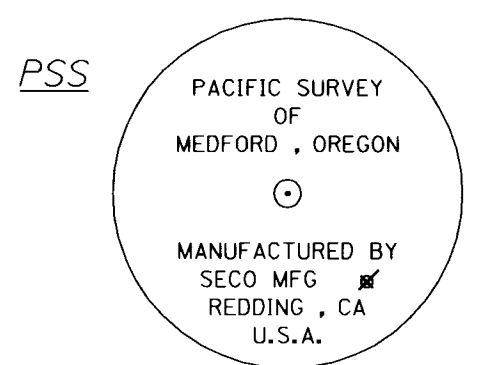

FOUND 4 1/2" BRASS DISK IN MONUMENT CASE W/ "WATER VALVE" LID IN PARKING AREA OF PACIFIC SURVEY SUPPLY; LOCATED BETWEEN DWY RAMP TO PACIFIC SURVEY SUPPLY 15.4' EASTERLY OF RIVERSIDE AVE CURB 55.8' WESTERLY OF PACIFIC SURVEY SUPPLY ENTRANCE

PROJECT CONTROL DESCRIPTION

STATION NAME	DESCRIPTION
1	SET PK NAIL W/1/2" BRASS WASHER STAMPED "OTAK CONTROL"
2	SET PK NAIL W/1/2" BRASS WASHER STAMPED "OTAK CONTROL"
3	SET 5/8"x30" REBAR WITH "OTAK CONTROL" RED PLASTIC CAP
4	SET 5/8"x30" REBAR WITH "OTAK CONTROL" RED PLASTIC CAP
5	SET 5/8"x30" REBAR WITH "OTAK CONTROL" RED PLASTIC CAP
6	FOUND 2 3/4" BRASS DISK IN CONCRETE (SEE SKETCH)
7	SET 5/8"x30" REBAR WITH "OTAK CONTROL" RED PLASTIC CAP
8	SET 5/8"x30" REBAR WITH "OTAK CONTROL" RED PLASTIC CAP
9	SET 5/8"x30" REBAR WITH "OTAK CONTROL" RED PLASTIC CAP
10	SET 5/8"x30" REBAR WITH "OTAK CONTROL" RED PLASTIC CAP
11	SET 5/8"x30" REBAR WITH "OTAK CONTROL" RED PLASTIC CAP
12	SET 5/8"x30" REBAR WITH "OTAK CONTROL" RED PLASTIC CAP
ASH	FOUND 4" BRASS DISK IN CONCRETE (SEE SKETCH)
PSS	FOUND 4 1/2" BRASS DISK IN MONUMENT CASE (SEE SKETCH)

TERRESTRIAL DATA (LDP)

FROM/TO	BEARING	DISTANCE (FT)
5-9	S35°12'10"E	602.59
10-5	N48°24'12"W	650.71
10-9	S66°33'23"W	151.78
11-4	S35°04'00"E	679.14
11-12	S49°29'13"E	580.73
12-4	S16°01'50"W	185.84

NOTES: ALL COORDINATES AND ELEVATIONS ARE DISPLAYED IN UNITS OF INTERNATIONAL FEET. DATA SHOWN AS ' * ' WAS HELD FOR THIS SURVEY. THIS PROJECT USED THE AVERAGE COMBINED FACTOR OF 0.9999468855 CALCULATED AT STATION 6. "ASH" DENOTES NGS STATION "ASH", PID "NZ1326". "PSS" DENOTES NGS STATION "PACIFIC SURVEY", PID "A12003".

PROJECT CONTROL POSITIONS AND COORDINATES

STATION NAME	LAT. '83(91) (NORTH)	LONG. '83(91) (WEST)	ELLIPSE HEIGHT (FT)	OCS NORTHING (FT)	OCS EASTING (FT)	LDP NORTHING (FT)	LDP EASTING (FT)	NAVD '88 ORTHO. EL. (FT)	GEOIDAL SEPARATION (FT)	CONVERGENCE ANGLE	SCALE FACTOR	COMBINED FACTOR
1	42°13'25".13524	122°43'45".08115	1683.63	211030.97	4317501.38	211042.18	4317730.71	1761.63	-78.00	-1°31'30".3	1.00002942	0.99994894
2	42°14'04".40087	122°45'14".11862	1568.57	215183.80	4310911.31	215195.23	4311140.30	1646.75	-78.18	-1°32'31".3	1.00002633	0.99995135
3	42°14'41".87576	122°46'24".66469	1500.61	219119.52	4305709.07	219131.16	4305937.78	1578.95	-78.34	-1°33'19".5	1.00002342	0.99995169
4	42°15'29".07952	122°47'21".63280	1467.06	224013.01	4301556.30	224024.91	4301784.79	1545.57	-78.51	-1°33'58".5	1.00001980	0.99994967
5	42°15'59".76184	122°47'57".74856	1440.65	227192.29	4298926.64	227204.36	4299154.99	1519.27	-78.61	-1°34'23".2	1.00001747	0.99994861
6	42°16'55".88322	122°48'57".92066	1388.76	232996.08	4294561.06	233008.46	4294789.18	1467.55	-78.79	-1°35'04".4	1.00001327	0.99994689
7	42°18'03".07777	122°50'14".49344	1363.27	239955.59	4288996.97	239968.33	4289224.79	1442.26	-78.99	-1°35'56".8	1.00000834	0.99994317
8	42°19'01".73622	122°51'26".16643	1306.66	246042.30	4283780.02	246055.37	4284007.56	1385.81	-79.14	-1°36'45".8	1.00000411	0.99994166
9	42°15'54".99422	122°47'52".95101	1443.71	226699.93	4299273.99	226711.98	4299502.36	1522.31	-78.60	-1°34'19".9	1.00001783	0.99994882
10	-	-	-	-	-	226772.36	4299641.61	1522.95	-	-	-	-
11	42°15'34".46279	122°47'27".02130	1465.25	224568.85	4301166.13	224580.78	4301394.60	1543.78	-78.53	-1°34'02".2	1.00001939	0.99994935
12	-	-	-	-	-	224203.53	4301836.11	1545.52	-	-	-	-
ASH	42°12'56".39242*	122°42'25".16768*	1751.97	207963.02	4323435.51	207974.07	4323665.16	1829.856*	-77.89	-1°30'35".7	1.00003170	0.99994796
PSS	42°20'08".42334*	122°52'28".46532*	1269.39	252922.66	4279292.77	252936.10	4279520.07	1348.67	-79.28	-1°37'28".4	0.99999941	0.99993873

