

TERRASURVEY, INC. 
PROFESSIONAL LAND SURVEYORS
 274 FOURTH STREET
 ASHLAND, OREGON 97520

TELEPHONE: (541) 482-6474
 FACSIMILE: (541) 552-0292
 ELECTRONIC: terrain@bisp.net

AFFIDAVIT OF MONUMENTATION FOR DEFERRED MONUMENTS

KNOW ALL MEN BY THESE PRESENTS, that I, Stuart M. Osmus, a duly Registered Land Surveyor of the State of Oregon, do hereby affirm that I have established with proper monuments as required by law those street centerline monuments shown as deferred on the Official Plat of CLEAR CREEK VILLAGE PHASE I, as recorded in Volume 27, page 59 of Plats in Jackson County, Oregon. The monuments are a 1" X 30" Iron Pipe with a 3" Brass Cap stamped "City of Ashland Survey Monument, LS 2464" in a monument case.

This Affidavit is to comply with Chapter 92.070 of the Revised Statutes of the State of Oregon.

IN WITNESS HEREOF, signed this 19th day of September, 2002.

STATE OF OREGON)

County of Jackson) ss.

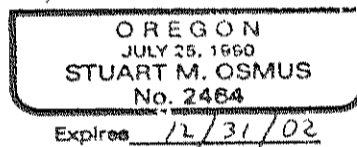
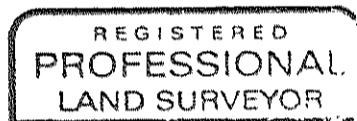
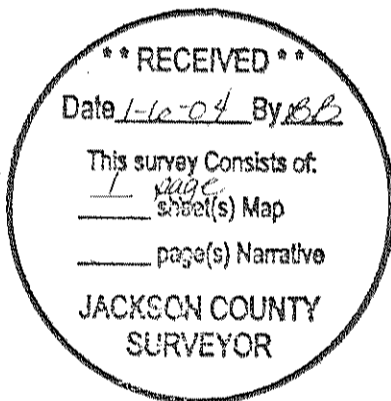

This instrument was acknowledged before me on this 19th day of September, 2002, by Stuart M. Osmus, a Registered Professional Land Surveyor, and acknowledged the foregoing instrument to be his voluntary act and deed.

Before me:



Notary

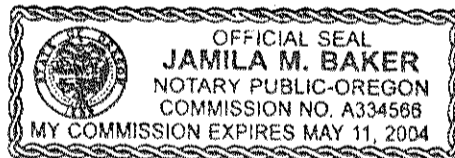

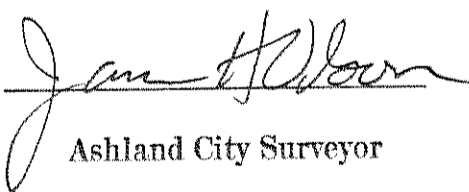
Approved: 
 Ashland City Surveyor

Sept. 20, 2002
 Date

Examined and approved this 17th day of October, 2002.

Jackson County, Oregon
 Recorded
 OFFICIAL RECORDS

 Jackson County Surveyor

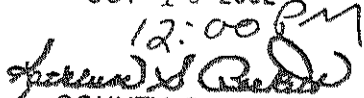
OCT 10 2002
 12:00 PM

 COUNTY CLERK

4/11
 12/2/73