

MARK E. BOYDEN  
R.P.L.S. ORE. 281  
108 MISTLETOE ST., MEDFORD, OREGON 97501  
PHONE (503) 773-6000

SURVEY NO. 17878

SURVEY NARRATIVE TO COMPLY WITH O.R.S. 209.250

SURVEY FOR: Eden Valley Orchards, Vineyard/Winery  
c/o Ann Root  
2310 Voorhies Road  
Medford, OR 97501

SURVEY BY: Boyden Surveyors  
108 Mistletoe Street  
Medford, OR 97501

LOCATION: D.L.C. No. 46, South-Half of Section 5,  
T. 38 S., R. 1 W., W.M., Jackson County, Oregon

BASIS OF BEARINGS: Centerline Stage Road South,  
Re: County Filed Survey No. 1547

DATE: August 18, 2003

PURPOSE: To monument the corners of Exhibit "D" of Instrument  
No. 00-43285

PROCEDURE: Utilizing E.D.M. equipment, traversed from the NE corner  
of D.L.C. No. 46, Westerly and Southerly to control  
monuments found as shown on the map to accompany this  
report. Set monuments as shown.

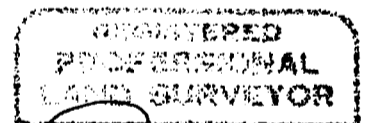

*Mark E. Boyden*  
JACKSON COUNTY  
MARK E. BOYDEN  
281  
Expires 12/31/03.

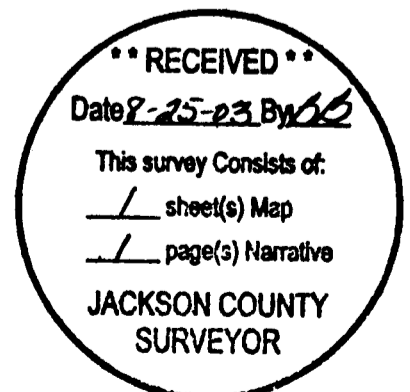

Survey for:

**EDEN VALLEY ORCHARDS  
VINEYARD / WINERY**

% Ann Root  
2310 Voorhies Road  
Medford, Oregon 97501

Located in D.L.C. No. 46  
S1/2, Sec. 5, T.38S, R.1W., W.M.  
Jackson County, Or.

By:

Boyden Surveyors  
108 Mistletoe St.  
Medford, Or. 97501

Date:

August 18, 2003

Scale: 1" = 200'

**LEGEND**

**BASIS OF BEARINGS**

FILED (CO.) SURVEY  
NO. 1547

● SET 5/8" x 30" REBAR/AL. CAP  
STAMPED "BOYDEN PLS 281"

○ FD MONUMENT AS INDICATED

F.S. = FILED (CO.) SURVEY

-x-x-x EXISTING FENCE LINE

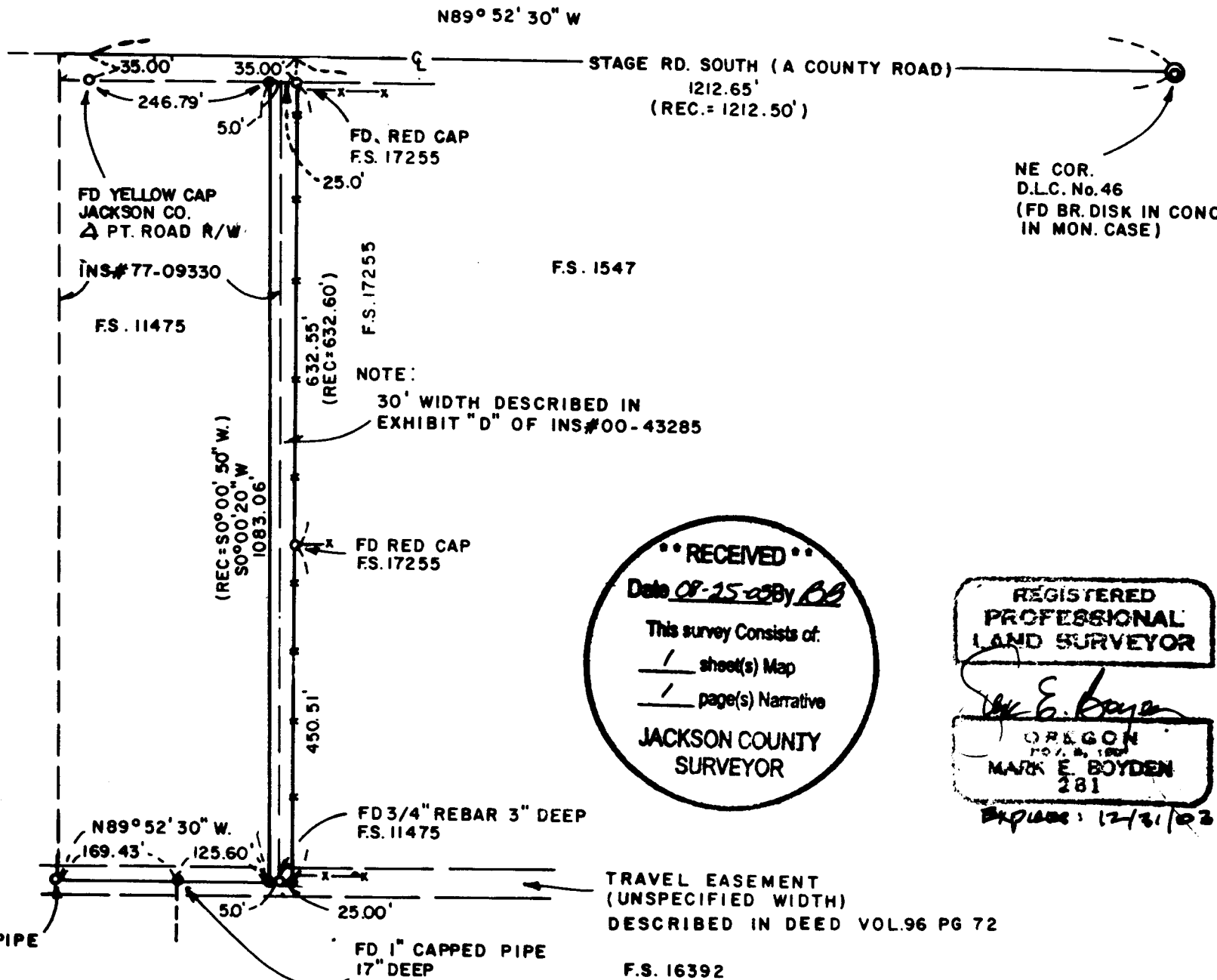

NOTE:  
30' WIDTH DESCRIBED IN  
EXHIBIT "D" OF INS#00-43285

**RECEIVED**  
Date 08-25-03 By MB  
This survey Consists of:  
/ sheet(s) Map  
/ page(s) Narrative  
**JACKSON COUNTY  
SURVEYOR**

**REGISTERED  
PROFESSIONAL  
LAND SURVEYOR**  
*Mark E. Boyden*  
**OREGON  
NOV. 16, 1987  
MARK E. BOYDEN  
281**  
EXPIRES: 12/31/03.

TRAVEL EASEMENT  
(UNSPECIFIED WIDTH)  
DESCRIBED IN DEED VOL.96 PG 72

F.S. 16392