

**LEGEND**

- ⊙ STREET CENTERLINE MONUMENTS PER S/N 9203 AS DESCRIBED (RECOVERED)
- ⊙ 3/4" IRON PIPE PER S/N 8574 & 9203 (RECOVERED)
- 5/8" IRON PIN PER S/N 8574 & 9203 (RECOVERED)
- ⊗ 5/8" IRON PIN PER S/N 12544 (RECOVERED)
- 5/8"x 24" IRON PIN w/ ORANGE PLASTIC CAP MARKED "KAMPMANN PLS 2883" (ESTABLISHED)
- PROPERTY LINE
- - - ADJUSTED PROPERTY LINE
- BOUNDARY LINE
- - - CENTERLINE
- - - EASEMENT LINE
- x - x - FENCELINE, CHAINLINK
- o - o - FENCELINE, BOARD
- S/N SURVEY NUMBER FILE, JACKSON COUNTY SURVEYOR
- O.R. INSTRUMENT NUMBER, JACKSON COUNTY RECORDER
- D.R. DEED RECORD VOLUME/PAGE, JACKSON COUNTY RECORDER
- ( ) SURVEY RECORD PER S/N 8574 & 9203
- { } SURVEY RECORD PER S/N 12544
- [ ] DEED RECORD O.R. 02-69440 & 02-69441

**SURVEY NARRATIVE  
TO COMPLY WITH O.R.S. 209.250**

**PURPOSE:** TO SURVEY AND MONUMENT A PROPERTY LINE ADJUSTMENT BETWEEN THOSE TRACTS OF LAND DESCRIBED WITHIN INSTRUMENT NUMBERS 02-69440 & 02-69441 OF THE OFFICIAL RECORDS OF JACKSON COUNTY, OREGON, LYING SITUATE IN THE NORTHEAST QUARTER OF SECTION 19, TOWNSHIP 37 SOUTH, RANGE 1 WEST, WILLAMETTE MERIDIAN.

**PROCEDURE:** MONUMENTS WERE FIELD SURVEYED UTILIZING A NIKON DTM-520 ELECTRONIC TOTAL STATION AND RANGING PRISMS. THE BASIS OF BEARING FOR THIS SURVEY WAS THE CENTERLINE OF GRAND AVENUE BETWEEN RECOVERED MONUMENTS LOCATED AT THE CENTERLINE INTERSECTIONS OF GRAND AVENUE WITH COVINA AVENUE AND CORONA AVENUE, HAVING A RECORD BEARING OF NORTH 89°49'00" WEST PER SURVEY NO. 9203, ON FILE IN THE OFFICE OF THE JACKSON COUNTY SURVEYOR. RECOVERED MONUMENTS REFERENCED ON SURVEY NUMBERS 9203 & 8574 BY VERLYN THOMAS WERE FOUND TO FIT SATISFACTORY WITH THE SURVEY RECORD AND WERE HELD FOR POSITION OF THE CORNERS OF LOT 4, BLOCK 2, LAKE WOOD SUBDIVISION. MONUMENTS RECOVERED FROM SURVEY NO. 12544, WHICH PARTITIONED OFF THE WESTERLY 60.25 FEET OF SAID LOT 4, WERE HELD FOR LINE, BUT FOUND TO BE SOUTHERLY FROM THEIR RECORD POSITIONS BY 0.07'. I ESTABLISHED MONUMENTS AT THE ADJUSTED PROPERTY LINE CORNERS PER THE MUTUAL DIRECTION OF THE LANDOWNERS. DURING THE PERFORMANCE OF THIS SURVEY, I NOTED EVIDENCE THAT THE LOCATION OF A BURIED CONCRETE BOX CULVERT WHICH HAS ENCLOSED THE HOPKINS IRRIGATION CANAL IN THIS AREA, APPEARS TO DEVIATE FROM THE RECORD LOCATION AS SHOWN ON THE LAKE WOOD SUBDIVISION PLAT. IT WAS NOT WITHIN THE SCOPE OF THIS SURVEY TO ATTEMPT TO RESOLVE OR FURTHER INVESTIGATE ANY POTENTIAL CONFLICT WHICH MAY OR MAY NOT RESULT FROM THIS DISCOVERY.

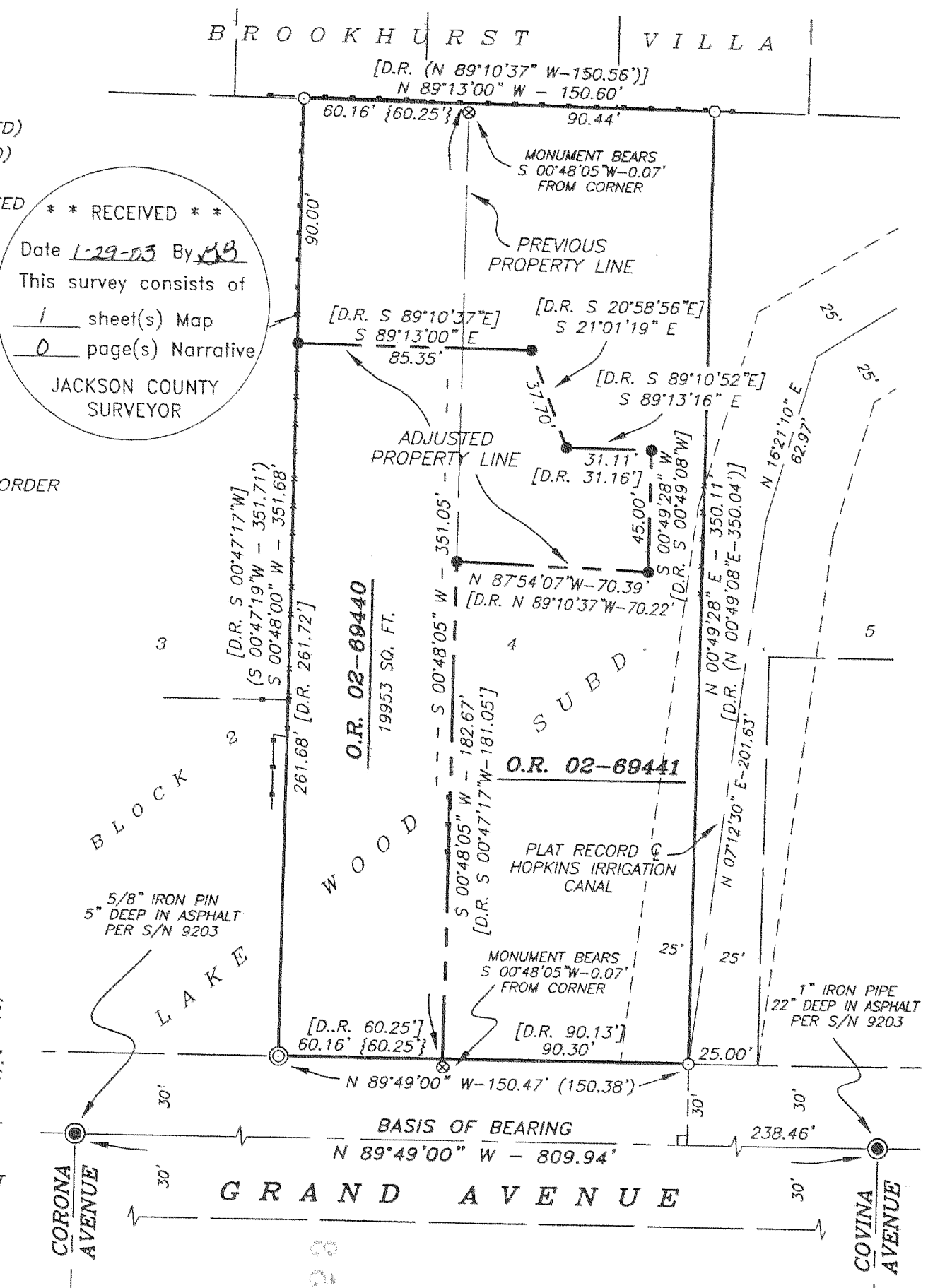

**MAP OF SURVEY**

LOCATED WITHIN  
NORTHEAST QUARTER OF SECTION 19,  
TOWNSHIP 37 SOUTH, RANGE 1 WEST, W.M.  
CITY OF MEDFORD, JACKSON COUNTY, OREGON

FOR  
**FRED HOLLIMAN**

2982 ROSEDALE TERRACE  
MEDFORD, OREGON 97504

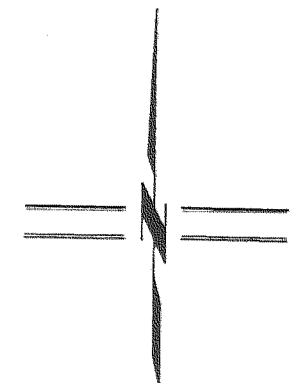

SCALE: 1" = 50'

REGISTERED  
PROFESSIONAL  
LAND SURVEYOR

*Shawn Kampmann*

OREGON  
JULY 14, 1998  
SHAWN KAMPMANN  
02883 LS

RENEWAL DATE: 6/30/2003

SURVEYED BY:  
**POLARIS LAND SURVEYING**  
P.O. BOX 459  
ASHLAND, OREGON 97520  
(541) 482-5009

DATE: JANUARY 16, 2003  
PROJECT NO. 066-02

ASSESSOR'S MAP NO. 371W19AB TAX LOTS 800 & 901

**POLARIS LAND SURVEYING**